

1/81 WTO

GW 4473

TRANSMITTED FOR ADP Bellewood

Recorded by 1/81

U.S. GEOLOGICAL SURVEY

Well No. E121 (E-130R)

Date 9/2/81

WATER RESOURCES DIVISION

E-Log No. \_\_\_\_\_

MISSISSIPPI DISTRICT

WELL RECORD

County Humphreys

Site ID 3.3.0.7.5.4.0.9.0.3.6.4.2.0.1 R=0\* T=A\* 2=W\*

Data reliab. 3=U<sup>C</sup> Report. agency 4=USGS\* Dist. 6=28\* 7=28\* Co. 8=0.5.3\*

Lat. \_\_\_\_\_ Long. 9=3.3.0.7.5.4\* 10=0.9.0.3.6.4.2\* Well No. 12=E.1.2.1\*

Location 13=N.E.S.E. 2.1 T. 1.5 N. R. 0.4 W.\* Alt. 16=10.2.\*

Hyd. Unit (OWDC) 20= Date 21=0.4.1.2.8.1.1.9.8.1.\*

Well use 23=W\* Water Use 24=I\* Hole depth 27=11.5.\* Well depth 28=11.5.\*

WL 30=2.0.\* Date 31=0.4.1.2.8.1.1.9.8.1.\* Source 33=D\*

Status 273= Project No. 5=

R=158\* T=A\* Date 159# 0.4.1.2.8.1.1.9.8.1.\* Owner No. \_\_\_\_\_

Owner 161# W. A. Mc MARROUGH

R=192\* T=A\* Date 193# Temp. 196#00010\* 197=

R=192\* T=A\* Date 193# Cond. 196#00095\* 197=

R=192\* T=A\* Date 193# pH 196#00400\* 197=

R=58\* T=A\* 59# 1\* Date 60=0.4.1.2.8.1.1.9.8.1.\* Remarks \_\_\_\_\_

Drlg. 63=4.0.5\* Name LARRY'S WELL Method 65=R\* Finish 66=1.5\*

R=76\* T=A\* 59# 1\* Steel

Top csng. 77# 0.\* Bot. csng. 78=7.5.\* Diam. 79# 12.\*

R=76\* T=A\* 59# 1\*

Top csng. 77# Bot. csng. 78= Diam. 79#

R=82\* T=A\* 59# 1\* Top 83# 7.5.\* Bottom 84=11.5.\*

Type 85=L\* Diam. 87=12.\* Size 88=

R=82\* T=A\* 59# 1\* Top 83# Bottom 84=

Type 85= Diam. 87= Size 88=

R= T=A\* 147# 1\* Q 150= Q/S 272=

134 flows 146 pumped

GEN. SITE DATA

OWNER

FIELD QW

CONSTR.

CASING

OPENINGS

YIELD

LIFT

R=42\* T= A \* Lift type 43# T \* Intake 44= \* Power type 45= E \*

Date 38= 0.4/28/1981 \* H.P. 46= 60. \* \*

LOGS

R=198# T= A \* Log 199# D \* Top 200= 0. \* Bot 201= 1.15. \* \*

R=198# T= A \* Log 199# \* Top 200= \* Bot 201= \* \*

R=189# T= A \* E Log No. 190# \* 191= M I S S D I S T \* \*

ANAL.

R=114# T= A \* Year 115# \* 117= \* 120= \*

AQUIFERS

R=90# T= A \* 256# 1 \* Top 91= 45. \* Bot 92= 1.15. \* \*

Unit ID 93= 1.12MRVA \* Name of Unit Alluv.

R=90# T= A \* 256# 1 \* Top 91= \* Bot 92= \* \*

Unit ID 93= \* Name of Unit

HYDRAULICS

R=98# T= A \* 99# 1 \* Unit tested 100= \* 103= \* \*

R=105# T= A \* 99# 1 \* Test No. 106# \* \*

107= \* Transmissivity (gal/d)/ft

108= \* Hydraul. cond. (gal/d)/ft<sup>2</sup>

110= \* Storage coeff. Boundaries

R=121# T= \* Yr Begin 122# \* Network 258# \* \*

Water Level Data Collection (1)

9 mi SW of Belgov

description of formations encountered	from	to
		75

Humphreys  
E 121  
4-28-81  
GW 4473

MISSISSIPPI DEPARTMENT OF NATURAL RESOURCES  
Bureau of Land and Water Resources  
Southport Mall  
P.O. Box 10631  
Jackson, Mississippi 39209  
WATER WELL DRILLERS LOG

CODED

April 28, 1981 date well completed  
Lump's Well Pump firm name  
Humphreys county well located

LANDOWNER: <u>W.A. McMorrough</u>	description of formations encountered	from	to
<u>Belzoni, ms.</u> (mailing address)			
	<u>FINE + MED SAND</u>	<u>45</u>	<u>75</u>
	<u>COARSE SAND</u>	<u>75</u>	<u>115</u>
<b>WELL LOCATION:</b>			
sec. <u>21</u> T. <u>15</u> N. R. <u>4</u> E			
<u>9</u> miles <u>SW</u> of <u>Belzoni</u>			
(distance) (direction) (nearest town)			
<b>WELL PURPOSE:</b> (home, irrigation, municipal, industrial)			
<b>WELL COMPLETION DATA:</b>			
(1) diameter (inches) <u>12"</u>			
(2) total depth (feet) <u>115'</u>			
(3) static water level (feet) <u>20</u> <sup>below</sup> / <sub>above</sub> top of ground.			
(4) casing <u>Steel</u> , <u>75'</u> (material) (depth)			
(size) If telescope see back.			
(5) screen <u>40'</u> , <u>75'</u> (length) (depth to top)			
<u>12"</u> , <u>Steel</u> (size) (material)			
(6) pump <u>60</u> (HP) (yield gpm)			
(type power)			
(7) electric log <u>NO</u> (yes or no)			
(organization running log)			
(8) how well bottom plugged <u>Steel Plate</u>			
DRILLERS REMARKS:			

CODED

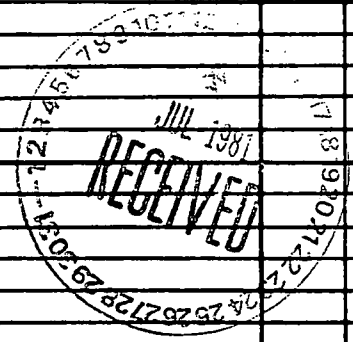

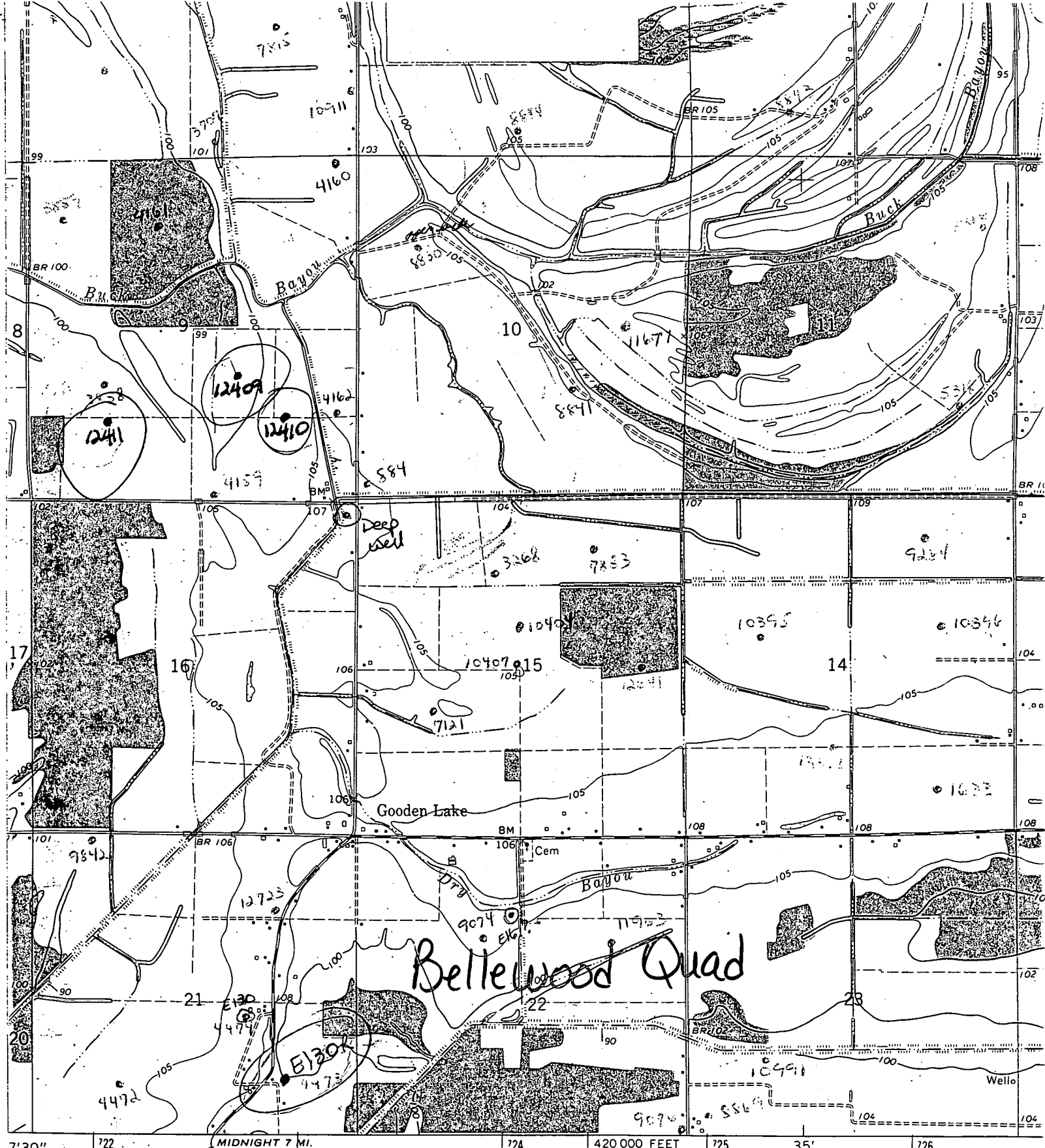

Mapped, edited, and published by the Geological Survey  
 Control by USGS and USC&GS

Planimetry by photogrammetric methods from aerial photographs taken 1961. Topography by planetable surveys 1964-65

Polyconic projection. 1927 North American datum  
 10,000-foot grid based on Mississippi coordinate system, west zone  
 1000-meter Universal Transverse Mercator grid ticks, zone 15, shown in blue

Fine red dashed lines indicate selected fence and field lines where generally visible on aerial photographs. This information is unchecked

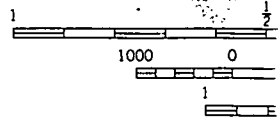
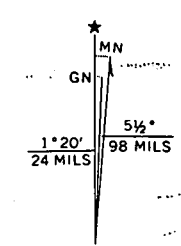

UTM GRID AND 1965 MAGNETIC NORTH DECLINATION AT CENTER OF SHEET