

6/78 WTO

TRANSMITTED FOR ADP 3/81

Midnight

Recorded by \_\_\_\_\_

U.S. GEOLOGICAL SURVEY  
WATER RESOURCES DIVISION  
MISSISSIPPI DISTRICT  
WELL RECORD

Well No. E 98

E-Log-No. \_\_\_\_\_

County Humphreys  
PITCHER & Pump

Site ID 330600090364801 R=0\* T=A\* 2=W\*

Data reliab. 3=C\* Report. agency 4=USGS\* Dist. 6=28\* 7=28\* Co. 8=053\*

GEN. SITE DATA

Lat. \_\_\_\_\_ Long. 9=330600\* 10=0903648\* Well No. 12=E098\*

Location 13=8.W.1.E. S 3.3 T 1.5 N R 0.4 W\* Alt. 16=105\* <sup>105</sup>  
<sub>23.12</sub>  
<sub>76.82</sub>

Hyd. Unit (OWDC) 20= Date 21=0910111980\*

Well use 23= Water Use 24= Hole depth 27= Well depth 28=67\*

WL 30=28\* Date 31=0910111980\* Source 33=S\*

Status 273= Project No. 5=

OWNER

R=158\* T=A\* Date 159#0910111980\* Owner No. \_\_\_\_\_

Owner 161=UNKNOWN\*

FIELD QW

R=192\* T=A\* Date 193# Temp. 196#00010\* 197=

R=192\* T=A\* Date 193# Cond. 196#00095\* 197=

R=192\* T=A\* Date 193# pH 196#00400\* 197=

CONSTR.

R=58\* T=A\* 59#1\* Date 60= Remarks \_\_\_\_\_

Drlg. 63= Name \_\_\_\_\_ Method 65= Finish 66=

CASING

R=76\* T=A\* 59#1\*  
Top csgn. 77# Bot. csgn. 78= Diam. 79#

R=76\* T=A\* 59#1\*  
Top csgn. 77# Bot. csgn. 78= Diam. 79#

OPENINGS

R=82\* T=A\* 59#1\* Top 83# Bottom 84=

Type 85= Diam. 87= Size 88=

R=82\* T=A\* 59#1\* Top 83# Bottom 84=

Type 85= Diam. 87= Size 88=

YIELD

R= \_\_\_\_\_ T=A\* 147#1\* Q 150= Q/S 272=

134 flows 146 pumped

LIFT  
 R=42\* T= A \* Lift type 43# \* Intake 44= \* Power type 45= \*  
 Date 38= / / \* H.P. 46= \*

LOGS  
 R=198\* T= A \* Log 199# \* Top 200= \* Bot 201= \*  
 R=198\* T= A \* Log 199# \* Top 200= \* Bot 201= \*  
 R=189\* T= A \* E Log No. 190# \* 191= M I S S D I S T \*

ANAL.  
 R=114\* T= A \* Year 115# \* Type 120= \*

AQUIFERS  
 R=90\* T= A \* 256# 1 \* Top 91= \* Bot 92= \*  
 Unit ID 93= \* Name of Unit \_\_\_\_\_  
 R=90\* T= A \* 256# 1 \* Top 91= \* Bot 92= \*  
 Unit ID 93= \* Name of Unit \_\_\_\_\_

HYDRAULICS  
 R=98\* T= A \* 99# 1 \* Unit tested 100= \* 103= \*  
 R=105\* T= A \* 99# 1 \* Test No. 106# \*  
 107= \* Transmissivity (gal/d)/ft \_\_\_\_\_  
 108= \* Hydraul. cond. (gal/d)/ft<sup>2</sup> \_\_\_\_\_  
 110= \* Storage coeff. Boundaries \_\_\_\_\_

R=121\* T= \* Yr Begin 122# 1 7 5 0 \* Network 258= \*

Water Level Data Collection (1)

*Handwritten:*  
 Held 32.00  
 .72  
 31.08  
 2.9  
 28.18

*Handwritten:*  
 Depth 70  
 - 2.9  
 67.1

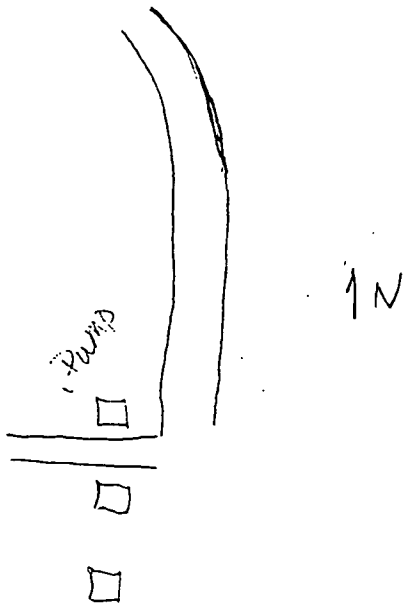

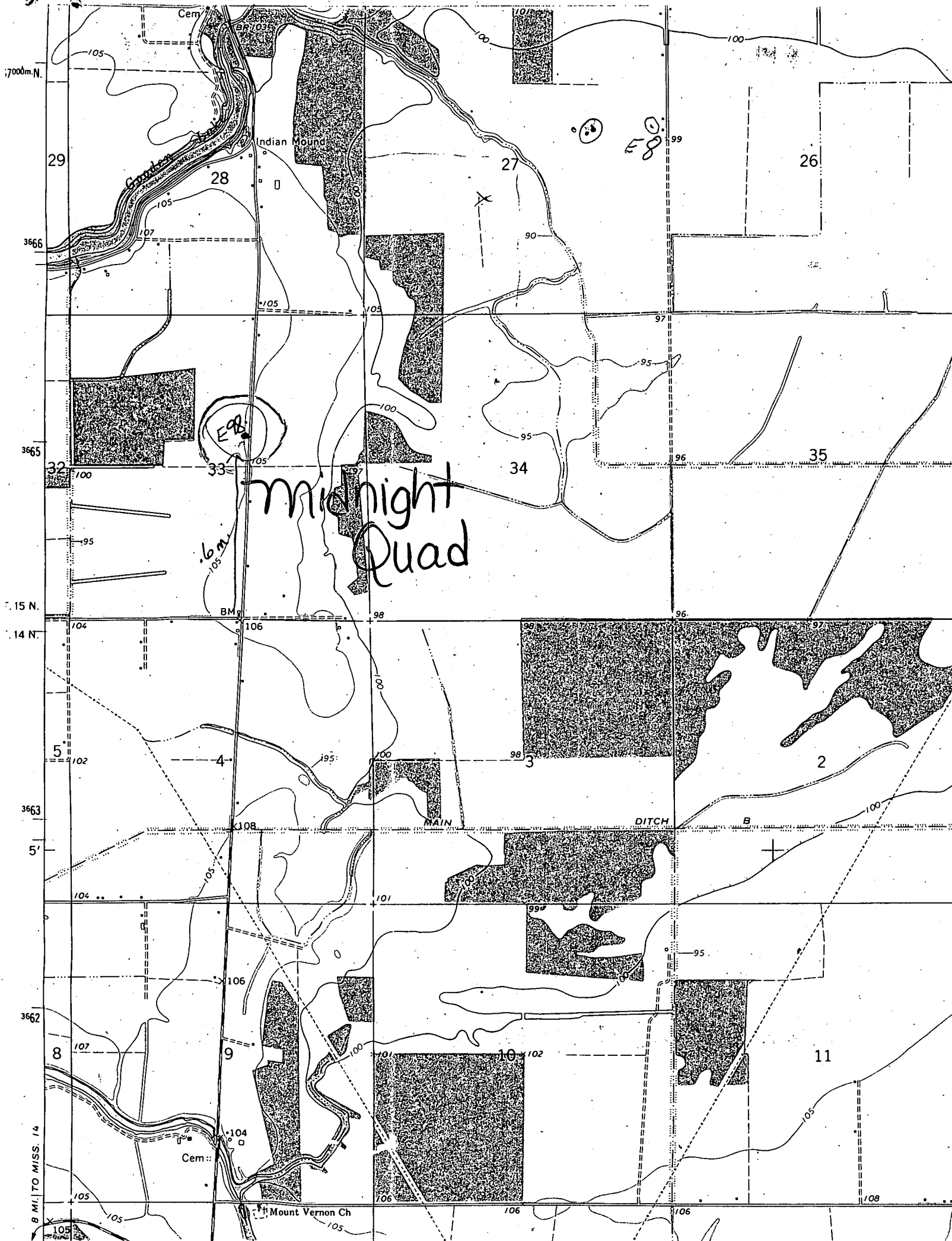

7000m.N.  
29  
3666  
3665  
7.15 N.  
7.14 N.  
5  
3663  
5'  
3662  
8  
8 MI. TO MISS. 14

Cem  
Indian Mound

Midnight Quad

1.6 m.

BM

MAIN

DITCH

Cem

Mount Vernon Ch

EG

EG

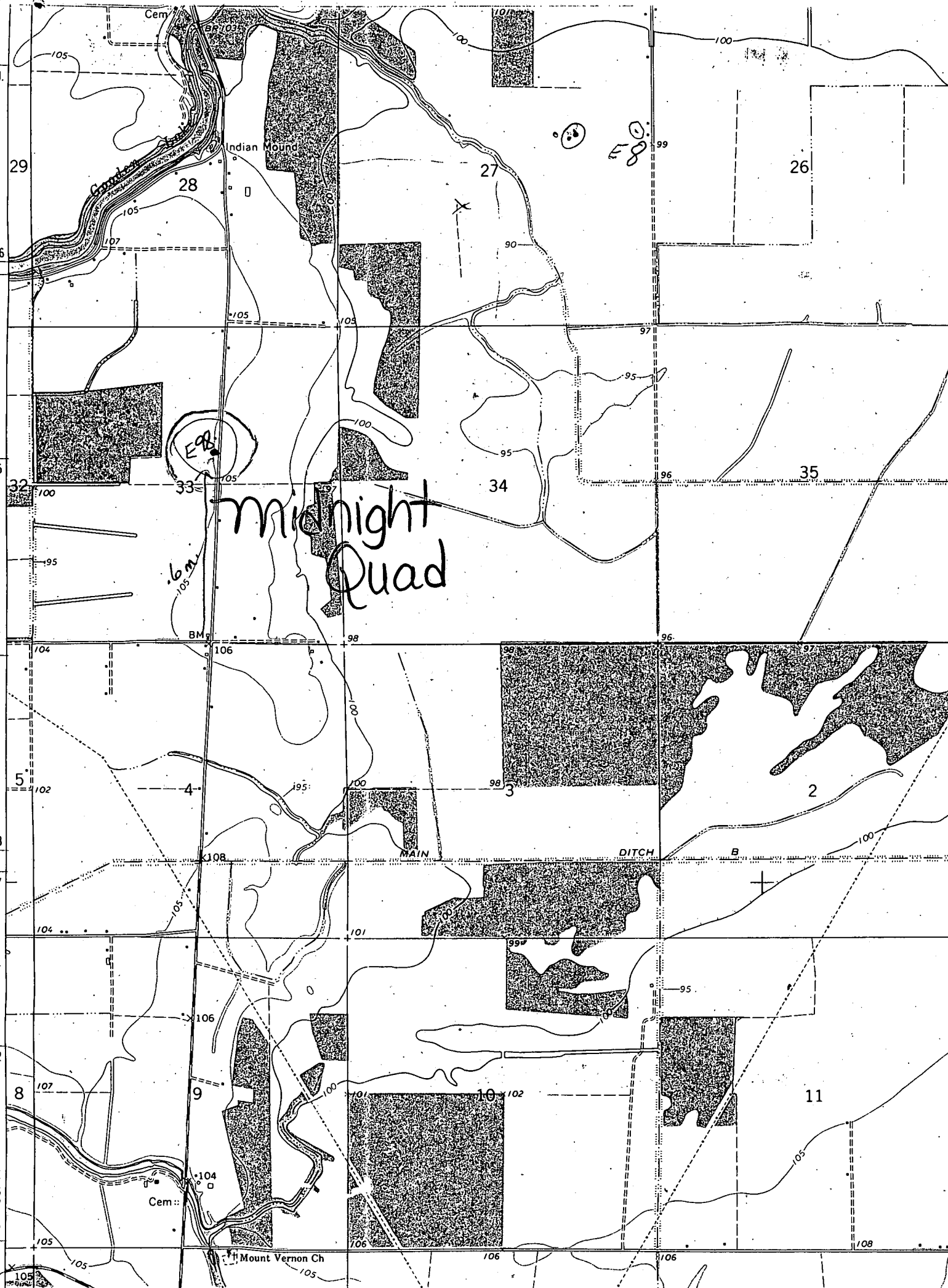

Cem  
Indian Mound

Midnight Quad

1.6 m.

BM

MAIN

DITCH

Cem

Mount Vernon Ch

EG

EG