

Correction - not

APR

PUNCHED

FORM 9-1642 (1-68)

Well No. E30

WELL SCHEDULE

U. S. DEPT. OF THE INTERIOR

GEOLOGICAL SURVEY

WATER RESOURCES DIVISION

MASTER CARD

Record by B.D. Source of data George Lewis Date 9-71 Map _____

State 28 County Hampshire (or town) 27

Latitude: 33^{deg} 06^{min} 59^{sec} N Longitude: 090^{degrees} 37^{min} 58^{sec} Sequential number: 1

Lat-long accuracy: 15^{sec} S, R 9^{sec} W Sec 27, SW Sec SW

Local well number: E0305-2915N04W Other number: _____ B & M

Local use: 087 Owner or name: South wall

Owner or name: E. R. JANOUS Address: Belmont

Ownership: County, Fed Gov't, City, Corp or Co, Private, State Agency, Water Dist P

Use of water: (A) Air cond, (B) Bottling, (C) Comm, (D) Dewater, (E) Power, (F) Fire, (G) Dom, (H) Irr, (I) Med, (J) P S, (K) Rec, (L) Stock, (M) Instit, (N) Unused, (O) Recharge, (P) Desal-P S, (Q) Desal-other, (R) Other U

Use of well: (A) Anode, (B) Drain, (C) Seismic, (D) Heat Res, (E) Obs, (F) Oil-gas, (G) Recharge, (H) Test, (I) Unused, (J) Withdraw, (K) Waste, (L) Destroyed. U

DATA AVAILABLE: Well data Freq. W/L meas.: Field aquifer char.

Hyd. lab. data: _____

Qual. water data; type: _____

Freq. sampling: _____ Pumpage inventory: yes no; period: _____

Aperture cards: _____ yes no

Log data: D

WELL-DESCRIPTION CARD

SAME AS ON MASTER CARD Depth well: 109 ft Meas. rept. accuracy 3

Depth cased: (first perf.) 56 ft Casing type: _____; Diam. 16x12 in

Finish: (C) porous concrete, (F) gravel w. (perf.), (G) gravel w. (screen), (H) horiz. gallery, (I) open end, (J) open perf., (K) screen, (L) sd. pt., (M) shored, (N) open hole, (O) other 5

Method: (A) air bored, (B) cable, (C) dug, (D) hyd jetted, (E) air rot., (F) reverse percussion, (G) trenching, (H) driven, (I) drive wash, (J) other H

Date Drilled: 9-60 Pump intake setting: _____ ft

Driller: Burton - G.W.

Lift (type): (A) air, (B) bucket, (C) cent, (D) jet, (E) multiple, (F) multiple, (G) none, (H) piston, (I) rot, (J) submerg, (K) turb, (L) other T Deep Shallow

Power (type): (A) diesel, (B) elec, (C) gas, (D) gasoline, (E) hand, (F) gas, (G) wind; H.P. Trans. or meter no. _____

Descrip. MP _____ ft above LSD, Alt. MP _____

Alt. LSD: _____ Accuracy: (source) _____

Water Level: 16 ft above MP; Ft below LSD 16 Accuracy: _____

Date meae: N:60 Yield: _____ gpm Method determined _____

Drawdown: _____ ft Accuracy: _____ Pumping period _____ hrs

QUALITY OF WATER DATA: Iron _____ ppm Sulfate _____ ppm Chloride _____ ppm Hard. _____ ppm

Sp. Conduct _____ K x 10⁶ Temp. _____ °F Date sampled _____

Taste, color, etc. _____

Well No. E30

HYDROGEOLOGIC CARD

SAME AS ON MASTER CARD **Physiographic Province:** 03 **Section:** _____
Drainage Basin: E **Subbasin:** 15H

Topo of well site: (D) depression, stream channel, dunes, flat, hilltop, sink, swamp, (E) (F) (R) (K) (L) (P) (S) (T) (U) (V) offshore, pediment, hillside, terrace, undulating, valley flat

MAJOR AQUIFER: system _____ series 06 aquifer, formation, group MIA

Lithology: _____ **Origin:** 2 **Aquifer Thickness:** 55 ft

Length of well open to: _____ ft 48 **Depth to top of:** _____ ft 49

MINOR AQUIFER: system _____ series _____ aquifer, formation, group _____

Lithology: _____ **Origin:** _____ **Aquifer Thickness:** _____ ft

Length of well open to: _____ ft _____ **Depth to top of:** _____ ft _____

Intervals Screened: 12"

Depth to consolidated rock: _____ ft _____ **Source of data:** _____

Depth to basement: _____ ft _____ **Source of data:** _____

Surficial material: _____ **Infiltration characteristics:** _____

Coefficient Trans: _____ gpd/ft _____ **Coefficient Storage:** _____

Coefficient Perm: _____ gpd/ft²; **Spec cap:** _____ **gpm/ft; Number of geologic cards:** _____

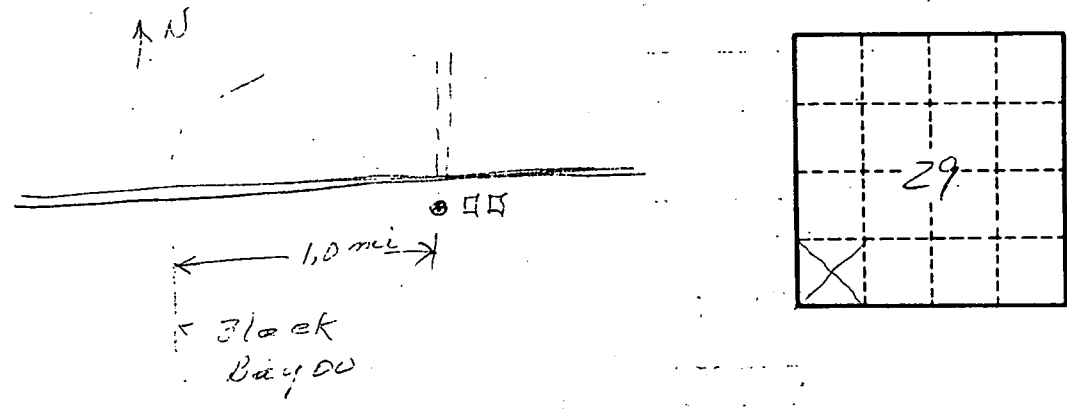

Well No. 03