

Co. map

Bellewood and GW 10145? 1/81
TRANSMITTED FOR ADP

Bellewood

Recorded by WTO
Date 1/87
Agency USGS

U.S. GEOLOGICAL SURVEY
WATER RESOURCES DIVISION
MISSISSIPPI DISTRICT

Well No. C133
E-Log No. _____
County Humphreys
R.D. Bearden

WELL RECORD

GEN SITE DATA

Site Id 33114360903411401 R=0* T=A* 2=W* Data reliab. 3=U* C U

Dist. 6=28* State 7=28* Co. 8=053* Lat. Long. 9=33114361* 10=09034141*

Well NO. 12=C133* Location 13=S SW 1/2 T 16 N R 04 W* 14=SW NW 15=2* 16=110* 17=110*

Hyd. Unit (OWDC) 20=081030207* Date 21=1986105101* (YYYYMMDD) 17=M*

Agency Use 803=Φ* Well Use 23=W* Water Use 24=Q* Hole depth 27= _____* Well depth 28=11780*

WL 30=143.0* Date 31=1987101109* Source 33=S* Flow 37=1*

Project No. 5= _____*

LIFT

R=42* T=A* 254#1* Date 38=1986105101* Lift Type 43#T* Intake 44= _____*

Power Type 45=E* H.P. 46=110*

CONSTR.

R=58* T=A* 723#1* Date 60=1986105101* Drlg 63=405* Name Larry's well + pump

Method 65=H* Finish 66=S* Remarks _____

CASING

R=76* T=A* 725#1* 59#1* Top csng 77# _____ 0.* Bot. csng 78= _____* Diam. 79# 8*

R=76* T=A* 725#2* 59#1* Top csng 77# _____* Bot. csng 78= _____* Diam. 79# _____*

OPENINGS

R=82* T=A* 726#1* 59#1* Top 83# 1720* Bottom 84=1780* Type 85=S*

Diam. 87=4* Size 88= _____*

R=82* T=A* 726#2* 59#1* Top 83# _____* Bottom 84= _____* Type 85= _____*

87= _____* 88= _____*

AQUIFERS

R=90* T=A* 721#1* Top 91= _____* Bot 92= _____* Unit Id 93=124WLCXM*

R=90* T=A* 721#2* Top 91= _____* Bot 92= _____* Unit Id 93= _____*

HYDRAULICS

R=98* T=A* 99#1* Unit tested 100= _____* 103= _____*

R=105* T=A* 99#1* Test No. 106# _____* 107= _____* Transmissivity (gal/d)/ft _____

108= _____* Hydraul. cond. (gal/d)/ft² _____ 110= _____* Storage coeff. Boundaries _____

ANAL. R=114* T=A* 706= Q/W * Year 115# 1987 * 117= USGS * 120= B *

R=121* T=A* Yr Begin 115# * Network 257# *

YIELD: R=146* T=A* Flow/Pumped (circle one) 147#1* 148= 1986/05/01 * 150= 250. *
Q/S 272= * *

OWNER R=158* T=A* 718#1* Date 159# 1986/05/01 * Owner No. *
Owner 161# R-DI BEARDEN * *

WATER ID R=189* T=A* 736#1* E-Log No. 190# * 191= M I S S I S S I D I S T *

FIELD QW R=192* T=A* 738#1* Date 193# 1987/01/09 * Temp 196#00010* 197= 32.5 *

R=192* T=A* 738#2* Date 193# 1987/01/09 * Cond 196#00095* 197= 150. *

R=192* T=A* 738#3* Date 193# 1987/01/09 * pH 196#00400* 197= 8.3 *

LOGS R=198* T=A* 739#1* Log 199# * Top 200= * Bot 201= *

R=198* T=A* 739#2* 199# * 200= * 201= *

Remarks: R=183# 311= / / / / / *

184: Hatchery #962-7261
Flowed 100gpm
#12
On old Hwy 49 about 1 1/2 mile SE of Isola

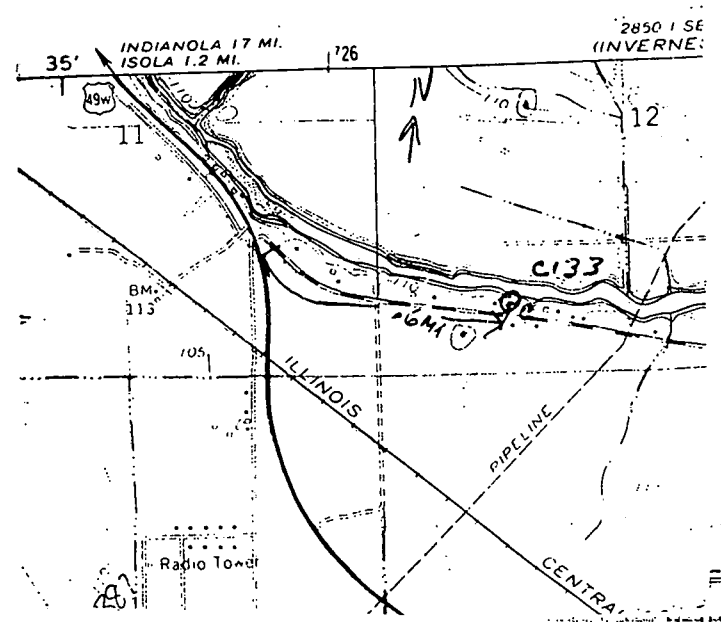

WILCOX DATA SHEET-VERIFICATION CHECKLIST

COUNTY HUMPHREYS

Bellewood Quad

WELL OWNER R. D. Blonquin

CHECKED

U.S.G.S. NO. C-133

8/5/94

B.O.H. NO. N/A

8/5/94

OLWR NO. _____

LOCATION:

MAP SW, NW, SE, SW S 12, T 16 N, R 4 W

8/5/94

GPS ✓

ELEV. (MSL) 110'

8/5/94

W.L. (L.S.) (1) + 29'

8/5/94

(2) _____

HEAD (MSL) + 139'

8/5/94

SCREENED INTERVAL 1,720' - 1,780' (L.S.) / - 1,610' - - 1,670' (MSL)

8/5/94

AQUIFER VERIFIED Meridian - Upper Wilcox

8/5/94

PREVIOUS W.L. + 43' (1987)

8/5/94

DATA ENTERED _____

724 | 725 35' | 726 | 2850 1 SE (INVERNESS) | R. 4 W. | R. 3 W | 728

INDIANOLA 17 MI.
ISOLA 1.2 MI.

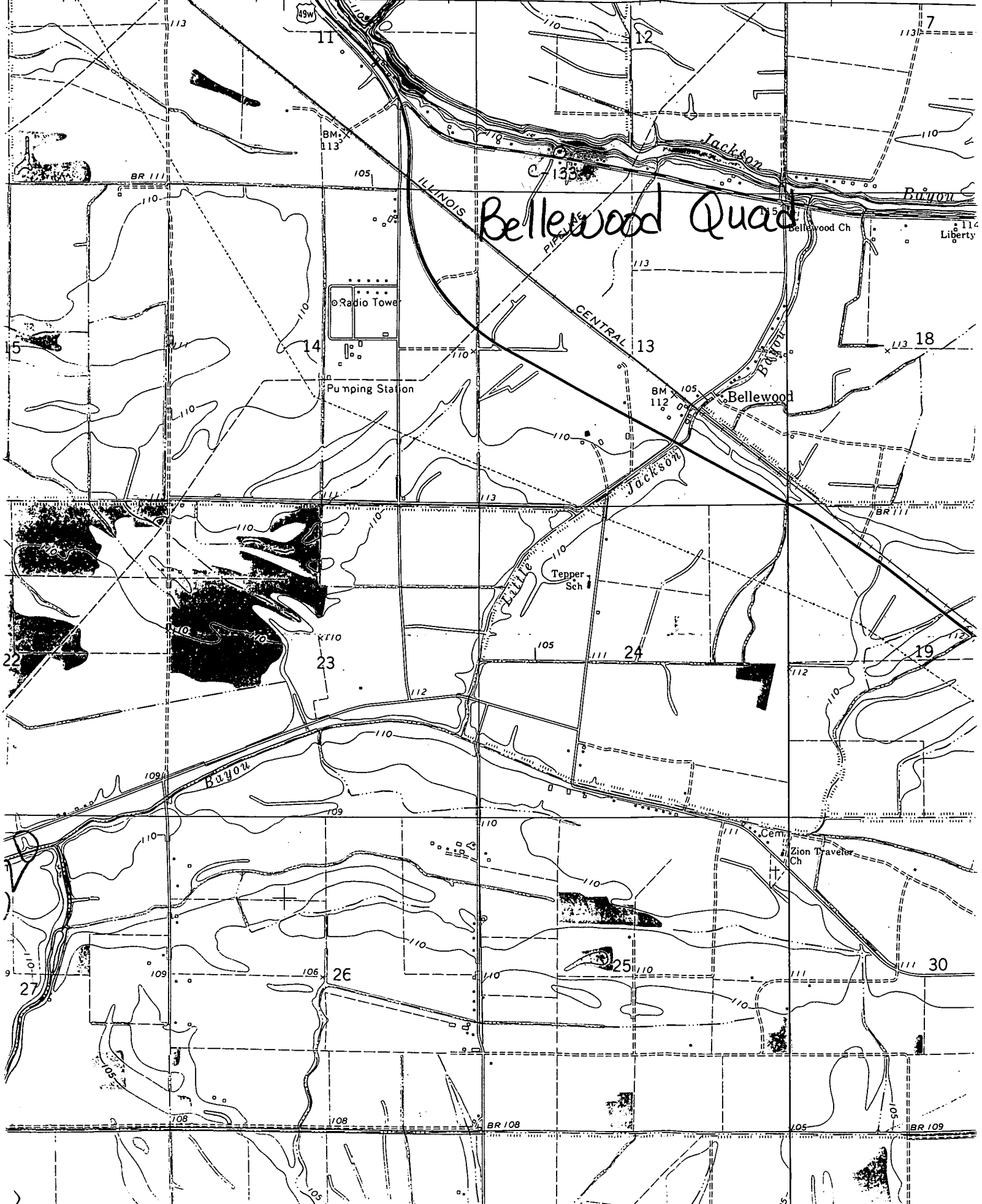

Bellewood Quad

Radio Tower

Pumping Station

Tepper Sch

Bellewood

Zion Traveler Ch

Liberty

ILLINOIS

CENTRAL

Jackson

Bayou

Bayou

Jackson

2E

25

30

BR 108

BR 109

BM 113

BM 112

22

27

7

5

18

19

30

14

13

23

24

12

7

11

18

19

30

27

2E

25

30

BR 108

BR 109

BM 113

BM 112

22

27

7

5

18

19

30

14

13

23

24

12

7

11

18

19

30

27

2E

25

30

BR 108

BR 109

BM 113

BM 112

22

27

7

5

18

19

30

14

13

23

24

12

7

11

18

19

30

27

2E

25

30

BR 108

BR 109

BM 113

BM 112

22

27

7

5

18

19

30

14

13

23

24

12

7

11

18

19

30

27

2E

25

30

BR 108

BR 109

BM 113

BM 112

22

27

7

5

18

19

30

14

13

23

24

12

7

11

18

19

30

27

2E

25

30

BR 108

BR 109

BM 113

BM 112

22

27

7

5

18

19

30

14

13

23

24

12

7

11

18

19

30

27

2E

25

30

BR 108

BR 109

BM 113

BM 112

22

27

7

5

18

19

30

14

13

23

24

12

7

11

18

19

30

27

2E

25

30

BR 108

BR 109

BM 113

BM 112

22

27

7

5

18

19

30

14

13

23

24

12

7

11

18

19

30

27

2E

25

30

BR 108

BR 109

BM 113

BM 112

22

27

7

5

18

19

30

14

13

23

24

12

7

11

18

19

30

27

2E

25

30

BR 108

BR 109

BM 113

BM 112

22

27

7

5

18

19

30

14

13

23

24

12

7

11

18

19

30

27

2E

25

30

BR 108

BR 109

BM 113

BM 112

22

27

7

5

18

19

30

14

13

23

24

12

7

11

18

19

30

27

2E

25

30

BR 108

BR 109

BM 113

BM 112

22

27

7

5

18

19

30

14

13

23

24

12

7

11

18

19

30

27

2E

25

30

BR 108

BR 109

BM 113

BM 112

22

27

7

5

18

19

30

14

13

23

24

12

7

11

Digitized 2-4-03

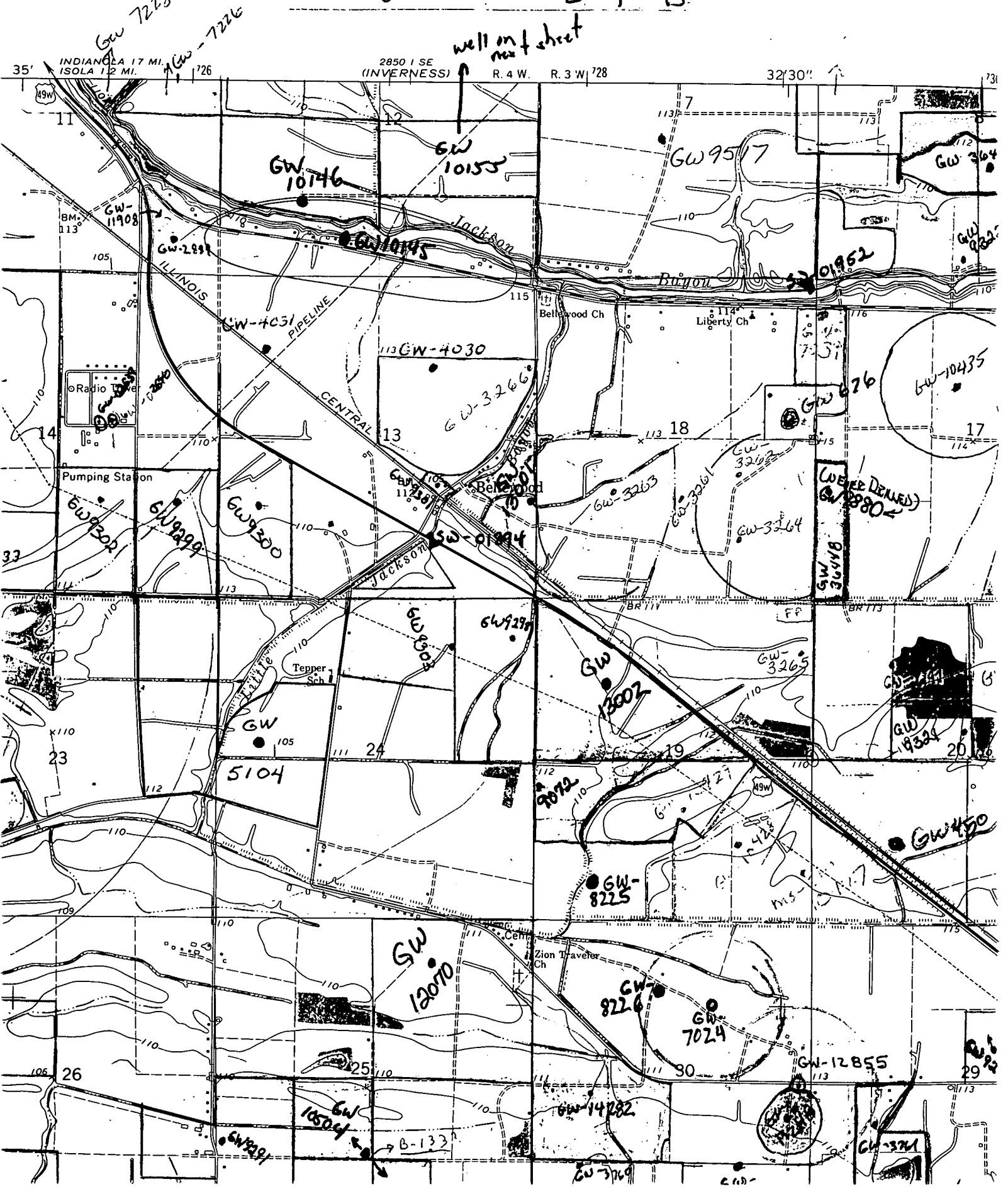

well on sheet

2850 1 SE (INVERNESS) R. 4 W. R. 3 W. 728

32'30"

35'

INDIANOLA 17 MI.
ISOLA 12 MI.

GW 7228
GW-7226

GW 10146

GW 10155

GW 9517

GW 364

GW-11908

GW-2891

GW-10145

GW-01952

GW-4031

GW-4030

GW 676

GW-10435

Pumping Station

GW-10130

GW-10199

GW-300

GW-01994

GW-3263

GW-3262

GW-3264

WELL DELETED
GW-1890

GW-300

GW-929

GW 18002

GW-3265

GW-1851

GW 18324

5104

7072

GW-8225

GW-450

GW 12070

Zion Traveler Ch

GW 8226

GW 7024

GW-12855

26

GW 10504

GW-14282

GW-3769

GW-3371

49W

BM 113

Radio

33

23

709

105

106

11

105

10

110

110

110

110

110

12

110

110

110

110

110

110

110

13

110

110

110

110

110

110

110

14

110

110

110

110

110

110

110

17

110

110

110

110

110

110

110

18

110

110

110

110

110

110

110

19

110

110

110

110

110

110

110

20

110

110

110

110

110

110

110

21

110

110

110

110

110

110

110

22

110

110

110

110

110

110

110

23

110

110

110

110

110

110

110

24

110

110

110

110

110

110

110

25

110

110

110

110

110

110

110

26

110

110

110

110

110

110

110

27

110

110

110

110

110

110

110

28

110

110

110

110

110

110

110

29

110

110

110

110

110

110

110

30

110

110

110

110

110

110

110

31

110

110

110

110

110

110

110

32

110

110

110

110

110

110

110

33

110

110

110

110

110

110

110

34

110

110

110

110

110

110

110

35

110

110

110

110

110

110

110

36

110

110

110

110

110

110

110

37

110

110

110

110

110

110

110

38

110

110

110

110

110

110

110

39

110

110

110

110

110

110

110

40

110

110

110

110

110

110

110

41

110

110

110

110

110

110

110

42

110

110

110

110

110

110

110

43

110

110

110

110

110

110

110

44

110

110

110

110

110

110

110

ILLINOIS

CENTRAL

JACKSON

Jackson

Bigyon

Tepper Sch

Bellewood

Liberty Ch

Bellewood Ch

Zion Traveler Ch

B-133

GW 3648

GW 3649

GW 3650

GW 3651

GW 3652

GW 3653

GW 3654

GW 3655

GW 3656