

6/78 WTO

U.S. GEOLOGICAL SURVEY
WATER RESOURCES DIVISION
MISSISSIPPI DISTRICT
WELL RECORD

TRANSMITTED FOR ADP

5/80

Belzoni
C58

Recorded by

WTO

Well No.

Date

11/26/79

E-Log No.

County

Humphreys

Site ID

3.3 1.4 2.3 0.9 0.2 9.3 4.0 1

R=0*

T=A*

2=W*

BELZONI 168A

Data reliab.

3=U*

Report. agency

4=USGS*

Dist.

6=28*

7=28*

Co.

8=0.53*

Lat.

Long./

9=33 1.4 2.3

10=0.9 0.2 9.3 4

Well No.

12=C058*

Location

13=SE NW SE SE S 18 T 16 N R 0.3 W*

Alt.

16=115. * 112.

Hyd. Unit (OWDC)

20=

Date

21=10/04/1979*

Well use

23=W*

Water Use

24=H*

Hole depth

27=800.*

Well depth

28=800.*

WL

30=20.*

Date

31=10/04/1979*

Source

33=D*

11/11/80

Status

273=

Project No.

5=

WL MP - 25.27
MP - top of casing
.3 PLSD
WL LSD - 24.97

R=158*

T=A*

Date

159# 10/04/1979*

Owner No.

Owner

161=MRS. W. L. HARPER

116
25
91

R=192*

T=A*

Date

193# / / *

Temp.

196#00010*

197=

R=192*

T=A*

Date

193# / / *

Cond.

196#00095*

197=

R=192*

T=A*

Date

193# / / *

pH

196#00400*

197=

R=58*

T=A*

59# 1*

Date

60=10/04/1979*

Remarks

Drlg.

63=40.5*

Name

Larry's

Method

65=H*

Finish

66=S*

R=76*

T=A*

59# 1*

Top csng.

77# 0.*

Bot. csng.

78=140.*

Diam.

79# 4.*

R=76*

T=A*

59# 1*

Top csng

77# 140.*

Bot. csng.

78=780.*

Diam.

79# 2.*

R=82*

T=A*

59# 1*

Top

83# 780.*

Bottom

84=800.*

Type

85=S*

Diam.

87=2.*

Size

88=

R=82*

T=A*

59# 1*

Top

83#

Bottom

84=

Type

85=

Diam.

87=

Size

88=

YIELD

R=146*

T=A*

147# 1*

Q

150=20.*

Q/S

272=

134 flows 146 pumped

LIFT

R=42* T= A * Lift type 43# S* Intake 44= * Power type 45= E*

Date 38= 10/04/1979* H.P. 46= 1.*

LOGS

R=198* T= A * Log 199# D* Top 200= 0.* Bot 201= 800.*

R=198* T= A * Log 199# * Top 200= * Bot 201= *

R=189* T= A * E Log No. 190# * 191= M I S S D I S T *

ANAL.

R=114* T= A * Year 115# * Type 120= *

AQUIFERS

R=90* T= A * 256# 1 * Top 91= 750.* Bot 92= 800.*

Unit ID 93= 124SPRT * Name of Unit

R=90* T= A * 256# 1 * Top 91= * Bot 92= *

Unit ID 93= * Name of Unit

HYDRAULICS

R=98* T= A * 99# 1 * Unit tested 100= * 103= *

R=105* T= A * 99# 1 * Test No. 106# *

107= * Transmissivity (gal/d)/ft

108= * Hydraul. cond. (gal/d)/ft²

110= * Storage coeff. Boundaries

R=121* T= * Yr Begin 122# * Network 258= *

Water Level Data Collection (1)

description of formations encountered	from	to
clay	0'	10'
clay	15'	30'
th. coarse sand	35'	70'
fine sand + silty sand	75'	1'
fine sand + silty, calc.	90'	16'
clay	160'	2'
clay + sand	230'	70'
white coarse sand	250'	9'

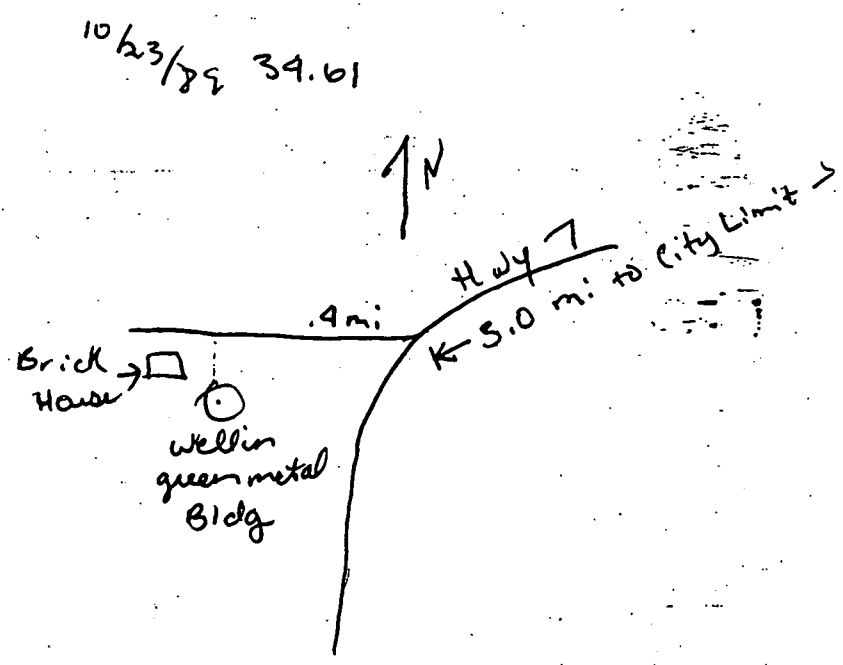

Humphreys
C-58
10-4-1979

MISSISSIPPI
 BOARD OF WATER COMMISSIONERS
 416 North State Street
 Jackson, Mississippi 39201

CODED

WATER WELL DRILLERS LOG

10-4-79 19 79 Lewis Well Pump Co Humphreys
 date well completed firm name county well located

LANDOWNER: <u>ms W L Hayes</u>	description of formations encountered	from	to
<u>Belzoni miss</u> (mailing address)			
WELL LOCATION: sec. <u>15</u> T. <u>16</u> N. R. <u>3</u> E <u>4</u> miles <u>north</u> of <u>Belzoni</u> (distance) (direction) (nearest town)	<u>br clay</u>	<u>0'</u>	<u>15'</u>
	<u>br clay</u>	<u>15'</u>	<u>39'</u>
	<u>th cone sand</u>	<u>39'</u>	<u>78'</u>
	<u>th cone sand + sh sand</u>	<u>75'</u>	<u>92'</u>
	<u>th cone sand + sh, rocks</u>	<u>92'</u>	<u>160'</u>
	<u>clay</u>	<u>160'</u>	<u>230'</u>
WELL PURPOSE: (home, irrigation, municipal, industrial)	<u>clay + sand</u>	<u>230'</u>	<u>750'</u>
	<u>white cone sand</u>	<u>750'</u>	<u>800'</u>
WELL COMPLETION DATA: (1) diameter (inches) <u>4 1/2"</u> (2) total depth (feet) <u>800'</u> (3) static water level (feet) <u>20'</u> <u>below</u> top of ground. (4) casing <u>plastic</u> , <u>780'</u> (material) (depth) (size) if telescope see back. (5) screen <u>20'</u> , <u>780'</u> (length) (depth to top) <u>2"</u> , <u>plastic</u> (size) (material) (6) pump <u>1</u> , <u>20</u> (HP) (yield gpm) <u>Electric</u> (type power) (7) electric log <u> </u> (yes or no) (organization running log) (8) how well bottom plugged <u>Washed</u>			
DRILLERS REMARKS:			

DEPT. OF NATURAL RESOURCES
 BUREAU OF LAND & WATER RESOURCES

NOV 15 1979

RECEIVED

SPARTA DATA SHEET-VERIFICATION CHECKLIST

COUNTY HUMPHREYS

QUAD: BELZONI

WELL OWNER MRS W.L. HARPER

CHECKED

U.S.G.S. NO. C-58

EJB
11-7-95

B.O.H. NO. _____

OLWR NO. _____

LOCATION:

MAP (SE, NW, SE, SE S10, T16N, R3W)

✓

GPS _____

ELEV. (MSL) 112'

✓

W.L. (L.S.) (1) -34.2' 5-10-95

✓

(2) -34.2' "

✓

HEAD (MSL) 77.8'

✓

SCREENED INTERVAL 780'-800' (LS) / -668' - -688' (MSL)

✓

AQUIFER VERIFIED SPARTA

✓

PREVIOUS W.L. -34.61' (10/23/89) / -24.97' (11/11/80) / -20' (10/4/79)

✓

DATA ENTERED _____

33°15'

734000mE

SWIFTTOWN 5 MI.

736

27°30" R3W R2W

10

Jaketown

11

12

C58

3681000mN

Floodgate

Belzoni Quad

Public Access

15

14

13

Ole Lake

3680

BM 117

Macedonia Ch

Wasp

Cem Mt E

Shiloh-D Ch

3679

17-22

23

24

Lake

3678

Well

X112

Well

Fisk

Mt Zion Cem

EDWARDS LANDING STRIP

Well

27

Well

26

Well

25

12°30"

3676

Fairground

Bayou

BR 112

BR 114

INDIANOLA 23 MI
BELLEWOOD 4.5 MI

7

10