

Bellewood

6778 WTO

Recorded by GVD  
Date 3-20-1979

U.S. GEOLOGICAL SURVEY USCE  
WATER RESOURCES DIVISION L12Y1  
MISSISSIPPI DISTRICT  
WELL RECORD

Well No. C52  
E-Log No. \_\_\_\_\_  
County HUMPHREYS

GEN. SITE DATA

Site ID 331217090310801 R=0\* T=A\* 2=W\*

Data reliab. 3=C\* Report. agency 4=USGS\* Dist. 6=28\* 7=28\* Co. 8=053\*

Lat. \_\_\_\_\_ Long. 9=331217\* 10=0903108\* Well No. 12=C052\*

Location SE SE 13=SWNW, S 28 T, 16 N, R 03 W\* Alt. 16=113.56\*

Hyd. Unit (OWDC) 20= Date 21=0210111979\*

Well use 23=0\* Water Use 24=U\* Hole depth 27= Well depth 28=59.0\*

WL 30=23.0\* Date 31=0212811979\* Source 33=S\*

Status 273= Project No. 5=056\*

OWNER

R=158\* T=A\* Date 159#0210111979\* Owner No. \_\_\_\_\_

Owner 161=USCE L12Y1\*

FIELD CW

R=192\* T=A\* Date 193# Temp. 196#00010\* 197=

R=192\* T=A\* Date 193# Cond. 196#00095\* 197=

R=192\* T=A\* Date 193# pH 196#00400\* 197=

CONSTR.

R=58\* T=A\* 59#1\* Date 60=0210111979\* Remarks \_\_\_\_\_

Drig. 63= Name USCE Method 65=H\* Finish 66=S\*

CASING

R=76\* T=A\* 59#1\*

Top csng. 77# -3.0\* Bot. csng. 78=56.0\* Diam. 79# 1.5\*

R=76\* T=A\* 59#1\*

Top csng 77# Bot. csng. 78= Diam. 79#

OPENINGS

R=82\* T=A\* 59#1\* Top 83# 56.0\* Bottom 84=59.0\*

Type 85=C\* Diam. 87=1.5\* Size 88=.010\*

R=82\* T=A\* 59#1\* Top 83# Bottom 84=

Type 85= Diam. 87= Size 88=

YIELD

R= T=A\* 147# 1\* Q 150= Q/S 272=

134 flows 146 pumped

LIFT

R=42\* T= A \* Lift type 43# \* Intake 44= \* Power type 45= \*

Date 38= / / H.P. 46= \*

LOGS

R=198\* T= A \* Log 199# \* Top 200= \* Bot 201= \*

R=198\* T= A \* Log 199# \* Top 200= \* Bot 201= \*

R=189\* T= A \* E Log No. 190# \* 191= M I S S D I S T \*

ANAL.

R=114\* T= A \* Year 115# \* Type 120= \*

AQUIFERS

R=90\* T= A \* 256# 1 \* Top 91= \* Bot 92= \*

Unit ID 93= 112MRYA \* Name of Unit \_\_\_\_\_

R=90\* T= A \* 256# 1 \* Top 91= \* Bot 92= \*

Unit ID 93= \* Name of Unit \_\_\_\_\_

HYDRAULICS

R=98\* T= A \* 99# 1 \* Unit tested 100= \* 103= \*

R=105\* T= A \* 99# 1 \* Test No. 106# \*

107= \* Transmissivity (gal/d)/ft \_\_\_\_\_

108= \* Hydraul. cond. (gal/d)/ft<sup>2</sup> \_\_\_\_\_

110= \* Storage coeff. Boundaries \_\_\_\_\_

R=121\* T= \* Yr Begin 122# \* Network 258= \*

Water Level Data Collection (1)

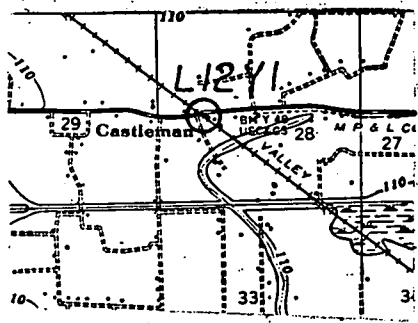

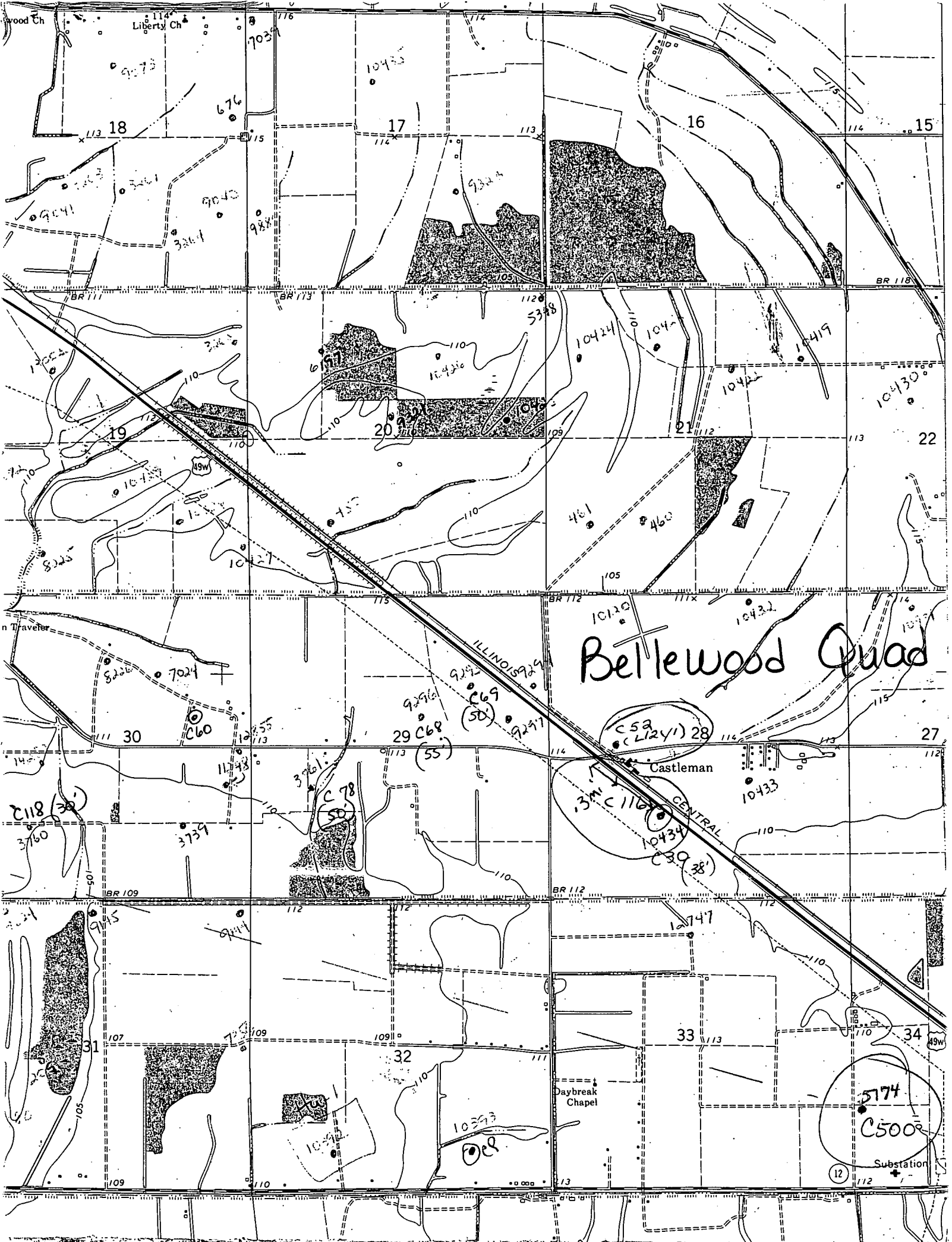

# Bellewood Quad

C 53  
(L 241) 28

Castleman

C 110  
CENTRAL  
C 39 (38)

C 78  
SD

29 C 68  
(55)

(50)

5174  
C 500

Substation

Daybreak  
Chapel

