

Metzer Perm. Test

9-185-July 1935  
Revised

UNITED STATES B. 1.2 NW  
DEPARTMENT OF THE INTERIOR  
GEOLOGICAL SURVEY  
WATER RESOURCES BRANCH

WELL SCHEDULE

Date \_\_\_\_\_, 19\_\_\_\_ Field No. \_\_\_\_\_  
Record by \_\_\_\_\_ Office No. C7  
Source of data \_\_\_\_\_

1. Location: State Miss. County Humphreys  
Map Antler Quad

SW SE 1/4 SE SW 1/4 sec. 3334 T 16 N R 3 E W

2. Owner: S. A. Barrett Address Belzoni

Tenant \_\_\_\_\_ Address \_\_\_\_\_

Driller Carlloss Address \_\_\_\_\_

3. Topography \_\_\_\_\_

4. Elevation \_\_\_\_\_ ft. above  
\_\_\_\_\_ ft. below

5. Type: Dug, (filled) driven, bored, jetted June 1955

6. Depth: Rept. 120 ft. Meas. \_\_\_\_\_ ft.

7. Casing: Diam. 16 in., to 12 in., Type \_\_\_\_\_

Depth 80 ft., Finish 40'

8. Chief Aquifer \_\_\_\_\_ From \_\_\_\_\_ ft. to \_\_\_\_\_ ft.

Others \_\_\_\_\_

9. Water level 16.0 ft. (rept. meas.) June 1955 above  
\_\_\_\_\_ below

10. Pump: Type Worth turbine Capacity \_\_\_\_\_ ft. (above below) surface

Power: Kind Diesel Horsepower \_\_\_\_\_ G. M.

11. Yield: Flow \_\_\_\_\_ G. M., Pump 2000 G. M., Meas., (Rept. Est. 6/55)

Drawdown \_\_\_\_\_ ft. after \_\_\_\_\_ hours pumping \_\_\_\_\_ G. M.

12. Use: Dom., Stock, PS., RR., Ind. (Irr.) Obs. Cotton

Adequacy, permanence \_\_\_\_\_

13. Quality \_\_\_\_\_ Temp \_\_\_\_\_ °F.

Taste, odor, color \_\_\_\_\_ Sample Yes \_\_\_\_\_ No \_\_\_\_\_

Unfit for \_\_\_\_\_

14. Remarks: (Log, Analyses, etc.) Daybreak Rd. N. side of  
rd. just beyond subst.  
Redrilled

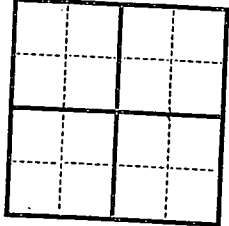

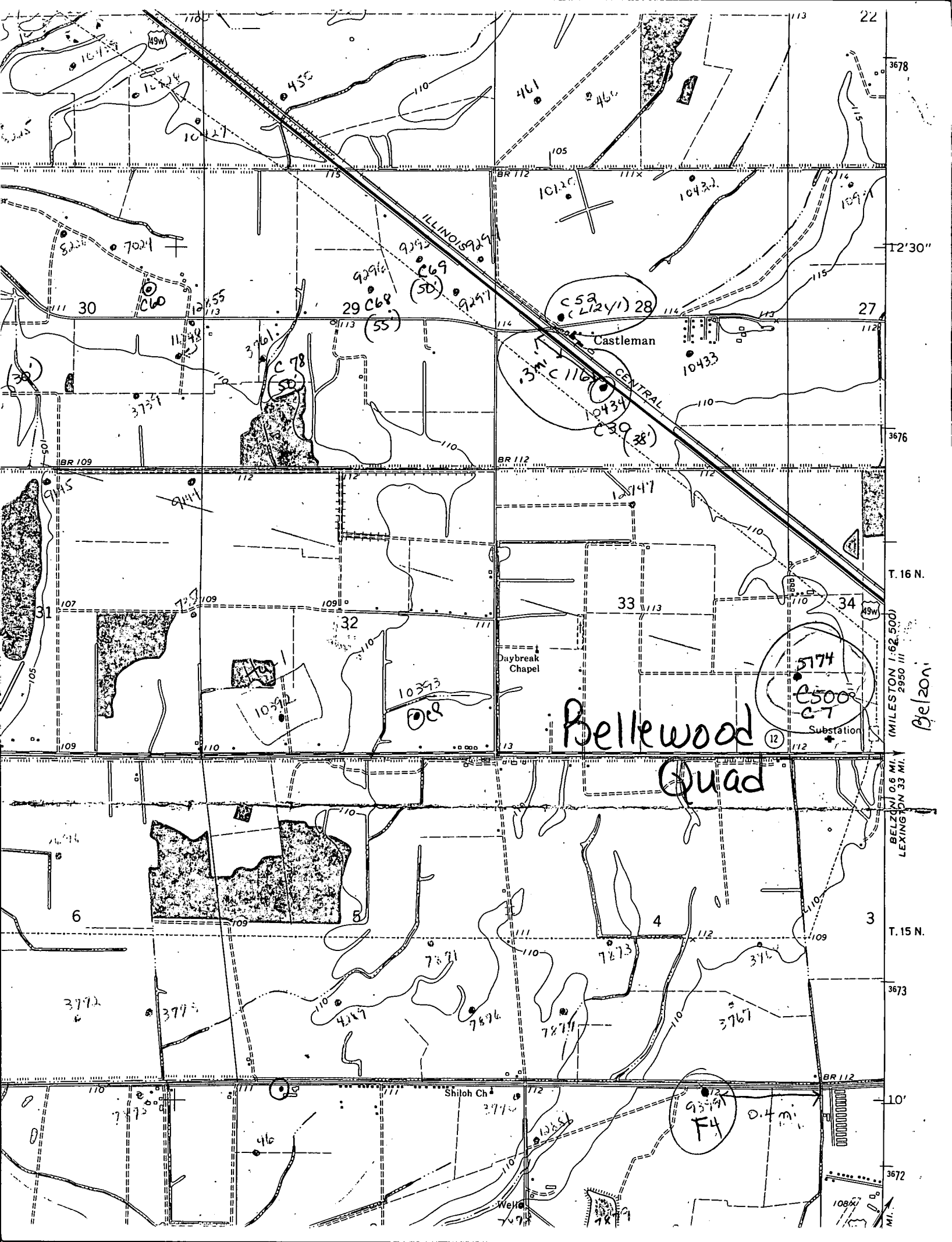

Bellewood Quad

T. 16 N.  
MILESTON 1.62 500  
2950 III  
Belzoni  
T. 15 N.  
0.6 MI.  
LEXINGTON 33 MI.

Castleman  
CENTRAL  
C59 (L1241) 28  
C116  
C39 (38)

5774  
C500  
C7  
Substation

9349  
F4  
0.4 mi.

Shiloh Ch.

Wells