

1/81 WFO

Recorded by W. Hunt by Quad

U.S. GEOLOGICAL SURVEY
WATER RESOURCES DIVISION
MISSISSIPPI DISTRICT
WELL RECORD

midnight NW

Well No. B122

Date 9/3/81

E-Log No. _____

This well was called B125,
but can't be

County Humphrey
Midnight NW

Site ID 3.3.1.4.3.2.0.9.0.4.0.0.3.0.1 R=0* T=A* 2=W*

Data reliab. 3=U Report. agency 4=USGS* Dist. 6=28* 7=28* Co. 8=0.5.3*

Lat. _____ Long. 9=3.3.1.4.3.2* 10=0.9.0.4.0.3* Well No. 12=B.1.2.2*

Location 13=NE NW S. 1.3. T. 1.6. N. R. 0.5. W. * Alt. 16=140.6.* 113 ← elev of ponds

Hyd. Unit (OWDC) 20= Date 21=0.7.1.2.2.1.19.8.1.*

Well use 23=W* Water Use 24=Q* Hole depth 27=116.* Well depth 28=116.*

WL 30=23.* Date 31=0.7.1.2.2.1.19.8.1.* Source 33=D*

Status 273= Project No. 5=

R=158* T=A* Date 159# 0.7.1.2.2.1.19.8.1.* Owner No. _____

Owner 161# BEARDEN

R=192* T=A* Date 193# Temp. 196#00010* 197=

R=192* T=A* Date 193# Cond. 196#00095* 197=

R=192* T=A* Date 193# pH 196#00400* 197=

R=58* T=A* 59# 1* Date 60=0.7.1.2.2.1.19.8.1.* Remarks _____

Drig. 63=4.0.5.* Name LARRY'S WELL Method 65=R* Finish 66=S*

R=76* T=A* 59# 1* Steel

Top csng. 77# 0.* Bot. csng. 78=7.6.* Diam. 79# 1.6.*

R=76* T=A* 59# 1*

Top csng 77# Bot. csng. 78= Diam. 79#

R=82* T=A* 59# 1* Top 83# 7.6.* Bottom 84=1.1.6.*

Type 85=L* Diam. 87=1.6.* Size 88=

R=82* T=A* 59# 1* Top 83# Bottom 84=

Type 85= Diam. 87= Size 88=

R= 146* T=A* 147# 1* Q 150=3.0.0.0.* Q/S 272=

134 flows 146 pumped

GEN. SITE DATA

OWNER

FIELD QW

CONSTR.

CASING

OPENINGS

YIELD

LIFT

R=42* T= A * Lift type 43# T* Intake 44= * Power type 45= E*

Date 38= 0.7.22.19.81* H.P. 46= 6.0.*

LOGS

R=198* T= A * Log 199# D* Top 200= 0.* Bot 201= 1.16.*

R=198* T= A * Log 199# * Top 200= * Bot 201= *

R=189* T= A * E Log No. 190# * 191= M I S S D I S T *

ANAL.

R=114* T= A * Year 115# * 117= * 120= *

AQUIFERS

R=90* T= A * 256# 1 * Top 91= 2.8.* Bot 92= 1.16.*

Unit ID 93= 1.12.M.P.V.A. * Name of Unit Alluv.

R=90* T= A * 256# 1 * Top 91= * Bot 92= *

Unit ID 93= * Name of Unit

HYDRAULICS

R=98* T= A * 99# 1 * Unit tested 100= * 103= *

R=105* T= A * 99# 1 * Test No. 106# *

107= * Transmissivity (gal/d)/ft

108= * Hydraul. cond. (gal/d)/ft²

110= * Storage coeff. Boundaries

R=121* T= * Yr Begin 122# * Network 258# *

Water Level Data Collection (1)
6 miles W of Isola

description of formations encountered	from	to
Clay	0	28
Fine sand	28	56
Med. to Coars. sand	56	77.6

LIFT

R=42* T= A * Lift type 43# * Intake 44# * Power type 45# *
 Date 38- / / * H.P. 46# *

LOGS

R=198* T= A * Log 199# * Top 200# * Bot 201# *
 R=198* T= A * Log 199# * Top 200# * Bot 201# *
 R=189* T= A * E Log No. 190# * 191- M I S S D I S T *

ANAL.

R=114* T= A * Year 115# * 117# * 120# *

AQUIFERS

R=90* T= A * 256# 1 * Top 91# * Bot 92# *
 Unit ID 93# * Name of Unit _____
 R=90* T= A * 256# 1 * Top 91# * Bot 92# *
 Unit ID 93# * Name of Unit _____

HYDRAULICS

R=98* T= A * 99# 1 * Unit tested 100# * 103# *
 R=105* T= A * 99# 1 * Test No. 106# *
 107# * Transmissivity (gal/d)/ft _____
 108# * Hydraul. cond. (gal/d)/ft² _____
 110# * Storage coeff. Boundaries _____

R=121* T= * Yr Begin 122# * Network 258# *

Water Level Data Collection (1)

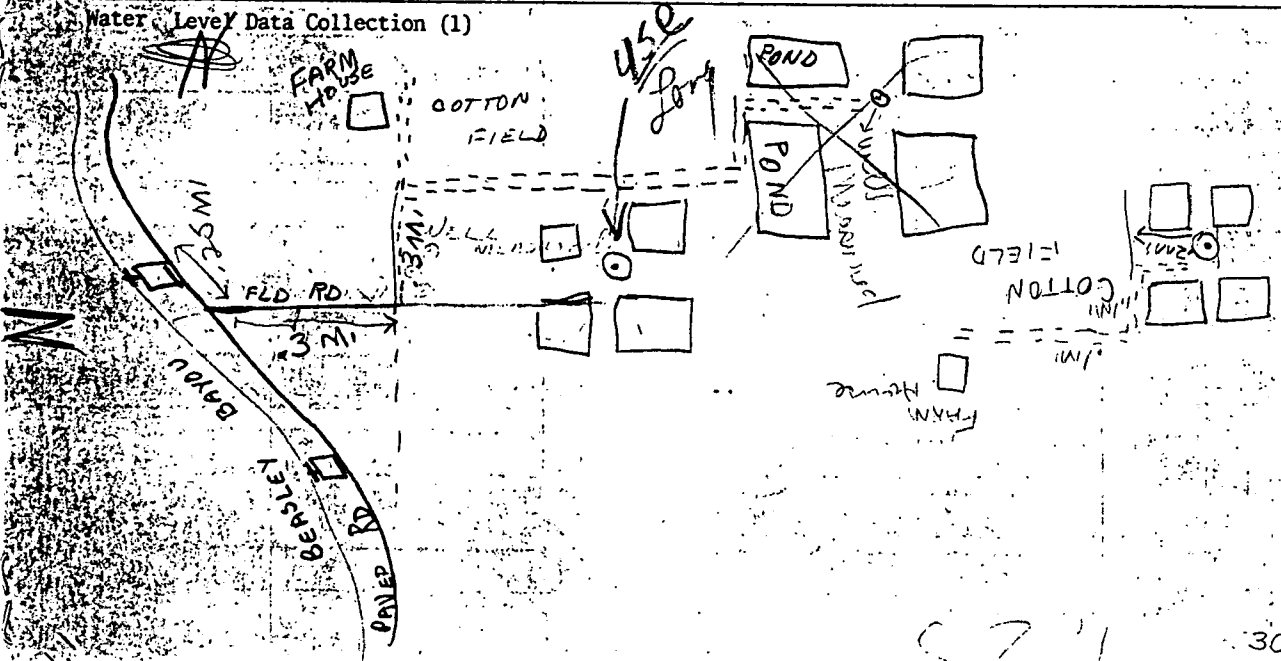

30.21 45.00
 50.9 9.31
 9.31 35.69

Humphreys
 B 122
 7-22-81
 GW 4036

MISSISSIPPI DEPARTMENT OF NATURAL RESOURCES
 Bureau of Land and Water Resources
 Southport Mall
 P.O. Box 10631
 Jackson, Mississippi 39209
 WATER WELL DRILLERS LOG

CODED

June 22 1981 date well completed
 Larry's well & Pump firm name
 Humphreys county well located

LANDOWNER:	description of formations encountered	from	to
Bearden			
<i>Arda</i> (mailing address)	Clay	0	28
	Fine Sand	28	56
	Melito Concrete	56	116

WELL LOCATION:
 sec. 13 T. 16 N R. 5 W
6 miles W of Arda
 (distance) (direction) (nearest town)

WELL PURPOSE: Fish Pond
 (home, irrigation, municipal, industrial)

- WELL COMPLETION DATA:
- (1) diameter (inches) 16"
 - (2) total depth (feet) 116
 - (3) static water level (feet) 23 below top of ground.
 - (4) casing Steel 76
 (material) (depth)
 - 16 if telescope see back.
 (size)
 - (5) screen 40 76
 (length) (depth to top)
 - 16 Steel
 (size) (material)
 - (6) pump 60 3000
 (HP) (yield gpm)
 - (type power)
 - (7) electric log No
 (yes or no)
 - (organization running log)
 - (8) how well bottom plugged Steel Plate

CODED

DEPT. OF NATURAL RESOURCES
 BUREAU OF LAND & WATER RESOURCES

JUL 16 1981

RECEIVED

DRILLERS REMARKS:

If well telescopes please sketch and show depths.

GROUND LEVEL

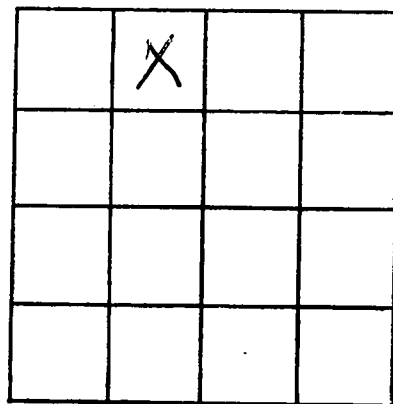

SECTION 13

Please indicate well location X.

ADDITIONAL INFORMATION

If more than one screen,
show locations of each on sketch.

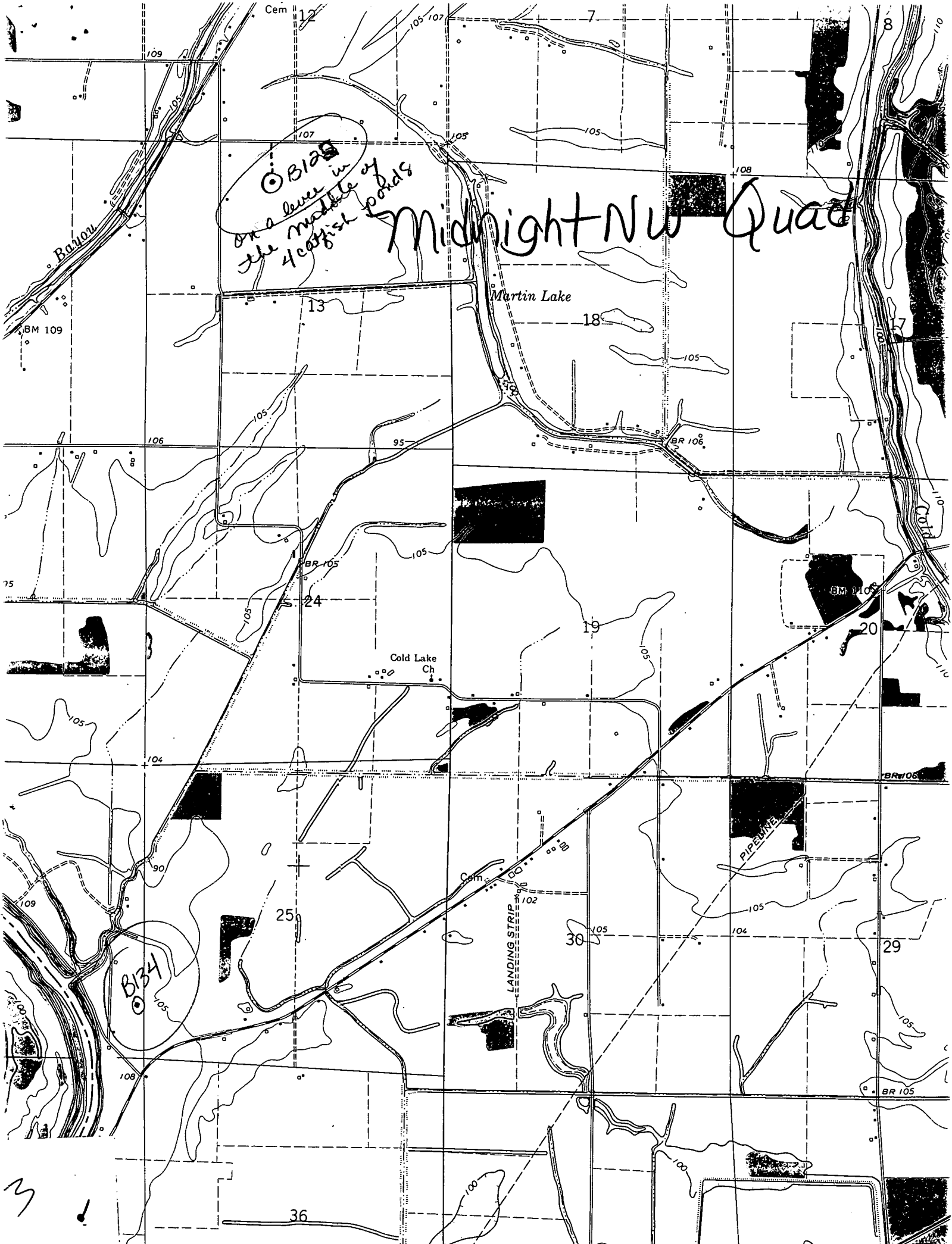

B128
on a levee in
the middle of
the 400 ft ponds

Midnight NW Quarter

B134

LANDING STRIP

PIPELINE

3

Cem 12

7

8

109

107

105

105

108

BM 109

13

Martin Lake

18

17

106

BR 105

Cold Lake
Ch

19

BM 105

20

104

24

105

BR 106

90

Cem

30

29

108

25

105

104

BR 105

36

100

100

BR 102

32