

6/78 WTO

*destroyed*

TRANSMITTED FOR ADP 3/81  
U.S. GEOLOGICAL SURVEY  
WATER RESOURCES DIVISION  
MISSISSIPPI DISTRICT  
WELL RECORD

Bellewood

Recorded by [Signature]

Date \_\_\_\_\_

Well No. B95

E-Log No. \_\_\_\_\_

County Humphrey

Site ID 3.31.102.09.033.32.01 R=0\* T=A\* 2=W\*  
5 19

Data reliab. 3=C\*<sup>C</sup> Report. agency 4=USGS\* Dist. 6=28\* 7=28\* Co. 8=053\*

Lat. \_\_\_\_\_ Long. 9=3.31.102\* 10=09.03332\* Well No. 12=095\*

Location 13=S 3.6 T 1.6 N R 0.4 W\* Alt. 16=104\*  
NESE

Hyd. Unit (OWDC) 20= \_\_\_\_\_ Date 21=09.24.1980\*

Well use 23=W\* Water Use 24=Q\* Hole depth 27= \_\_\_\_\_ Well depth 28=58\*

WL 30=23\* Date 31=09.24.1980\* Source 33=S\*

Status 273= \_\_\_\_\_ Project No. 5= \_\_\_\_\_

R=158\* T=A\* Date 159# 09.24.1980\* Owner No. \_\_\_\_\_

Owner 161# SINFIELD FISHERIES\*

R=192\* T=A\* Date 193# \_\_\_\_\_ Temp. 196#00010\* 197= \_\_\_\_\_

R=192\* T=A\* Date 193# \_\_\_\_\_ Cond. 196#00095\* 197= \_\_\_\_\_

R=192\* T=A\* Date 193# \_\_\_\_\_ pH 196#00400\* 197= \_\_\_\_\_

R=58\* T=A\* 59# 1\* Date 60= \_\_\_\_\_ Remarks \_\_\_\_\_

Drig. 63= \_\_\_\_\_ Name LARRY WELL & PUMP Method 65=H\* Finish 66=J\*

R=76\* T=A\* 59# 1\*

Top csng. 77# 0\* Bot. csng. 78= \_\_\_\_\_ Diam. 79# 1\*

R=76\* T=A\* 59# 1\*

Top csng. 77# \_\_\_\_\_ Bot. csng. 78= \_\_\_\_\_ Diam. 79# \_\_\_\_\_

R=82\* T=A\* 59# 1\* Top 83# \_\_\_\_\_ Bottom 84= \_\_\_\_\_

Type 85=L\* Diam. 87=2\* Size 88= \_\_\_\_\_

R=82\* T=A\* 59# 1\* Top 83# \_\_\_\_\_ Bottom 84= \_\_\_\_\_

Type 85= \_\_\_\_\_ Diam. 87= \_\_\_\_\_ Size 88= \_\_\_\_\_

R= \_\_\_\_\_ T=A\* 147# 1\* Q 150= \_\_\_\_\_ Q/S 272= \_\_\_\_\_

134 flows 146 pumped

GEN. SITE DATA

25  
1.6  
23.4  
WL

OWNER

FIELD OW

CONSTR.

CASING

OPENINGS

YIELD

LIFT

R=42\* T= A \* Lift type 43# S \* Intake 44= \* Power type 45= \*

Date 38= / / \* H.P. 46= \*

LOGS

R=198\* T= A \* Log 199# \* Top 200= \* Bot 201= \*

R=198\* T= A \* Log 199# \* Top 200= \* Bot 201= \*

R=189\* T= A \* E Log No. 190# \* 191= M I S S I S S I D I S T \*

ANAL.

R=114\* T= A \* Year 115# \* Type 120= \*

AQUIFERS

R=90\* T= A \* 256# 1 \* Top 91= \* Bot 92= \*

Unit ID 93= T. I. 2. M. R. V. A. \* Name of Unit MISS. RIVER VALLEY ALLUV.

R=90\* T= A \* 256# 1 \* Top 91= \* Bot 92= \*

Unit ID 93= \* Name of Unit

HYDRAULICS

R=98\* T= A \* 99# 1 \* Unit tested 100= \* 103= \*

R=105\* T= A \* 99# 1 \* Test No. 106# \*

107= \* Transmissivity (gal/d)/ft

108= \* Hydraul. cond. (gal/d)/ft<sup>2</sup>

110= \* Storage coeff. Boundaries

R=121\* T= A \* Yr Begin 122# 1950 \* Network 258= \*

Water Level Data Collection (1)

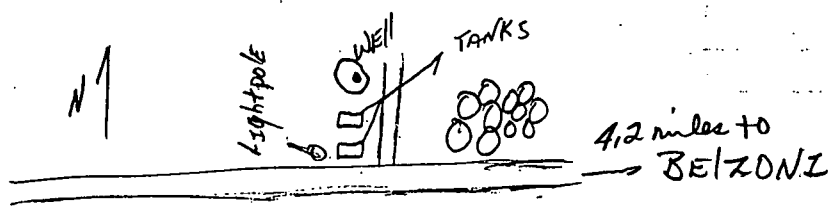

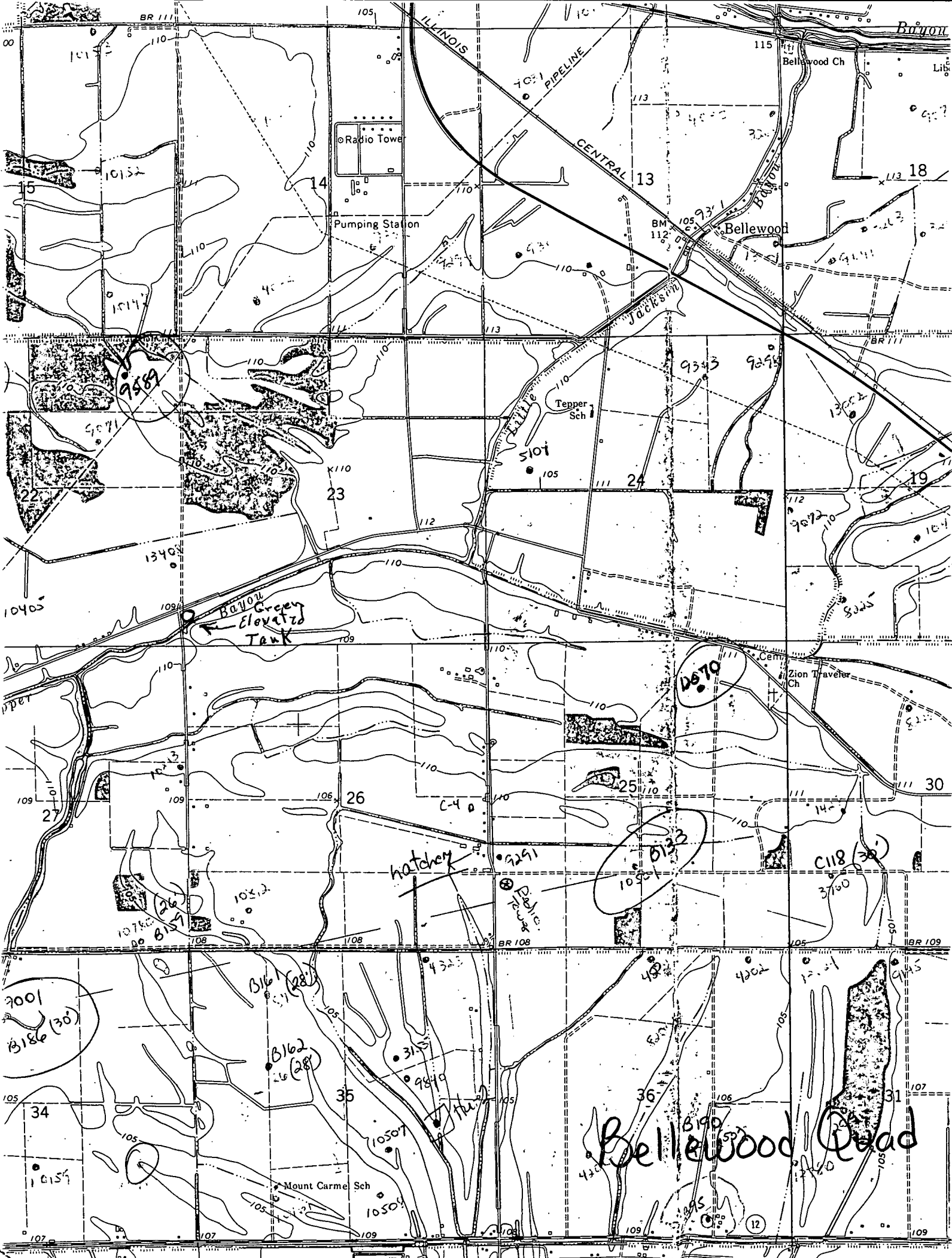

9589

Bayou Green Cloverleaf Tank

4570

5133

C118 (30)  
3750

3001  
3186 (30)

B161 (28)  
B162 (28)

Bellewood Dead