

TRANSMITTED FOR ADP 148C

Recorded by JG
Date 6-30-1986
Agency USGS

U.S. GEOLOGICAL SURVEY
WATER RESOURCES DIVISION
MISSISSIPPI DISTRICT

Well No. A45
E-Log No. _____
County Humphreys

WELL RECORD

GEN SITE DATA

Site Id 331815090285201 R=0* T=A* 2=W* Data rellab. 3=* C

Dist. 6=28* State 7=28* Co. 8=053* Lat. Long. 9=331815* 10=0902852*

Well NO. 12=A045* Location SE, SW, SW 13=SWS 23 T 117N R 03W* Alt. 16=1119* 17=M*

Hyd. Unit(OWDC) 2008030207* Date 21-1985-106-21* (YYYYMMDD)

Agency Use 803* Well Use 23-W* Water Use 24-I* Hole depth 27-1116* Well depth 28-1116*

WL 30-23* Date 31-1985-106-21* Source 33-D*

Project No. 5*

LIFT

R=42* T=A* 254#1* Date 38-1985-106-21* Lift Type 43-T* Intake 44*

Power Type 45-D* H.P. 46-40*

CONSTR.

R=58* T=A* 723#1* Date 60-1985-106-21* Orlg 63-405* Name Ferry's Well Pump

Method 65-H* Finish 66-S* Remarks _____

CASING

R=76* T=A* 725#1* 59#1* Top csng 77# D* Bot.csng 78-76* Diam. 79# 12*

R=76* T=A* 725#2* 59#1* Top csng 77# Bot.csng 78-* Diam. 79# *

OPENINGS

R=82* T=A* 726#1* 59#1* Top 83# 76* Bottom 84-1116* Type 85-S*

Diam. 87-12* Size 88-*

R=82* T=A* 726#2* 59#1* Top 83# Bottom 84-* Type 85-*

87-* 88-*

AQUIFERS

R=90* T=A* 721#1* Top 91- 29* Bot 92-1116* Unit Id 93-112MRVA*

R=90* T=A* 721#2* Top 91- Bot 92-* Unit Id 93-*

HYDRAULICS

R=98* T=A* 99#1* Unit tested 100- 103-*

R=105* T=A* 99#1* Test No. 106# 107-* Transmissivity(gal/d)/ft _____

108-* Hydraul. cond. (gal/d)/ft² _____ 110-* Storage coeff. Boundaries _____

ANAL. R=114* T=A* 706= * Year 115# * 117= * 120= *

R=121* T=A* Yr Begin 115# * Network 257# *

YIELD R=146* T=A* Flows/Number (circle one) 147#1* 148= 1 9 8 5 / 0 6 / 2 1 * 150= 2 0 0 0 . *

Q/S 272= *

OWNER R=158* T=A* 718#1* Date 159# 1 9 8 5 / 0 6 / 2 1 * Owner No. _____

Owner 161# WAYNE KING *

OTHER ID R=189* T=A* 736#1* E-Log No. 190# * 191= M I S S D I S T *

FIELD QW R=192* T=A* 738#1* Date 193# / / * Temp 196#00010* 197= . *

R=192* T=A* 738#2* Date 193# / / * Cond 196#00095* 197= . *

R=192* T=A* 738#3* Date 193# / / * pH 196#00400* 197= . *

LOGS R=198* T=A* 739#1* Log 199# D * Top 200= 0 . * Bot 201= 1 1 1 6 . *

R=198* T=A* 739#2* 199# * 200= . * 201= . *

Remarks: R=183# 311= / / *

184:

Clay	0	29
Fine sand	29	56
Coarse sand & gravel	56	116

Humphreys
A 45

MISSISSIPPI DEPARTMENT OF NATURAL RESOURCES
Bureau of Land and Water Resources
Southport Mall
P.O. Box 10631
Jackson, Mississippi 39209
WATER WELL DRILLERS LOG

CODED

6-21 19 85 date well completed
Lump's Well Pump firm name
Humphreys county well located

LANDOWNER:	description of formations encountered	from	to
Wayne King	Clay	0	29
Belzoni, MS (mailing address)	FINE Sand	29	56
	coarse sand & gravel	56	116

WELL LOCATION:
sec 23 T 17 N R 3
10 miles NE of ISOLA
(distance) (direction) (nearest town)

WELL PURPOSE:
(home, irrigation, municipal, industrial)

WELL COMPLETION DATA:

(1) diameter (inches) 12"

(2) total depth (feet) 116'

(3) static water level (feet) 23' below top of ground.

(4) casing Steel 76' (material) (depth)
(size) If telescope see back.

(5) screen 40' 76' (length) (depth to top)
12" Steel (size) (material)

(6) pump 40 2000 (HP) (yield gpm)
DSI (type power)

(7) electric log No (yes or no)

(organization running log)

(8) how well bottom plugged Steel Plate

RECEIVED
JUN 23 1986

Department of Natural Resources
Bureau of Land & Water Resources

DRILLERS REMARKS:

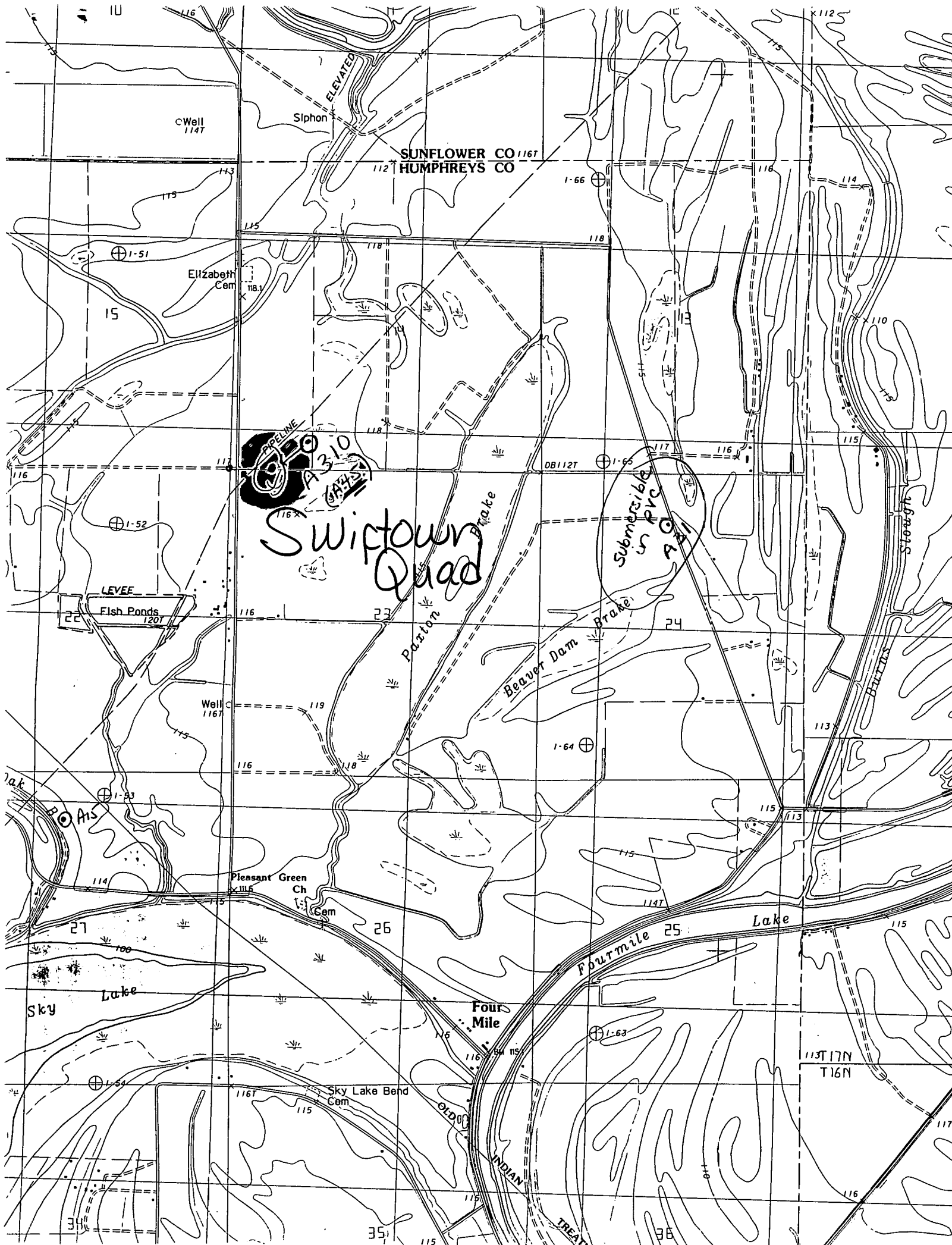

SUNFLOWER CO 1167
HUMPHREYS CO

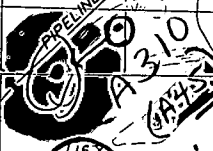

Swiftown Quad

Submersible in PVC

LEVEE

Fish Ponds 1207

Well C 1167

Pleasant Green Ch Cem

Sky Lake Bend Cem

Four Mile

INDIAN

TREATY

113T 17N
T16N