

1/81 WTO

Recorded by J. Crout

Date 9/2/81

U.S. GEOLOGICAL SURVEY  
WATER RESOURCES DIVISION  
MISSISSIPPI DISTRICT  
WELL RECORD

TRANSMITTED FOR ADP

Well No. A25

E-Log No.

County Humphreys

Inverness

*Smilerness*

Site ID 3.3.1.8.2.8.0.9.0.3.1.1.8.0.1

R=0\*

T=A\*

2=W\*

Data reliab. 3=U\*

Report. agency 4=USGS\*

Dist. 6=28\*

7=28\*

Co. 8=0.5.3\*

Lat. 9=3.3.1.8.2.8\*

Long. 10=0.9.0.3.1.1.8\*

Well No. 12=A.0.2.5\*

Location 13=SENE S 20 T 17 N R 0.3 W\*

Alt. 16=1.1.1.\*

Hyd. Unit (OWDC) 20=

Date 21=0.6.1.0.1.1.9.8.1\*

Well use 23=W\*

Water Use 24=Q\*

Hole depth 27=1.1.6.\*

Well depth 28=1.1.6.\*

WL 30=2.2.\*

Date 31=0.6.1.0.1.1.9.8.1\*

Source 33=D\*

Status 273=

Project No. 5=

R=158\*

T=A\*

Date 159#0.6.1.0.1.1.9.8.1\*

Owner No.

Owner 161#B.O.B. W.R.I.G.H.T.\*

R=192\*

T=A\*

Date 193#

Temp. 196#00010\*

197=

R=192\*

T=A\*

Date 193#

Cond. 196#00095\*

197=

R=192\*

T=A\*

Date 193#

pH 196#00400\*

197=

R=58\*

T=A\*

Date 59#1\* 60=0.6.1.0.1.1.9.8.1\*

Remarks

Drig. 63=4.0.5.\*

Name LARRY'S WELL

Method 65=R\*

Finish 66=S\*

R=76\*

T=A\*

59#1\*

Steel

Top csgn. 77# 0.\*

Bot. csgn. 78= 7.6.\*

Diam. 79# 1.6.\*

R=76\*

T=A\*

59#1\*

Top csgn 77#

Bot. csgn. 78=

Diam. 79#

R=82\*

T=A\*

59#1\*

Top 83# 7.6.\*

Bottom 84= 1.1.6.\*

Type 85= h.\*

Diam. 87= 1.6.\*

Size 88=

R=82\*

T=A\*

59#1\*

Top 83#

Bottom 84=

Type 85=

Diam. 87=

Size 88=

R= 146\*

T=A\*

147#1\*

Q 150= 3.0.0.0.\*

Q/S

272=

134 flows 146 pumped

GEN. SITE DATA

OWNER

FIELD ON

CONSTR.

CASING

OPENINGS

YIELD

LIFT.

R=42\* T= A \* Lift type 43# T \* Intake 44= \* Power type 45= D \*

Date 38= 06/01/1981 \* H.P. 46= 60. \* \*

LOGS

R=198\* T= A \* Log 199# D \* Top 200= 0. \* Bot 201= 116. \* \*

R=198\* T= A \* Log 199# \* Top 200= \* Bot 201= \* \*

R=189\* T= A \* E Log No. 190# \* 191= M I S S D I S T \* \*

ANAL.

R=114\* T= A \* Year 115# \* 117= \* 120= \* \*

AQUIFERS

R=90\* T= A \* 256# 1 \* Top 91= 3.0. \* Bot 92= 116. \* \*

Unit ID 93= 112MRVA \* Name of Unit Alluv.

R=90\* T= A \* 256# 1 \* Top 91= \* Bot 92= \* \*

Unit ID 93= \* Name of Unit

HYDRAULICS

R=98\* T= A \* 99# 1 \* Unit tested 100= \* 103= \* \*

R=105\* T= A \* 99# 1 \* Test No. 106# \* \*

107= \* Transmissivity (gal/d)/ft

108= \* Hydraul. cond. (gal/d)/ft<sup>2</sup>

110= \* Storage coeff. Boundaries

R=121\* T= \* Yr Begin 122# \* Network 258# \* \*

Water Level Data Collection (1)

7 miles SE INVERNESS

description of formations encountered	from	to
Point	0	30
FINE SAND	30	60
BIED & COARSE SAND	60	116

Humphreys  
A 25  
6-1-81

MISSISSIPPI DEPARTMENT OF NATURAL RESOURCES  
Bureau of Land and Water Resources  
Southport Mall  
P.O. Box 10631  
Jackson, Mississippi 39209  
WATER WELL DRILLERS LOG

June 01, 1981 date well completed  
Larry's Well & Pump firm name  
Humphreys county well located

LANDOWNER: <u>Bob Wright</u>	description of formations encountered	from	to
<u>Inverness MS.</u> (mailing address)			
<b>WELL LOCATION:</b> sec. <u>20</u> T. <u>17</u> N. R. <u>3</u> W. <u>7</u> miles <u>SE</u> of <u>Inverness</u> (distance) (direction) (nearest town)	<u>FINE SAND</u>	<u>30</u>	<u>60</u>
<b>WELL PURPOSE:</b> <u>Fish Pond</u> (home, irrigation, municipal, industrial)	<u>MED &amp; COARSE SAND</u>	<u>60</u>	<u>116</u>
<b>WELL COMPLETION DATA:</b>			
(1) diameter (inches) <u>16"</u>			
(2) total depth (feet) <u>116'</u>			
(3) static water level (feet) <u>22</u> below above top of ground.			
(4) casing <u>Steel</u> , <u>76'</u> (material) (depth) (size) If telescope see back.			
(5) screen <u>40'</u> , <u>76'</u> (length) (depth to top) <u>16"</u> , <u>Steel</u> (size) (material)			
(6) pump <u>60</u> <u>2000</u> (HP) (yield gpm) (type power)			
(7) electric log <u>No</u> (yes or no) (organization running log)			
(8) how well bottom plugged <u>Steel Plate</u>			
DRILLERS REMARKS:			

CODED

DEPT. OF NATURAL RESOURCES  
BUREAU OF LAND & WATER RESOURCES

JUL 16 1981

RECEIVED

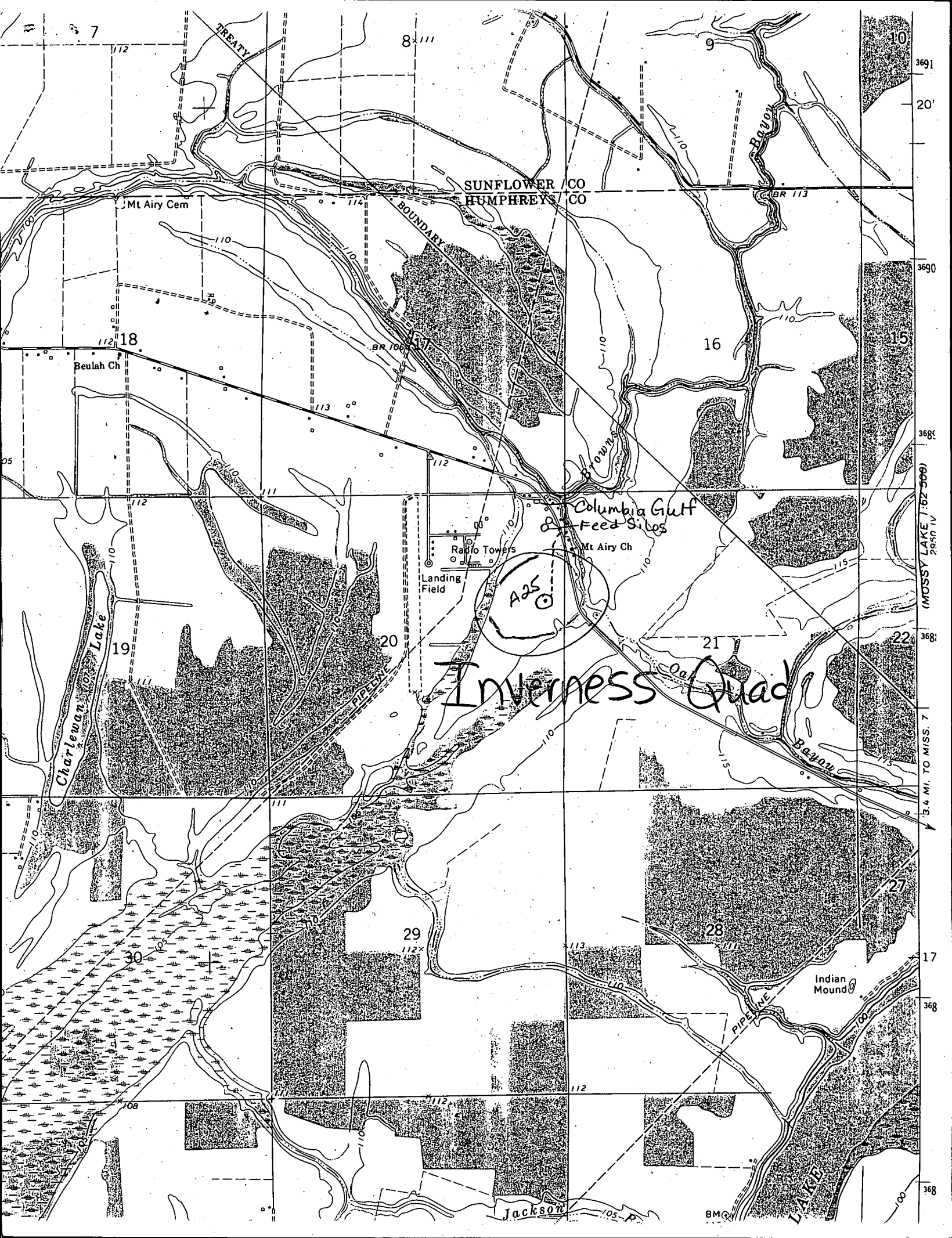

SUNFLOWER CO  
HUMPHREYS CO

Inverness Quad

A25

MOSSY LAKE (1:62,500)  
2.96 MI. IV  
3.4 MI. TO MISS. 7

Mt Airy Cem

Beulah Ch

Charlewan Lake

Columbia Gulf  
& Feed Sites

Radio Towers  
Landing Field

Mt Airy Ch

Indian Mound

Jackson

BMQ

3691  
20'  
3690  
3689  
3688  
3687  
3686  
3685  
3684  
3683  
3682  
3681  
3680  
3679  
3678  
3677  
3676  
3675  
3674  
3673  
3672  
3671  
3670  
3669  
3668  
3667  
3666  
3665  
3664  
3663  
3662  
3661  
3660  
3659  
3658  
3657  
3656  
3655  
3654  
3653  
3652  
3651  
3650  
3649  
3648  
3647  
3646  
3645  
3644  
3643  
3642  
3641  
3640  
3639  
3638  
3637  
3636  
3635  
3634  
3633  
3632  
3631  
3630  
3629  
3628  
3627  
3626  
3625  
3624  
3623  
3622  
3621  
3620  
3619  
3618  
3617  
3616  
3615  
3614  
3613  
3612  
3611  
3610  
3609  
3608  
3607  
3606  
3605  
3604  
3603  
3602  
3601  
3600  
3599  
3598  
3597  
3596  
3595  
3594  
3593  
3592  
3591  
3590  
3589  
3588  
3587  
3586  
3585  
3584  
3583  
3582  
3581  
3580  
3579  
3578  
3577  
3576  
3575  
3574  
3573  
3572  
3571  
3570  
3569  
3568  
3567  
3566  
3565  
3564  
3563  
3562  
3561  
3560  
3559  
3558  
3557  
3556  
3555  
3554  
3553  
3552  
3551  
3550  
3549  
3548  
3547  
3546  
3545  
3544  
3543  
3542  
3541  
3540  
3539  
3538  
3537  
3536  
3535  
3534  
3533  
3532  
3531  
3530  
3529  
3528  
3527  
3526  
3525  
3524  
3523  
3522  
3521  
3520  
3519  
3518  
3517  
3516  
3515  
3514  
3513  
3512  
3511  
3510  
3509  
3508  
3507  
3506  
3505  
3504  
3503  
3502  
3501  
3500