

GW14757
0260040-02

30
N29

Coded By 494
Checked By 029 129-94
Entered By 129
Date 12/94

U.S. GEOLOGICAL SURVEY
WATER RESOURCES DIVISION
MISSISSIPPI DISTRICT

E-Log No. 129
County Holmes
Agency

Well No. 170C

WELL RECORD

Agency Code U I S I G I S Site Id 1313101610191018191541111011 Project No. Owens Wells Quad

Station Name 12 N0291 HOLMES COMMUNITY Latitude 931310610191 Longitude 104018191541111

Lat/Long Ac. 11 SPTM Dist 6=28 State 7=28 County NE Land Net 13 N I W S I E S I 3 2 T I 1 5 N R I O 1 4 E 2

Location Map 14 10 I W E W I S I W E I 2 I 4 I S I Altitude 340 Mec/Meas 17 A L M Accuracy 18 1/101 Hydrologic Unit 20 086161021011

Agency Use 803 A I O Date Inventoried 711 Station Type Y Data Type 804

Instr. 805 806 Remarks Relia. 3 C L M U 2 H X IN

Date of Construction 21 03 / 25 / 1994 Well Use 23 N Water Use 24 N Primary Aquifer 714 12 Y M U W X I Hole Depth 27 10 22

Well Depth 28 1880 Water Level 30 1091 Water Level Date 31 07 / 10 / 1994 Method 34 Status 37 Source 33 D

CONSTRUCTION DATA

R=58 T=A 723#1 Construction Date 60 07 / 10 / 1994 Contractor 63 184 Name Grind Method 65 H Finish 66 G

CONSTRUCTION CASING DATA

R=76	T=A	725#1	59#1	77 10	78 1710	79 12
R=76	T=A	725#2	59#1	77 6910	78 1780	79 18

725#3 77# 790.*
78 = 815.*
79 = 8.*
725#4 77# 835.*
78 = 850.*
79 = 8.*

CONSTRUCTION OPENINGS DATA

R=82	T=A	726#1	59#1	83 17810	84 1790	87 18	85 S	89	88 1024
R=82	T=A	726#2	59#1	83 8115	84 835	87 18	85 S	89	88 1024

(417 to -427)

CONSTRUCTION LIFT DATA

R=42 T=A 254#1 Lift Type 43 T Date 38 07 / 10 / 1994 Intake 44 2610

(452 to -472) Also screened 850-880 (-487 to -517) 726#3 83# 850.*
84 = 890.*
87 = 8.*
89 = -020

Power H.P. 45 46 510 Serial No. 49

MISCELLANEOUS OWNER DATA

Date of Ownership 159 07 / 10 / 1994 Owner Name 161 HOLMES COUNTY

MISCELLANEOUS OTHER ID DATA

R=189 T=A 736#1 E-Log No. 190 129 Assigner 191 M I S S I D I S T

Well # 2

MISCELLANEOUS QW DATA

R=192	T=A	738#1	Date of Measurement 193#	Aquifer Sampled 195#	Temp 196#00010	Value 197#
R=192	T=A	738#2	Date of Measurement 193#	Aquifer Sampled 195#	So Cond 196#00095	Value 197#
R=192	T=A	738#3	Date of Measurement 193#	Aquifer Sampled 195#	pH 196#00400	Value 197#

MISCELLANEOUS LOGS DATA

R=198	T=A	739#1	Log Type 199#E	Sec. Depth 200# 10	End Depth 201# 18
R=198	T=A	739#1	Log Type 199#D	Sec. Depth 200# 10	End Depth 201# 22

MISCELLANEOUS NETWORK DATA 706 = QW WL WD *

R=114	T=A	730#1	Sec. Year 115# 9	End Year 116# 9	Agency Source 120=A 117#	Freq. 118#
R=121	T=A	730#2	Sec. Year 115# 9	End Year 116# 9	Agency Source 117#	Freq. 118#

MISCELLANEOUS REMARKS DATA

R=183	T=A	311#1	Date of Remarks 184#	Remarks 185#
-------	-----	-------	-------------------------	-----------------

DISCHARGE DATA

R=146	T=A	Pump/Flow 147#1	Date 148# 07 / 10 / 1994	Type 703# P	Discharge 150# 10	So. Capacity 272#
-------	-----	--------------------	-----------------------------	----------------	--------------------------------	----------------------

GEOHYDROLOGIC DATA

R=90	T=A	721#1	Depth Top 91# 18	Depth Bot. 92# 18	Unit Id 93# 12 11	304#
------	-----	-------	-------------------------------	--------------------------------	--	------

HYDRAULIC DATA

R=98	T=A	790#1	Unit Tested 100#	103#
------	-----	-------	---------------------	------

Well #2

68.4' dd @ 461gpm

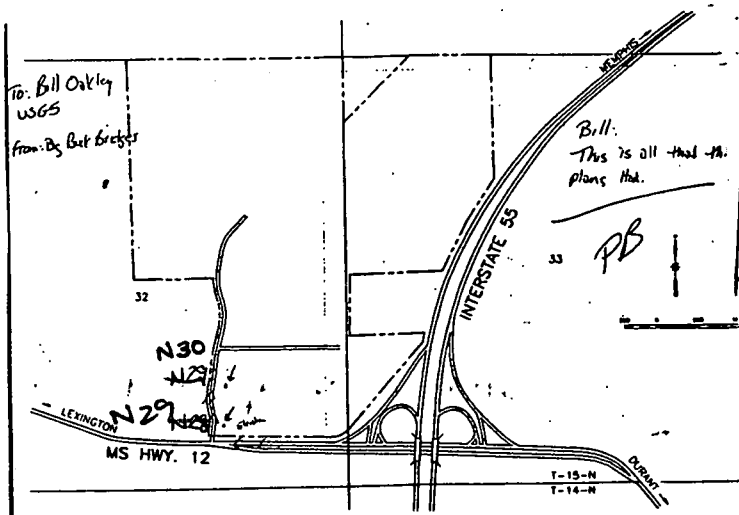

DESCRIPTION OF FORMATIONS ENCOUNTERED	FROM	TO
Sand & clay streaks	0	200
Clay	200	452
Sand with clay streaks	462	591
Clay	591	708
Sand & Clay streaks	708	782
Sand	782	904
Clay	904	1022

MISSISSIPPI DEPARTMENT OF ENVIRONMENTAL QUALITY
Office of Land and Water Resources

P. O. Box 10631
Jackson, MS 39289-0631
WATER WELL DRILLERS LOG

COUNTY WELL LOCATED Holmes	
WELL NUMBER N 30	CODED <input checked="" type="checkbox"/>
DATE WELL COMPLETED 07-01-94	

PERMIT NUMBER
NAME OF DRILLING FIRM Griner Drilling Service, Inc.

NAME & MAILING ADDRESS OF LANDOWNER Holmes County Board of Supervisors			
Courthouse			
Lexington, MS			
WELL LOCATION	SEC 32	TOWNSHIP 15 N	RANGE 4 E
DISTANCE 4 Miles	DIRECTION W	NEAREST TOWN Durant	
OTHER LANDMARK Int. I-55 & Hwy. 12			
WELL PURPOSE: Home, Irrigation, Municipal, Industrial, Fish Pond, etc. Industrial Park			

PUMP DATA		
PUMP TYPE (Circle One): Submersible, <input checked="" type="checkbox"/> Turbine, <input type="checkbox"/> Jet <input type="checkbox"/> Flowing Well, Other (Describe) _____		
POWER TYPE (Circle One): <input checked="" type="checkbox"/> Electric, <input type="checkbox"/> Tractor, <input type="checkbox"/> Diesel, <input type="checkbox"/> Gasoline, <input type="checkbox"/> Butane, Other (Describe) _____ H/P 50		
Pump Capacity (GPM) 600	No. of Stages 6	Setting Depth 250 FT.
PUMP TEST Well yielded 461 GPM with a drawdown of 68.41 ft. after 24 hours of pumping		

WELL DATA		
Well Depth 880'	Casing Diameter (In.) 12"	Casing Length (Ft.) 770'
Type of Casing steel	Hole Depth 1022	Depth to Static Water Level 109.79
TYPE OF COMPLETION: (Circle One or More): <input checked="" type="checkbox"/> Gravel Packed, <input type="checkbox"/> Underreamed, <input type="checkbox"/> Telescoped, <input type="checkbox"/> Natural Development, <input type="checkbox"/> Open Hole, <input type="checkbox"/> Other (Describe) _____		
WELL GROUTED TO A DEPTH OF 770 FEET Type Grout (circle one): Cement, Bentonite, or <input checked="" type="checkbox"/> Mix		

LOG DATA	
TYPE OF LOG RUN (Circle One): <input checked="" type="checkbox"/> Electric, <input checked="" type="checkbox"/> Gamma Ray, <input type="checkbox"/> Density, <input type="checkbox"/> Sonic, <input type="checkbox"/> Neutron, Other (Describe) _____	
Name of Organization Running Log Griner Drilling Service, Inc.	

GEOLOGIC DATA (Office Use Only)			
Surface Elev.	Geologic Unit	Unit Thickness	Depth to Top
Subs. SWL	Date	Analysis	Aquifer Test

SCREEN DATA		
Diameter - Inches 8"	Length - Feet 60	Slot Size - Inches .020
Screen Type Stainless steel	Depth to Bottom - Feet 880	

Driller's Remarks Well No. 2
--

DESCRIPTION OF FORMATIONS ENCOUNTERED	FROM	TO	FORMATIONS (Continued)	
			FROM	TO
Sand & clay streaks	0	200		
Clay	200	452		
Sand with clay streaks	462	591		
Clay	591	708		
Sand & Clay streaks	708	782		
Sand	782	904		
Clay	904	1022		

RECEIVED

JUL 14 1994

Dept. of Environmental Quality
Office of Land & Water Resources

IF MORE SPACE IS NEEDED, USE BACK

If well telescopes please sketch and show depths.

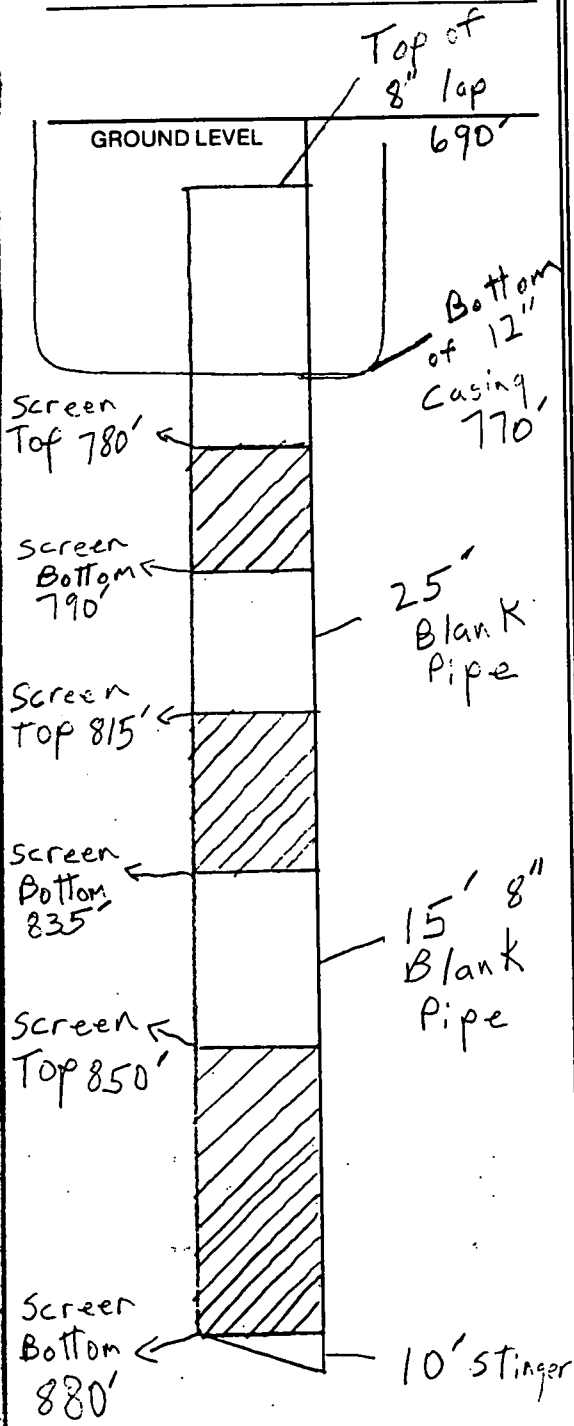

If more than one screen, show location of each on sketch.

0-770
690-780
780-790
12" casing ✓
8" lap ✓
screen
790-815 - casing
815-835 screen
835-850 casing
850-880 - screen

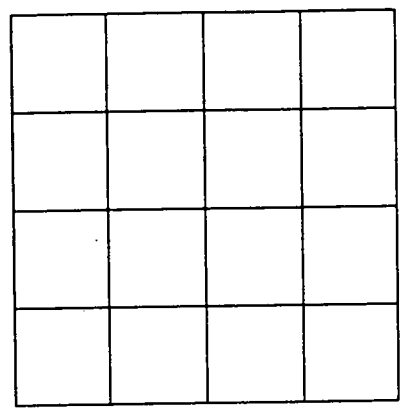

SECTION 32

Please indicate well location X.

ADDITIONAL INFORMATION

Blank lines for additional information.

DEPARTMENT OF ENVIRONMENTAL QUALITY - OLWR-
PUBLIC SUPPLY WELLS PROJECT

GPS LOG

USER NAME (S): RLB

DATE : 9-20-2002

UNIT DEQ # : _____

FILE # : _____

HEALTH DEPT. # : 260040-02 ELEVATION : _____

USGS # : N030

OLWR # : MS-GW 14757

OWNER : HOLMES CO. BD. OF SUPERVISORS QUAD : OWENS WELLS

LOCATION : _____ S _____ T _____ R _____ COUNTY HOLMES

LOCATION DESCRIPTION : _____

CASING DIA : _____ PUMP TYPE & SIZE : TURBINE

GPS FIELD LOCATION : LAT. 33.10390

LONG. -89.90310

GPS CORRECTED LOCATION : LAT. _____ LONG. _____

REMARKS : P000747PDS

33° 6' 14.0"

89° 54' 11.2"

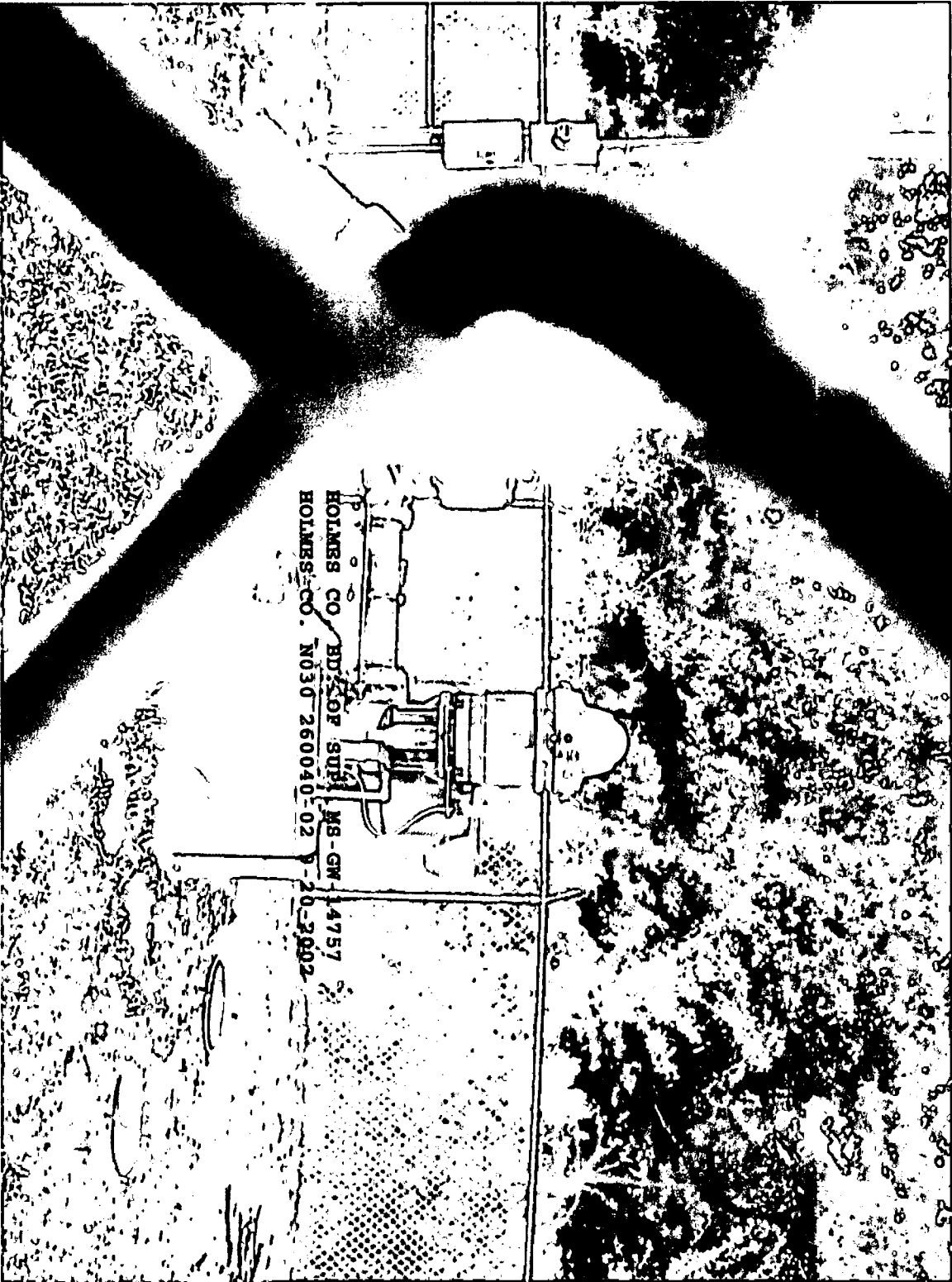

HOLMES CO HDY FOR SUPPLY MS-GW 14757
HOLMES-CO. NO30 260040-02 8-20-2002



Target is 33.1036°N, 89.9031°W - OWENS WELLS quad [Quad Info]

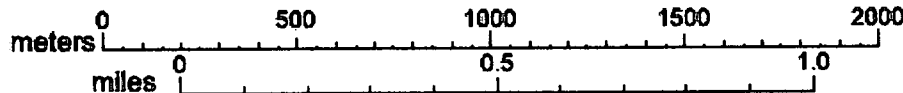

<http://www.topozone.com/print.asp?z=16&n=3666330&e=229067&s=25&u=1>

09/13/2002

Holmes Co Bd. of Sup.

MS-GW-14757 - ~~NO28~~ NO30 = well #1

MS-RW- 14758 NO29 = well #2

14758 - has HO Tag.

33.10045

-89.90290

Tierline of White Bldg.

14757

33.10390 - 10390

89.90310 P000747





Target is UTM 16 229067E 3666362N - OWENS WELLS quad [Quad Info]

