

6/78 WTO

Recorded by

Date

Destroyed
MP-WTO
9/9/80

U.S. GEOLOGICAL SURVEY
WATER RESOURCES DIVISION
MISSISSIPPI DISTRICT
WELL RECORD

TRANSMITTED FOR ADP

Well No.

E-Log No.

County

Tchula
K18
Holmes

Site ID

330841090142901

R=0*

T=A*

2=W*

#6

Data reliab.

3=C*^CU

Report. agency

4=USGS*

Dist.

6=28*

7=28*

Co.

8=051*

Lat.

Long./

9=330841*

10=0901429*

Well No.

12=K018*

Location

13# SWNW S19 T15N R01E*

Alt.

16=115.*

Hyd. Unit (OWDC)

20=

Date

21=0910911980*

Well use

23=U*

Water Use

24=*

Hole depth

27=*

Well depth

28=40.*

WL

30=11.*

Date

31=0910911980*

Source

33=S*

Status

273=*

Project No.

5=*

R=158*

T=A*

Date

159# 0910911980*

Owner No.

Owner

161=UNKNOWN*

R=192*

T=A*

Date

193# / / *

Temp.

196#00010*

197=

R=192*

T=A*

Date

193# / / *

Cond.

196#00095*

197=

R=192*

T=A*

Date

193# / / *

pH

196#00400*

197=

R=58*

T=A*

59#1*

Date

60=0110111980*

Remarks

Drlg.

63=*

Name

Method

65=H*

Finish

66=*

R=76*

T=A*

59#1*

Top csng.

77# 0.*

Bot. csng.

78=*

Diam.

79# 1.5*

R=76*

T=A*

59#1*

Top csng

77# *

Bot. csng.

78=*

Diam.

79# *

R=82*

T=A*

59#1*

Top

83# *

Bottom

84=*

Type

85=*

Diam.

87=*

Size

88=*

R=82*

T=A*

59#1*

Top

83# *

Bottom

84=*

Type

85=*

Diam.

87=*

Size

88=*

YIELD

R=*

T=A*

147# 1*

Q

150=*

Q/S

272=*

134 flows 146 pumped

R=42* T= A * Lift type 43# * Intake 44= * Power type 45= *

LIFT Date 39= / / H.P. 46= *

LOGS R=198* T= A * Log 199# * Top 200= * Bot 201= *
R=198* T= A * Log 199# * Top 200= * Bot 201= *
R=189* T= A * E Log No. 190# * 191= M I S S D I S T *

ANAL. R=114* T= A * Year 115# * Type 120= *

R=90* T= A * 256# 1 * Top 91= * Bot 92= *

AQUIFERS Unit ID 93= 112M.RVA * Name of Unit

R=90* T= A * 256# 1 * Top 91= * Bot 92= *

AQUIFERS Unit ID 93= * Name of Unit

HYDRAULICS R=98* T= A * 99# 1 * Unit tested 100= * 103= *

R=105* T= A * 99# 1 * Test No. 106# *

HYDRAULICS 107= * Transmissivity (gal/d)/ft

108= * Hydraul. cond. (gal/d)/ft²

110= * Storage coeff. Boundaries

R=121* T= * Yr Begin 122# * Network 258= *

Water Level Data Collection (1)

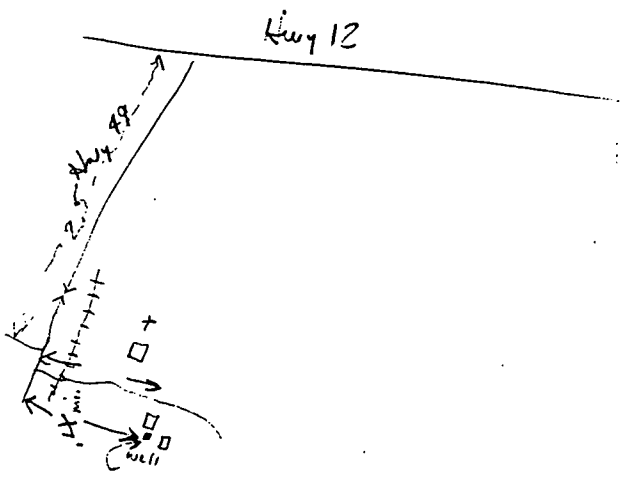

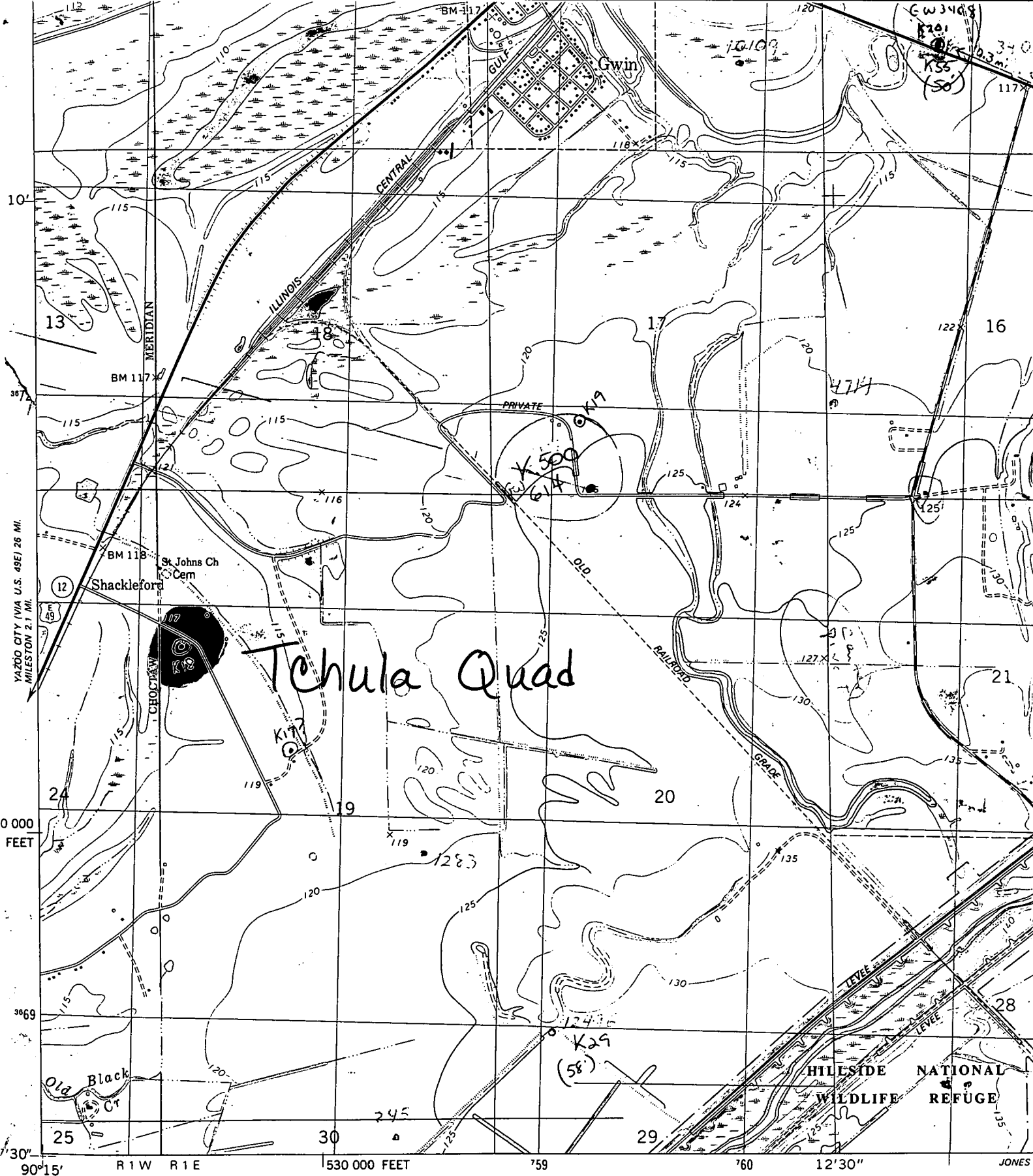

Mapped, edited, and published by the Geological Survey
 Control by USGS, NOS/NOAA, and the Mississippi Highway Department
 Topography by photogrammetric methods from aerial photographs
 taken 1976. Field checked 1977. Map edited 1982
 Projection and 10,000-foot grid ticks: Mississippi coordinate
 system, west zone (transverse Mercator)
 1000-meter Universal Transverse Mercator grid, zone 15
 1927 North American Datum
 To place on the predicted North American Datum 1983
 move the projection lines 11 meters south and

