

5-J302

GW4997

16 6/13 J 15 Maxcella PUNCHED

FORM 9-1642 (1-68)

Well No.

J 15

WELL SCHEDULE

Elog # 81

U. S. DEPT. OF THE INTERIOR

GEOLOGICAL SURVEY

WATER RESOURCES DIVISION

MASTER CARD

Record by WTO Source of data Obs driller Date 9-4-73 Map Milestone Quad.

State MISS County 28 (or town) Holmes 26

Latitude: 33 10 34 N Longitude: 0 9 0 1 9 2 8 Sequential number: 1

Lat-long accuracy: 2 15 1 8 1 8 Irreg. NW 1 SW 2

Local well number: 064081 Other number: 8 & M

Local use: 064081 Owner or name: DELTA GAS CO

Ownership: County, Fed Gov't, City, Corp or Co, Private, State Agency, Water Dist N

Use of water: (A) Air cond, Bottling, Comm, Dewater, Power, Fire, Dom, Irr, Med, Ind, P S, Rec, (S) Stock, Instit, Unused, Repressure, Recharge, Desal-P S, Desal-other, Other Cooling

Use of well: (A) Anode, Drain, Seismic, Heat Res, Obs, Oil-gas, Recharge, Test, Unused, Withdraw, Waste, Destroyed. W

DATA AVAILABLE: Well data  Freq. W/L meas.:  Field aquifer char.

Hyd. lab. data:

Qual. water data; type:

Freq. sampling:  Pumpage inventory:  yes no; period:

Log data: Elog 180' - 1176 DE

WELL-DESCRIPTION CARD

SAME AS ON MASTER CARD Depth well: 738 Meas. rept accuracy 3

Depth cased: 698 Casing type: 6 Diam. in 6

Finish: (C) porous concrete, (F) gravel w. (G) gravel w. (H) horz. open (P) perf., (S) screen, (T) sd. pt., (W) shored, (X) open hole, (Z) other S

Method: (A) air, (B) bored, (C) cable, (D) dug, (H) hyd jetted, (J) air, (P) reverse, (R) trenching, (T) driven, (V) drive wash, (W) other H

Date Drilled: 9-4-73 9-7-73 Pump intake setting: 36 ft

Driller: SINGER LAYNE, CLEVELAND MISS.

Lift (type): (A) air, (B) bucket, (C) cent, (J) multiple, (L) multiple, (M) multiple, (N) none, (P) piston, (R) submerg, (S) turb, (T) other T Deep 40 Shallow

Power (type): (nat) diesel, elec, gas, gasoline, hand, gas, wind; (LP) H.P. 5 U Trans. of meter no.

Descrip. MP: 111 1110 Accuracy: topo

Alt. LSD: 111 1110 Accuracy: topo

Water Level: 0 Accuracy: topo

Date meas: 8-7-73 Yield: 60 gpm Method determined 61

Drawdown: 62 Accuracy: 63 Pumping period: 64 hrs 65

QUALITY OF WATER DATA: Iron 69 Sulfate 70 Chloride 71 Hard. 72

Sp. Conduct 73 K x 10 74 Temp. 75 Date sampled 76

Taste, color, etc. 77

10/26/89 -1.5

11/17/80

MP 10 3.00 3.60 2.40

110 2 108

Latitude-longitude N  
S  
d m s d m s

**HYDROGEOLOGIC CARD**

**SAME AS ON MASTER CARD** Physiographic Province: 03 Section: \_\_\_\_\_

**E** Drainage Basin: 15J Subbasin: \_\_\_\_\_

Topo of well site: (D) depression, stream channel, dunes, flat, hilltop, sink, swamp, (C) (E) (F) (H) (K) (L) (P) (S) (T) (U) (V) offshore, pediment, hillside, terrace, undulating, valley flat 27

**MAJOR AQUIFER:** TE SS

Lithology: US Origin: 2 Aquifer Thickness: 110 ft

Length of well open to: \_\_\_\_\_ ft 40 Depth to top of: \_\_\_\_\_ ft 630

**MINOR AQUIFER:** \_\_\_\_\_ \_\_\_\_\_ \_\_\_\_\_

Lithology: \_\_\_\_\_ \_\_\_\_\_ Origin: \_\_\_\_\_ Aquifer Thickness: \_\_\_\_\_ ft

Length of well open to: \_\_\_\_\_ ft \_\_\_\_\_ Depth to top of: \_\_\_\_\_ ft \_\_\_\_\_

**Intervals Screened:** \_\_\_\_\_

Depth to consolidated rock: \_\_\_\_\_ ft \_\_\_\_\_ Source of data: \_\_\_\_\_

Depth to basement: \_\_\_\_\_ ft \_\_\_\_\_ Source of data: \_\_\_\_\_

Surficial material: \_\_\_\_\_ \_\_\_\_\_ Infiltration characteristics: \_\_\_\_\_

Coefficient Trans: \_\_\_\_\_ gpd/ft \_\_\_\_\_ Coefficient Storage: \_\_\_\_\_

Coefficient Perm: \_\_\_\_\_ gpd/ft<sup>2</sup>; Spec cap: \_\_\_\_\_ gpm/ft; Number of geologic cards: \_\_\_\_\_

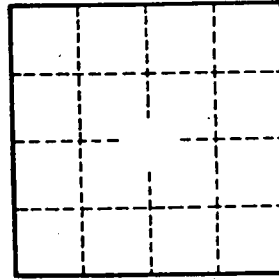
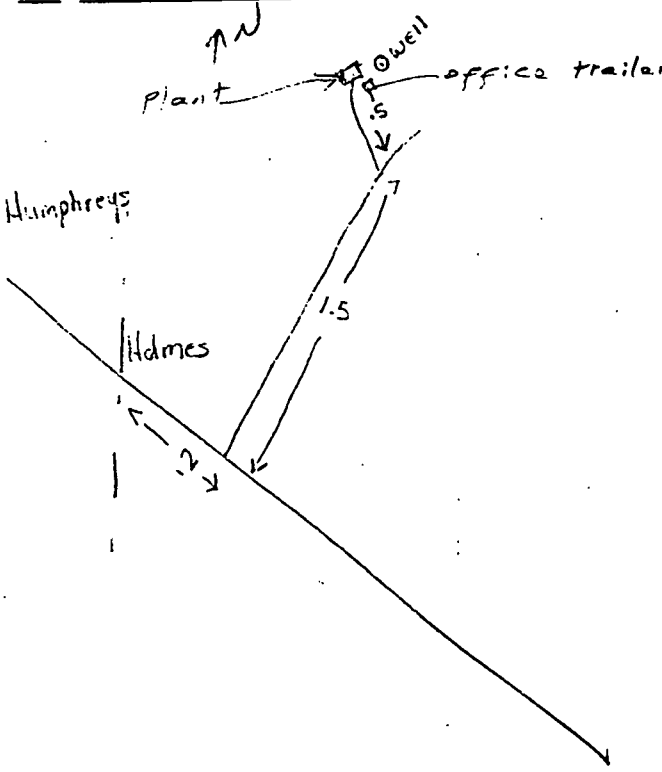

Well No. \_\_\_\_\_

C17187

**HOLMES**  
**JIS**  
**8-12-73**  
**E Log # 81**

MISSISSIPPI  
 BOARD OF WATER COMMISSIONERS  
 416 North State Street  
 Jackson, Mississippi 39201

**CODED**

**WATER WELL DRILLERS LOG**

August 12, 1973  
 date well completed

**SINGER CLAYNE**  
 Delta Gas Company  
 firm name

Holmes  
 county well located

LANDOWNER:	description of formations encountered	from	to
Delta Gas Company			
Jackson, Mississippi (mailing address)	Sand	37	95
	Gravel	95	161
WELL LOCATION:	Clay	161	195
	Sandy Clay	195	400
sec. <u>8</u> T. <u>15</u> N R. <u>1</u> W	White Clay	400	494
	White Sand	494	548
12 miles East of Belzoni (distance) (direction) (nearest town)	Clay	548	551
	White Sand	551	600
WELL PURPOSE: Industrial (home, irrigation, municipal, industrial)	Clay	600	648
	Coarse Sand	648	716
WELL COMPLETION DATA:	Shale	716	717
	Coarse Sand	717	744
(1) diameter (inches) <u>6"</u>	Clay	744	889
(2) total depth (feet) <u>745'</u>	Rock	889	893
(3) static water level (feet) <u>0</u> below top of ground.	Shale	893	964
	Sand Rock	964	973
(4) casing <u>Steel</u> , <u>200'</u> (material) (depth)	Shale	973	981
	Rock	981	986
<u>6"</u> if telescope see back. 498' Blank	Shale	986	994
	Clay	994	1020
(5) screen <u>40'</u> , <u>738'</u> (length) (depth to top)	Shale	1020	1070
	Sandy Shale	1070	1135
<u>3"</u> <u>Stainless Steel</u> (size) (material)	Clay	1135	1198
(6) pump <u>5</u> <u>60</u> (HP) (yield gpm)			
<u>electric</u> (type power)			
(7) electric log <u>Yes</u> (yes or no)			
U.S. Geological Survey (organization running log)			
(8) how well bottom plugged <u>3"</u> <u>Backpressure Valve - 7'</u>			
DRILLERS REMARKS:			

**CODED**

NOV 13 1973

Miss. STATE WATER COMM.

DATA SHEET-VERIFICATION CHECKLIST

COUNTY HOLMES

MARCELLA QUAD

WELL OWNER TEXAS GAS CO. (Formerly DELTA GAS)

CHECKED

U.S.G.S. NO. J-15

JNH

B.O.H. NO \_\_\_\_\_

\_\_\_\_\_

OLWR NO. \_\_\_\_\_

\_\_\_\_\_

LOCATION:

MAP NW SW IRREG S 8 T15N R1W

JNH

GPS \_\_\_\_\_

\_\_\_\_\_

ELEV. (MSL) 111'

JNH

W.L. (L.S.) (1) - 6.05' 7-12-95

JNH

(2) - 6.00' "

JNH

HEAD (MSL) 104.95'

JNH

SCREENED INTERVAL 608'-738' (LS) | -587' - 627' (MSL)

JNH

AQUIFER VERIFIED SPARTA

JNH

PREVIOUS W.L. -0.15' (10/26/89) | -2.40' (11/19/80) | 0' (8/1/73)

JNH

DATA ENTERED \_\_\_\_\_

\_\_\_\_\_

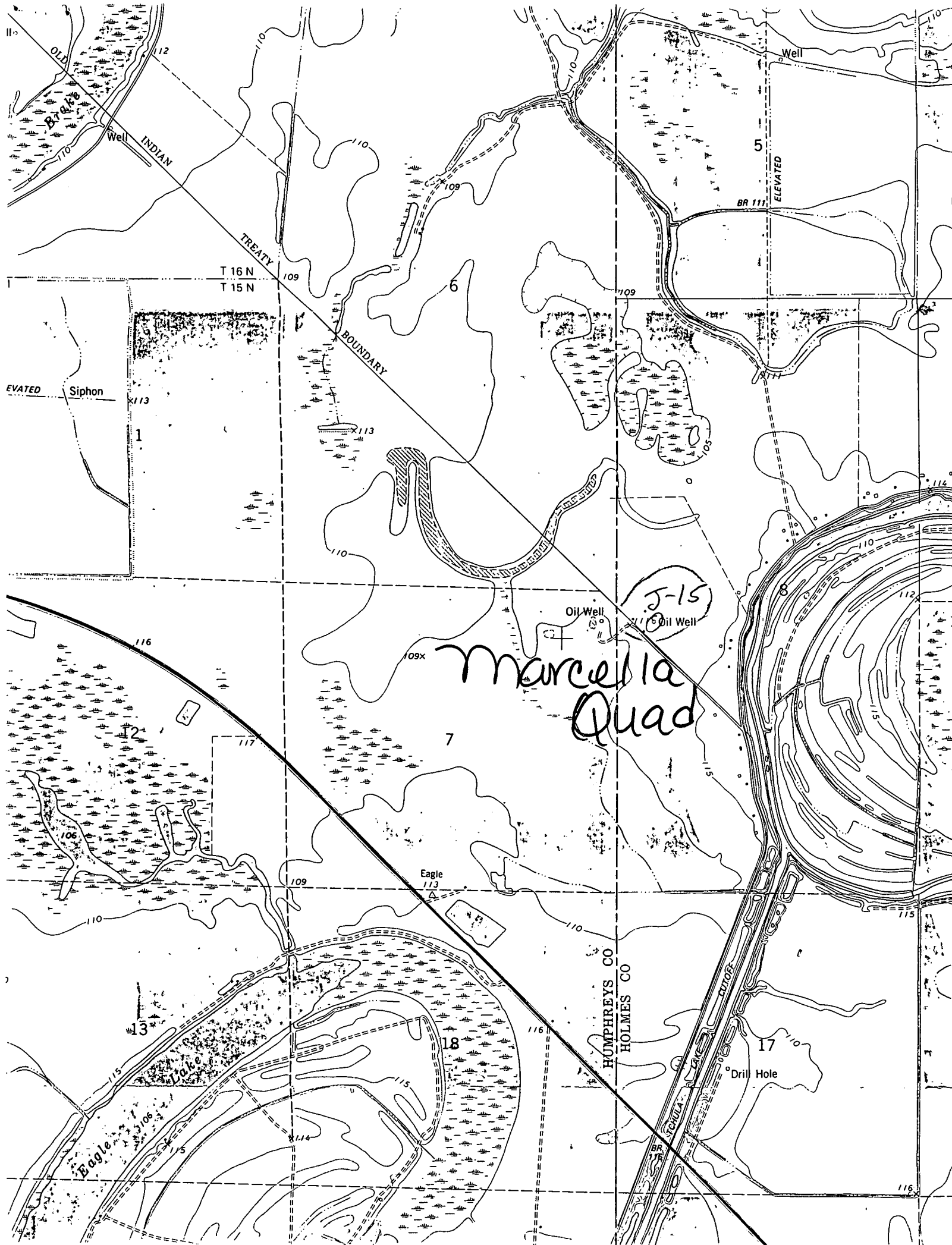

Marcella Quad

J-15

T 16 N  
T 15 N

HUMPHREYS CO  
HOLMES CO

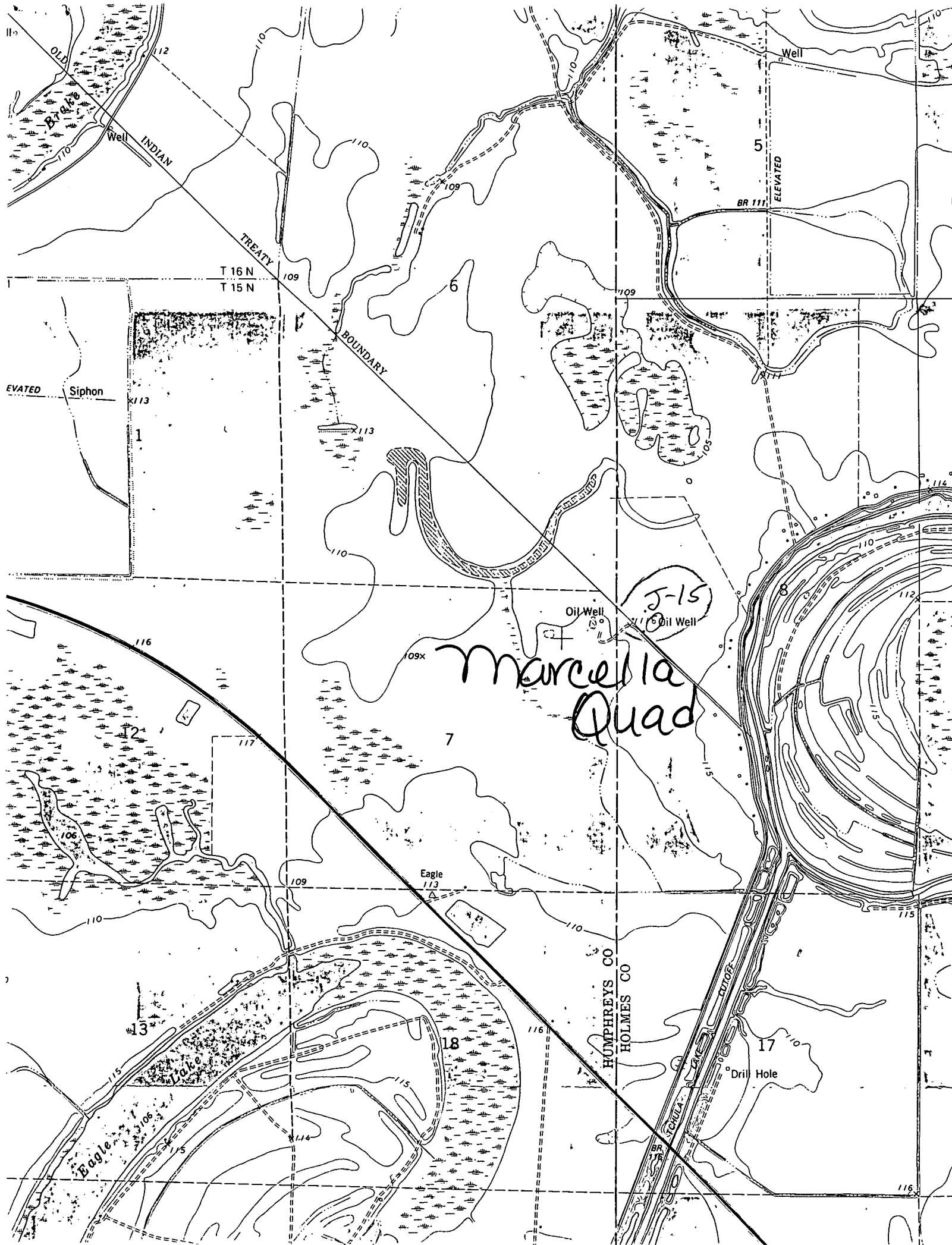

Marcella Quad

J-15

T 16 N  
T 15 N

HUMPHREYS CO  
HOLMES CO