

6/78 WTO

TRANSMITTED FOR ADP

Tchula  
H # 1

Recorded by BSCW  
Date 9/24/80

U.S. GEOLOGICAL SURVEY  
WATER RESOURCES DIVISION  
MISSISSIPPI DISTRICT  
WELL RECORD

Well No. H22  
E-Log No. \_\_\_\_\_  
County Holmes

Site ID 331315090123801 R=0\* T=A\* 2=W\*

GEN. SITE DATA

Data reliab. 3=C\*<sup>C</sup>U Report. agency 4=USGS\* Dist. 6=28\* 7=28\* Co. 8=051\*

Lat. \_\_\_\_\_ Long. 9=331315\* 10=0901238\* Well No. 12=H022\*

Location 13=SE NE S 29 T 16 N R 01 E\* Alt. 16=118\* <sup>118</sup><sub>115.5</sub>  
<sub>106.4</sub>

Hyd. Unit (OWDC) 20= \_\_\_\_\_\* Date 21=0912411980\*

Well use 23= \_\_\_\_\_\* Water Use 24=H\* Hole depth 27= \_\_\_\_\_\* Well depth 28=68\*

30= 12\* Date 31=0912411980\* Source 33=S\*

Status 273= \_\_\_\_\_\* Project No. 5= \_\_\_\_\_\*

*MP = top of pitcher pump at 3.3' above 15d*

R=158\* T=A\* Date 159# 0912411980\* Owner No. \_\_\_\_\_

OWNER

Owner 161# FRANK WILSON\*

FIELD OW

R=192\* T=A\* Date 193# \_\_\_\_\_\* Temp. 196#00010\* 197= \_\_\_\_\_\*

R=192\* T=A\* Date 193# \_\_\_\_\_\* Cond. 196#00095\* 197= \_\_\_\_\_\*

R=192\* T=A\* Date 193# \_\_\_\_\_\* pH 196#00400\* 197= \_\_\_\_\_\*

CONSTR.

R=58\* T=A\* 59# 1\* Date 60=01011940\* Remarks \_\_\_\_\_

Drlg. 63= \_\_\_\_\_\* Name \_\_\_\_\_ Method 65=H\* Finish 66= \_\_\_\_\_\*

CASING

R=76\* T=A\* 59# 1\*

Top csgn. 77# 0\* Bot. csgn. 78= \_\_\_\_\_\* Diam. 79# 1\*

R=76\* T=A\* 59# 1\*

Top csgn. 77# \_\_\_\_\_\* Bot. csgn. 78= \_\_\_\_\_\* Diam. 79# \_\_\_\_\_\*

OPENINGS

R=82\* T=A\* 59# 1\* Top 83# \_\_\_\_\_\* Bottom 84= \_\_\_\_\_\*

Type 85= \_\_\_\_\_\* Diam. 87= \_\_\_\_\_\* Size 88= \_\_\_\_\_\*

R=82\* T=A\* 59# 1\* Top 83# \_\_\_\_\_\* Bottom 84= \_\_\_\_\_\*

Type 85= \_\_\_\_\_\* Diam. 87= \_\_\_\_\_\* Size 88= \_\_\_\_\_\*

YIELD

R= \_\_\_\_\_\* T=A\* 147# 1\* Q 150= \_\_\_\_\_\* Q/S 272= \_\_\_\_\_\*

134 flows 146 pumped

R=42\* T= A \* Lift type 43# \* Intake 44= \* Power type 45= \*

LIFT Date 38= / / H.P. 46= \*

R=198\* T= A \* Log 199# \* Top 200= \* Bot 201= \*

R=198\* T= A \* Log 199# \* Top 200= \* Bot 201= \*

R=189\* T= A \* E Log No. 190# \* 191= M I S S D I S T \*

ANAL. R=114\* T= A \* Year 115# \* Type 120= \*

R=90\* T= A \* 256# 1 \* Top 91= \* Bot 92= \*

AQUIFERS Unit ID 93= 112 MRVA \* Name of Unit MISS. RIVER VALLEY ALLUV.

R=90\* T= A \* 256# 1 \* Top 91= \* Bot 92= \*

Unit ID 93= \* Name of Unit

R=98\* T= A \* 99# 1 \* Unit tested 100= \* 103= \*

R=105\* T= A \* 99# 1 \* Test No. 106# \*

HYDRAULICS 107= \* Transmissivity (gal/d)/ft

108= \* Hydraul. cond. (gal/d)/ft<sup>2</sup>

110= \* Storage coeff. Boundaries

R=121\* T= A \* Yr Begin 122# \* Network 258= \*

Water Level Data Collection (1) ↑ N

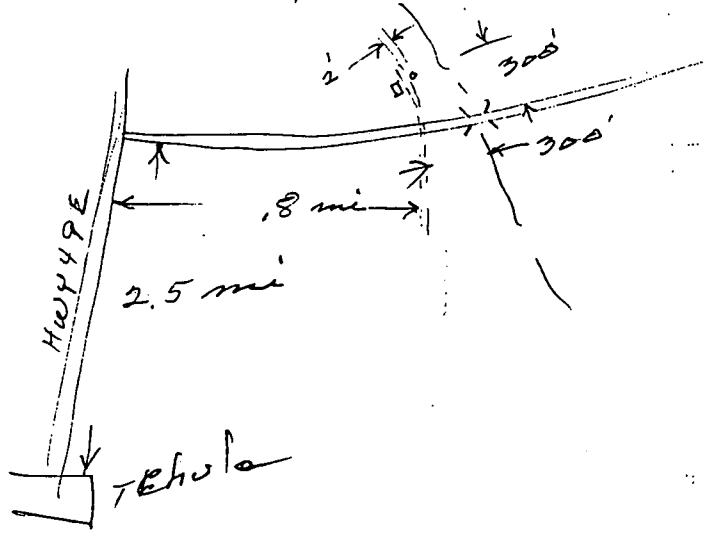

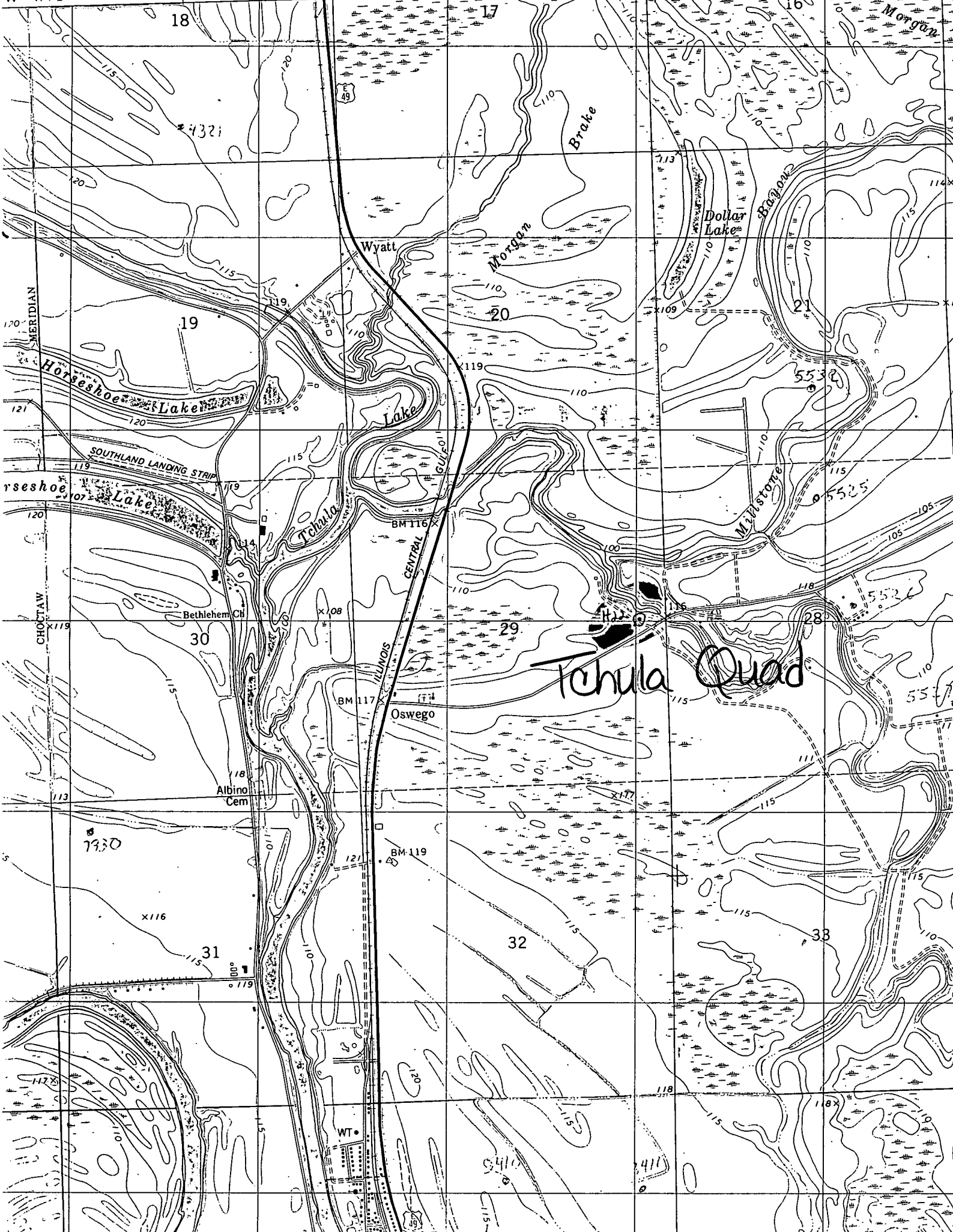

Tehula Quad