

GW7605

Cruger
Bio

6/78 WTO

Recorded by WTO

U.S. GEOLOGICAL SURVEY TRANSMITTED FOR ADP Well No.

Date 1/23/79

WATER RESOURCES DIVISION

E-Log No.

MISSISSIPPI DISTRICT

County Holmes

WELL RECORD APR 1979

Site ID 331900090140002 R=0* T=A* 2=W*

GEN. SITE DATA

Data reliab. 3=C* Report. agency 4=USGS* Dist. 6=28* 7=28* Co. 8=051*

Lat. Long./ 9=331900* 10=0901400* Well No. 12=B010*

Location SW 8 SE S 19 T 17 N R 01 E* Alt. 16=120* 120

Hyd. Unit (OWDC) 20=08020206* Date 21=01/01/1970*

Well use 23=W* Water Use 24=P* Hole depth 27=1231.* Well depth 28=1230.*

WL 30=-50.* Date 31=04/06/1972* Source 33=S*

Status 273=* Project No. 5=*

OWNER

R=158* T=A* Date 159#01/01/1970* Owner No.

Owner 161=CRUGER*

FIELD ON

R=192* T=A* Date 193#04/06/1972* Temp. 196#00010* 197=24.0*

R=192* T=A* Date 193#04/06/1972* Cond. 196#00095* 197=4.00*

R=192* T=A* Date 193#04/06/1972* pH 196#00400* 197=8.2*

CONSTR.

R=58* T=A* 59#1* Date 60=01/01/1970* Remarks

Drlg. 63=037* Name BUTANE GAS Method 65=H* Finish 66=S*

CASING

R=76* T=A* 59#1*

Top csng. 77#0.* Bot. csng. 78=* Diam. 79#6.*

R=76* T=A* 59#1*

Top csng. 77#* Bot. csng. 78=* Diam. 79#*

OPENINGS

R=82* T=A* 59#1* Top 83#1200.* Bottom 84=1230.*

Type 85=S* Diam. 87=4.* Size 88=*

R=82* T=A* 59#1* Top 83#* Bottom 84=*

Type 85=* Diam. 87=* Size 88=*

YIELD

R=146* T=A* 147#1* Q 150=80.* Q/S 272=*

134 flows 146 pumped

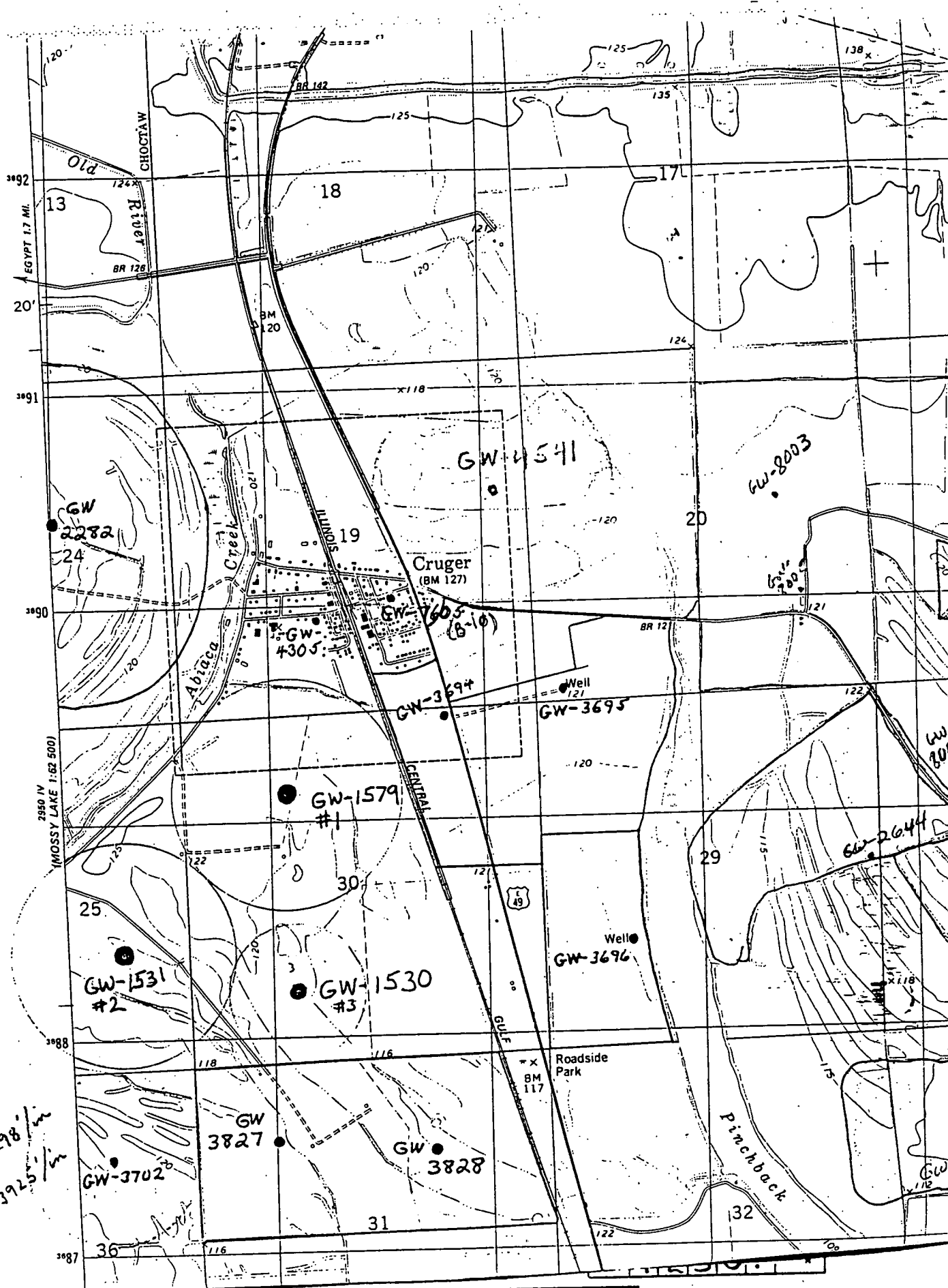

LAT: 32.98' N
 LONG: 89.25' W

PENINGS Type 85- S * Diam. 87- 4 * Size 88- * *
 R-82 * T- A * 59#1 * Top 83# * Bottom 84- * *

Holmes
B 10

MISSISSIPPI
BOARD OF WATER COMMISSIONERS
416 North State Street
Jackson, Mississippi 39201

CODED

WATER WELL DRILLERS LOG

19 BUTANE GAS - CO HOLMES CO
date well completed firm name county well located

LANDOWNER: TOWN OF CRUGER
CRUGER MISS
(mailing address)
WELL LOCATION:
sec. 25 T. 17 N. R. 1 E.
0 miles 0 of CRUGER
(distance) (direction) (nearest town)

WELL PURPOSE: MUNICIPAL
(home, irrigation, municipal, industrial)

WELL COMPLETION DATA:
(1) diameter (inches) 6 X 4
(2) total depth (feet) 1231
(3) static water level (feet) 20 below above top of ground.
(4) casing 6" STEEL 600' (material) (depth)
+ STEEL 600'
(size) If telescope see back.
(5) screen 30" 4" STAINLESS STEEL (length) (depth to top)
(6) pump 12E LDA (size) (material)
5-80 (HP) (yield gpm)
FLEC (type power)
(7) electric log NO (yes or no)
(organization running log)
(8) how well bottom plugged BACK WASH VALVE

description of formations encountered	from	to
CLAY	0	14
FINE SAND	14	35
SAND & GRAVEL	35	96
SAND - GRAVEL	96	105
ROCK	105	106
SAND & GRAVEL	106	170
SAND	170	250
SHALE	250	295
SAND & SHALE	295	440
SHALE	440	500
SAND & SHALE	500	591
ROCK	591	592
SAND & ROCK SHALE	592	975
SAND	975	997
SAND - ROCK - SHALE	997	1085
SAND - ROCK -	1085	1139
HARD PACK SAND	1139	1190
SAND -	1190	1220
SHALE	1220	1230
ROCK	1230	1231

CODED

12E LDA - 50-9
5 HP - 80
1.3 FT SET

JUL 1 1970

DRILLERS REMARKS:

MISS. BO. OF
WATER COM.

WILCOX DATA SHEET-VERIFICATION CHECKLIST

COUNTY HOLMES

Cruzer Quad

WELL OWNER Cruzer CHECKED

U.S.G.S. NO. B-10 _____

B.O.H. NO _____

OLWR NO. _____

LOCATION:

MAP SW, NW, SE S19, T17N, R1E 7/18/94

GPS Not done _____

ELEV. (MSL) 120' 7/18/94

W.L. (L.S.) (1) + 17' 7/18/94

(2) _____

HEAD (MSL) + 137' 7/18/94

SCREENED INTERVAL 1,200' - 1,230' (L.S.) / -1,080' - -1,110' (MSL) 7/18/94

AQUIFER VERIFIED meridian - Upper Wilcox 7/19/94

PREVIOUS W.L. +15.25' (1988) / +33' (1979) 7/18/94

DATA ENTERED _____

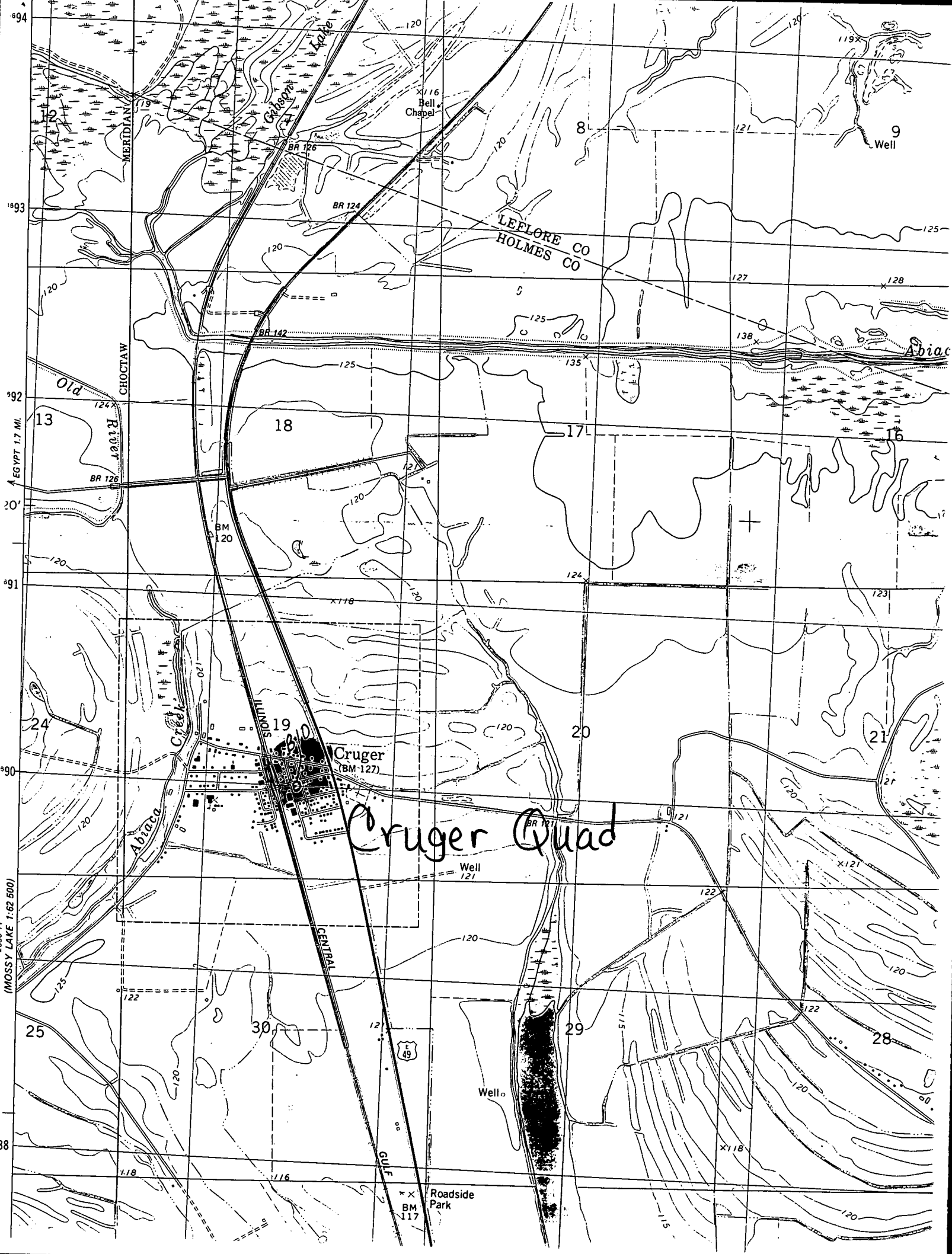

894
893
892
20'
891
890
889
888

9 Well

LEFLORE CO
HOLMES CO

Abbeville

Old River

Cruger Quad

Cruger
(BM 127)

49

Roadside Park

(MOSSY LAKE 1:62 500)

CHOCOTAW

Abbeville Creek

CENTRAL

GULF

MERIDIAN

Cruger

Bell Chapel

BR 124

BR 142

BR 126

BM 120

Well 121

Well

BM 117

30

29

28

21

20

18

17

16

13

138

135

125

127

121

120

120

120

120

120

125

120

118

116

121

120

115

120

120

125

128

123

121

122

122

118

115

119

119

119

117

117

117

117

117

117

117

117

117

117

120

120

120

120

120

120

120

120

120

120

125

120

120

120

120

120

120

120

120

120

120

125

120

120

120

120

120

120

120

120

120

120

125

120

120

120

120

120

120

120

120

120

120

125

120

120

120

120

120

120

120

120

120

120

125

120

120

120

120

120

120

120

120