

Recorded by W10
Date 3/6/68 7/24/79
-1996

TRANSMITTED FOR ADP
U.S. GEOLOGICAL SURVEY
WATER RESOURCES DIVISION
MISSISSIPPI DISTRICT
WELL RECORD

Well No. 031
E-Log No. 288
County Hinds

Site ID 321228090393502 R=0* T=A* 2=W* Cayuga Quad

Data reliab. 3-C Report. agency 4-USGS Dist. 6-28 7-28 Co. 8-049

GEN. SITE DATA

Lat. 9-321228 Long. 10-0903935 Well No. 12-0031

Location 13-NWSEY S 01 T 14N R 05E Alt. 16-220 216

Hyd. Unit (OWDC) 20- Date 21-0310611968

Well use 23-W Water Use 24-P Hole depth 27-1337 Well depth 28-1280

WL 30-106 Date 31-0410111968 Source 33-D

Status 273- Project No. 5-

CCKF

OWNER

R=158* T=A* Date 159#0410111968 Owner No. 161-HUBBARD

Cayuga Quad
Hubbard

FIELD ON

R=192* T=A* Date 193#0612111972 Temp. 196#00010 197-31.5

R=192* T=A* Date 193#0612111972 Cond. 196#00095 197-1100

R=192* T=A* Date 193#0612111972 pH 196#00400 197-7.9

CONSTR.

R=58* T=A* 59#1 Date 60-0410111968 Remarks

Drlg. 63-053 Name T.M. Parks Method 65-H Finish 66-S

101.43

CASING

R=76* T=A* 59#1 Top csgn. 77#0 Bot. csgn. 78-210 Diam. 79#8

R=76* T=A* 59#1 Top csgn. 77#210 Bot. csgn. 78-285 Diam. 79#6

R=76* T=A* 59#1 77#285 78=1029 79#4

11/17/89

OPENINGS

R=82* T=A* 59#1 Top 83#1029 Bottom 84-1049

Type 85-S Diam. 87-4 Size 88-

R=82* T=A* 59#1 Top 83#1220 Bottom 84-1230

Type 85-S Diam. 87-4 Size 88-

6/9/94 WJE/PAP

R=82* T=A* 59#1 83#1240 84=1250 85=S 83#1260 84=12

YIELD R=146* 10.0 272-

154 flows 145 cupped

R=42* T= A * Lift type 43# T * Intake 44= * Power type 45= E *

LIFT Date 38= 04/01/1978 * H.P. 46= 10 *

LOGS R=198* T= A * Log 199# * Top 200= * Bot 201= *
R=198* T= A * Log 199# E * Top 200= 209 * Bot 201= 1337 *
R=189* T= A * E Log No. 190# 288 * 191= M I S S I S S I P P I D I S T *

ANAL. R=114* T= A * Year 115# * Type 120= *

R=90* T= A * 256# 1 * Top 91= * Bot 92= *
Unit ID 93= 24 C C K F * Name of Unit

R=90* T= A * 256# 1 * Top 91= * Bot 92= *
Unit ID 93= * Name of Unit

R=98* T= A * 99# 1 * Unit tested 100= * 103= *

R=105* T= A * 99# 1 * Test No. 106# *

HYDRAULICS 107= * Transmissivity (gal/d)/ft

108= * Hydraul. cond. (gal/d)/ft²

110= * Storage coeff. Boundaries

R=121* T= * Yr Begin 122# * Network 258= *

Water Level Data Collection (1)

Screened
029' - 1049'
096' - 1136'
220' - 1230'
740' - 1250'
260' - 1280'

stored water
160 units

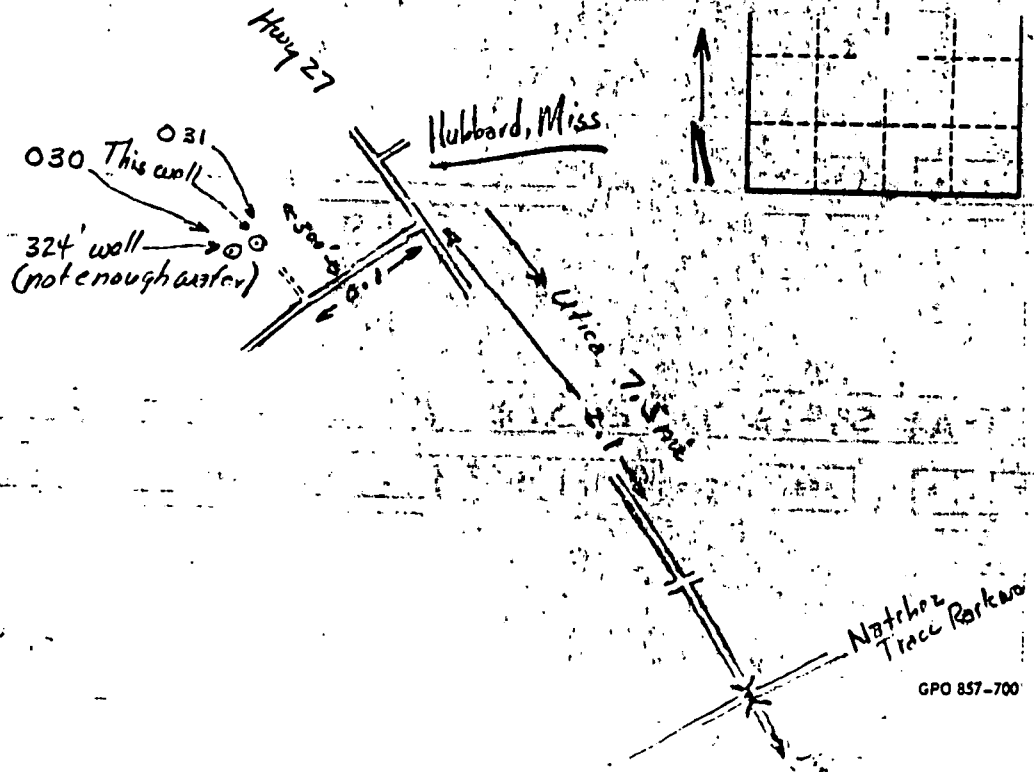

G^w 1996

CODED

Hinds
 031
 10-67
 Elec Log
 10/14/67

MISSISSIPPI
 BOARD OF WATER COMMISSIONERS
 416 North State Street
 Jackson, Mississippi 39201

WATER WELL DRILLERS LOG

date well completed 10/14/67 19 firm name Waterwell, Inc. county well located Hinds

LANDOWNER: Hubbard Water Assoc., Inc.
 Hubbard, Miss.
 (mailing address)

WELL LOCATION:
 sec. 1 T 4 N R 5 E
 8 miles NW of UTKB
 (distance) (direction) (nearest town)

WELL PURPOSE:
 (home, irrigation, municipal, industrial)

- WELL COMPLETION DATA:
- (1) diameter (inches) 8x6
 - (2) total depth (feet) 366
 - (3) static water level (feet) 94 below top of ground.
 - (4) casing steel 250 (material) (depth)
 8" (size) if telescope see back.
 - (5) screen 40 2629304 (length) (depth to top)
 6 stainless steel (size) (material)
 - (6) pump 10 100 (HP) (yield gpm)
 electric (type power)
 - (7) electric log YES (yes or no)
 MISS. G. S. (organization running log)
 - (8) how well bottom plugged Back wash valve

description of formations encountered	from	to
Westward clay	0	5
Grey clay	5	30
Silty white sand	30	34
Blue clay	34	78
White coarse sand	78	82
blue shale	82	107
SW sand	107	128
Blue clay	128	180
bluish grey Marl	180	208
lime rock with streaks of soft	208	255
Marl, abundance of shelled fossils		
Grey SW to Med Sand	255	282
White chalk	282	298
fine white sand	298	325
streaks of white		
very fine white sand large streaks of lignite	325	355
Blue shale	355	416
Blue Clay (Y0200)	416	423
TD 423		

DRILLERS REMARKS: split screens - water has high color

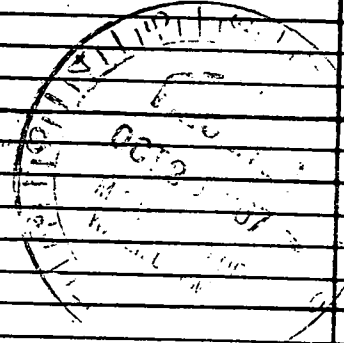

I think this is for a test well - see back of 031 well schedule -

If well telescopes please sketch and show depths.

NE 1/4, SW 1/4 SEC 1
T4N, R5E

GROUND LEVEL

94' Water Level

221' Lead Seal

252'

262' } 6" screen
282' }

304' } 6" screen
324' }

} tail pipe
366'

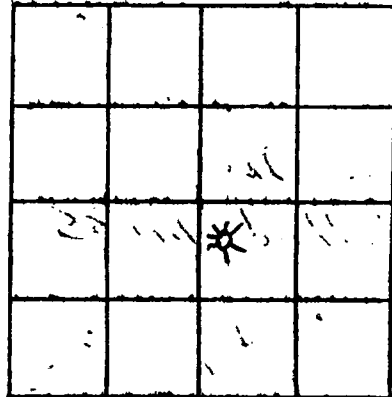

SECTION 1

Please indicate well location X.

ADDITIONAL INFORMATION

Surface casing cemented
by Halliburton to 252'

Set 4000 gal pressure
TANK

ENGINEERS:
ENGINEER SERVICE
MR. W. W. SYKES

Soil Bore Analysis
AT ENGINEERS' OFFICE

If more than one screen,
show locations of each on sketch.

DEPARTMENT OF ENVIRONMENTAL QUALITY - OLWR
PUBLIC SUPPLY WELLS PROJECT

GPS LOG

USER NAME(S): Phillips / Everett DATE: 6/9/94
UNIT DEQ #: 84090 FILE #: B060919D
HEALTH DEPT. #: 250007-01 ELEV. 216
USGS #: Ø31 OLWR #: GW1996
OWNER: Hubbard W.A. Quad: Coyuga
LOCATION: NW/SE S 1 TIAN R 5E COUNTY: Hinds
LOCATION DESCRIPTION: On Cook Rd. just off Hwy 27

CASING DIA: _____ PUMP TYPE & SIZE: submersible

GPS FIELD LOCATION: LAT. 32° 12.686 LONG. 90° 39.632

GPS CORRECTED LOCATION: LAT. 32 12 40.145 LONG. 90 39 38.524
32.21115139 90.66070111

REMARKS: Tag has been removed!

2

