

WELL SCHEDULE

Log #54

U. S. DEPT. OF THE INTERIOR

GEOLOGICAL SURVEY

WATER RESOURCES DIVISION

#54

PUNCHED

MASTER CARD

Record by P.E. Grantham Source of data Drl-t Obser Date 8/13/70 Map 9/4/59

State G.D. County 28 (or town) Hick Sequential number: 25

Latitude: 32° 08' 17" N Longitude: 090° 33' 44" W

Lat-long accuracy: 2' T. 4 S. R. 4 Sec. 36 NE. SW. SE

Local well number: 0021CD3604M04W Other number: _____

Local use: 050 Owner or name: _____

Owner or name: W. H. EVERETT Address: Utica

Ownership: (C) County, Fed Gov't, City, Corp or Co, (P) Private, (S) State Agency, Water Dist D

Use of water: (A) Air cond, Bottling, Comm, Dewater, Power, Fire, (B) Irr, (C) Med, (D) Ind, (E) P S, Rec, (F) Stock, (G) Instit, (H) Unused, (I) Recharge, (J) Desal-P S, (K) Desal-other, (L) Other H

Use of well: (A) Anode, (B) Drain, (C) Seismic, (D) Heat Res, (E) Obs, (F) Oil-gas, (G) Recharge, (H) Test, (I) Unused, (J) Withdraw, (K) Waste, (L) Destroyed W

DATA AVAILABLE: Well data Freq. W/L meas.: Field aquifer char.

Hyd. lab. data: _____

Qual. water data: type: _____

Freq. sampling: _____ Pumpage inventory: yes no period: _____

Aperture cards: _____

Log data: _____

WELL-DESCRIPTION CARD

Qat basin SAME AS ON MASTER CARD Depth well: 232 ft Meas. 3

Depth cased: _____ Casing type: _____ Diam. 3 in

Finish: (C) porous concrete, (F) gravel w. concrete, (G) gravel w. (perf.), (H) horiz. gallery, (I) open end, (J) screen, (K) sd. pt., (L) shored, (M) open hole, (N) other S

Method: (A) air bored, (B) cable, (C) dug, (D) hyd, (E) jetted, (F) air percussion, (G) reverse, (H) trenching, (I) driven, (J) drive wash, (K) other H

Date Drilled: 8/4/59 Pump intake setting: 959 ft

Driller: R. G. McNeer address _____

Lift (type): (A) air, (B) bucket, (C) cent, (D) joy, (E) multiple, (F) multiple, (G) none, (H) piston, (I) rot, (J) submerg, (K) turb, (L) other J Deep Shallow

Power (type): (A) diesel, (B) elec, (C) gas, (D) gasoline, (E) hand, (F) gas, (G) wind, (H) H.P. 1 Trans. or meter no. S

Descrip. MP _____ ft above LSD, Alt. MP _____

Alt. LSD: 200 Accuracy: (source) topo

Water Level: _____ ft above MP; _____ ft below LSD 90 Accuracy: _____

Date meas: 9/1/59 Yield: 959 gpm Method determined: _____

Drawdown: _____ ft Accuracy: _____ Pumping period: _____ hrs

QUALITY OF WATER DATA: Iron _____ ppm Sulfate _____ ppm Chloride _____ ppm Hard. _____ ppm

Sp. Conduct _____ K x 10⁶ Temp. _____ °F Date sampled: _____

Taste, color, etc. _____

Well No.

021

HYDROGEOLOGIC CARD

SAME AS ON MASTER CARD Physiographic Province: 03 Section: _____

D Drainage Basin: 15K Subbasin: _____

Topo of well site: (D) depression, stream channel, dunes, flat, hilltop, sink, swamp, (E) (F) (R) (K) (L) (G) (P) (S) (T) (U) (V) offshore, pediment, hillside, terrace, undulating, valley-flat. _____

MAJOR AQUIFER: system _____ series TM aquifer, formation, group CA

Lithology: _____ Origin: 3 Aquifer Thickness: _____ ft

Length of well open to: _____ ft Depth to top of: _____ ft

MINOR AQUIFER: system _____ series _____ aquifer, formation, group _____

Lithology: _____ Origin: _____ Aquifer Thickness: _____ ft

Length of well open to: _____ ft Depth to top of: _____ ft

Intervals Screened: _____

Depth to consolidated rock: _____ ft Source of data: _____

Depth to basement: _____ ft Source of data: _____

Surficial material: _____ Infiltration characteristics: _____

Coefficient Trans: _____ gpd/ft² Coefficient Storage: _____

Coefficient Perm: _____ gpd/ft² Spec cap: _____ gpm/ft; Number of geologic cards: _____

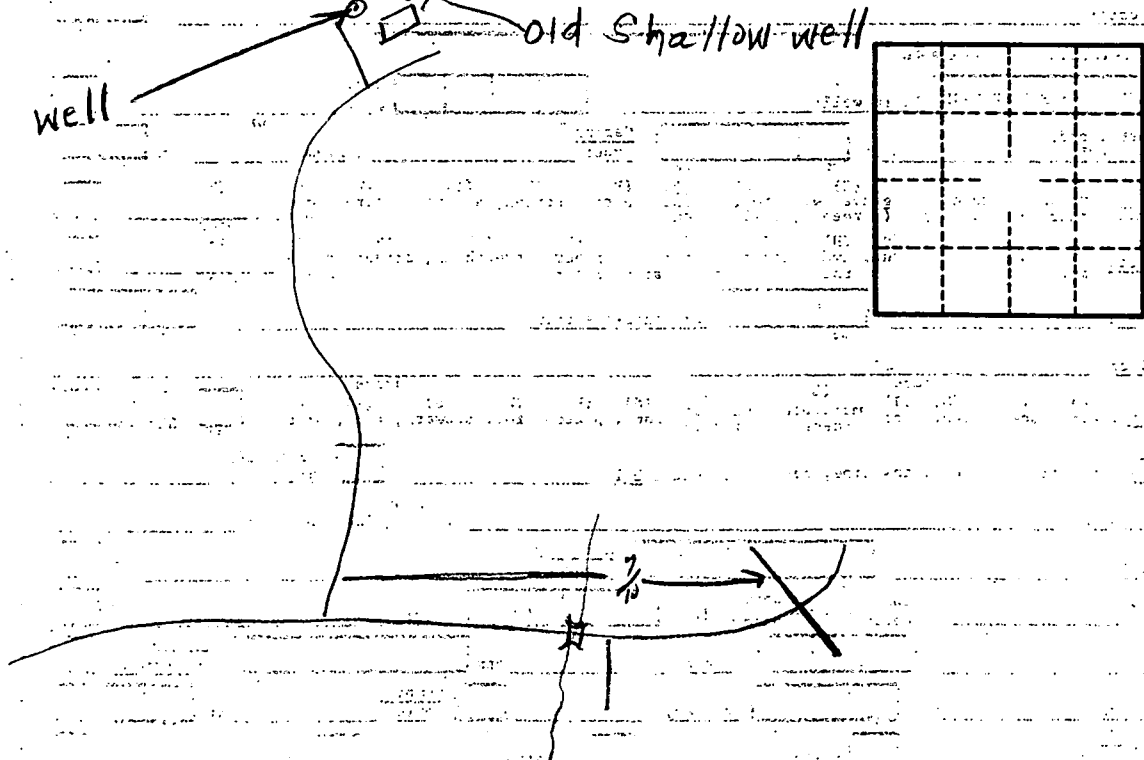

Well No.

180