

WELL SCHEDULE

U. S. DEPT. OF THE INTERIOR

GEOLOGICAL SURVEY

WATER RESOURCES DIVISION

PUNCHED

MASTER CARD

Record by B.E. Ellison Source of data D.F. Berry Date 7/1/60 8/11/70 Map \_\_\_\_\_

State G.D. County 2-8 (or town) \_\_\_\_\_ Sequential number: 2-5 1

Latitude: 32 14 20 N Longitude: 09 01 55 5 Sequential number: 1

Lat-long accuracy: 2 0 T. 5 S. R 1 Sec 26, SE t., SE t., \_\_\_\_\_

Local well number: M 0 7 2 D D 2 6 0 5 N 0 1 W Other number: \_\_\_\_\_ B & M

Local use: \_\_\_\_\_ Owner or name: \_\_\_\_\_

Owner or name: HINDS WATER CO. Address: \_\_\_\_\_

Ownership: (C) County, Fed Gov't, City, Corp or Co, Private, State Agency, (W) Water Dist. \_\_\_\_\_ W

Use of water: (A) Air cond, Bottling, Comm, Dewater, Power, Fire, Dom, Irr, Med, Ind, (P) P S, Rec, \_\_\_\_\_

Use of well: (A) Anode, Drain, Seismic, Heat Res, Obs, Oil-gas, Recharge, Test, Unused, (W) Withdraw, Waste, Destroyed. \_\_\_\_\_ W

DATA AVAILABLE: Well data  Freq. W/L meas.: \_\_\_\_\_ Field aquifer char. \_\_\_\_\_

Hyd. lab. data: \_\_\_\_\_

Qual. water data; type: \_\_\_\_\_

Freq. sampling: \_\_\_\_\_ Pumpage inventory: \_\_\_\_\_ period: \_\_\_\_\_

Aperture cards: \_\_\_\_\_

Log data: \_\_\_\_\_

WELL-DESCRIPTION CARD

SAME AS ON MASTER CARD Depth well: \_\_\_\_\_ ft 1 2 2 5 Meas. rept \_\_\_\_\_ accuracy \_\_\_\_\_

Depth cased; (first perf.) \_\_\_\_\_ ft 1 1 5 3 Casing type: 4; Diam. 6 4 3 9 in \_\_\_\_\_

Finish: (C) porous concrete, (F) gravel w. (perf.), (G) gravel w. (screen), (H) horiz. gallery, (O) open end, (P) perf., (S) screen, (T) sd. pt., (W) shored, (X) open hole, other \_\_\_\_\_

Method: (A) air rot, (B) bored, (C) cable, (D) dug, (H) hyd. jetted, (J) air percussion, (P) reverse, (R) trenching, (T) driven, (V) drive wash, (W) other \_\_\_\_\_

Date Drilled: 1960 9 6 0 Pump intake setting: \_\_\_\_\_ ft 3 3 2

Driller: David Berry \_\_\_\_\_ Benton, Miss. \_\_\_\_\_

Lift (type): (A) air, (B) bucket, (C) cent, (J) multiple, (M) multiple, (N) none, (P) piston, (R) (S) submers, (T) turb, other \_\_\_\_\_ Deep \_\_\_\_\_ Shallow \_\_\_\_\_

Power (type): diesel elec, nat gas, gasoline, hand, gas, wind; H.P. 20 V Trans. or meter no. \_\_\_\_\_

Descrip. MP \_\_\_\_\_ ft above below LSD, Alt. MP \_\_\_\_\_

Alt. LSD: \_\_\_\_\_ 3 3 5 Accuracy: (source) top \_\_\_\_\_

Water Level \_\_\_\_\_ ft above below MP; Ft \_\_\_\_\_ LSD 2 4 6 Accuracy: \_\_\_\_\_

Date meas: 7/1/60 7 6 0 Yield: \_\_\_\_\_ gpm \_\_\_\_\_ Method \_\_\_\_\_

Drawdown: \_\_\_\_\_ ft \_\_\_\_\_ Accuracy: \_\_\_\_\_ Pumping period \_\_\_\_\_ hrs \_\_\_\_\_

QUALITY OF WATER DATA: Iron \_\_\_\_\_ ppm Sulfate \_\_\_\_\_ ppm Chloride \_\_\_\_\_ ppm Hard. \_\_\_\_\_ ppm

Sp. Conduct \_\_\_\_\_ K x 10 6 \_\_\_\_\_ Temp. \_\_\_\_\_ F \_\_\_\_\_ Date sampled \_\_\_\_\_

Taste, color, etc. \_\_\_\_\_

Well No. M 72

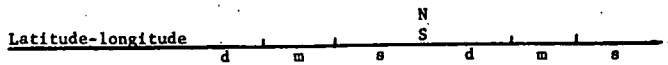

**HYDROGEOLOGIC CARD**

**SAME AS ON MASTER CARD** Physiographic Province: 03 Section: \_\_\_\_\_

**D** Drainage Basin: 137 Subbasin: \_\_\_\_\_

Topo of well site: (D) depression, (C) stream channel, (E) dunes, (F) flat, (H) hilltop, (K) sink, (L) swamp, (S) offshore, (P) pediment, (T) hillside, (U) terrace, (V) undulating, valley flat \_\_\_\_\_

**MAJOR AQUIFER:** system \_\_\_\_\_ series JTE aquifer, formation, group SS

**Lithology:** \_\_\_\_\_ US Origin: \_\_\_\_\_ **2** **AQUIFER Thickness:** \_\_\_\_\_ ft

**Length of well open to:** \_\_\_\_\_ ft **Depth to top of:** \_\_\_\_\_ ft

**MINOR AQUIFER:** system \_\_\_\_\_ series \_\_\_\_\_ aquifer, formation, group \_\_\_\_\_

**Lithology:** \_\_\_\_\_ Origin: \_\_\_\_\_ **AQUIFER Thickness:** \_\_\_\_\_ ft

**Length of well open to:** \_\_\_\_\_ ft **Depth to top of:** \_\_\_\_\_ ft

**Intervals Screened:** 60' screen 1008

**Depth to consolidated rock:** \_\_\_\_\_ ft **Source of data:** \_\_\_\_\_

**Depth to basement:** \_\_\_\_\_ ft **Source of data:** \_\_\_\_\_

**Surficial material:** \_\_\_\_\_ **Infiltration characteristics:** \_\_\_\_\_

**Coefficient Trans:** \_\_\_\_\_ gpd/ft **Coefficient Storage:** \_\_\_\_\_

**Coefficient Perm:** \_\_\_\_\_ gpd/ft<sup>2</sup>; **Spec cap:** \_\_\_\_\_ **gpm/ft; Number of geologic cards:** \_\_\_\_\_

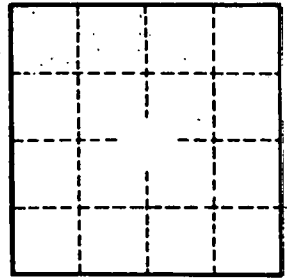
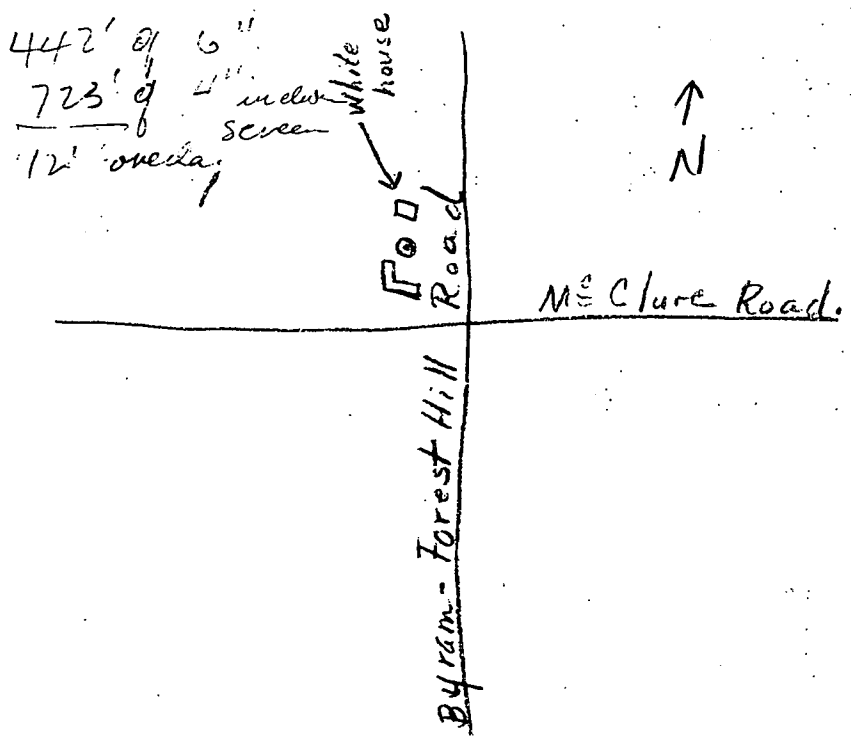

Well No. M72

M72