

This is or was an active well.
P.G.
5-3003

6W01170

9-185
(October 1950)

UNITED STATES
DEPARTMENT OF THE INTERIOR
GEOLOGICAL SURVEY
WATER RESOURCES DIVISION

WELL SCHEDULE

Date 5/25, 1963 Field No. Jackson Gas Field
Record by P. E. Grantham Office No. H-137
Source of data Don Franklin + Observation

1. Location: State Miss County Hinds

Map NE 1/4 NE 1/4 sec. 7 T 6 N 2 E
S R W

2. Owner: Colonial Country Club Address _____
Tenant _____ Address _____
Driller Dean Griner Address Columbia, Miss.

3. Topography Rolling

4. Elevation 307 ft. above below MSL Bay

5. Type: Dug drilled, driven, bored, jetted 1963

6. Depth: Rept. 827 ft. Meas. 831 ft.

7. Casing: Diam. 6" in., to 4" in., Type _____
Depth _____ ft., Finish _____

8. Chief Aquifer Sparta From _____ ft. to _____ ft.
Others _____

9. Water level 169.43 ft. above below TOP
OF CASING meas. 6-12- 1963 below surface
which is 15 ft. above below

10. Pump: Type Turbinic (Peerless) Capacity _____ G. M.
Power: Kind Elec Horsepower 100

11. Yield: Flow _____ G. M., Pump 750 G. M., Meas., Rept. Est.
Drawdown _____ ft. after _____ hours pumping _____ G. M.

12. Use: Dom., Stock, PS., RR., Ind., Irr., Obs. golf course
Adequacy, permanence _____

13. Quality _____ Temp. 82 °F.
Taste, odor, color _____ Sample Yes No
Unfit for _____

14. Remarks: (Log, Analyses, etc.) _____

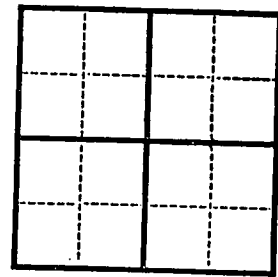

Water level 180' 6-29-66

One joint (21') ft of section

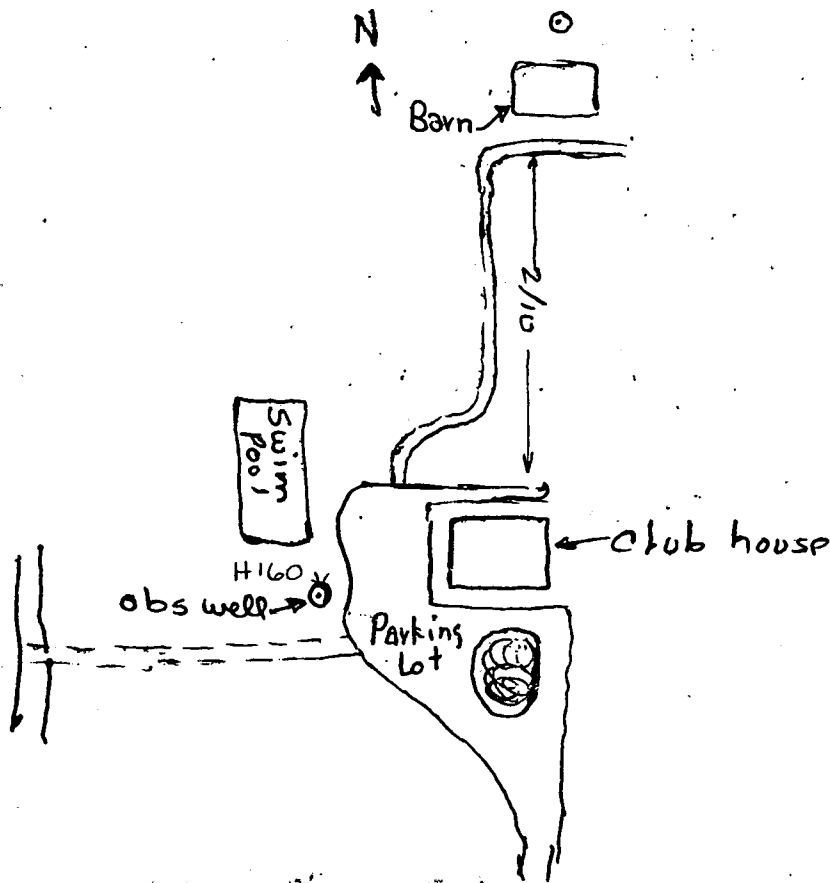

**DEPARTMENT OF ENVIRONMENTAL QUALITY - OLWR-
PUBLIC SUPPLY WELLS PROJECT**

GPS LOG

USER NAME (S) : RLB DC DATE :5-14-2003

UNIT DEQ # : _____ FILE # : _____

HEALTH DEPT. # : _____ ELEVATION :

USGS # : H137 OLWR # :GW01170

OWNER : COLONIAL COUNTRY CLUB QUAD
:RIDGELAND

LOCATION : SE NE S 7 T 6N R 2E COUNTY HINDS

LOCATION DESCRIPTION : NEXT TO SWIMMING POOL IN WELL HOUSE

CASING DIA : 6 PUMP TYPE & SIZE :SUB.

GPS FIELD LOCATION : LAT . 32.37824 LONG. 90.12805

GPS CORRECTED LOCATION : LAT . LONG.

REMARKS : P000899 ACTIVE

COLONIAL COUNTRY CLUB H137 GW01170
HINDS CO. 5-14-2003 32.37824*90.12805

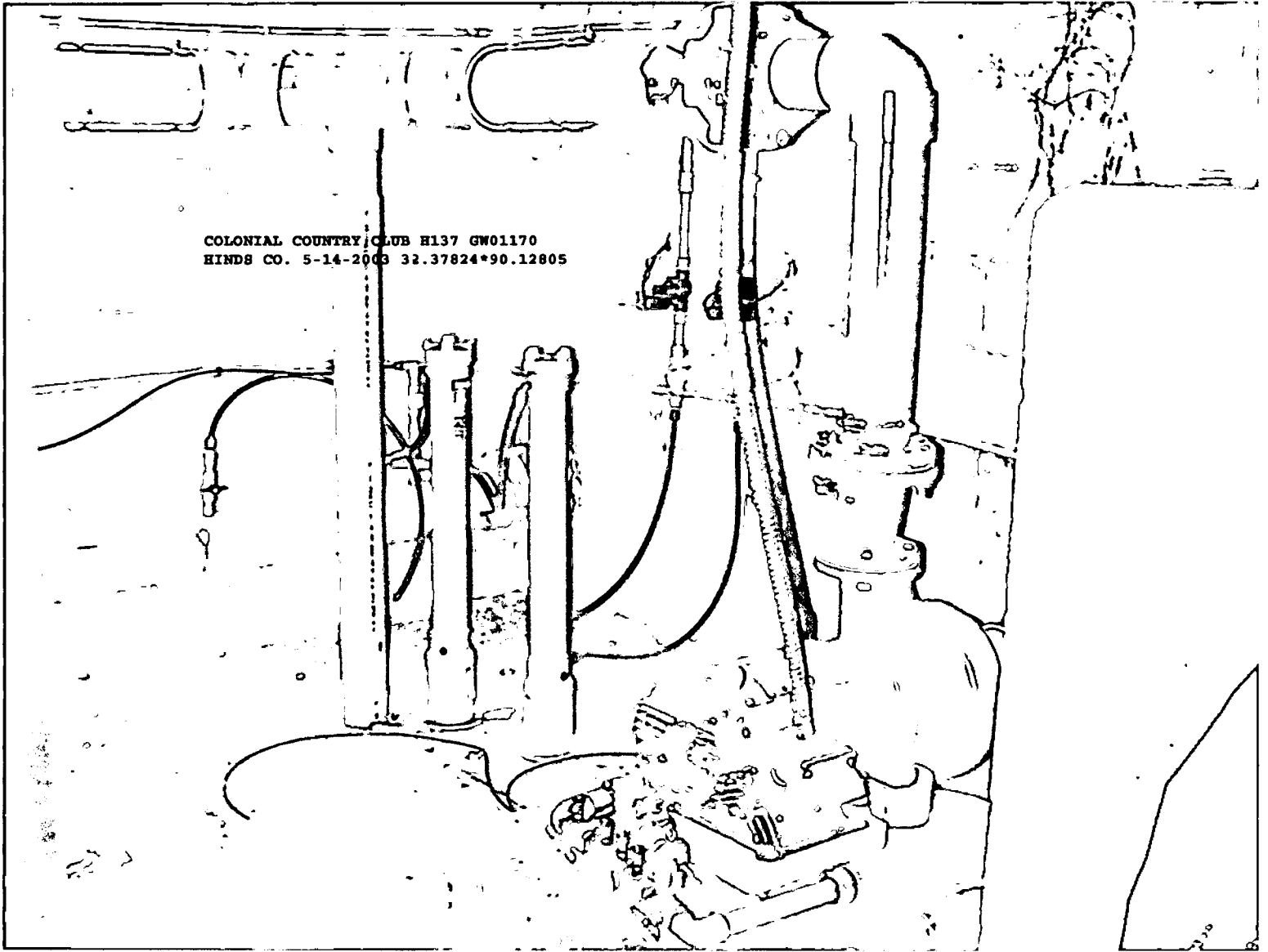



Target is 32° 22' 42"N, 90° 07' 41"W - RIDGELAND quad [Quad Info]

