

PUNCHED

WELL SCHEDULE
GEOLOGICAL SURVEY

U. S. DEPT. OF THE INTERIOR

WATER RESOURCES DIVISION

MASTER CARD

Record by E.J. Harvey Source of data Layne Central Date 10/2/60 8/4/70 Map _____

State 28 County (or town) 25

Latitude: 32° 19' 29" N Longitude: 09° 01' 31" W Sequential number: 1

Lat-long accuracy: 2 T, 6 S, R 1 Sec 33, NE & NE B & M

Local well number: H 126 A A 33 06 N 01 E Other number: _____

Local use: _____ Owner or name: Indep. Linen Serv. Co.

Owner or name: INDEP. LINEN SERV. Address: _____

Ownership: County, Fed Gov't, City, Corp or Co, Private, State Agency, Water Dist N

Use of water: (A) Air cond, Bottling, Comm, Dewater, Power, Fire, Dom, Irr, Med, Ind, P S, Rec, (N) N

Use of well: (A) Anode, Drain, Seismic, Heat Res, Obs, Oil-gas, Recharge, Test, Unused, (W) W (X) Withdraw, Waste, Destroyed

DATA AVAILABLE: Well data Freq. W/L meas.: Field aquifer char.

Hyd. lab. data: _____

Qual. water data; type: _____

Freq. sampling: _____ Pumpage inventory: yes no, period: _____

Aperture cards: _____

Log data: _____

WELL-DESCRIPTION CARD

SAME AS ON MASTER CARD Depth well: _____ ft 1010 Meas. rept accuracy 6

Depth cased: _____ ft Casing type: _____; Diam. in 9

Finish: (C) porous concrete, (F) gravel w. (perf.), (G) gravel w. (screen), (H) horiz. gallery, (J) open end, (P) perf., (S) screen, (T) sd. pt., (W) shored, (X) open hole, (Z) other 5

Method Drilled: (A) air rot, (B) bored, (C) cable, (D) dug, (H) H hyd rot, (J) jetted, (P) air percussion, (R) reverse, (T) trenching, (V) driven, (W) drive wash, (Z) other H

Date Drilled: 10/60 960 Pump intake setting: _____ ft _____

Driller: _____ name _____ address _____

Lift (type): (A) air, (B) bucket, (C) cent, (J) jet, (L) multiple, (M) multiple, (N) none, (P) piston, (R) rot, (S) submerg, (T) turb, (Z) other T Deep Shallow

Power (type): nat, diesel, el gas, gasoline, hand, gas, wind; H.P. _____ Trans. or meter no. _____

Descrip. MP _____ ft above _____ below LSD, Alt. MP _____

Alt. LSD: _____ Accuracy: (source) topo

Water Level: _____ ft above _____ below MP; _____ ft above _____ below LSD Accuracy: _____

Date meas: _____ Yield: _____ gpm _____ Method determined _____

Drawdown: _____ ft _____ Accuracy: _____ Pumping period _____ hrs _____

QUALITY OF WATER DATA: Iron _____ ppm Sulfate _____ ppm Chloride _____ ppm Hard. _____ ppm

Sp. Conduct _____ K x 10⁶ _____ Temp. _____ °F Date sampled _____

Taste, color, etc. Test Hole Abandoned; refer Log

Well No. H 126

Latitude-longitude N
S
d m s d m s

HYDROGEOLOGIC CARD

SAME AS ON MASTER CARD Physiographic Province: 03 Section: _____

Drainage Basin: D 137 Subbasin: _____

Topo of well site: (D) depression, stream channel, dunes, flat, hilltop, sink, swamp, (E) (F) (H) (K) (L) (P) (S) (T) (U) (V) offshore, pediment, hillside, terrace, undulating, valley flat

MAJOR AQUIFER: system _____ series TE aquifer, formation, group SS

Lithology: US Origin: 2 Thickness: _____ ft

Length of well open to: _____ ft Depth to top of: _____ ft

MINOR AQUIFER: system _____ series _____ aquifer, formation, group _____

Lithology: _____ Origin: _____ Thickness: _____ ft

Length of well open to: _____ ft Depth to top of: _____ ft

Intervals Screened: _____

Depth to consolidated rock: _____ ft Source of data: _____

Depth to basement: _____ ft Source of data: _____

Surficial material: _____ Infiltration characteristics: _____

Coefficient Trans: _____ gpd/ft Coefficient Storage: _____

Coefficient Perm: _____ gpd/ft²; Spec cap: _____ gpm/ft; Number of geologic cards: _____

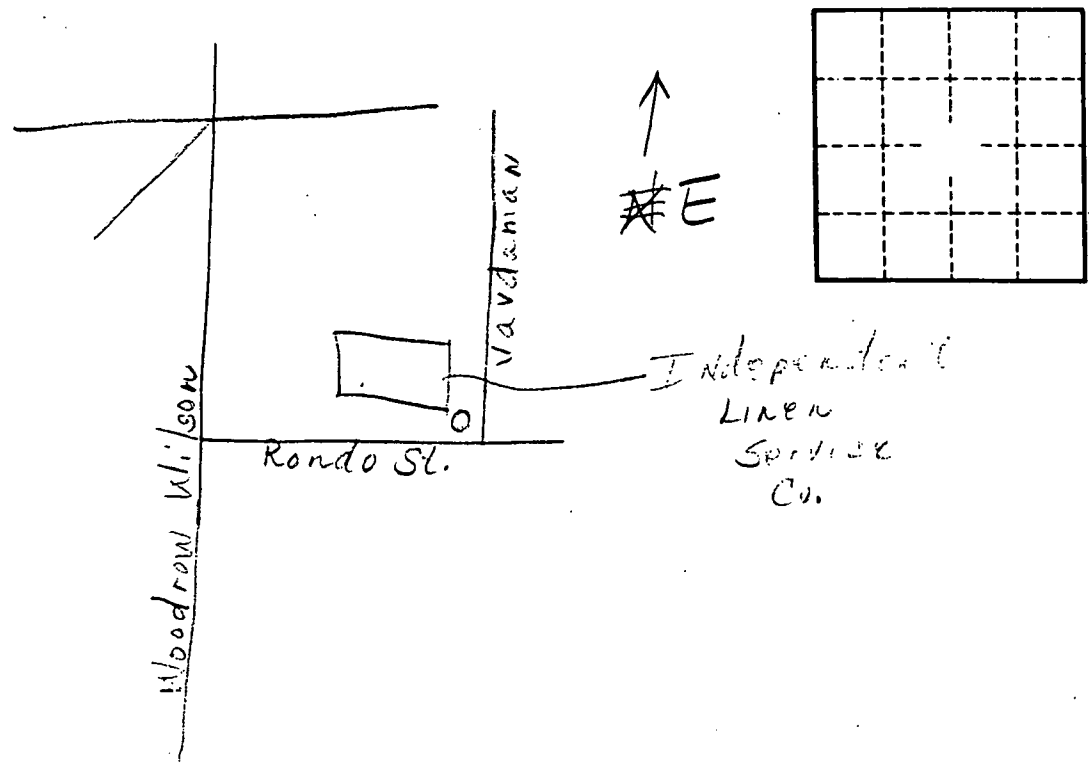

Well No. _____

H126