

9-185
(October 1950)

LOG STRIPPED B&W

UNITED STATES
DEPARTMENT OF THE INTERIOR
GEOLOGICAL SURVEY
WATER RESOURCES DIVISION

#5

WELL SCHEDULE

Date June 16, 1954 Field No. _____
Record by William Powell Office No. H 56
Source of data Mr. Richborn Mgr.

1. Location: State Miss County Hinds
Map Jackson Quad
SE, NE, SE, SE, SE 1/4 sec. 87 T 6 S R 1 W

2. Owner: Rex Brown Plant Address City
Tenant _____ Address _____
Driller Layne Central Address Hwy 80 W

3. Topography _____
4. Elevation 373 ft. above MSL
 below

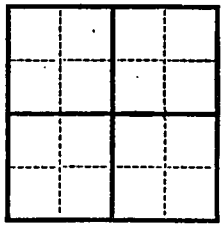

5. Type: Dug, drilled, driven, bored, jetted _____ 1950

6. Depth: Rept. 365 ft. Meas. _____ ft.

7. Casing: Diam. 10 in., to 6 in., Type _____
Depth _____ ft., Finish 75' Screen

8. Chief Aquifer Spartan From _____ ft. to _____ ft.
Others _____

9. Water level 226 ft. Rept. 1-28-1955 above _____ below _____
Turbine which is _____ ft. above _____ below surface

10. Pump: Type Centrifugal Capacity 500-600 G. M.
Power: Kind Electricity Horsepower 75

11. Yield: Flow _____ G. M., Pump 615 G. M., Meas. Rept. Est. _____
Drawdown _____ ft. after _____ hours pumping _____ G. M.

12. Use: Dom., Stock, PS., RR., Ind., Irr., Obs. _____
Adequacy, permanence _____

13. Quality Very soft Temp 80 °F.
Taste, odor, color _____ Sample Yes No
Unfit for _____

14. Remarks: (Log, Analyses, etc.) Log is about the same as #4. Observation well in test made May 2, 1960.

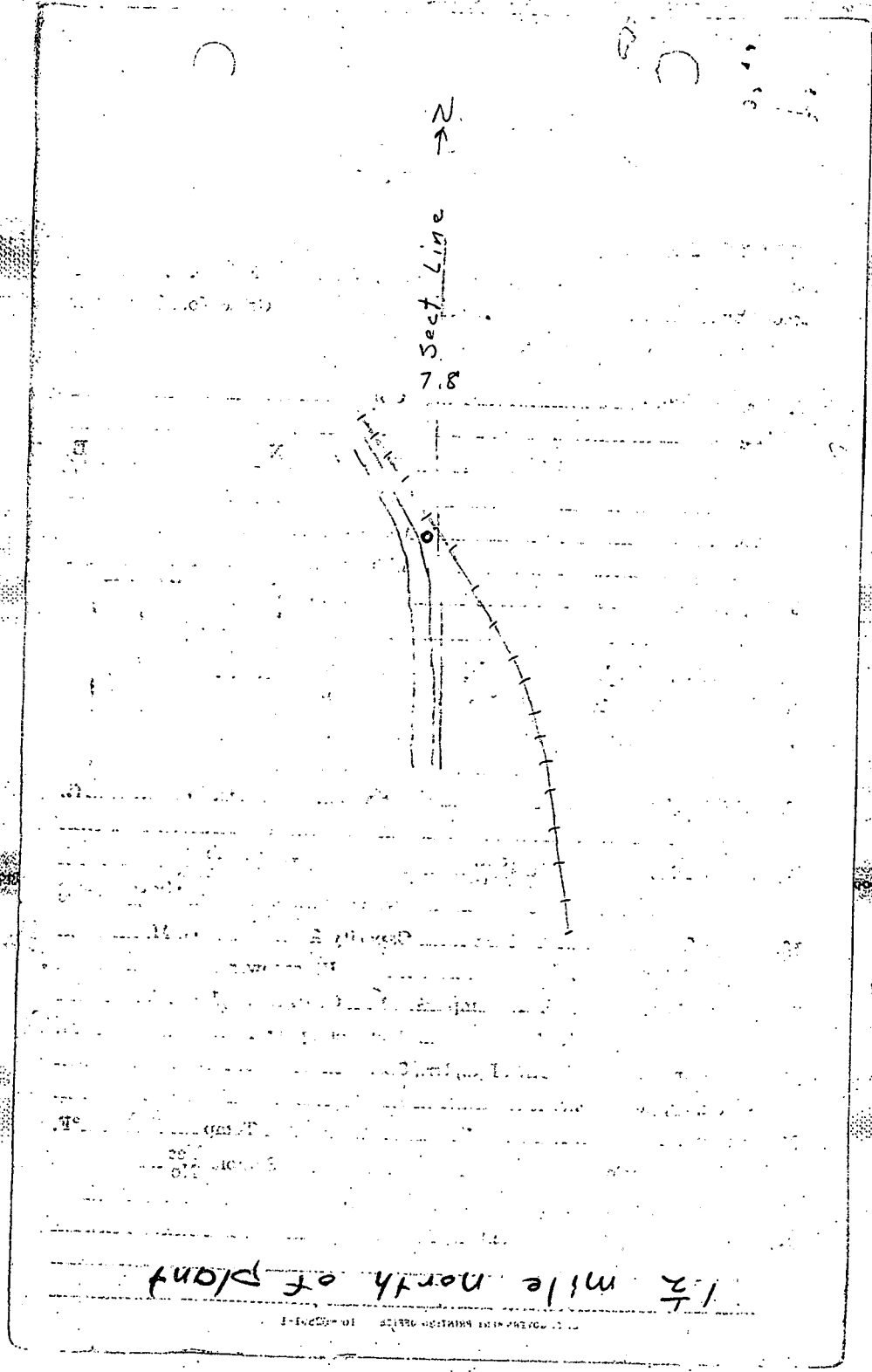

GEOLOGICAL SURVEY

LOG OF WELL State..... No. #5

County.....

Sheet 1 of.....

Attach to form 9-185; record of casing, perforations, and other pertinent hydrologic data below

Material	Thick- ness (feet)	Depth (feet)
Clay, yellow		40
shale, blue		108
shale, hard		153
shale, gummy		265
shale, hard; streaks of sand		306
shale		373
shale, streaks of sand		505
sand, fine; streaks of shale		595
shale		711
sand rock		722
shale		729
shale, streaks of sand		752
sand, fine; streaks of shale		774
sand		882

T.D. 882 June 1950 9/2/50
E. N. Hood

DEPARTMENT OF ENVIRONMENTAL QUALITY - OLWR-
PUBLIC SUPPLY WELLS PROJECT

GPS LOG

USER NAME (S): RLB + DC DATE: 1-15-2003

UNIT DEQ #: _____ FILE #: _____

HEALTH DEPT. #: _____ ELEVATION: _____

USGS #: H056 OLWR #: MS-GW-02081

OWNER: MS Power + Light QUAD: Jackson
Rex Brown Power Plant Ridgeland

LOCATION: SE NE S 7 T 6 N R 1 E COUNTY Hinds

LOCATION DESCRIPTION: Well #5 old mo.

CASING DIA: 10" PUMP TYPE & SIZE: 75 HP.
*.7 miles north of intersection of Helder Forest
between railroad + hwy.*

GPS FIELD LOCATION: LAT. 32.38083 LONG. 90.22744

GPS CORRECTED LOCATION: LAT. 32 22' 51.0" LONG. 90 13' 38.6"

REMARKS: Picture #3

P000836 PSD

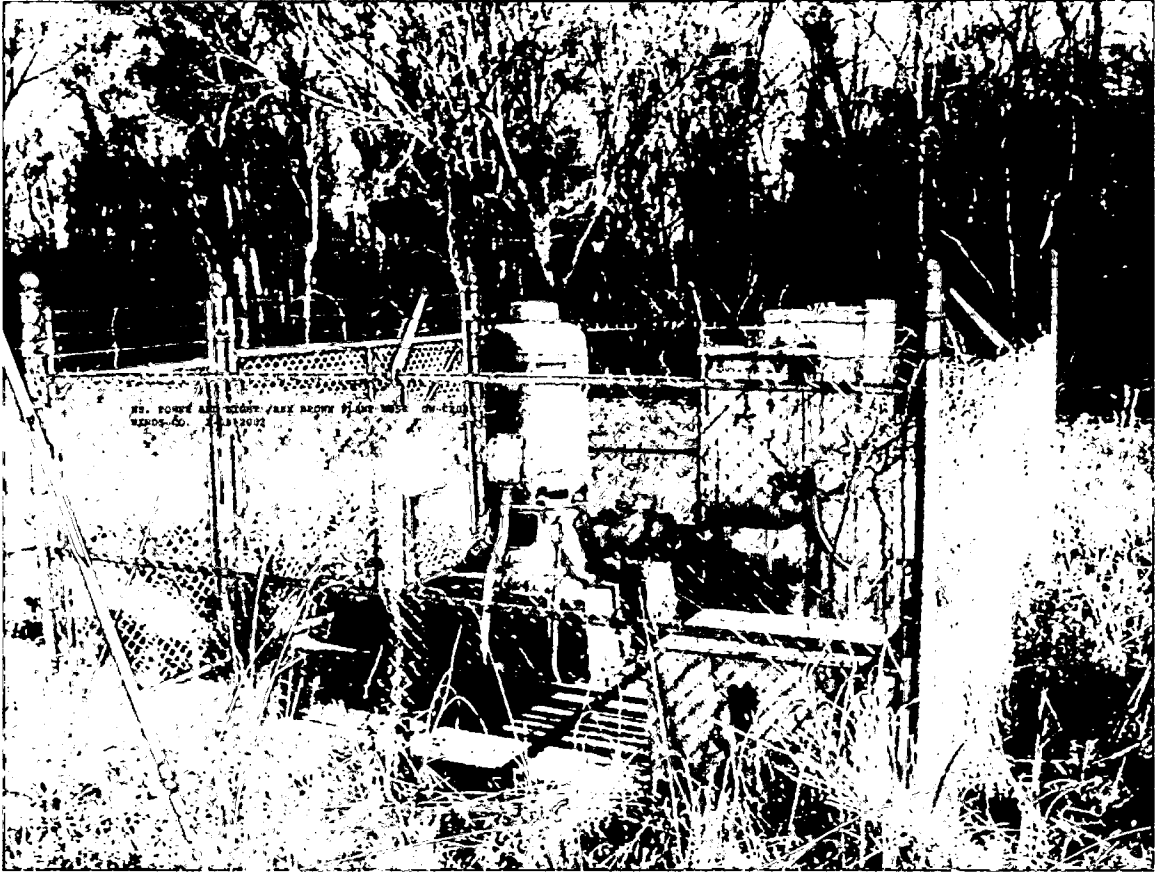

MS. Power + Light
Ry Brown Plant
GW 02081

TopoZone.com

Target is 32.3808°N, 90.2274°W - **RIDGELAND** quad [Quad Info]

