

WELL SCHEDULE

U. S. DEPT. OF THE INTERIOR

GEOLOGICAL SURVEY

WATER RESOURCES DIVISION

PURCHED

MASTER CARD

Record by E. H. Bassett Source of data INSPE. #8 Well/Date 3/12/56 7/30/70 Map

State G.D. County 28 (or town) 25

Latitude: 322244N Longitude: 090085W Sequential number: 1

Lat-long accuracy: 2 T. 6 S, R. 1 W, Sec. 12, SE, NE, SW, NW

Local well number: H039CA1206NO1E Other number:

Local use: HINDS WATER CO Owner or name: Hinds County Inspected

Ownership: (C) County Fed Gov't, City, Corp or Co, Private, State Agency, Water Dist C

Use of Air cond, Bottling, Comm, Dewater, Power, Fire, Dom, Irr, Med, Ind, P S, Rec, (P)

water: (S) (T) (U) (V) (W) (X) (Y) (Z) P

Use of well: (A) (D) (G) (H) (I) (J) (K) (L) (M) (N) (O) (P) (R) (T) (U) (W) (X) (Z) W

Anode, Drain, Seismic, Heat Res, Obs, Oil-gas, Recharge, Test, Unused, Withdraw, Waste, Destroyed.

DATA AVAILABLE: Well data 70 Freq. W/L meas.: 71 Field aquifer char. 72

Hyd. lab. data: 73

Qual. water data; type: 74

Freq. sampling: 75 Pumpage inventory: 76 yes no; period: 77 yes

Aperture cards: 78

Log data: 79

WELL-DESCRIPTION CARD

SAME AS ON MASTER CARD Depth well: 802 ft Meas. rept accuracy 24 6

Depth cased: 25 ft Casing type: 26 Diam. 8-1/2 in 29 30

Finish: porous concrete, gravel w. screen, gravel w. gallery, horiz. open end, perf., screen, sd. pt., shored, open hole, other 31

Method: (A) (B) (C) (D) (E) (F) (G) (H) (I) (J) (K) (L) (M) (N) (O) (P) (R) (T) (U) (V) (W) (Z) 32

Drilled: air bored, cable, dug, jetted, air percussion, rotary, reverse trenching, driven, drive wash, other 33

Date Drilled: 1955 9:55 Pump intake setting: 36 ft 38

Driller: Laine - Central name (L) (M) address (N) (P) (R) (S) (T) (Z) 7 Deep 40 Shallow

Lift (type): (A) (B) (C) (J) multiple, multiple, none, piston, rot, submerg, turb, other 15 4 Trans. or meter no.

Power (type): diesel, elec, gas, gasoline, hand, gas, wind; H.P. 15 4

Descrip. MP Top of concrete foundation. 1.7 ft above below LSD, Alt. MP 47 4

Alt. LSD: 323 Accuracy: (source) 48 49 50 51 52 53 54 55 56 57 58 59 60 61 62 63 64 65 66 67 68 69 70 71 72 73 74 75 76 77 78 79

Water Level: 166.33 ft above below MP; Ft below LSD 167 Accuracy: 52 53 54 55 56 57 58 59 60 61 62 63 64 65 66 67 68 69 70 71 72 73 74 75 76 77 78 79

Date meas: 10/29/57 0:57 Yield: 250 gpm 60 Method determined 61

Drawdown: 62 ft 63 Accuracy: 64 65 Pumping period 66 hrs 67 68 69 70 71 72 73 74 75 76 77 78 79

QUALITY OF WATER DATA: Iron 69 Sulfate 70 Chloride 71 Hard. 72 Sp. Conduct 73 K x 10 74 Temp. 75 °F 76 Date sampled 77 78 79

Taste, color, etc. 79

Well No. H39

Latitude-longitude

N
S

d m s d m s

HYDROGEOLOGIC CARD

SAME AS ON MASTER CARD Province: _____ Section: 03

Drainage Basin: D Subbasin: 137

Topo of well site: (D) depression, stream channel, dunes, flat, hilltop, sink, swamp, (F) offshore, pediment, hillside, terrace, undulating, valley flat

MAJOR AQUIFER: system _____ series TE aquifer, formation, group US

Lithology: _____ Origin: 2 Aquifer Thickness: _____ ft

Length of well open to: _____ ft Depth to top of: _____ ft

MINOR AQUIFER: system _____ series _____ aquifer, formation, group _____

Lithology: _____ Origin: _____ Aquifer Thickness: _____ ft

Length of well open to: _____ ft Depth to top of: _____ ft

Intervals Screened: 60' Layne Kaustane Bronze

Depth to consolidated rock: _____ ft Source of data: _____

Depth to basement: _____ ft Source of data: _____

Surficial material: _____ Infiltration characteristics: _____

Coefficient Trans: _____ gpd/ft Coefficient Storage: _____

Coefficient Perm: _____ gpd/ft; Spec cap: _____ gpm/ft; Number of geologic cards: _____

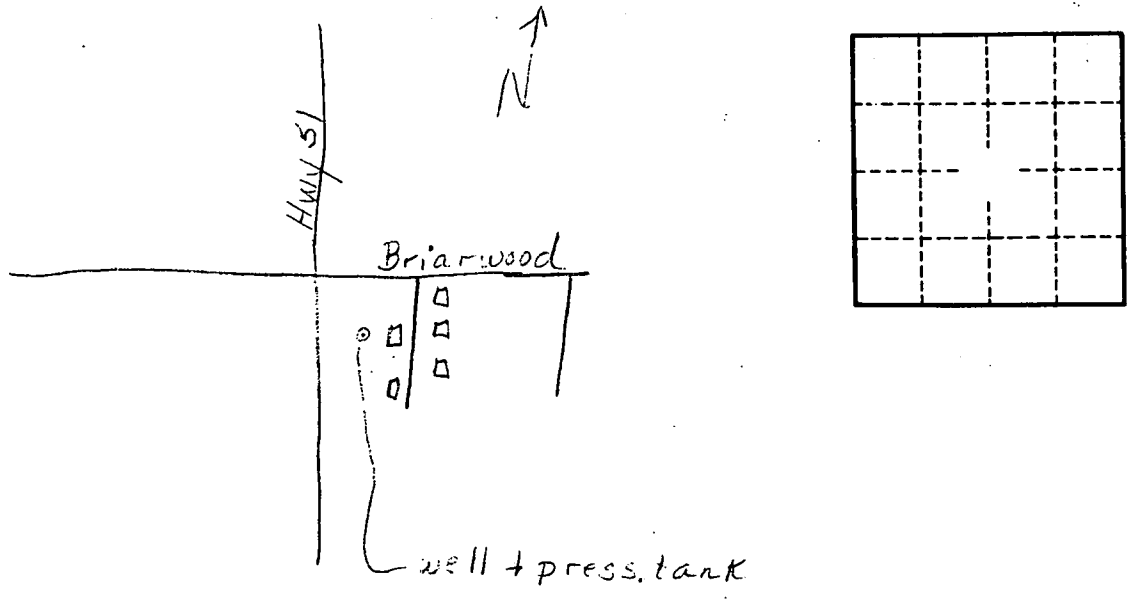

Well No. _____

H39