

WELL SCHEDULE

U. S. DEPT. OF THE INTERIOR

GEOLOGICAL SURVEY

WATER RESOURCES DIVISION

PUNCHED

MASTER CARD

Record by P. Carroll Source of data C.D. Date 10/45 7/90/70 Map \_\_\_\_\_

State 28 County (or town) 25

Latitude: 32<sup>deg</sup> 21<sup>min</sup> 30<sup>sec</sup> N Longitude: 09<sup>deg</sup> 08<sup>min</sup> 48<sup>sec</sup> W Sequential number: 1

Lat-long accuracy: 2 T. 6 S. R. 1 E. Sec. 13 NE & SE & SW & SE 4

Local well number: H1019CD1306NO1E Other number: \_\_\_\_\_

Local use: \_\_\_\_\_ Owner or name: Culley, Creekmore, Scott

Owner or name: CULY, CRMOR, SCOT Address: \_\_\_\_\_

Ownership: County, Fed Gov't, City, Corp or Co, Private, State Agency, Water Dist P

Use of Air cond, Bottling, Comm, Dewater, Power, Fire, Dom, Irr, Med, Ind, P S, Rec, \_\_\_\_\_

Water: (S) (T) (U) (V) (W) (X) (Y) (Z) H

Stock, Instit, Unused, Repressure, Recharge, Desal-P S, Desal-other, Other \_\_\_\_\_

Use of well: (A) (D) (G) (H) (I) (J) (K) (L) (M) (N) (O) (P) (R) (T) (U) (V) (W) (X) (Z) W

Anode, Drain, Seismic, Heat Res, Obs, Oil-gas, Recharge, Test, Unused, Withdraw, Waste, Destroyed. \_\_\_\_\_

DATA AVAILABLE: Well data  Freq. W/L meas.: \_\_\_\_\_ Field aquifer char. \_\_\_\_\_

Hyd. lab. data: \_\_\_\_\_

Qual. water data; type: \_\_\_\_\_

Freq. sampling: \_\_\_\_\_ Pumpage inventory:  yes  no; period: \_\_\_\_\_

Aperture cards: \_\_\_\_\_

Log data: \_\_\_\_\_

WELL-DESCRIPTION CARD

SAME AS ON MASTER CARD Depth well: \_\_\_\_\_ ft Meas. rept \_\_\_\_\_ ft accuracy \_\_\_\_\_

Depth cased; (first perf.) \_\_\_\_\_ ft Casing type: \_\_\_\_\_; Diam. \_\_\_\_\_ in

Finish: (C) porous concrete, (F) gravel v. concrete, (G) gravel v. (screen), (H) horiz. gallery, (I) open end, (J) perf., (K) screen, (L) sd. pt., (M) shored, (N) open hole, (O) other \_\_\_\_\_

Method Drilled: (A) air rot, (B) bored, (C) cable, (D) dug, (E) hyd. roy., (F) jetted, (G) air percussion, (H) reverse, (I) trenching, (J) driven, (K) wash, (L) other \_\_\_\_\_

Date Drilled: 1941 9:41 Pump intake setting: \_\_\_\_\_ ft

Driller: W.O. McMurlary, Jackson

Lift (type): (A) air, (B) bucket, (C) cent. jet, (D) multiple, (E) multiple, (F) none, (G) piston, (H) rot, (I) submerg, (J) turb, (K) other \_\_\_\_\_ Deep  Shallow

Power (type): (A) diesel, (B) elec, (C) gas, (D) gasoline, (E) hand, (F) gas, (G) wind, (H) H.P. 1/2 Trans. or meter no. T

Descrip. MP Base distance of pump is 1.0 ft above  below  LSD, Alt. MP \_\_\_\_\_

Alt. LSD: 330.57 331 Accuracy: (source) \_\_\_\_\_

Water Level: 179.42 ft above  below  MP; Ft above  below  LSD 179 Accuracy: \_\_\_\_\_

Date mea: 10/18/56 Yield: 0.56 gpm \_\_\_\_\_ Method determined \_\_\_\_\_

Drawdown: \_\_\_\_\_ ft Accuracy: \_\_\_\_\_ Pumping period \_\_\_\_\_ hrs

QUALITY OF WATER DATA: Iron \_\_\_\_\_ ppm Sulfate \_\_\_\_\_ ppm Chloride \_\_\_\_\_ ppm Hard. \_\_\_\_\_ ppm

Sp. Conduct \_\_\_\_\_ K x 10<sup>6</sup> Temp. \_\_\_\_\_ °F Date sampled \_\_\_\_\_

Taste, color, etc. \_\_\_\_\_

Well No. H19

Latitude-longitude \_\_\_\_\_ N \_\_\_\_\_ S \_\_\_\_\_ d \_\_\_\_\_ m \_\_\_\_\_ s

**HYDROGEOLOGIC CARD**

SAME AS ON MASTER CARD Physiographic Province: \_\_\_\_\_ Section: 03

Drainage Basin: D Subbasin: 137

Topo of well site: (D) depression, (C) stream channel, (E) dunes, (F) flat, (R) hilltop, (K) sink, (L) swamp, (M) offshore, (P) pediment, (S) hillside, (T) terrace, (U) undulating, (V) valley flat

MAJOR AQUIFER: system \_\_\_\_\_ series \_\_\_\_\_ aquifer, formation, group \_\_\_\_\_

Lithology: \_\_\_\_\_ Origin: \_\_\_\_\_ Aquifer Thickness: \_\_\_\_\_ ft

Length of well open to: \_\_\_\_\_ ft Depth to top of: \_\_\_\_\_ ft

MINOR AQUIFER: system \_\_\_\_\_ series \_\_\_\_\_ aquifer, formation, group \_\_\_\_\_

Lithology: \_\_\_\_\_ Origin: \_\_\_\_\_ Aquifer Thickness: \_\_\_\_\_ ft

Length of well open to: \_\_\_\_\_ ft Depth to top of: \_\_\_\_\_ ft

Intervals Screened: \_\_\_\_\_

Depth to consolidated rock: \_\_\_\_\_ ft Source of data: \_\_\_\_\_

Depth to basement: \_\_\_\_\_ ft Source of data: \_\_\_\_\_

Surficial material: \_\_\_\_\_ Infiltration characteristics: \_\_\_\_\_

Coefficient Trans: \_\_\_\_\_ gpd/ft Coefficient Storage: \_\_\_\_\_

Coefficient Perm: \_\_\_\_\_ gpd/ft<sup>2</sup>; Spec cap: \_\_\_\_\_ gpm/ft; Number of geologic cards: \_\_\_\_\_

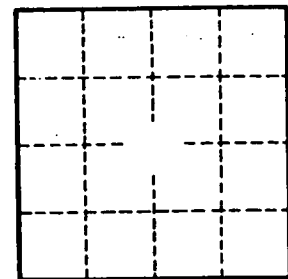
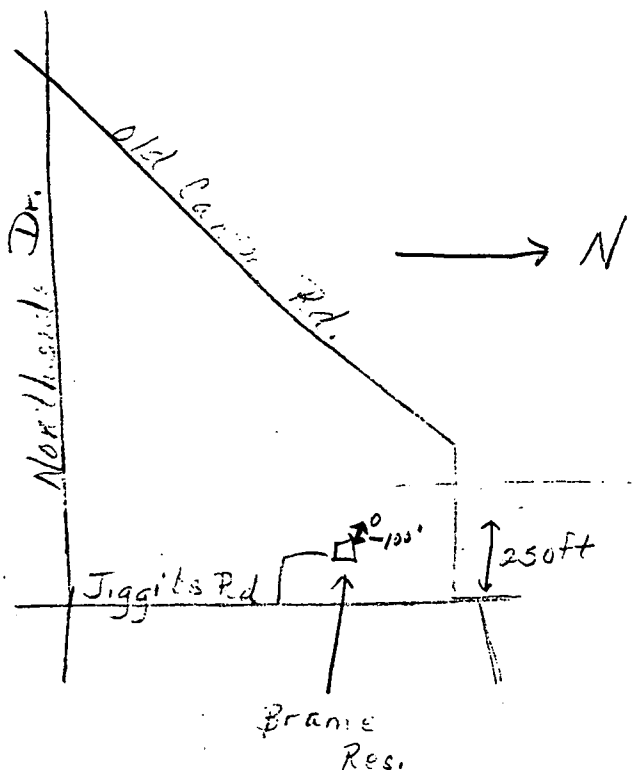

Well No. \_\_\_\_\_

419