

WELL SCHEDULE

U. S. DEPT. OF THE INTERIOR

GEOLOGICAL SURVEY

WATER RESOURCES DIVISION

PUNCHED

MASTER CARD

Record by E.J. Harvey Source of data Driller Date 7/28/70 Map \_\_\_\_\_

State G.D. County 28 (or town) \_\_\_\_\_ Sequential number: 1

Latitude: 32 21 16 N Longitude: 090 20 42 W  
 Lat-long accuracy: 2 T. 6 S. R. 1 Sec 19, NW $\frac{1}{4}$ , NW $\frac{1}{4}$ , NW $\frac{1}{4}$

Local well number: G0588B1906NO1W Other number: \_\_\_\_\_ B & M

Local use: \_\_\_\_\_ Owner or name: FIRST MISS. CORP. Address: \_\_\_\_\_

Ownership: County, Fed Gov't, City, Corp or Co, Private, State Agency, Water Dist \_\_\_\_\_ N

Use of water: (A) Air cond, Bottling, Comm, Dewater, Power, Fire, Dom, Irr, Med, Ind, P S, Rec, (S) Stock, Instit, (U) Unused, (V) Recharge, (W) Desal-P S, (X) Desal-other, Other \_\_\_\_\_ U

Use of well: (A) Anode, (D) Drain, (G) Seismic, (H) Heat Res, (I) Obs, (J) Oil-gas, (K) Recharge, (L) Test, (M) Unused, (N) Withdraw, (O) Waste, (P) Destroyed. \_\_\_\_\_ U

DATA AVAILABLE: Well data \_\_\_\_\_ Freq. W/L meas.: \_\_\_\_\_ Field aquifer char. \_\_\_\_\_

Hyd. lab. data: \_\_\_\_\_

Qual. water data; type: \_\_\_\_\_

Freq. sampling: \_\_\_\_\_ Pumpage inventory: \_\_\_\_\_

Aperture cards: \_\_\_\_\_

Log data: \_\_\_\_\_

WELL-DESCRIPTION CARD

SAME AS ON MASTER CARD Depth well: 998 ft Meas. rept accuracy \_\_\_\_\_

Depth cased: \_\_\_\_\_ Casing type: \_\_\_\_\_; Diam. \_\_\_\_\_ in

Finish: (C) porous concrete, (F) gravel w. (G) horiz. (H) open end, (I) screen, (J) sd. pt., (K) shored, (L) open hole, (M) other \_\_\_\_\_ S

Method: (A) air bored, (B) cable, (C) dug, (D) hyd rot., (E) jetted, (F) air percussion, (G) reverse, (H) trenching, (I) driven, (J) drive wash, (K) other \_\_\_\_\_ H

Date Drilled: 1/60 960 Pump intake setting: \_\_\_\_\_ ft

Driller: Layne Central address \_\_\_\_\_

Lift (type): (A) air, (B) bucket, (C) cent, (D) jet, (E) multiple, (F) multiple, (G) none, (H) piston, (I) rot, (J) submerg, (K) turb, (L) other \_\_\_\_\_ Deep \_\_\_\_\_ Shallow \_\_\_\_\_

Power (type): (A) diesel, (B) elec, (C) gas, (D) gasoline, (E) hand, (F) gas, (G) wind; H.P. \_\_\_\_\_ Trans. or meter no. \_\_\_\_\_

Descrip. MP \_\_\_\_\_ ft above \_\_\_\_\_ below LSD, Alt. MP \_\_\_\_\_

Alt. LSD: 360 Accuracy: (source) \_\_\_\_\_

Water Level \_\_\_\_\_ ft above \_\_\_\_\_ below MP; \_\_\_\_\_ ft below LSD Accuracy: \_\_\_\_\_

Date meas: \_\_\_\_\_ Yield: \_\_\_\_\_ gpm \_\_\_\_\_ Method determined \_\_\_\_\_

Drawdown: \_\_\_\_\_ ft Accuracy: \_\_\_\_\_ Pumping period \_\_\_\_\_ hrs

QUALITY OF WATER DATA: Iron \_\_\_\_\_ ppm Sulfate \_\_\_\_\_ ppm Chloride \_\_\_\_\_ ppm Hard. \_\_\_\_\_ ppm

Sp. Conduct \_\_\_\_\_ K x 10<sup>6</sup> Temp. \_\_\_\_\_ °F Date sampled \_\_\_\_\_

Taste, color, etc. \_\_\_\_\_

Well No. G58

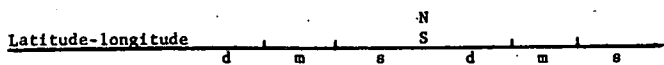

**HYDROGEOLOGIC CARD**

**SAME AS ON MASTER CARD** **Physiographic Province:** 03 **Section:** \_\_\_\_\_

**Drainage Basin:** D **Subbasin:** 15K

**Topo of well site:** (D) depression, stream channel, dunes, flat, hilltop, sink, swamp, (K) (L) (P) (S) (T) (U) (V) offshore, pediment, hillside, terrace, undulating, valley flat. 27

**MAJOR AQUIFER:** system \_\_\_\_\_ series TE aquifer, formation, group SP

**Lithology:** \_\_\_\_\_ **Origin:** US **Aquifer Thickness:** 2 ft

**Length of well open to:** \_\_\_\_\_ ft **Depth to top of:** \_\_\_\_\_ ft

**MINOR AQUIFER:** system \_\_\_\_\_ series \_\_\_\_\_ aquifer, formation, group \_\_\_\_\_

**Lithology:** \_\_\_\_\_ **Origin:** \_\_\_\_\_ **Aquifer Thickness:** \_\_\_\_\_ ft

**Length of well open to:** \_\_\_\_\_ ft **Depth to top of:** \_\_\_\_\_ ft

**Intervals Screened:** \_\_\_\_\_

**Depth to consolidated rock:** \_\_\_\_\_ ft **Source of data:** \_\_\_\_\_

**Depth to basement:** \_\_\_\_\_ ft **Source of data:** \_\_\_\_\_

**Surficial material:** \_\_\_\_\_ **Infiltration characteristics:** \_\_\_\_\_

**Coefficient Trans:** \_\_\_\_\_ gpd/ft **Coefficient Storage:** \_\_\_\_\_

**Perm:** \_\_\_\_\_ gpd/ft<sup>2</sup>; Spec cap: \_\_\_\_\_ gpm/ft; Number of geologic cards: \_\_\_\_\_

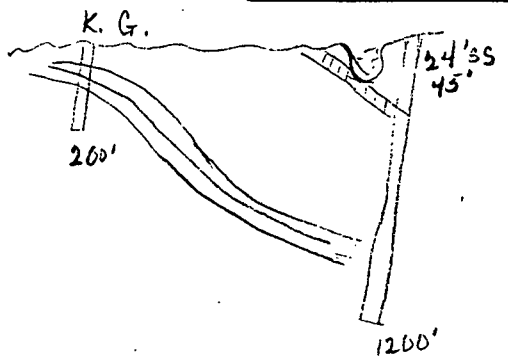
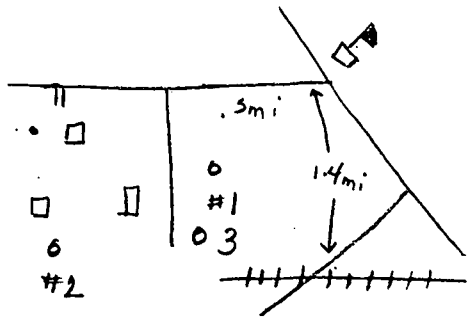
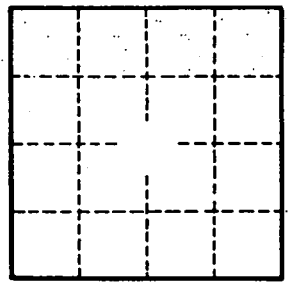
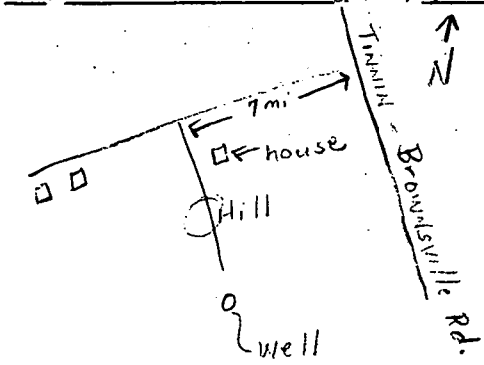

Well No. \_\_\_\_\_

G58