

WELL SCHEDULE

U. S. DEPT. OF THE INTERIOR

GEOLOGICAL SURVEY

WATER RESOURCES DIVISION

PUNCHED

MASTER CARD

Record by Callahan + Passings Source of data Mrs. Mayo Date 7/3/56 7/27/70 Map

State G.D. County 28 (or town) 25

Latitude: 32° 23' 36" N Longitude: 09° 01' 44" W Sequential number: 1

Lat-long accuracy: 2 T. 6 S. R. 1 E. Sec. 1, NW 1/4, SW 1/4, NE 1/4

Local well number: G019CA0106ND1W Other number: _____

Local use: _____ Owner or name: _____ Address: Rt 3 Box 41A Pocahontas

Ownership: County, Fed Gov't, City, Corp or Co., Private, State Agency, Water Dist P

Use of water: (A) Air cond, Bottling, Comm, Dewater, Power, Fire, Irr, Mad, Ind, P S, Rec, (B) Stock, Instit, Unused, Repressure, Recharge, Desal-P S, Desal-other, Other H

Use of well: (A) Anode, Drain, Seismic, Heat Res, Obs, Oil-gas, Recharge, Test, Unused, Withdraw, Waste, Destroyed. W

DATA AVAILABLE: Well data Freq. W/L meas.: Field aquifer char.

Hyd. lab. data: _____

Qual. water data; type: _____

Freq. sampling: _____ Pumpage inventory: yes no; period: _____

Aperture cards: _____

Log data: _____

WELL-DESCRIPTION CARD

SAME AS ON MASTER CARD Depth well: 1140 ft Meas. rept. accuracy 3

Depth cased: _____ ft Casing type: _____; Diam. 3/2 in

Finish: porous concrete, gravel w. (perf.), gravel w. (screen), horiz. gallery, open end, (H) (P) (S) (T) (W) (X) (B) other S

Method Drilled: (A) air rot, (B) bored, cable, dug, rot., (C) jetted, (D) percussion, (E) air rot., (F) reverse, (G) trenching, (H) driven, (I) wash, (J) other H

Date Drilled: 1947 947 Pump intake setting: _____ ft

Driller: Guy Davis

Lift (type): (A) air, (B) bucket, (C) cent. jet, (D) multiple, (E) multiple, (F) none, (G) piston, (H) rot., (I) submerg, (J) turb., (K) other J Deep Shallow

Power (type): diesel, elec, gas, gasoline, hand, gas, wind; H.P. 3 Trans. or meter no. T

Descrip. MP _____ ft above LSD, Alt. MP _____

Alt. LSD: 334 Accuracy: (source) 4

Water Level 148.75 ft above MP; Ft below LSD 149 Accuracy: G

Date meas: 8/29/46 846 Yield: _____ gpm Method determined 8

Drawdown: _____ ft Accuracy: _____ hrs

QUALITY OF WATER DATA: Iron _____ ppm Sulfate _____ ppm Chloride _____ ppm Hard. _____ ppm

Sp. Conduct _____ K x 10⁶ Temp. _____ °F Date sampled _____

Taste, color, etc. _____

Well No.

G19

Latitude-longitude _____
d m s d m s

HYDROGEOLOGIC CARD

SAME AS ON MASTER CARD

Physiographic Province: _____

03 Section: _____

D Drainage Basin: _____

15K Subbasin: _____

Topo of well site: (D) depression, stream channel, dunes, flat, hilltop, sink, swamp, (E) offshore, pediment, hillside, terrace, undulating, valley flat (F) (R) (K) (L) (P) (S) (T) (U) (V)

MAJOR AQUIFER:

system _____ series TE aquifer, formation, group SS

Lithology: _____ Origin: US Aquifer Thickness: 2 ft

Length of well open to: _____ ft Depth to top of: _____ ft

MINOR AQUIFER:

system _____ series _____ aquifer, formation, group _____

Lithology: _____ Origin: _____ Aquifer Thickness: _____ ft

Length of well open to: _____ ft Depth to top of: _____ ft

Intervals Screened: #6 20' screen

Depth to consolidated rock: _____ ft Source of data: _____

Depth to basement: _____ ft Source of data: _____

Surficial material: _____ Infiltration characteristics: _____

Coefficient Trans: _____ gpd/ft Coefficient Storage: _____

Coefficient Perm: _____ gpd/ft²; Spec cap: _____ gpm/ft; Number of geologic cards: _____

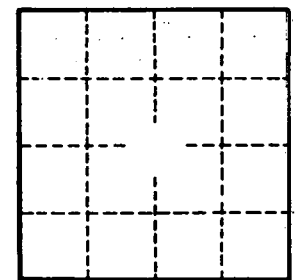
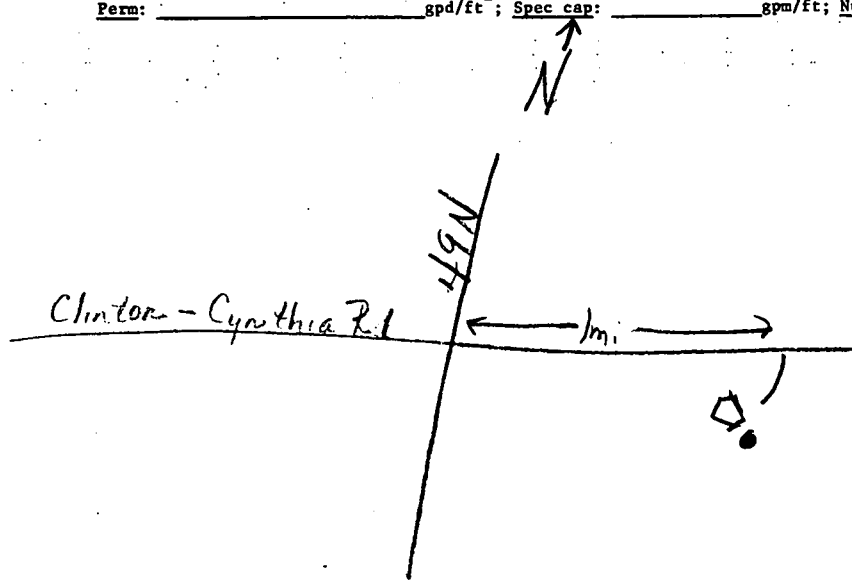

Well No. _____

G19