

WELL SCHEDULE

U. S. DEPT. OF THE INTERIOR

GEOLOGICAL SURVEY

WATER RESOURCES DIVISION

**KEPT
PUNCHED**

MASTER CARD

Record by E. H. Boswell Source of data Enloe Records Date _____ Map _____

State G.D. 28 County (or town) 25

Latitude: 32^{deg} 21^{min} 30^{sec} N Longitude: 09^{degrees} 02^{min} 05^{sec} W Sequential number: 1

Lat-long accuracy: 3 T. 6 S. R. 2 E. Sec 18 NE SE SE

Local well number: F013D1806N02W Other number: _____

Local use: _____ Owner or name: _____

Owner or name: J. M. VANCE Address: R4 Bolton, Miss

Ownership: County, Fed Gov't, City, Corp or Co, (P) Private, State Agency, Water Dist _____

Use of water: (A) Air cond, Bottling, Comm, Dewater, Power, Fire, (H) Dom, Irr, Med, Ind, P S, Rec, (S) Stock, Instat, Unused, Repressure, Recharge, Desal-P S, Desal-other, Other _____

Use of well: (A) Anode, Drain, Seismic, Heat Res, Obs, Oil-gas, Recharge, Test, Unused, (W) Withdraw, Waste, Destroyed. _____

DATA AVAILABLE: Well data Freq. W/L meas.: Field aquifer char.

Hyd. lab. data: _____

Qual. water data; type: _____

Freq. sampling: _____ Pumpage inventory: yes no, period: _____

Aperture cards: _____

Log data: _____

WELL-DESCRIPTION CARD

SAME AS ON MASTER CARD Depth well: _____ ft 924 Meas. rept. accuracy _____

Depth cased: _____ ft Casing type: _____; Diam. 3x2 in

Finish: porous concrete, gravel w. (F), gravel w. (G), horiz. (H), open (O), perf., (S) screen, sd. pt., shored, open hole, other _____

Method Drilled: (A) air rot, (B) bored, cable, dug, (C) hyd rot, (D) jetted, (E) percussion, (F) rotary, (G) reverse trenching, (H) driven, (I) air wash, (J) other _____

Date Drilled: 12/22/50 D50 Pump intake setting: _____ ft

Driller: Enloe Tool Co.

Lift (type): (A) air, bucket, cent, (B) multiple, (C) multiple, (D) multiple, (E) none, (F) piston, (G) rot, (H) submerg, (I) turb, (J) other _____ Deep Shallow

Power (type): diesel, elec, nat gas, gasoline, hand, gas, wind; H.P. _____ Trans. or meter no. _____

Descrip. MP _____ ft above _____ ft below LSD, Alt. MP _____

Alt. LSD: _____ Accuracy: (source) _____

Water Level: _____ ft above _____ ft below MP; Ft below LSD _____ Accuracy: _____

Date meae: _____ Yield: _____ gpm _____ Method determined _____

Drawdown: _____ ft _____ Accuracy: _____ Pumping period: _____ hrs _____

QUALITY OF WATER DATA: Iron _____ ppm Sulfate _____ ppm Chloride _____ ppm Hard. _____ ppm

Sp. Conduct _____ K x 10⁶ _____ Temp. _____ °F _____ Date sampled _____

Taste, color, etc. Plumb set @ 189'

Well No.

F13

Latitude-longitude N
S
d m s d m s

HYDROGEOLOGIC CARD

SAME AS ON MASTER CARD **Physiographic Province:** 03 **Section:** _____

Drainage Basin: D **Subbasin:** 15K

Topo of well site: (D) depression, stream channel, dunes, flat, hilltop, sink, swamp, (E) (F) (R) (K) (L) (P) (S) (T) (U) (V) offshore, pediment, hillside, terrace, undulating, valley flat. 27

MAJOR AQUIFER: system _____ series TE aquifer, formation, group C0

Lithology: _____ **Origin:** 2 **Aquifer Thickness:** _____ ft

Length of well open to: _____ ft **Depth to top of:** _____ ft

MINOR AQUIFER: system _____ series _____ aquifer, formation, group _____

Lithology: _____ **Origin:** _____ **Aquifer Thickness:** _____ ft

Length of well open to: _____ ft **Depth to top of:** _____ ft

Intervals Screened: 40' 9" stainless steel 814'-924'

Depth to consolidated rock: _____ ft **Source of data:** _____

Depth to basement: _____ ft **Source of data:** _____

Surficial material: _____ **Infiltration characteristics:** _____

Coefficient Trans: _____ gpd/ft **Coefficient Storage:** _____

Coefficient Perm: _____ gpd/ft²; **Spec cap:** _____ **gpm/ft; Number of geologic cards:** _____

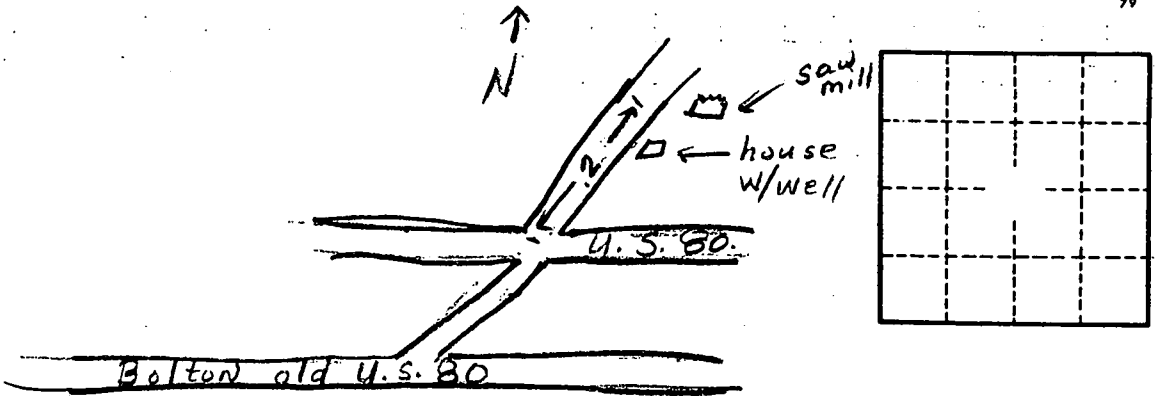

Well No.

F13