

WELL SCHEDULE  
GEOLOGICAL SURVEY

U. S. DEPT. OF THE INTERIOR

Elog 128  
WATER RESOURCES  
**PONCHED**

MASTER CARD

Record by P. E. GRANTHEM Source of data Driller + OBSERVE Date 3/17/61 7/21/70 Map \_\_\_\_\_

State C.D. County 28 (or town) \_\_\_\_\_

Latitude: 32° 24' 42" N Longitude: 090° 17' 50" W Sequential number: 1

Lat-long accuracy: 2 T, 7 S, R 1 E Sec 33, NW, NE, NE

Local well number: C019AA3307N01W Other number: \_\_\_\_\_

Local use: \_\_\_\_\_ Owner or name: \_\_\_\_\_

Owner or name: RAYMOND BERRY Address: Reahontas

Ownership: County, Fed Gov't, City, Corp or Co, Private, State Agency, Water Dist \_\_\_\_\_

Use of water: (A) Air cond, Bottling, Comm, Dewater, Power, Fire, Dom, Irr, Med, Ind, P S, Rec, (S) Stock, Instit, Unused, Repressure, Recharge, Desal-P S, Desal-other, Other \_\_\_\_\_

Use of well: (A) Anode, Drain, Seismic, Heat Res, Obs, Oil-gas, Recharge, Test, Unused, Withdraw, Waste, Destroyed, \_\_\_\_\_

DATA AVAILABLE: Well data  Freq. W/L meas.: \_\_\_\_\_ Field aquifer char. \_\_\_\_\_

Hyd. lab. data: \_\_\_\_\_

Qual. water data; type: \_\_\_\_\_

Freq. sampling: \_\_\_\_\_ Pumpage inventory: \_\_\_\_\_

Aperture cards: \_\_\_\_\_

Log data: \_\_\_\_\_

WELL-DESCRIPTION CARD

SAME AS ON MASTER CARD Depth well: 682 ft Meas. accuracy \_\_\_\_\_

Depth cased: 662 ft Casing type: \_\_\_\_\_; Diam. 4x2 in

Finish: (C) porous concrete, (F) gravel w. concrete, (G) gravel w. (screen), (H) horiz. gallery, (P) open end, (S) perf., (T) sd. pt., (W) shored, (X) open hole, (B) other \_\_\_\_\_

Method Drilled: (A) air rot, (B) bored, (C) cable, (D) dug, (H) hyd rot, (J) jetted, (P) air percussion, (R) reverse, (T) trenching, (V) driven, (W) drive wash, (B) other \_\_\_\_\_

Date Drilled: 5/61 9/61 Pump intake setting: \_\_\_\_\_ ft

Driller: J. McNEES JACKSON

Lift (type): (A) air, (B) bucket, (C) cent, (J) jet, (L) multiple, (M) multiple, (N) none, (P) piston, (R) rot, (S) submerg, (T) turb, (B) other \_\_\_\_\_ Deep \_\_\_\_\_

Power (type): (nat) diesel, (elec) gas, gasoline, hand, gas, wind; H.P. 3/4 Trans. or meter no. \_\_\_\_\_

Descrip. MP \_\_\_\_\_ ft above \_\_\_\_\_ ft below LSD, Alt. MP \_\_\_\_\_

Alt. LSD: 240 Accuracy: (source) \_\_\_\_\_

Water Level \_\_\_\_\_ ft above \_\_\_\_\_ ft below MP; Ft \_\_\_\_\_ LSD \_\_\_\_\_ Accuracy: \_\_\_\_\_

Date meas: 8/24/61 8/61 Yield: \_\_\_\_\_ gpm \_\_\_\_\_ Method determined \_\_\_\_\_

Drawdown: \_\_\_\_\_ ft \_\_\_\_\_ Accuracy: \_\_\_\_\_ Pumping period \_\_\_\_\_ hrs \_\_\_\_\_

QUALITY OF WATER DATA: Iron \_\_\_\_\_ ppm Sulfate \_\_\_\_\_ ppm Chloride \_\_\_\_\_ ppm Hard. \_\_\_\_\_ ppm

Sp. Conduct \_\_\_\_\_ K x 10<sup>6</sup> \_\_\_\_\_ Temp. \_\_\_\_\_ °F Date sampled \_\_\_\_\_

Taste, color, etc. \_\_\_\_\_

Well No. C19

Well No. \_\_\_\_\_

C19

Log # 128

Latitude-longitude \_\_\_\_\_

HYDROGEOLOGIC CARD

SAME AS ON MASTER CARD

Physiographic Province: \_\_\_\_\_

03

Section: \_\_\_\_\_

D

Drainage Basin: \_\_\_\_\_

15K

Subbasin: \_\_\_\_\_

Topo of well site: (D) depression, stream channel, dunes, flat, hilltop, sink, swamp, (P) offshore, pediment, hillside, terrace, undulating, valley flat

MAJOR AQUIFER:

system \_\_\_\_\_

series \_\_\_\_\_

TE

aquifer, formation, group \_\_\_\_\_

C:Ø

Lithology: \_\_\_\_\_

US

Origin: \_\_\_\_\_

2

Aquifer Thickness: \_\_\_\_\_ ft

Length of well open to: \_\_\_\_\_ ft

Depth to top of: \_\_\_\_\_ ft

MINOR AQUIFER:

system \_\_\_\_\_

series \_\_\_\_\_

aquifer, formation, group \_\_\_\_\_

Lithology: \_\_\_\_\_

Origin: \_\_\_\_\_

Aquifer Thickness: \_\_\_\_\_ ft

Length of well open to: \_\_\_\_\_ ft

Depth to top of: \_\_\_\_\_ ft

Intervals Screened:

20' .007 SS SCREEN

Depth to consolidated rock: \_\_\_\_\_ ft

Source of data: \_\_\_\_\_

Depth to basement: \_\_\_\_\_ ft

Source of data: \_\_\_\_\_

Surficial material: \_\_\_\_\_

Infiltration characteristics: \_\_\_\_\_

Coefficient Trans: \_\_\_\_\_ gpd/ft

Coefficient Storage: \_\_\_\_\_

Coefficient Perm: \_\_\_\_\_ gpd/ft<sup>2</sup>; Spec cap: \_\_\_\_\_ gpm/ft; Number of geologic cards: \_\_\_\_\_

300' of 4''

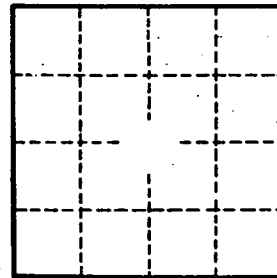
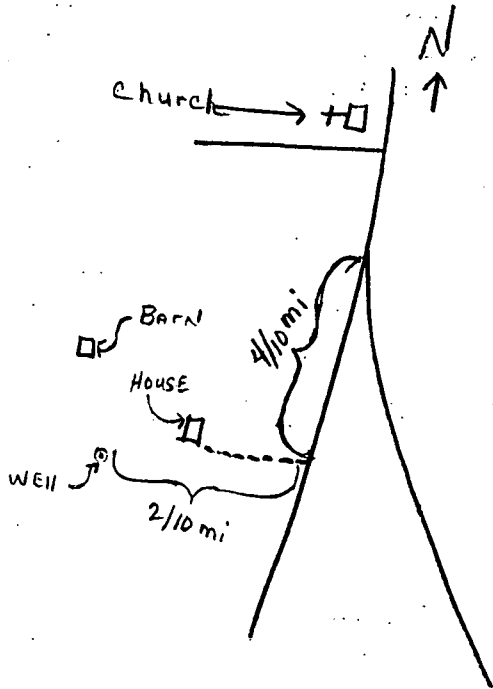

Well No. \_\_\_\_\_

C19