

302134089/41501

Well No.

Φ125

393c

WELL SCHEDULE

E log # 76

U. S. DEPT. OF THE INTERIOR

GEOLOGICAL SURVEY

WATER RESOURCES DIVISION

PUNCHED

MASTER CARD

Record by WTO Source of data Bowc Obs. driller 5/70 Date 5/70 Map _____

State MS 28 County HARRISON 24

Latitude: 30 21 34 N Longitude: 089 14 43 Sequential number: 1

Lat-long accuracy: 20 8 12 W Sec. 7 SW SW SW

Local well number: Φ125DC0708512W Other number: _____ B & M

Local use: 024076 Owner or name: _____

Owner or name: MARGOT GACK Address: _____

Ownership: County, Fed Gov't, City, Corp or Co, Private, State Agency, Water Dist P

Use of Air cond, Bottling, Comm, Dewater, Power, Fire, Dom, Irr, Med, Ind, P S, Rec, water: _____

Stock, Instit, Unused, Repressure, Recharge, Desal-P S, Desal-other, Other H

Use of well: Anode, Drain, Seismic, Heat Res, Obs, Oil-gas, Recharge, Test, Unused, Withdraw, Waste, Destroyed. W

DATA AVAILABLE: Well data Freq. W/L meas.: Field aquifer char.

Hyd. lab. data:

Qual. water data; type:

Freq. sampling: Pumpage inventory: yes no; period: _____

Aperture cards: yes

Log data: E log 8' - 1577' E

WELL-DESCRIPTION CARD

SAME AS ON MASTER CARD Depth well: 1577 ft Meas. 3

Depth cased: 1547 ft Casing type: Steel ; Diam. 4 in

Finish: porous concrete, gravel w. (screen), gravel w. (gallery), horiz. open end, perf., screen, sd. pt., shored, open hole, other S

Method Drilled: air bored, cable, dug, hyd jetted, rot., air percussion, rotary, reverse trenching, driven, drive wash, other H

Date Drilled: 5/70 9:10 Pump intake setting: _____ ft

Driller: SUTTER

Lift (type): (A) air, bucket, cent, jet, (B) multiple, (C) multiple, (D) none, piston, rot, submerg, turb, other N Deep Shallow

Power (type): diesel, elec, gas, gasoline, hand, gas, wind; H.P. Trans. or meter no. _____

Descrip. MP _____ ft above below LSD, Alt. MP _____

Alt. LSD: 12 Accuracy: Topo 3

Water Level 87 ft above below MP; Ft below LSD 48 Accuracy: 48:7 D

Date meas: 5:70 Yield: _____ gpm Method determined

Drawdown: _____ ft Accuracy: _____ Pumping period _____ hrs

QUALITY OF WATER DATA: Iron _____ ppm Sulfate _____ ppm Chloride _____ ppm Hard. _____ ppm

Sp. Conduct _____ K x 10 6 Temp. _____ °F Date sampled _____

Taste, color, etc. _____

Well No.

Φ125

Latitude-longitude _____
 d m s N S d m s

HYDROGEOLOGIC CARD

SAME AS ON MASTER CARD Physiographic Province: 03 Section: _____
 Drainage Basin: D Subbasin: 135
 Topo of well site: (D) (C) (E) (F) (H) (K) (L) (N) (P) (S) (T) (U) (V) _____
 depression, stream channel, dunes, flat, hilltop, sink, swamp, offshore, pediment, hillside, terrace, undulating, valley flat
 MAJOR AQUIFER: system _____ series T M aquifer, formation, group M Z
 Lithology: _____ Origin: 3 Aquifer Thickness: 61 ft
 Length of well open to: _____ ft Depth to top of: 1516 ft
 MINOR AQUIFER: system _____ series _____ aquifer, formation, group _____
 Lithology: _____ Origin: _____ Aquifer Thickness: _____ ft
 Length of well open to: _____ ft Depth to top of: _____ ft
 Intervals Screened: 4" SS
 Depth to consolidated rock: _____ ft Source of data: _____
 Depth to basement: _____ ft Source of data: _____
 Surficial material: _____ Infiltration characteristics: _____
 Coefficient Trans: _____ gpd/ft Coefficient Storage: _____
 Coefficient Perm: _____ gpd/ft²; Spec cap: _____ gpm/ft; Number of geologic cards: _____

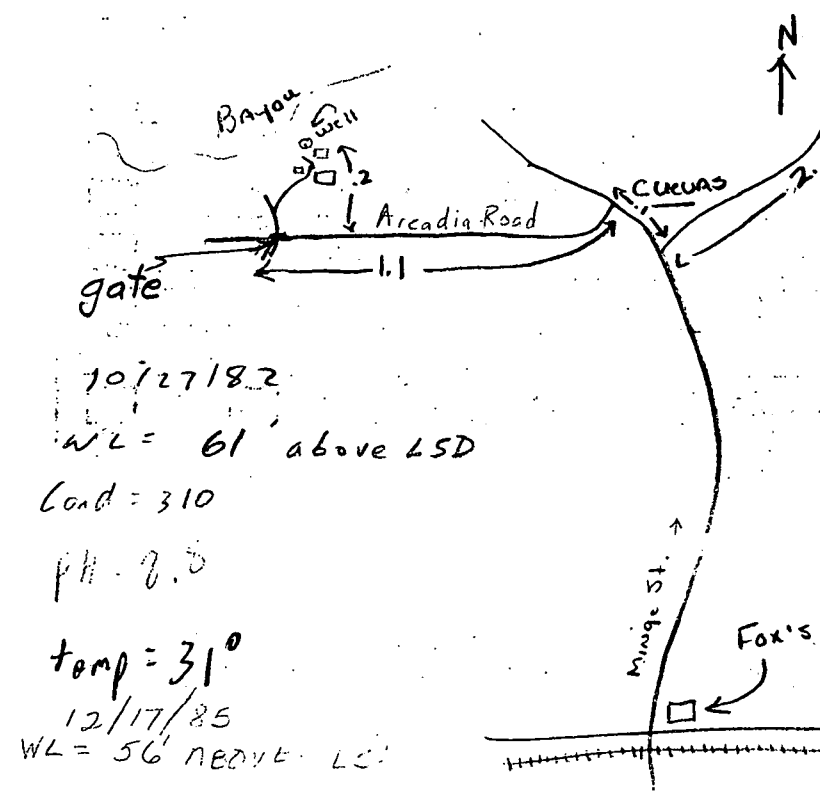

Clay	0	18
Clay - sand streaks	18	118
Sand	118	132
Clay	132	470
Sand	470	488
Clay	488	522
Sand	522	618
Clay	618	638
Sand	638	894
Clay	894	914
Sand	914	962
Clay	962	1164
Sand	1164	1192
Clay - sand streaks	1192	1516
Sand	1516	1577

CWSP COORDINATES

Well No: 8125
 Corer: HARRISON

LINE	CORNER	REMARKS
1		Reference of UCC 88-414
2		LEGAL DATE: 05/01/88
3		
4		
5		
6		
7		
8		
9		
10		
11		
12		
13		
14		
15		
16		
17		
18		
19		
20		
21		
22		
23		
24		
25		
26		
27		
28		
29		
30		
31		
32		
33		
34		
35		
36		
37		
38		
39		
40		
41		
42		
43		
44		
45		
46		
47		
48		
49		
50		
51		
52		
53		
54		
55		
56		
57		
58		
59		
60		
61		
62		
63		
64		
65		
66		
67		
68		
69		
70		
71		
72		
73		
74		
75		
76		
77		
78		
79		
80		
81		
82		
83		
84		
85		
86		
87		
88		
89		
90		
91		
92		
93		
94		
95		
96		
97		
98		
99		
100		