



R=42\* T= A \* Lift type 43# S\* Intake 44= \* Power type 45= E\*

Date 38= 10/26/1982\* H.P. 46= 1.5\*

LIFT

R=198\* T= A \* Log 199# D\* Top 200= 0.\* Bot 201= 19.6.0.\*

R=198\* T= A \* Log 199# E\* Top 200= 4.2.\* Bot 201= 19.5.0.\*

R=189\* T= A \* Log No. 190# 1.4.5\* 191= M I S S I D I S T \*

LOGS

R=114\* T= A \* Year 115# \* 117= \* 120= \*

ANAL.

R=90\* T= A \* 256# 1 \* Top 91= 19.0.0.\* Bot 92= \*

Unit ID 93= 22 P.C.G.L. \* Name of Unit

R=90\* T= A \* 256# 1 \* Top 91= \* Bot 92= \*

Unit ID 93= \* Name of Unit

AQUIFERS

R=98\* T= A \* 99# 1 \* Unit tested 100= \* 103= \*

R=105\* T= A \* 99# 1 \* Test No. 106# \*

107= \* Transmissivity (gal/d)/ft

108= \* Hydraul. cond: (gal/d)/ft<sup>2</sup>

110= \* Storage coeff. Boundaries

HYDRAULICS

R=121\* T= \* Yr Begin 122# \* Network 258# \*

Water Level Data Collection (1)

(1625' From N Line + 500' from East line)

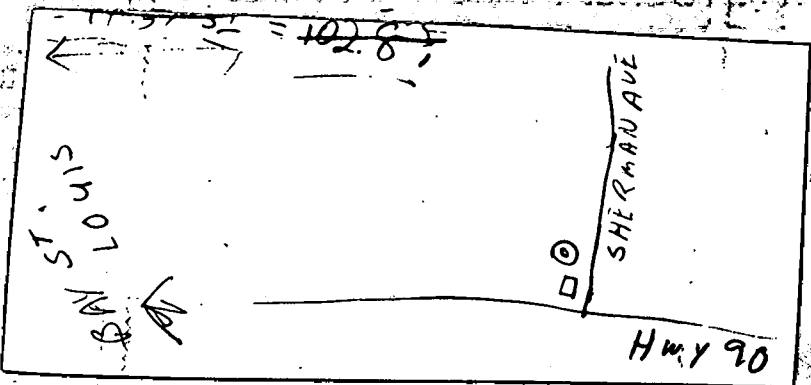

description of formations encountered	from	to
Surface	0	6
Sand	6	100
Blue Clay	100	190
Sand	190	215
Clay	215	230
Sand - Coarse	230	300
Blue Clay	300	375
Sand	375	400
Blue Clay	400	425
Sand	425	440
Blue Clay	440	520
Sand - Coarse	520	570
Fine Sand	570	620
Blue Clay	620	640
Coarse Gray Sand	640	740
Blue Clay	740	1010
Fine Sand	1010	1160
Blue Clay	1160	1350
Fine Sand	1350	1370
Blue Clay	1370	1700
Coarse Gray Sand	1700	1960

1/31 WFO

TRANSMITTED FOR ADP

BAV ST. 20013

Recorded by BAR  
Date 10/6/82

U.S. GEOLOGICAL SURVEY  
WATER RESOURCES DIVISION  
MISSISSIPPI DISTRICT

Well No. N 307  
E-Log No. 145  
County HARRISON

2  
34

Site ID 3,0,1,8,2,8,0,8,9,1,6,2,0,2 R=0\* T=A\* 2=W\*

Data reliab. 3=C<sup>1</sup> Report. agency 4=USGS\* Dist. 6=28\* 7=28\* Co. 8=0,4,7

Lat. Long. 9=30,1,8,2,8\* 10=0,8,9,1,6,3,4\* Well No. 12=N,3,0,7

Location 13=SENE, S 34, T 08, R 13, W\* Alt. 16=1,5\*

Hyd. Unit (OWDC) 20=0,3,1,7,0,0,9\* Date 21=0,9,1,3,0,1,1,9,8,2\*

Well use 23=W\* Water use 24=I\* Hole depth 27=1,9,6,0\* Well depth 28=1,9,6,0\*

WL 30=-6,0\* Date 31=1,0,1,2,6,1,1,9,8,2\* Source 33=D\*

Status 273=  \* Project No. 5=  , 0,4,7\*

R=158\* T=A\* Date 159# 0,9,1,3,0,1,1,9,8,2\* Owner No.

OWNER  
Owner 161# A, W, JUNZ  
L G

R=192\* T=A\* Date 193# 1,1,1,0,4,1,1,9,8,6\* Temp. 196#00010\* 197=2,2\*

R=192\* T=A\* Date 193# 1,1,1,0,4,1,1,9,8,6\* Cond. 196#00095\* 197=8,0,0\*

R=192\* T=A\* Date 193#    pH 196#00400\* 197=  \*

R=58\* T=A\* 59# 1\* Date 60=0,9,1,3,0,1,1,9,8,2\* Remarks

CONSTR.  
Drig. 63=0,7,2\* Name BRADEN Method 65=H\* Finish 66=S\*

R=76\* T=A\* 59# 1\*

CASING  
Top csng. 77# 0\* Bot. csng. 78=1,0,5\* Diam. 79# 4\*

R=76\* T=A\* 59# 1\*

Top csng 77# 1,0,5\* Bot. csng. 78=1,9,4,0\* Diam. 79# 2\*

R=82\* T=A\* 59# 1\* Top 83# 1,9,4,0\* Bottom 84=1,9,6,0\*

OPENINGS  
Type 85=S\* Diam. 87=2\* Size 88=  \*

R=82\* T=A\* 59# 1\* Top 83#   \* Bottom 84=  \*

Type 85=  \* Diam. 87=  \* Size 88=  \*

YIELD  
R=146\* T=A\* 147# 1\* Q 150=50\* Q/S 272=  \*

134 flows 146 pumped