

WRD Exp. (GW)  
April 1966

Well No. N 195

WELL SCHEDULE

392D

U. S. DEPT. OF THE INTERIOR

GEOLOGICAL SURVEY

WATER RESOURCES DIVISION

MASTER CARD Brown + Reed Driller 3/24/39

Record by J. Shell Source of data \_\_\_\_\_ Date 11/68 Map \_\_\_\_\_

State \_\_\_\_\_ County 28 (or town) Harrison Sequential number: 24

Latitude: 301850N 0891870W Longitude: \_\_\_\_\_ Sequential number: 1

Lat-long accuracy: 3 T. 8 S. R. 130 Sec. 33, NE, SE

Local well number: 71795AD3300-13W Other number: \_\_\_\_\_ B & M

Local use: 024 Owner or name: Gulf Shore Beach Inn

Owner or name: GULF SHORE BEACH INN Address: Henderson Point

Ownership: County, Fed Gov't, City, Corp or Co, Private, State Agency, Water Dist \_\_\_\_\_ N

Use of water: (A) Air cond, (B) Bottling, (C) Comm, (D) Dewater, (E) Power, (F) Fire, (G) Dom, (H) Irr, (I) Med, (J) P S, (K) Rec, (L) Stock, (M) Instit, (N) Unused, (O) Recharge, (P) Desal-P S, (Q) Desal-other, (R) Other \_\_\_\_\_ T

Use of well: (A) Anode, (B) Drain, (C) Seismic, (D) Heat Res, (E) Obs, (F) Oil-gas, (G) Recharge, (H) Test, (I) Unused, (J) Withdraw, (K) Waste, (L) Destroyed \_\_\_\_\_ W

DATA AVAILABLE: Well data  Freq. W/L meas.:  Field aquifer char.

Hyd. lab. data: \_\_\_\_\_

Qual. water data; type: \_\_\_\_\_

Freq. sampling: \_\_\_\_\_ Pumpage inventory:  yes  no; period: \_\_\_\_\_

Aperture cards: \_\_\_\_\_ yes  no

Log data: \_\_\_\_\_

WELL-DESCRIPTION CARD

Depth well: 985 ft Meas. 6 ft

Depth cased: 945 ft Casing type: \_\_\_\_\_; Diam. 4 in

Finish: (C) porous concrete, (F) gravel w. (perf.), (G) gravel w. (screen), (H) horiz. gallery, (I) open end, (J) open perf., (K) screen, (L) sd. pt., (M) shored, (N) open hole, (O) other \_\_\_\_\_ S

Method Drilled: (A) air rot, (B) bored, (C) cable, (D) dug, (E) hyd rot., (F) jetted, (G) air percussion, (H) reverse, (I) rotary, (J) trenching, (K) driven, (L) drive wash, (M) other \_\_\_\_\_ H

Date Drilled: 927 Pump intake setting: \_\_\_\_\_ ft

Driller: John Sutter name \_\_\_\_\_ address \_\_\_\_\_

Lift (type): (A) air, (B) bucket, (C) cent, (D) jet, (E) multiple (cent.), (F) multiple (turb.), (G) none, (H) piston, (I) rot, (J) submerg, (K) turb, (L) other \_\_\_\_\_ Deep  Shallow

Power (type): diesel, elec, gas, gasoline, hand, gas, wind; H.P. \_\_\_\_\_ Trans. or meter no. \_\_\_\_\_

Descr. MP \_\_\_\_\_ above \_\_\_\_\_ ft below \_\_\_\_\_ LSD; Alt: MP \_\_\_\_\_

Alt. LSD: 4.48 Accuracy: 4 \_\_\_\_\_

Water Level: 27 ft above MP; \_\_\_\_\_ ft below LSD Accuracy: \_\_\_\_\_

Date meas: 5/26/64 Yield: 339 gpm \_\_\_\_\_ Method determined \_\_\_\_\_

Drawdown: \_\_\_\_\_ ft Accuracy: \_\_\_\_\_ Pumping period \_\_\_\_\_ hrs

QUALITY OF WATER DATA: Iron \_\_\_\_\_ ppm Sulfate \_\_\_\_\_ ppm Chloride \_\_\_\_\_ ppm Hard. \_\_\_\_\_ ppm Sp. Conduct \_\_\_\_\_ K x 10<sup>6</sup> Temp. 81 °F \_\_\_\_\_ Date sampled \_\_\_\_\_

Taste, color, etc. \_\_\_\_\_

PUNCHED

Well No. N 195

Well No. N 195

Latitude-longitude \_\_\_\_\_  
d m s d m s

HYDROGEOLOGIC CARD

SAME AS ON MASTER CARD 03 Section: \_\_\_\_\_  
Province: \_\_\_\_\_

0 Drainage Basin: 13S Subbasin: \_\_\_\_\_

Topo of well site: (D) depression, stream channel, dunes, flat, hilltop, sink, swamp, (P) offshore, pediment, hillside, terrace, undulating, valley flat \_\_\_\_\_

MAJOR AQUIFER: T.M system series \_\_\_\_\_ aquifer, formation, group P.A

Lithology: U.S Origin: 3 Aquifer Thickness: 6.4 ft

Length of well open to: \_\_\_\_\_ ft 4.0 Depth to top of: \_\_\_\_\_ ft 9.21

MINOR AQUIFER: \_\_\_\_\_ system series \_\_\_\_\_ aquifer, formation, group \_\_\_\_\_

Lithology: \_\_\_\_\_ Origin: \_\_\_\_\_ Aquifer Thickness: \_\_\_\_\_ ft

Length of well open to: \_\_\_\_\_ ft \_\_\_\_\_ Depth to top of: \_\_\_\_\_ ft \_\_\_\_\_

Intervals Screened: \_\_\_\_\_

Depth to consolidated rock: \_\_\_\_\_ ft \_\_\_\_\_ Source of data: \_\_\_\_\_

Depth to basement: \_\_\_\_\_ ft \_\_\_\_\_ Source of data: \_\_\_\_\_

Surficial material: \_\_\_\_\_ Infiltration characteristics: \_\_\_\_\_

Coefficient Trans: \_\_\_\_\_ gpd/ft \_\_\_\_\_ Coefficient Storage: \_\_\_\_\_

Coefficient Perm: \_\_\_\_\_ gpd/ft<sup>2</sup>; Spec cap: \_\_\_\_\_ gpm/ft; Number of geologic cards: \_\_\_\_\_

11/20/85  
N  
NL = 1.7' above LSD

10-21-82  
5.2 above LSD  
Temp. 26.5°C  
Cond. 560  $\mu$ m  
PH 8.9  
11/19/85 LOCKED INSIDE FENCE

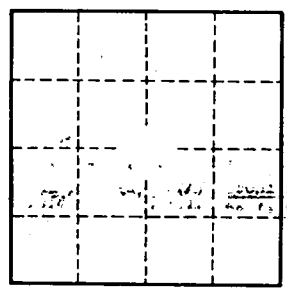

L & R R

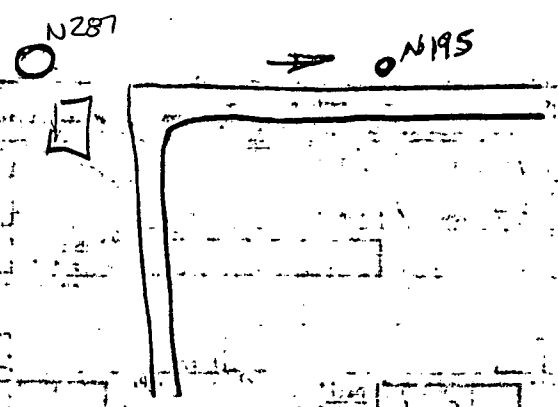

5.2  
4.48  
9.68

Well No. N 195