

Set ID 302402-0885-903
4

PUNCHED
APR 11 1975

FORM 9-1642 (1-68) Well No. M576
WELL SCHEDULE
U. S. DEPT. OF THE INTERIOR GEOLOGICAL SURVEY WATER RESOURCES DIVISION
Elog #100
PUNCHED
APR 5 1973

MASTER CARD
Record by WTO Source of data Bowc Date 2/73 Map _____
State MISS County HARRISON
Latitude: 30° 24' 04" N Longitude: 089° 59' 03" W Sequential number: 1
Local well number: M576CC2707S10W Other well number: _____
Local use: 064100 673 311 Owner or name: _____
Owner or name: BILLOXI Address: _____

Ownership: County, Fed Gov't, City, Corp or Co, Private, State Agency, Water Dist M
Use of Air cond, Bottling, Comm, Dewater, Power, Fire, Dom, Irr, Med, Ind, P S, Rec, _____
water: (S) (T) (U) (V) (W) (X) (Y) (Z) P
Stock, Instat, Unused, Repressure, Recharge, Desal-P S, Desal-other, Other
Use of well: (A) (D) (G) (H) (I) (J) (K) (L) (M) (N) (O) (P) (Q) (R) (S) (T) (U) (V) (W) (X) (Y) (Z) W
Anode, Drain, Seismic, Heat Res, Obs, Oil-gas, Recharge, Test, Unused, Withdraw, Waste, Destroyed
DATA AVAILABLE: Well-data Freq. W/L meas. Field aquifer char.
Hyd. lab. data: USGS
Qual. water data: type: _____
Freq. sampling: Pumpage inventory: yes no, period: _____
Aperture cards: _____
Log data: Sch log. to 1420 DE

WELL-DESCRIPTION CARD
SAME AS ON MASTER CARD Depth well: 848 ft Meas. rept accuracy 3
Depth cased (first perf.): 788 ft Casing type: _____; Diam. in 6
Finish: (C) porous concrete, (F) gravel w. screen, (G) gravel w. gallery, (H) horiz. open end, (I) open perf., (J) screen, (K) sd. pt., (L) shored, (M) open hole, (N) other
Method: (A) air, (B) bored, (C) cable, (D) dug, (E) hyd. jetted, (F) air percuss, (G) reverse rotary, (H) driven, (I) drive wash, (J) other
Date Drilled: 2-2-73 973 Pump intake setting: _____ ft

Driller: SINGER-LAYNE
Lift (type): (A) air, (B) bucket, (C) cent, (D) jet, (E) multiple, (F) multiple, (G) none, (H) piston, (I) rot, (J) submerg, (K) turb, (L) other
Power (type): (A) diesel, (B) elec, (C) gas, (D) gasoline, (E) hand, (F) gas, (G) wind, (H) H.P.
Descrip. MP _____ ft above _____ ft below LSD, Alt. MP _____
Alt. LSD: 30 Accuracy: CIS
Water Level: _____ ft above _____ ft below MP; _____ ft below LSD Accuracy: _____
Date meas: 273 Yield: _____ gpm Method determined: _____
Drawdown: _____ ft Accuracy: _____ Pumping period: _____ hrs
QUALITY OF WATER DATA: Iron _____ ppm Sulfate _____ ppm Chloride _____ ppm Hard. _____ ppm
Sp. Conduct 430 K x 10⁶ Temp. 28.2 °F Date sampled 6/12 673
Taste, color, etc. _____

Well No. M576

HYDROGEOLOGIC CARD

Physiographic Province: 03 Section: _____

Drainage Basin: 135 Subbasin: _____

Topo of well site: (D) (C) (E) (F) (H) (K) (L) (M) (N) (O) (P) (S) (T) (U) (V) _____

MAJOR AQUIFER: T.M aquifer, formation, group M.Z

Lithology: S Origin: 3 Aquifer Thickness: 331 ft

Length of well open to: 107 ft Depth to top of: 610 ft 7160

MINOR AQUIFER: _____ aquifer, formation, group _____

Lithology: _____ Origin: _____ Aquifer Thickness: _____ ft

Length of well open to: _____ ft Depth to top of: _____ ft

Intervals Screened:

Depth to consolidated rock: _____ ft Source of data: _____

Depth to basement: _____ ft Source of data: _____

Surficial material: _____ Infiltration characteristics: _____

Coefficient Trans: 943 gpd/ft² Coefficient Storage: _____

Coefficient Perm: 880 gpd/ft²; Spec cap: 31 gpm/ft; Number of geologic cards: _____

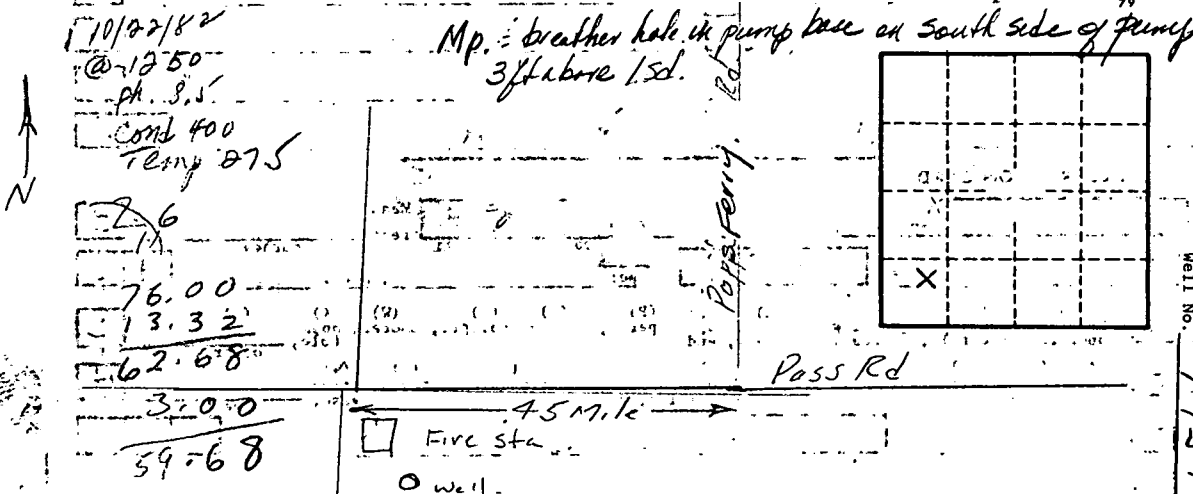

Well No. 17576