

WELL SCHEDULE

U. S. DEPT. OF THE INTERIOR

GEOLOGICAL SURVEY

WATER RESOURCES DIVISION

MASTER CARD

Record by JAC Source of data old records Date _____ Map _____

State 28 County (or town) 24

Latitude: 30 24 30 N Longitude: 0 8 9 0 0 0 Sequential number: 1

Lat-long accuracy: 4 T. 7 R. 9 Sec 28

Local well number: M002 2807509W Other number: #1 B & M

Local use: 088 D64 13 Owner or name: City of Beloit

Owner or name: BILLOXI Address: Main St Plant
LAMEUSE ST

Ownership: County, Fed Gov't, City, Corp or Co, Private, State Agency, Water Dist M

Use of water: (A) Air cond, Bottling, Comm, Dewater, Power, Fire, Dom, Irr, Med, Ind, P S, Rec, Stock, Instit, Unused, Reppure, Recharge, Desal-P S, Desal-other, Other P

Use of well: (A) Anode, Drain, Seismic, Heat Res, Obs, Oil-gas, Recharge, Test, Unused, Withdraw, Waste, Destroyed. W

DATA AVAILABLE: Well data Freq. W/L meas.: Field aquifer char. Z

Hyd. lab. data: _____

Qual. water data; type: MSBOK (Oct '60)

Freq. sampling: _____ Pumpage inventory: no, period: _____

Aperture cards: _____

Log data: _____

WELL-DESCRIPTION CARD

SAME AS ON MASTER CARD Depth well: _____ ft 1207 Meas. rept accuracy 6

Depth cased; (first perf.) _____ ft 1127 Casing type: _____; Diam. 12x10 in 12

Finish: (C) porous concrete, (F) gravel w. (perf.), (G) gravel w. (screen), (H) horiz. gallery, (I) open end, (J) percuss, rotary, (K) air, (L) reverse, (M) percuss, rotary, (N) air, (O) reverse, (P) air, (Q) reverse, (R) air, (S) reverse, (T) air, (U) reverse, (V) air, (W) reverse, (X) air, (Y) reverse, (Z) air, (AA) reverse, (AB) air, (AC) reverse, (AD) air, (AE) reverse, (AF) air, (AG) reverse, (AH) air, (AI) reverse, (AJ) air, (AK) reverse, (AL) air, (AM) reverse, (AN) air, (AO) reverse, (AP) air, (AQ) reverse, (AR) air, (AS) reverse, (AT) air, (AU) reverse, (AV) air, (AW) reverse, (AX) air, (AY) reverse, (AZ) air, (BA) reverse, (BB) air, (BC) reverse, (BD) air, (BE) reverse, (BF) air, (BG) reverse, (BH) air, (BI) reverse, (BJ) air, (BK) reverse, (BL) air, (BM) reverse, (BN) air, (BO) reverse, (BP) air, (BQ) reverse, (BR) air, (BS) reverse, (BT) air, (BU) reverse, (BV) air, (BW) reverse, (BX) air, (BY) reverse, (BZ) air, (CA) reverse, (CB) air, (CC) reverse, (CD) air, (CE) reverse, (CF) air, (CG) reverse, (CH) air, (CI) reverse, (CJ) air, (CK) reverse, (CL) air, (CM) reverse, (CN) air, (CO) reverse, (CP) air, (CQ) reverse, (CR) air, (CS) reverse, (CT) air, (CU) reverse, (CV) air, (CW) reverse, (CX) air, (CY) reverse, (CZ) air, (DA) reverse, (DB) air, (DC) reverse, (DD) air, (DE) reverse, (DF) air, (DG) reverse, (DH) air, (DI) reverse, (DJ) air, (DK) reverse, (DL) air, (DM) reverse, (DN) air, (DO) reverse, (DP) air, (DQ) reverse, (DR) air, (DS) reverse, (DT) air, (DU) reverse, (DV) air, (DW) reverse, (DX) air, (DY) reverse, (DZ) air, (EA) reverse, (EB) air, (EC) reverse, (ED) air, (EE) reverse, (EF) air, (EG) reverse, (EH) air, (EI) reverse, (EJ) air, (EK) reverse, (EL) air, (EM) reverse, (EN) air, (EO) reverse, (EP) air, (EQ) reverse, (ER) air, (ES) reverse, (ET) air, (EU) reverse, (EV) air, (EW) reverse, (EX) air, (EY) reverse, (EZ) air, (FA) reverse, (FB) air, (FC) reverse, (FD) air, (FE) reverse, (FF) air, (FG) reverse, (FH) air, (FI) reverse, (FJ) air, (FK) reverse, (FL) air, (FM) reverse, (FN) air, (FO) reverse, (FP) air, (FQ) reverse, (FR) air, (FS) reverse, (FT) air, (FU) reverse, (FV) air, (FW) reverse, (FX) air, (FY) reverse, (FZ) air, (GA) reverse, (GB) air, (GC) reverse, (GD) air, (GE) reverse, (GF) air, (GG) reverse, (GH) air, (GI) reverse, (GJ) air, (GK) reverse, (GL) air, (GM) reverse, (GN) air, (GO) reverse, (GP) air, (GQ) reverse, (GR) air, (GS) reverse, (GT) air, (GU) reverse, (GV) air, (GW) reverse, (GX) air, (GY) reverse, (GZ) air, (HA) reverse, (HB) air, (HC) reverse, (HD) air, (HE) reverse, (HF) air, (HG) reverse, (HH) air, (HI) reverse, (HJ) air, (HK) reverse, (HL) air, (HM) reverse, (HN) air, (HO) reverse, (HP) air, (HQ) reverse, (HR) air, (HS) reverse, (HT) air, (HU) reverse, (HV) air, (HW) reverse, (HX) air, (HY) reverse, (HZ) air, (IA) reverse, (IB) air, (IC) reverse, (ID) air, (IE) reverse, (IF) air, (IG) reverse, (IH) air, (II) reverse, (IJ) air, (IK) reverse, (IL) air, (IM) reverse, (IN) air, (IO) reverse, (IP) air, (IQ) reverse, (IR) air, (IS) reverse, (IT) air, (IU) reverse, (IV) air, (IW) reverse, (IX) air, (IY) reverse, (IZ) air, (JA) reverse, (JB) air, (JC) reverse, (JD) air, (JE) reverse, (JF) air, (JG) reverse, (JH) air, (JI) reverse, (JJ) air, (JK) reverse, (JL) air, (JM) reverse, (JN) air, (JO) reverse, (JP) air, (JQ) reverse, (JR) air, (JS) reverse, (JT) air, (JU) reverse, (JV) air, (JW) reverse, (JX) air, (JY) reverse, (JZ) air, (KA) reverse, (KB) air, (KC) reverse, (KD) air, (KE) reverse, (KF) air, (KG) reverse, (KH) air, (KI) reverse, (KJ) air, (KK) reverse, (KL) air, (KM) reverse, (KN) air, (KO) reverse, (KP) air, (KQ) reverse, (KR) air, (KS) reverse, (KT) air, (KU) reverse, (KV) air, (KW) reverse, (KX) air, (KY) reverse, (KZ) air, (LA) reverse, (LB) air, (LC) reverse, (LD) air, (LE) reverse, (LF) air, (LG) reverse, (LH) air, (LI) reverse, (LJ) air, (LK) reverse, (LL) air, (LM) reverse, (LN) air, (LO) reverse, (LP) air, (LQ) reverse, (LR) air, (LS) reverse, (LT) air, (LU) reverse, (LV) air, (LW) reverse, (LX) air, (LY) reverse, (LZ) air, (MA) reverse, (MB) air, (MC) reverse, (MD) air, (ME) reverse, (MF) air, (MG) reverse, (MH) air, (MI) reverse, (MJ) air, (MK) reverse, (ML) air, (MM) reverse, (MN) air, (MO) reverse, (MP) air, (MQ) reverse, (MR) air, (MS) reverse, (MT) air, (MU) reverse, (MV) air, (MW) reverse, (MX) air, (MY) reverse, (MZ) air, (NA) reverse, (NB) air, (NC) reverse, (ND) air, (NE) reverse, (NF) air, (NG) reverse, (NH) air, (NI) reverse, (NJ) air, (NK) reverse, (NL) air, (NM) reverse, (NN) air, (NO) reverse, (NP) air, (NQ) reverse, (NR) air, (NS) reverse, (NT) air, (NU) reverse, (NV) air, (NW) reverse, (NX) air, (NY) reverse, (NZ) air, (OA) reverse, (OB) air, (OC) reverse, (OD) air, (OE) reverse, (OF) air, (OG) reverse, (OH) air, (OI) reverse, (OJ) air, (OK) reverse, (OL) air, (OM) reverse, (ON) air, (OO) reverse, (OP) air, (OQ) reverse, (OR) air, (OS) reverse, (OT) air, (OU) reverse, (OV) air, (OW) reverse, (OX) air, (OY) reverse, (OZ) air, (PA) reverse, (PB) air, (PC) reverse, (PD) air, (PE) reverse, (PF) air, (PG) reverse, (PH) air, (PI) reverse, (PJ) air, (PK) reverse, (PL) air, (PM) reverse, (PN) air, (PO) reverse, (PP) air, (PQ) reverse, (PR) air, (PS) reverse, (PT) air, (PU) reverse, (PV) air, (PW) reverse, (PX) air, (PY) reverse, (PZ) air, (QA) reverse, (QB) air, (QC) reverse, (QD) air, (QE) reverse, (QF) air, (QG) reverse, (QH) air, (QI) reverse, (QJ) air, (QK) reverse, (QL) air, (QM) reverse, (QN) air, (QO) reverse, (QP) air, (QQ) reverse, (QR) air, (QS) reverse, (QT) air, (QU) reverse, (QV) air, (QW) reverse, (QX) air, (QY) reverse, (QZ) air, (RA) reverse, (RB) air, (RC) reverse, (RD) air, (RE) reverse, (RF) air, (RG) reverse, (RH) air, (RI) reverse, (RJ) air, (RK) reverse, (RL) air, (RM) reverse, (RN) air, (RO) reverse, (RP) air, (RQ) reverse, (RR) air, (RS) reverse, (RT) air, (RU) reverse, (RV) air, (RW) reverse, (RX) air, (RY) reverse, (RZ) air, (SA) reverse, (SB) air, (SC) reverse, (SD) air, (SE) reverse, (SF) air, (SG) reverse, (SH) air, (SI) reverse, (SJ) air, (SK) reverse, (SL) air, (SM) reverse, (SN) air, (SO) reverse, (SP) air, (SQ) reverse, (SR) air, (SS) reverse, (ST) air, (SU) reverse, (SV) air, (SW) reverse, (SX) air, (SY) reverse, (SZ) air, (TA) reverse, (TB) air, (TC) reverse, (TD) air, (TE) reverse, (TF) air, (TG) reverse, (TH) air, (TI) reverse, (TJ) air, (TK) reverse, (TL) air, (TM) reverse, (TN) air, (TO) reverse, (TP) air, (TQ) reverse, (TR) air, (TS) reverse, (TU) reverse, (TV) air, (TW) reverse, (TX) air, (TY) reverse, (TZ) air, (UA) reverse, (UB) air, (UC) reverse, (UD) air, (UE) reverse, (UF) air, (UG) reverse, (UH) air, (UI) reverse, (UJ) air, (UK) reverse, (UL) air, (UM) reverse, (UN) air, (UO) reverse, (UP) air, (UQ) reverse, (UR) air, (US) reverse, (UT) air, (UU) reverse, (UV) air, (UW) reverse, (UX) air, (UY) reverse, (UZ) air, (VA) reverse, (VB) air, (VC) reverse, (VD) air, (VE) reverse, (VF) air, (VG) reverse, (VH) air, (VI) reverse, (VJ) air, (VK) reverse, (VL) air, (VM) reverse, (VN) air, (VO) reverse, (VP) air, (VQ) reverse, (VR) air, (VS) reverse, (VT) air, (VU) reverse, (VV) air, (VW) reverse, (VX) air, (VY) reverse, (VZ) air, (WA) reverse, (WB) air, (WC) reverse, (WD) air, (WE) reverse, (WF) air, (WG) reverse, (WH) air, (WI) reverse, (WJ) air, (WK) reverse, (WL) air, (WM) reverse, (WN) air, (WO) reverse, (WP) air, (WQ) reverse, (WR) air, (WS) reverse, (WT) air, (WU) reverse, (WV) air, (WW) reverse, (WX) air, (WY) reverse, (WZ) air, (XA) reverse, (XB) air, (XC) reverse, (XD) air, (XE) reverse, (XF) air, (XG) reverse, (XH) air, (XI) reverse, (XJ) air, (XK) reverse, (XL) air, (XM) reverse, (XN) air, (XO) reverse, (XP) air, (XQ) reverse, (XR) air, (XS) reverse, (XT) air, (XU) reverse, (XV) air, (XW) reverse, (XX) air, (XY) reverse, (XZ) air, (YA) reverse, (YB) air, (YC) reverse, (YD) air, (YE) reverse, (YF) air, (YG) reverse, (YH) air, (YI) reverse, (YJ) air, (YK) reverse, (YL) air, (YM) reverse, (YN) air, (YO) reverse, (YP) air, (YQ) reverse, (YR) air, (YS) reverse, (YT) air, (YU) reverse, (YV) air, (YW) reverse, (YX) air, (YY) reverse, (YZ) air, (ZA) reverse, (ZB) air, (ZC) reverse, (ZD) air, (ZE) reverse, (ZF) air, (ZG) reverse, (ZH) air, (ZI) reverse, (ZJ) air, (ZK) reverse, (ZL) air, (ZM) reverse, (ZN) air, (ZO) reverse, (ZP) air, (ZQ) reverse, (ZR) air, (ZS) reverse, (ZT) air, (ZU) reverse, (ZV) air, (ZW) reverse, (ZX) air, (ZY) reverse, (ZZ) air

Date Drilled: 954 Pump intake setting: _____ ft _____

Driller: CT SWITZER

Lift (type): (A) air, (B) bucket, (C) cent, (D) jet, (E) multiple, (F) multiple, (G) multiple, (H) multiple, (I) multiple, (J) multiple, (K) multiple, (L) multiple, (M) multiple, (N) multiple, (O) multiple, (P) multiple, (Q) multiple, (R) multiple, (S) multiple, (T) multiple, (U) multiple, (V) multiple, (W) multiple, (X) multiple, (Y) multiple, (Z) multiple, (AA) multiple, (AB) multiple, (AC) multiple, (AD) multiple, (AE) multiple, (AF) multiple, (AG) multiple, (AH) multiple, (AI) multiple, (AJ) multiple, (AK) multiple, (AL) multiple, (AM) multiple, (AN) multiple, (AO) multiple, (AP) multiple, (AQ) multiple, (AR) multiple, (AS) multiple, (AT) multiple, (AU) multiple, (AV) multiple, (AW) multiple, (AX) multiple, (AY) multiple, (AZ) multiple, (BA) multiple, (BB) multiple, (BC) multiple, (BD) multiple, (BE) multiple, (BF) multiple, (BG) multiple, (BH) multiple, (BI) multiple, (BJ) multiple, (BK) multiple, (BL) multiple, (BM) multiple, (BN) multiple, (BO) multiple, (BP) multiple, (BQ) multiple, (BR) multiple, (BS) multiple, (BT) multiple, (BU) multiple, (BV) multiple, (BW) multiple, (BX) multiple, (BY) multiple, (BZ) multiple, (CA) multiple, (CB) multiple, (CC) multiple, (CD) multiple, (CE) multiple, (CF) multiple, (CG) multiple, (CH) multiple, (CI) multiple, (CJ) multiple, (CK) multiple, (CL) multiple, (CM) multiple, (CN) multiple, (CO) multiple, (CP) multiple, (CQ) multiple, (CR) multiple, (CS) multiple, (CT) multiple, (CU) multiple, (CV) multiple, (CW) multiple, (CX) multiple, (CY) multiple, (CZ) multiple, (DA) multiple, (DB) multiple, (DC) multiple, (DD) multiple, (DE) multiple, (DF) multiple, (DG) multiple, (DH) multiple, (DI) multiple, (DJ) multiple, (DK) multiple, (DL) multiple, (DM) multiple, (DN) multiple, (DO) multiple, (DP) multiple, (DQ) multiple, (DR) multiple, (DS) multiple, (DT) multiple, (DU) multiple, (DV) multiple, (DW) multiple, (DX) multiple, (DY) multiple, (DZ) multiple, (EA) multiple, (EB) multiple, (EC) multiple, (ED) multiple, (EE) multiple, (EF) multiple, (EG) multiple, (EH) multiple, (EI) multiple, (EJ) multiple, (EK) multiple, (EL) multiple, (EM) multiple, (EN) multiple, (EO) multiple, (EP) multiple, (EQ) multiple, (ER) multiple, (ES) multiple, (ET) multiple, (EU) multiple, (EV) multiple, (EW) multiple, (EX) multiple, (EY) multiple, (EZ) multiple, (FA) multiple, (FB) multiple, (FC) multiple, (FD) multiple, (FE) multiple, (FF) multiple, (FG) multiple, (FH) multiple, (FI) multiple, (FJ) multiple, (FK) multiple, (FL) multiple, (FM) multiple, (FN) multiple, (FO) multiple, (FP) multiple, (FQ) multiple, (FR) multiple, (FS) multiple, (FT) multiple, (FU) multiple, (FV) multiple, (FW) multiple, (FX) multiple, (FY) multiple, (FZ) multiple, (GA) multiple, (GB) multiple, (GC) multiple, (GD) multiple, (GE) multiple, (GF) multiple, (GG) multiple, (GH) multiple, (GI) multiple, (GJ) multiple, (GK) multiple, (GL) multiple, (GM) multiple, (GN) multiple, (GO) multiple, (GP) multiple, (GQ) multiple, (GR) multiple, (GS) multiple, (GT) multiple, (GU) multiple, (GV) multiple, (GW) multiple, (GX) multiple, (GY) multiple, (GZ) multiple, (HA) multiple, (HB) multiple, (HC) multiple, (HD) multiple, (HE) multiple, (HF) multiple, (HG) multiple, (HH) multiple, (HI) multiple, (HJ) multiple, (HK) multiple, (HL) multiple, (HM) multiple, (HN) multiple, (HO) multiple, (HP) multiple, (HQ) multiple, (HR) multiple, (HS) multiple, (HT) multiple, (HU) multiple, (HV) multiple, (HW) multiple, (HX) multiple, (HY) multiple, (HZ) multiple, (IA) multiple, (IB) multiple, (IC) multiple, (ID) multiple, (IE) multiple, (IF) multiple, (IG) multiple, (IH) multiple, (II) multiple, (IJ) multiple, (IK) multiple, (IL) multiple, (IM) multiple, (IN) multiple, (IO) multiple, (IP) multiple, (IQ) multiple, (IR) multiple, (IS) multiple, (IT) multiple, (IU) multiple, (IV) multiple, (IW) multiple, (IX) multiple, (IY) multiple, (IZ) multiple, (JA) multiple, (JB) multiple, (JC) multiple, (JD) multiple, (JE) multiple, (JF) multiple, (JG) multiple, (JH) multiple, (JI) multiple, (JJ) multiple, (JK) multiple, (JL) multiple, (JM) multiple, (JN) multiple, (JO) multiple, (JP) multiple, (JQ) multiple, (JR) multiple, (JS) multiple, (JT) multiple, (JU) multiple, (JV) multiple, (JW) multiple, (JX) multiple, (JY) multiple, (JZ) multiple, (KA) multiple, (KB) multiple, (KC) multiple, (KD) multiple, (KE) multiple, (KF) multiple, (KG) multiple, (KH) multiple, (KI) multiple, (KJ) multiple, (KL) multiple, (KM) multiple, (KN) multiple, (KO) multiple, (KP) multiple, (KQ) multiple, (KR) multiple, (KS) multiple, (KT) multiple, (KU) multiple, (KV) multiple, (KW) multiple, (KX) multiple, (KY) multiple, (KZ) multiple, (LA) multiple, (LB) multiple, (LC) multiple, (LD) multiple, (LE) multiple, (LF) multiple, (LG) multiple, (LH) multiple, (LI) multiple, (LJ) multiple, (LK) multiple, (LM) multiple, (LN) multiple, (LO) multiple, (LP) multiple, (LQ) multiple, (LR) multiple, (LS) multiple, (LT) multiple, (LU) multiple, (LV) multiple, (LW) multiple, (LX) multiple, (LY) multiple, (LZ) multiple, (MA) multiple, (MB) multiple, (MC) multiple, (MD) multiple, (ME) multiple, (MF) multiple, (MG) multiple, (MH) multiple, (MI) multiple, (MJ) multiple, (MK) multiple, (ML) multiple, (MN) multiple, (MO) multiple, (MP) multiple, (MQ) multiple, (MR) multiple, (MS) multiple, (MT) multiple, (MU) multiple, (MV) multiple, (MW) multiple, (MX) multiple, (MY) multiple, (MZ) multiple, (NA) multiple, (NB) multiple, (NC) multiple, (ND) multiple, (NE) multiple, (NF) multiple, (NG) multiple, (NH) multiple, (NI) multiple, (NJ) multiple, (NK) multiple, (NL) multiple, (NM) multiple, (NN) multiple, (NO) multiple, (NP) multiple, (NQ) multiple, (NR) multiple, (NS) multiple, (NT) multiple, (NU) multiple, (NV) multiple, (NW) multiple, (NX) multiple, (NY) multiple, (NZ) multiple, (OA) multiple, (OB) multiple, (OC) multiple, (OD) multiple, (OE) multiple, (OF) multiple, (OG) multiple, (OH) multiple, (OI) multiple, (OJ) multiple, (OK) multiple, (OL) multiple, (OM) multiple, (ON) multiple, (OO) multiple, (OP) multiple, (OQ) multiple, (OR) multiple, (OS) multiple, (OT) multiple, (OU) multiple, (OV) multiple, (OW) multiple, (OX) multiple, (OY) multiple, (OZ) multiple, (PA) multiple, (PB) multiple, (PC) multiple, (PD) multiple, (PE) multiple, (PF) multiple, (PG) multiple, (PH) multiple, (PI) multiple, (PJ) multiple, (PK) multiple, (PL) multiple, (PM) multiple, (PN) multiple, (PO) multiple, (PP) multiple, (PQ) multiple, (PR) multiple, (PS) multiple, (PT) multiple, (PU) multiple, (PV) multiple, (PW) multiple, (PX) multiple, (PY) multiple, (PZ) multiple, (QA) multiple, (QB) multiple, (QC) multiple, (QD) multiple, (QE) multiple, (QF) multiple, (QG) multiple, (QH) multiple, (QI) multiple, (QJ) multiple, (QK) multiple, (QL) multiple, (QM) multiple, (QN) multiple, (QO) multiple, (QP) multiple, (QQ) multiple, (QR) multiple, (QS) multiple, (QT) multiple, (QU) multiple, (QV) multiple, (QW) multiple, (QX) multiple, (QY) multiple, (QZ) multiple, (RA) multiple, (RB) multiple, (RC) multiple, (RD) multiple, (RE) multiple, (RF) multiple, (RG) multiple, (RH) multiple, (RI) multiple, (RJ) multiple, (RK) multiple, (RL) multiple, (RM) multiple, (RN) multiple, (RO) multiple, (RP) multiple, (RQ) multiple, (RR) multiple, (RS) multiple, (RT) multiple, (RU) multiple, (RV) multiple, (RW) multiple, (RX) multiple, (RY) multiple, (RZ) multiple, (SA) multiple, (SB) multiple, (SC) multiple, (SD) multiple, (SE) multiple, (SF) multiple, (SG) multiple, (SH) multiple, (SI) multiple, (SJ) multiple, (SK) multiple, (SL) multiple, (SM) multiple, (SN) multiple, (SO) multiple, (SP) multiple, (SQ) multiple, (SR) multiple, (SS) multiple, (ST) multiple, (SU) multiple, (SV) multiple, (SW) multiple, (SX) multiple, (SY) multiple, (SZ) multiple, (TA) multiple, (TB) multiple, (TC) multiple, (TD) multiple, (TE) multiple, (TF) multiple, (TG) multiple, (TH) multiple, (TI) multiple, (TJ) multiple, (TK) multiple, (TL) multiple, (TM) multiple, (TN) multiple, (TO) multiple, (TP) multiple, (TQ) multiple, (TR) multiple, (TS) multiple, (TU) multiple, (TV) multiple, (TW) multiple, (TX) multiple, (TY) multiple, (TZ) multiple, (UA) multiple, (UB) multiple, (UC) multiple, (UD) multiple, (UE) multiple, (UF) multiple, (UG) multiple, (UH) multiple, (UI) multiple, (UJ) multiple, (UK) multiple, (UL) multiple, (UM) multiple, (UN) multiple, (UO) multiple, (UP) multiple, (UQ) multiple, (UR) multiple, (US) multiple, (UT) multiple, (UU) multiple, (UV) multiple, (UW) multiple, (UX) multiple, (UY) multiple, (UZ) multiple, (VA) multiple, (VB) multiple, (VC) multiple, (VD) multiple, (VE) multiple, (VF) multiple, (VG) multiple, (VH) multiple, (VI) multiple, (VJ) multiple, (VK) multiple, (VL) multiple, (VM) multiple, (VN) multiple, (VO) multiple, (VP) multiple, (VQ) multiple, (VR) multiple, (VS) multiple, (VT) multiple, (VU) multiple, (VV) multiple, (VW) multiple, (VX) multiple, (VY) multiple, (VZ) multiple, (WA) multiple, (WB) multiple, (WC) multiple, (WD) multiple, (WE) multiple, (WF) multiple, (WG) multiple, (WH) multiple, (WI) multiple, (WJ) multiple, (WK) multiple, (WL) multiple, (WM) multiple, (WN) multiple, (WO) multiple, (WP) multiple, (WQ) multiple, (WR) multiple, (WS) multiple, (WT) multiple, (WU) multiple, (WV) multiple, (WW) multiple, (WX) multiple, (WY) multiple, (WZ) multiple, (XA) multiple, (XB) multiple, (XC) multiple, (XD) multiple, (XE) multiple, (XF) multiple, (XG) multiple, (XH) multiple, (XI) multiple, (XJ) multiple, (XK) multiple, (XL) multiple, (XM) multiple, (XN) multiple, (XO) multiple, (XP) multiple, (XQ) multiple, (XR) multiple, (XS) multiple, (XT) multiple, (XU) multiple, (XV) multiple, (XW) multiple, (XX) multiple, (XY) multiple, (XZ) multiple, (YA) multiple, (YB) multiple, (YC) multiple, (YD) multiple, (YE) multiple, (YF) multiple, (YG) multiple, (YH) multiple, (YI) multiple, (YJ) multiple, (YK) multiple, (YL) multiple, (YM) multiple, (YN) multiple, (YO) multiple, (YP) multiple, (YQ) multiple, (YR) multiple, (YS) multiple, (YT) multiple, (YU) multiple, (YV) multiple, (YW) multiple, (YX) multiple, (YY) multiple, (YZ) multiple, (ZA) multiple, (ZB) multiple, (ZC) multiple, (ZD) multiple, (ZE) multiple, (ZF) multiple, (ZG) multiple, (ZH) multiple, (ZI) multiple, (ZJ) multiple, (ZK) multiple, (ZL) multiple, (ZM) multiple, (ZN) multiple, (ZO) multiple, (ZP) multiple, (ZQ) multiple, (ZR) multiple, (ZS) multiple, (ZT) multiple, (ZU) multiple, (ZV) multiple, (ZW) multiple, (ZX) multiple, (ZY) multiple, (ZZ) multiple

Descrip. MP _____ ft above _____ ft below LSD, Alt. MP _____

Alt. LSD: _____ Accuracy: (source) _____

Water Level: 12.5 ft above MP; 113 ft below LSD Accuracy: _____

Date meag: 1/14 Yield: 1600 gpm Method determined _____

Drawdown: _____ ft Accuracy: _____ Pumping period: _____ hrs

QUALITY OF WATER DATA: Iron .1 ppm Sulfate 0 ppm Chloride 445 ppm Hard. 19 ppm

Sp. Conduct _____ K x 10⁶ Temp. _____ °F Date sampled _____

Taste, color, etc. _____

PUNCHED and VERIFIED
ROLLA COMPUTATION BRANCH

Well No.

MZ

Well No. M 2

Latitude-longitude _____
d m s N
d m s S

HYDROGEOLOGIC CARD

SAME AS ON MASTER CARD Physiographic Province: 03 Section: _____

Drainage Basin: D Subbasin: 135

Topo of well site: (D) depression, stream channel, dunes, flat, hilltop, sink, swamp, (E) (P) (R) (K) (L) (Q) (S) (T) (U) (V) offshore, pediment, hillside, terrace, undulating, valley flat

MAJOR AQUIFER: system _____ series TM aquifer, formation, group MZ

Lithology: _____ Origin: _____ Aquifer Thickness: _____ ft

Length of well open to: _____ ft Depth to top of: _____ ft

MINOR AQUIFER: system _____ series _____ aquifer, formation, group _____

Lithology: _____ Origin: _____ Aquifer Thickness: _____ ft

Length of well open to: _____ ft Depth to top of: _____ ft

Intervals Screened: _____

Depth to consolidated rock: _____ ft Source of data: _____

Depth to basement: _____ ft Source of data: _____

Surficial material: _____ Infiltration characteristics: _____

Coefficient Trans: 105,000 gpd/ft 104 Coefficient Storage: _____

Coefficient Perm: 900 gpd/ft²; Spec cap: 3 gpm/ft; Number of geologic cards: _____

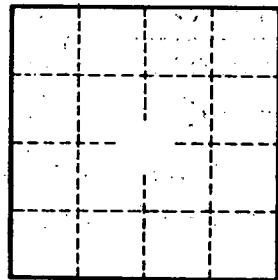
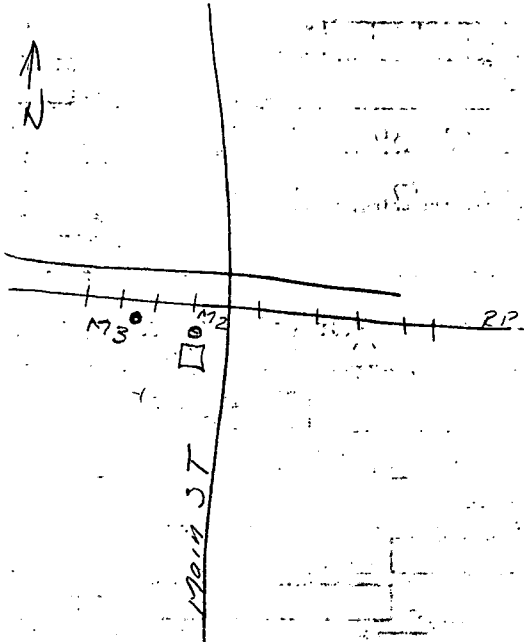

Well No. _____

M 2