

WRD Exp. (GW)
April 1966

Well No. L 35

WELL SCHEDULE

Tag # 64

U. S. DEPT. OF THE INTERIOR

GEOLOGICAL SURVEY

WATER RESOURCES DIVISION

MASTER CARD

Record by J. P. Callahan Source of data 063 DM9 Date 4/10/68 Map GULFPORT Quad

State Miss 28 County (or town) HARRISON 24

Latitude: 30^{deg} 26^{min} 45^{sec} N Longitude: 08^{degrees} 90^{min} 32^{sec} W Sequential number: 1

Lat-long accuracy: 2^{20'} T. 7^N S R. 11^E W Sec 11, NW $\frac{1}{4}$, SE $\frac{1}{4}$, SE $\frac{1}{4}$ B & M

Local well number: L0350DD1107S11W Other number: Dedeaux U.L.

Local use: 688064 568 89 Owner or name: Plummer & Dedeaux subdivision

Owner or name: PLUMMER-DEDEAUX Address: _____

Ownership: County, Fed Gov't, City, Corp or Co, Private, State Agency, Water Dist P

Use of Air cond, Bottling, Comm, Dewater, Power, Fire, Dom, Irr, Med, Ind, P S, Rec, water: _____

Stock, Instit, Unused, Reppure, Recharge, Desal-P S, Desal-other, Other P

Use of (A) (D) (G) (H) (φ) (P) (R) (T) (U) (W) (X) (Z) well: Anode, Drain, Seismic, Heat Res, Obs, Oil-gas, Recharge, Test, Unused, Withdraw, Waste, Destroyed W

DATA AVAILABLE: Well data Freq. W/L meas.: Field aquifer char. Z

Hyd. lab. data: _____

Qual. water data; type: _____

Freq. sampling: _____ Pumpage inventory: yes, no, period: _____

Aperture cards: _____ yes DE

Log data: _____ DE

WELL-DESCRIPTION CARD

SAME AS ON MASTER CARD Depth well: 730 ft Meas. rept accuracy 3

Depth cased (first perf.): 680 ft Casing type: Steel; Diam. 8x6 in 8

Finish: porous concrete, gravel w. (perf.), (screen), (H) horiz. gallery, (φ) open end, (S) perf., (T) screen, (W) sd. pt., (X) shored, (Z) open hole, other S

Method Drilled: (A) air bored, (B) cable, (C) dug, (D) hyd jetted, (H) air rot., (J) percussion, (P) air rot., (R) reverse trenching, (T) driven, (V) air wash, (W) drive wash, (Z) other H

Date Drilled: 4/10/68 968 Pump intake setting: _____ ft 36 38

Driller: C.T SWITZER name address GULFPORT Miss

Lift (type): (A) air, (B) bucket, (C) cent, (J) jet, (L) multiple, (M) multiple, (N) none, (P) piston, (R) rot, (S) submerg, (T) turb, other T Deep 7 Shallow 40

Power (type): diesel, elec, gas, gasoline, hand, gas, wind; H.P. 15 4 Trans. or meter no. _____

Descrip. MP _____ ft above LSD. Alt. MP _____

Alt. LSD: 28 Accuracy: (source) CI 5' 3

Water Level 3 ft above MP; 3 ft below LSD Accuracy: _____ 52 D

Date meas: 468 Yield: _____ gpm 280 Method determined 2

Drawdown: _____ ft Accuracy: _____ Pumping period _____ hrs 2

QUALITY OF WATER DATA: Iron _____ ppm Sulfate _____ ppm Chloride _____ ppm Hard. _____ ppm

Sp. Conduct _____ K x 10⁶ Temp. 79 °F _____ Date sampled _____

Taste, color, etc. PH=9.0

Well No.

L 35

Well No. L35

Latitude-longitude N
S
d m s d m s

HYDROGEOLOGIC CARD

SAME AS ON MASTER CARD Physiographic Province: 03 Section: _____

D Drainage Basin: 135 Subbasin: _____

Topo of well site: (D) depression, stream channel, dunes, flat, hilltop, sink, swamp, (K) (L) (P) (S) (T) (U) (V) offshore, pediment, hillside, terrace, undulating, valley flat 7

MAJOR AQUIFER: system _____ series 7M aquifer, formation, group MZ

Lithology: _____ Origin: _____ Aquifer Thickness: 93 ft

120 Length of well open to: _____ ft 50 Depth to top of: _____ ft 667

MINOR AQUIFER: system _____ series _____ aquifer, formation, group _____

Lithology: _____ Origin: _____ Aquifer Thickness: _____ ft

_____ Length of well open to: _____ ft _____ Depth to top of: _____ ft _____

Intervals Screened: 50' of 008

Depth to consolidated rock: _____ ft _____ Source of data: _____

Depth to basement: _____ ft _____ Source of data: _____

Surficial material: _____ Infiltration characteristics: _____

Coefficient Trans: _____ gpd/ft 703 Coefficient Storage: _____

Coefficient Perm: 580 gpd/ft²; Spec cap: 8.9 gpm/ft; Number of geologic cards: _____

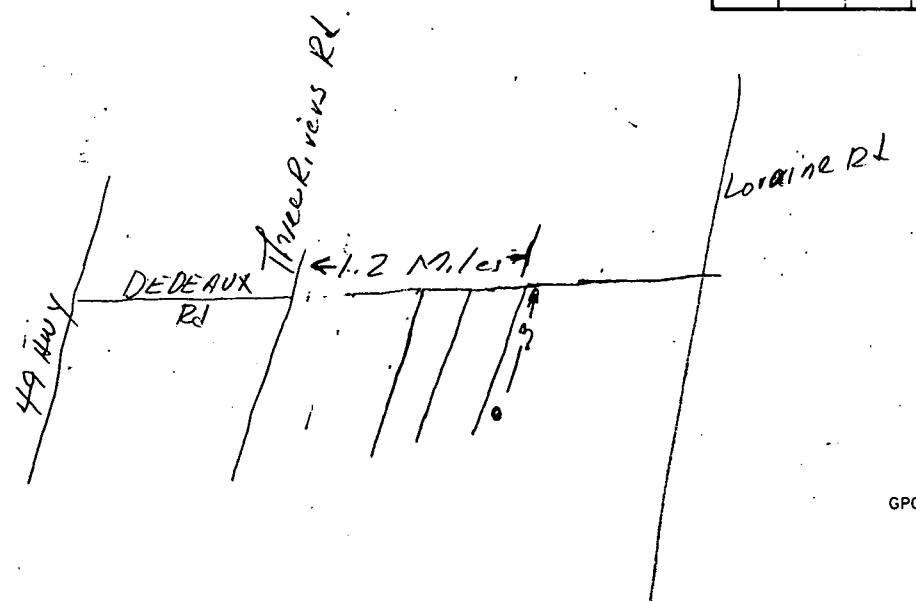
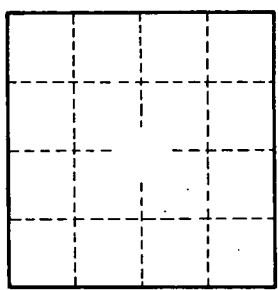
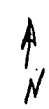

Paragone?

WELL NO.

L35