

Coded By A 296
 Checked By 02/29/96
 Entered By 02/29/96
 Date 2/96

U.S. GEOLOGICAL SURVEY
 WATER RESOURCES DIVISION
 MISSISSIPPI DISTRICT

E-Log No. Hamson
 County Hamson
 Agency Hamson

Well No. H 321
374C

WELL RECORD

Agency Code U S I G S		Site Id 1303231708855241011			Project No. 5047		
Station Name 12 H321 DRAIN WILLIAMS				Latitude 9303237		Longitude 10408855214	
Lat/Long Ac. 11 50		Dist 628	State 7-28	County 047	Land Net 13 W W I N E S I O M I T I O N I S I R I O P A W		
Location Map 14 WILLIAMS			Altitude 16 70	Mec/Meas 17 A L D	Accuracy 18 1ST	Hydrologic Unit 20 03117010191	
Agency Use 803 0		Date Inventoried 711 / /		Station Type 4 Y		Data Type 804	
Instru. 305		Remarks			Relia. 3 C M U		26 X
Date of Construction 21 11/10/1980		Well Use 23 W	Water Use 24 H	Primary Aquifer 714 1216 R A F		Hole Depth 27 330	
Well Depth 28 330		Water Level 30 H 0	Water Level Date 31 11/10/1980		Method 34	Status 37	Source 35 D

CONSTRUCTION DATA

Construction Date 60 11/10/1980		Contractor 65 Coastal		Method 65 H	Finish 66 S
------------------------------------	--	--------------------------	--	----------------	----------------

CONSTRUCTION CASING DATA

Top/Casing 77 19		Bot/Casing 78 320	Diameter 79 12	
Top/Casing 77		Bot/Casing 78	Diameter 79	

CONSTRUCTION OPENINGS DATA

Top/Depth 83 320		Bot/Depth 84 330	Diameter 87 12	Type 85 S	Length 89	Width 88
Top/Depth 83		Bot/Depth 84	Diameter 87	Type 85	Length 89	Width 88

CONSTRUCTION LIFT DATA

Lift Type 43		Date 38 11/10/1980		Intake 44		
Power 45 EL		H.P. 46	Serial No. 49			

MISCELLANEOUS OWNER DATA

Date of Ownership 159 11/10/1980		Owner Name 161 DRAIN WILLIAMS					
-------------------------------------	--	----------------------------------	--	--	--	--	--

MISCELLANEOUS OTHER ID DATA

E-Log No. 190		Assigner 191 M I S S I S S I D I S I					
------------------	--	---	--	--	--	--	--

MISCELLANEOUS QM DATA

R=192	T=A	738#1	Date of Measurement	1934	Aquifer Sampled	1954	Temp	196700010	Value	1974
R=192	T=A	738#2	Date of Measurement	1934	Aquifer Sampled	1954	So Cond	196700095	Value	1974
R=192	T=A	738#3	Date of Measurement	1934	Aquifer Sampled	1954	pH	196700000	Value	1974

MISCELLANEOUS LOGS DATA

R=198	T=A	739#1	Log Type	1994	Sec. Depth	200	End Depth	201	33101
R=198	T=A	739#2	Log Type	1994	Sec. Depth	200	End Depth	201	

MISCELLANEOUS NETWORK DATA 706 = QW WL WD *

R=114	T=A	730#1	Sec. Year	1154	End Year	1164	Agency Source	1174	Freq.	1184
R=121	T=A	730#2	Sec. Year	1154	End Year	1164	Agency Source	1174	Freq.	1184

MISCELLANEOUS REMARKS DATA

R=183	T=A	311#1	Date of Remarks	184	Remarks	185
-------	-----	-------	-----------------	-----	---------	-----

DISCHARGE DATA

R=146	T=A	Pump/Flow	147#1	Date	148	Type	703	Discharge	150	Sp. Capacity	272
-------	-----	-----------	-------	------	-----	------	-----	-----------	-----	--------------	-----

GEOHYDROLOGIC DATA

R=90	T=A	721#1	Depth Top	91	Depth Bot.	92	Unit Id	93	304
------	-----	-------	-----------	----	------------	----	---------	----	-----

HYDRAULIC DATA

R=98	T=A	790#1	Unit Tested	100	103
------	-----	-------	-------------	-----	-----

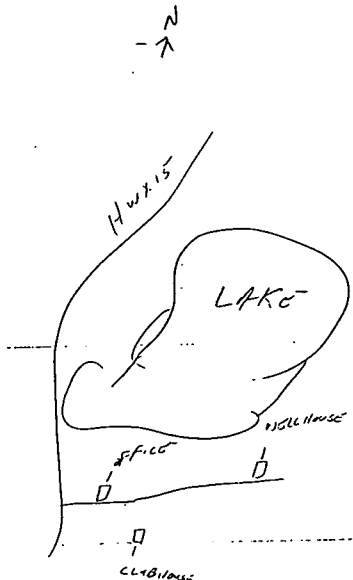

top soil	1	3
red clay	3	15
gravel	15	22
coarse white sand	22	45
blue clay	45	75
white sand	75	90
soft blue clay	90	140
gray sand	140	170
soft blue clay	170	290
hard blue clay	290	300
fine white sand	300	310
coarse white sand	310	330