

# TRANSMITTED FOR ADP

Recorded by BRR

Date 7/2/86

Agency USGS

U.S. GEOLOGICAL SURVEY  
WATER RESOURCES DIVISION  
MISSISSIPPI DISTRICT

## WELL RECORD

Well No. H270

E-Log No. \_\_\_\_\_

County HARRISON  
DUNGO

Site Id 303025088542001 R=0\* T=A\* 2=W\* Data rellab. 3-X\* 841  
30 85

Dist. 6=28\* State 7=28\* Co. 8=04171\* Lat. Long. 9=303025\* 10=0885420\*

Well NO. 12=H2701\* Location 13=WNW1/4S20T06SR09W\* Alt. 16=40.1\*

Hyd. Unit(OWDC) 20=03117010091\* Date 21=1986103121\* (YYYYMMDD) 17=M\*

Agency Use 803-Q1\* Well Use 23=WI\* Water Use 24=HI\* Hole depth 27=1861.1\* Well depth 28=1836.1\*

WL 30=1111.6\* Date 31=1986111120\* Source 33=51\*

Project No. 5= FLWS

R=42\* T=A\* 254#1\* Date 38=1986103121\* Lift Type 43#J\* Intake 44=

Power Type 45=E\* H.P. 46=1.5\*

R=58\* T=A\* 723#1\* Date 60=1986103121\* Drig 63=11581\* Name COAST WATER WELL SER.

Method 65=HI\* Finish 66=SI\* Remarks \_\_\_\_\_

R=76\* T=A\* 725#1\* 59#1\* Top csng 77# 10.1\* Bot.csng 78= 8116.1\* Diam. 79# 2.1\*

R=76\* T=A\* 725#2\* 59#1\* Top csng 77# 1.1\* Bot.csng 78= 1.1\* Diam. 79# 1.1\*

R=82\* T=A\* 726#1\* 59#1\* Top 83# 1816.1\* Bottom 84= 1836.1\* Type 85=SI\*

Diam. 87= 2.1\* Size 88= 1.1\*

R=82\* T=A\* 726#2\* 59#1\* Top 83# 1.1\* Bottom 84= 1.1\* Type 85= 1.1\*

87= 1.1\* 88= 1.1\*

R=90\* T=A\* 721#1\* Top 91= 1790.1\* Bot 92= 1.1\* Unit Id 93= 1121GRMF1\*

R=90\* T=A\* 721#2\* Top 91= 1.1\* Bot 92= 1.1\* Unit Id 93= 1.1\*

R=98\* T=A\* 99#1\* Unit tested 100= 1.1\* 103= 1.1\*

R=105\* T=A\* 99#1\* Test No. 106# 1.1\* 107= 1.1\* Transmissivity(gal/d)/ft

R=114\* T=A\* 706= \_\_\_\_\_\* Year 115# \_\_\_\_\_\* 117= \_\_\_\_\_\* 120= \_\_\_\_\_\*

R=121\* T=A\* Yr Begin 115# \_\_\_\_\_\* Network 257# \_\_\_\_\_\*

R=146\* T=A\* (Flows/Pumped) (circle one) 147#1\* 148= 119861031211\* 0 150= \_\_\_\_\_201\*  
 Q/S 272= \_\_\_\_\_\*

R=158\* T=A\* 718#1\* Date 159# 119861031211\* Owner No. \_\_\_\_\_

Owner 161# DIOWIGI YOUNG \_\_\_\_\_\*

R=189\* T=A\* 736#1\* E-Log No. 190# \_\_\_\_\_\* 191= M I S S I S S I S T \*

R=192\* T=A\* 738#1\* Date 193# 11921112\* Temp 196#00010\* 197= 22.0\*  
 R=192\* T=A\* 738#2\* Date 193# 11921112\* Cond 196#00095\* 197= 760.0\*

R=192\* T=A\* 738#3\* Date 193# \_\_\_\_\_/\_\_\_\_\_/\_\_\_\_\_\* pH 196#00400\* 197= \_\_\_\_\_\*

R=198\* T=A\* 739#1\* Log 199# D\* Top 200= \_\_\_\_\_0.1\* Bot 201= 1861.1\*

R=198\* T=A\* 739#2\* 199# \_\_\_\_\_\* 200= \_\_\_\_\_\* 201= \_\_\_\_\_\*

Remarks: R=183# 311= \_\_\_\_\_/\_\_\_\_\_/\_\_\_\_\_\*

84:  $3\frac{1}{2}$  mi NW OF D'IBERVILLE

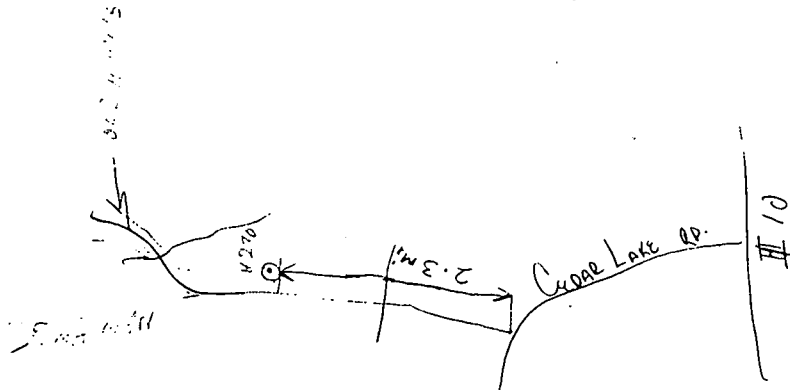

Top soil	0	1
White Clay	1	15
Blue Clay	15	27
Blue Sand	27	26
Blue Clay	28	30
Blue Clay + Oyster Shell	33	40
Blue Sand	40	46
Blue Clay + Oyster Shell	47	46
Gray Coarse Sand	44	49
Blue Clay + Oyster Shell	49	47
Blue Clay	47	50
2" Rock	50	50
Blue Clay	50	55
Blue Clay + Oyster Shell	55	60
Blue Clay + Oyster Shell	60	68
Blue Clay	68	79
Blue Clay + Oyster Shell	79	81
Gray Coarse Sand	81	89
Gray Coarse Sand	89	90
Wood + gravel		

Department of Natural Resources  
Division of Land & Water Resources