

WRD Exp. (GW)  
April 1966

Well No. H 13  
Well - H 13  
dependent on H 265  
new sched H 265  
**WELL SCHEDULE**

U. S. DEPT. OF THE INTERIOR  
GEOLOGICAL SURVEY  
WATER RESOURCES DIVISION  
Well H 265

MASTER CARD

Record by L J Source of data BWC Date 7-68 Map \_\_\_\_\_

State 28 County (or town) HARRIS 24

Latitude: 30<sup>deg</sup> 31<sup>min</sup> 12<sup>sec</sup> N Longitude: 08<sup>degrees</sup> 85<sup>min</sup> 55<sup>sec</sup> W Sequential number: 1

Lat-long accuracy: 1<sup>20</sup> T. 6<sup>N</sup> R. 10<sup>W</sup> Sec. 15 NE 1/4, NW 1/4, SW 1/4 B & M

Local well number: H 013 B C 1506510 W Other number: \_\_\_\_\_

Local use: 064 Owner or name: C. M. PLUMMER

Owner or name: KEESLER AFB Address: SCARBOROUGH FAIR

Ownership: County, Fed Gov't, City, Corp or Co, Private, State Agency, Water Dist F

Use of water: (A) Air cond, Bottling, Comm, Dewater, Power, Fire, Dom, Irr, Med, Ind, P S, Rec, (B) Stock, Instit, Unused, Repressure, Recharge, Desal-P S, Desal-other, Other UNUSUAL 10/22/82

Use of well: (A) Anode, Drain, Seismic, Heat Res, Obs, Oil-gas, Recharge, Test, Unused, Withdraw, Waste, Destroyed W

DATA AVAILABLE: Well data  Freq. W/L meas.:  Field aquifer char.

Hyd. lab. data: \_\_\_\_\_

Qual. water data; type: USGS 5170

Freq. sampling: \_\_\_\_\_ Pumpage inventory:  yes  no, period: \_\_\_\_\_

Aperture cards: \_\_\_\_\_ yes  no

Log data: D

WELL-DESCRIPTION CARD

SAME AS ON MASTER CARD Depth well: 505 ft Meas. 3

Depth cased; (first perf.) 465 ft Casing type: \_\_\_\_\_; Diam. 12 in

Finish: (C) porous concrete, (F) gravel w. (G) gravel w. (H) horiz. open, (P) perf., screen, sd. pt., shored, open hole, (S) other

Method Drilled: (A) air rot., (B) bored, (C) cable, (D) dug, (H) hyd jetted, (J) air rot., (P) reverse percussion, (R) reverse, (T) trenching, (V) driven, (W) drive wash, (Z) other H

Date Drilled: 943 Pump intake setting: \_\_\_\_\_ ft

Driller: Jayne Central address \_\_\_\_\_

Lift (type): (A) air, (B) bucket, (C) cent, (J) jet, (L) multiple, (M) multiple, (N) none, (P) piston, (R) rot, (S) submerg, (T) turb, (Z) other T Deep D Shallow 40

Power (type): (nat) diesel, elec, gas, gasoline, hand, gas, wind; H.P.  Trans. or meter no. \_\_\_\_\_

Descrip. MP 1" plug in N side at 2.0 ft below LSD. Alt. MP \_\_\_\_\_

Alt. LSD: 130 Accuracy: (source) \_\_\_\_\_

Water Level: \_\_\_\_\_ ft above MP; \_\_\_\_\_ ft below LSD 72 Accuracy: \_\_\_\_\_

Date meas: 61 Yield: 20 # gpm 280 Method determined \_\_\_\_\_

Drawdown: \_\_\_\_\_ ft Accuracy: \_\_\_\_\_ Pumping period \_\_\_\_\_ hrs \_\_\_\_\_

QUALITY OF WATER DATA: Iron \_\_\_\_\_ ppm Sulfate \_\_\_\_\_ ppm Chloride \_\_\_\_\_ ppm Hard. \_\_\_\_\_ ppm

Sp. Conduct \_\_\_\_\_ K x 10<sup>6</sup> Temp. \_\_\_\_\_ °F Date sampled \_\_\_\_\_

Taste, color, etc. \_\_\_\_\_

PUNCHED and VERIFIED  
ROLLA COMPUTATION BRANCH

Well No.

H 13

10/24/82  
130  
837  
120.63  
2.0  
118.63

12/5/85  
LALINE WET

Well No. H 13

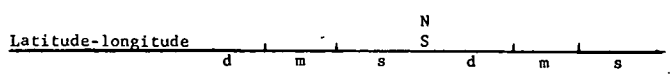

**HYDROGEOLOGIC CARD**

**Physiographic Province:** 03 **Section:** \_\_\_\_\_

**Drainage Basin:** D **Subbasin:** 135

**Topo of well site:** (D) depression, (C) stream channel, (E) dunes, (F) flat, (H) hilltop, (K) sink, (L) swamp, (P) offshore, (S) pediment, (T) hillside, (U) terrace, (V) undulating, valley flat

**MAJOR AQUIFER:** system \_\_\_\_\_ series TIP aquifer, formation, group GF

**Lithology:** US **Origin:** 3 **Thickness:** \_\_\_\_\_ ft

**Length of well open to:** \_\_\_\_\_ ft **Depth to top of:** \_\_\_\_\_ ft

**MINOR AQUIFER:** system \_\_\_\_\_ series \_\_\_\_\_ aquifer, formation, group \_\_\_\_\_

**Lithology:** \_\_\_\_\_ **Origin:** \_\_\_\_\_ **Thickness:** \_\_\_\_\_ ft

**Length of well open to:** \_\_\_\_\_ ft **Depth to top of:** \_\_\_\_\_ ft

**Intervals Screened:** \_\_\_\_\_

**Depth to consolidated rock:** \_\_\_\_\_ ft **Source of data:** \_\_\_\_\_

**Depth to basement:** \_\_\_\_\_ ft **Source of data:** \_\_\_\_\_

**Surficial material:** \_\_\_\_\_ **Infiltration characteristics:** \_\_\_\_\_

**Coefficient Trans:** \_\_\_\_\_ gpd/ft **Coefficient Storage:** \_\_\_\_\_

**Perm:** \_\_\_\_\_ gpd/ft<sup>2</sup>; **Spec cap:** \_\_\_\_\_ gpm/ft; **Number of geologic cards:** \_\_\_\_\_

12" to 460'

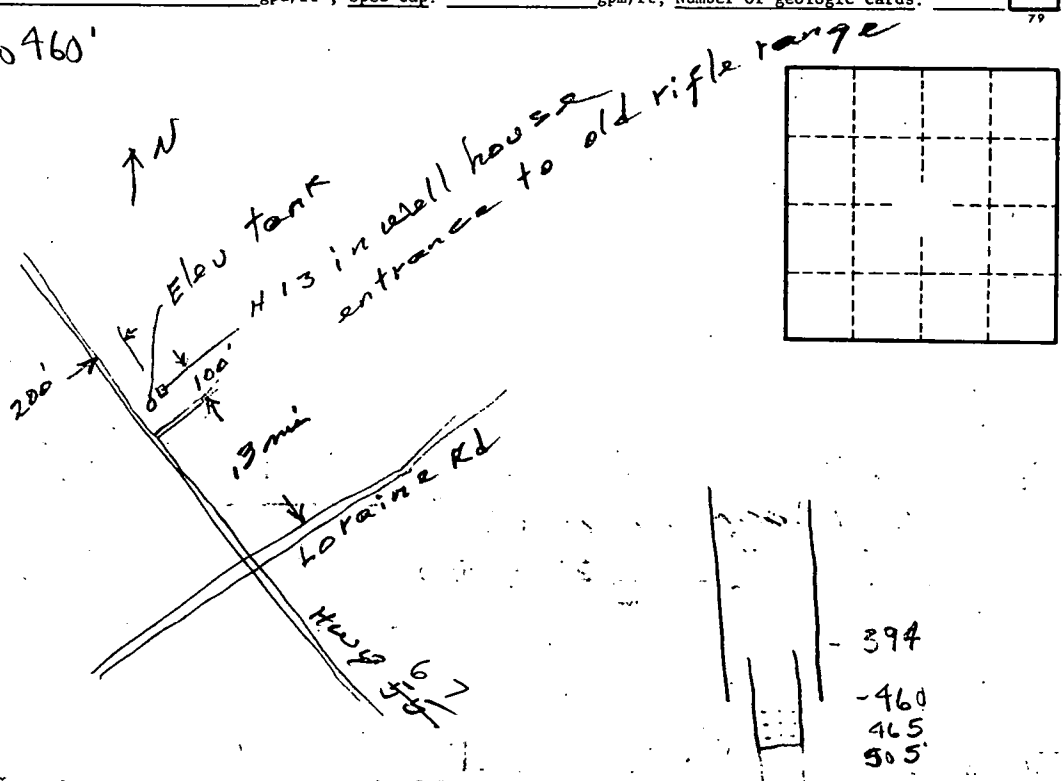

SD-455-505'