

WELL SCHEDULE

U. S. DEPT. OF THE INTERIOR

GEOLOGICAL SURVEY

WATER RESOURCES DIVISION

MASTER CARD

Record by ? Source of data ? Date ? Map Logtown

State Miss. County (or town) Hancock 28 23

Latitude: 30 16 10 N Longitude: 08 9 33 21 Sequential number: 1

Lat-long accuracy: 1 T. 9 0 R. 16 0 Sec. 12, SE SW

Local well number: 4073DC1209S16W Other number: B & M

Local use: MISS HWY DEPT Owner or name: Miss. Highway Dept.

Owner or name: MISS HWY DEPT Address: Magnolia Mem. Rd. side Part

Ownership: County, Fed Gov't, City, Corp or Co, Private, State Agency, Water Dist (S)

Use of water: Air cond, Bottling, Comm, Dewater, Power, Fire, Dom, Irr, Med, Ind, P S, Rec, Stock, Inatit, Unused, Reppure, Recharge, Desal-P S, Desal-other, Other (H)

Use of well: Anode, Drain, Seismic, Heat Res, Obs, Oil-gas, Recharge, Test, Unused, Withdraw, Waste, Destroyed (W)

DATA AVAILABLE: Well data 70 Freq. W/L meas.: 71 Field aquifer char. 72

Hyd. lab. data: 73

Qual. water data; type: 74

Freq. sampling: 75 Pumpage inventory: 76 yes

Aperture cards: 77 yes

Log data: 78 79

WELL-DESCRIPTION CARD

SAME AS ON MASTER CARD Depth well: 675 ft 675 Meas. 24 6

Depth cased; (first perf.) 635 ft 635 Casing type: 20 23 accuracy 29 30 Diam. 3 in 3

Finish: porous concrete, gravel w. (perf.), gravel w. (screen), horiz. gallery, open end, perf., screen, sd. pt., (shored), open hole, other (S)

Method Drilled: air bored, cable, dug, hyd jetted, air reverse, air percussion, rotary, trenching, driven, drive wash, other (H)

Date Drilled: 1938+ 938 Pump intake setting: 33 35 ft 36 38

Driller: Lewis Fields (?) name address

Lift (type): air, bucket, cent, jet, multiple, multiple, none, piston, rot, submerg, turb, other (S) Deep 39 Shallow 40

Power (type): diesel, elec, gas, gasoline, hand, gas, wind; H.P. 41 Trans. or meter no. 42

Descrip. MP GL 0 ft above 41 below LSD, Alt. MP 47 5

Alt. LSD: 20 20 Accuracy: (source) 47 5

Water Level 10.7 ft 42 45 above below MP; Ft below LSD 48 51 Accuracy: 52 A

Date meas: 6/19/56 656 Yield: 47 spm 47 Method determined 61

Drawdown: 62 ft 64 Accuracy: 65 Pumping period 66 68 hrs

QUALITY OF WATER DATA: Iron 69 Sulfate 70 Chloride 47 2 Hard. 72

Sp. Conduct 597 K x 10<sup>6</sup> 8 Temp. 78 °F 74 76 Date sampled 6/19/56 656 77 79

Taste, color, etc. 73

TRANSMITTED FOR ADP

Well No.

173

Well No. L73

Latitude-longitude 30 16 10 <sup>N</sup> 089 33 21  
d m s d m s

HYDROGEOLOGIC CARD

SAME AS ON MASTER CARD  Physiographic Province: 03 Section: \_\_\_\_\_

Drainage Basin: D 13V Subbasin: \_\_\_\_\_

Topo of well site: (D) depression, stream channel, dunes, flat, hilltop, sink, swamp, (E) (F) (H) (K) (L) (M) (P) (S) (T) (U) (V) offshore, pediment, hillside, terrace, undulating, valley flat \_\_\_\_\_

MAJOR AQUIFER: Tertiary system, Pliocene series, TP aquifer, formation, group, Graham Ferry Fm GF

Lithology: US Origin: 3 Aquifer Thickness: \_\_\_\_\_ ft

Length of well open to: 40 ft Depth to top of: \_\_\_\_\_ ft

MINOR AQUIFER: \_\_\_\_\_ system, \_\_\_\_\_ series, \_\_\_\_\_ aquifer, formation, group

Lithology: \_\_\_\_\_ Origin: \_\_\_\_\_ Aquifer Thickness: \_\_\_\_\_ ft

Length of well open to: \_\_\_\_\_ ft Depth to top of: \_\_\_\_\_ ft

Intervals Screened: \_\_\_\_\_

Depth to consolidated rock: \_\_\_\_\_ ft Source of data: \_\_\_\_\_

Depth to basement: \_\_\_\_\_ ft Source of data: \_\_\_\_\_

Surficial material: \_\_\_\_\_ Infiltration characteristics: \_\_\_\_\_

Coefficient Trans: \_\_\_\_\_ gpd/ft Coefficient Storage: \_\_\_\_\_

Coefficient Perm: \_\_\_\_\_ gpd/ft<sup>2</sup>; Spec cap: \_\_\_\_\_ gpm/ft; Number of geologic cards: \_\_\_\_\_

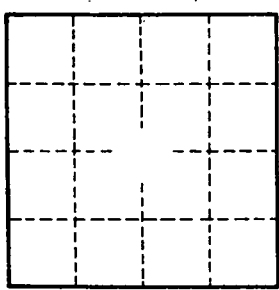

Well No.

L73

DEPARTMENT OF ENVIRONMENTAL QUALITY - OLWR  
PUBLIC SUPPLY WELLS PROJECT

GPS LOG

USER NAME(S): Stewart/Everett DATE: 10/12/95

UNIT DEQ #: \_\_\_\_\_ FILE #: A101220A

HEALTH DEPT. #: 230024-01 ELEV. 20'

USGS #: L73 OLWR #: \_\_\_\_\_

OWNER: MVC Weigh Station #527 QUAD: Lofton

LOCATION: NWSESW S 12 T 9S R 16W COUNTY: Hancock

LOCATION DESCRIPTION: \_\_\_\_\_  
\_\_\_\_\_

CASING DIA: \_\_\_\_\_ PUMP TYPE & SIZE: Subm.

GPS FIELD LOCATION: LAT. 30° 16.302' LONG. 89° 33.354'

GPS CORRECTED LOCATION: LAT. 30.27118850 LONG. 89.55561691

REMARKS: The down the Beacon XL was not working  
\_\_\_\_\_  
\_\_\_\_\_  
\_\_\_\_\_

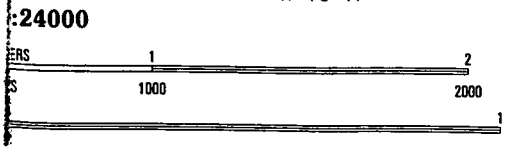
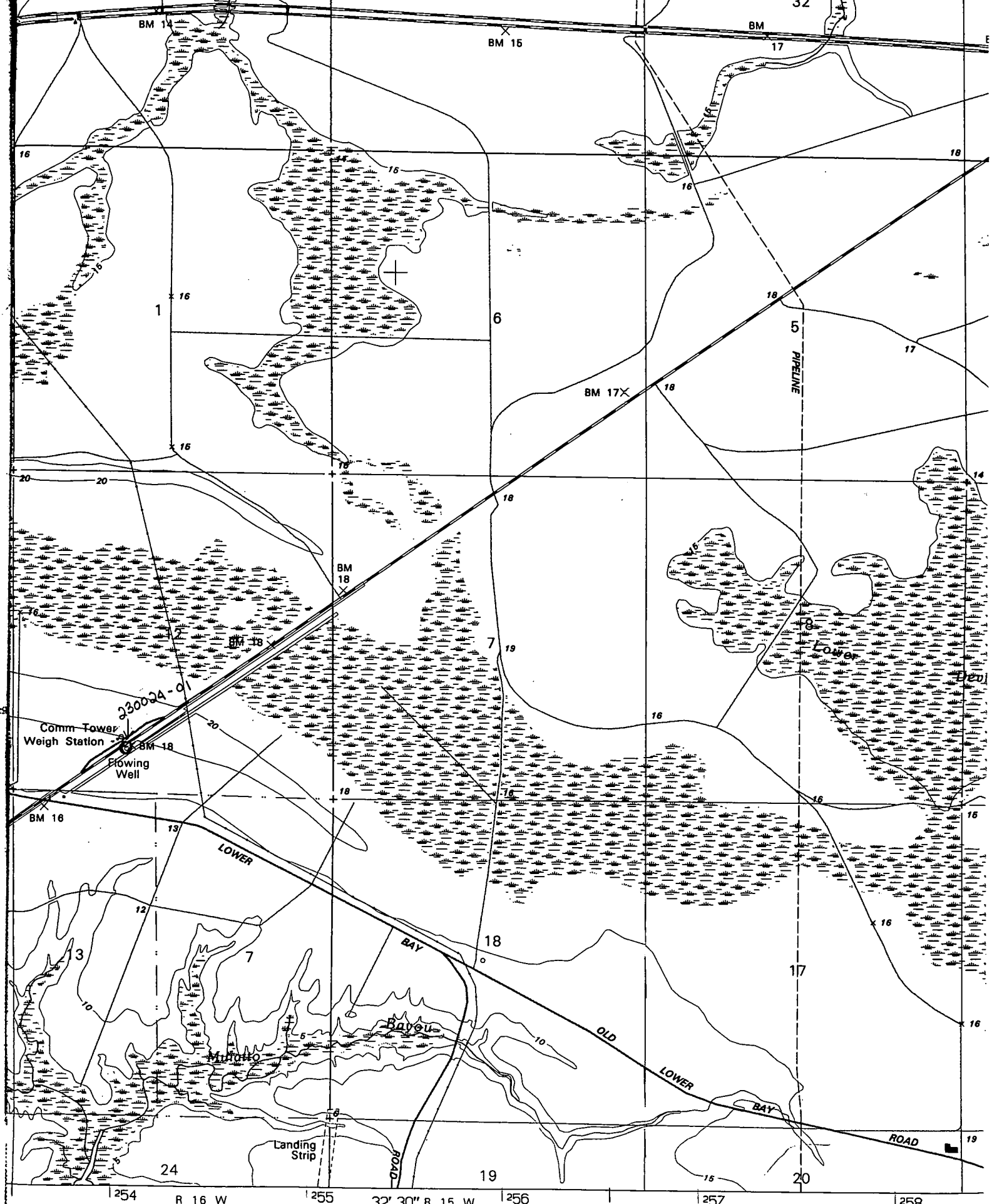

INTERIOR - GEOLOGICAL SUR  
**ROAD CLASS**

Primary highway Li  
 hard surface ..... in  
 Secondary highway