

WELL SCHEDULE

U. S. DEPT. OF THE INTERIOR

GEOLOGICAL SURVEY

WATER RESOURCES DIVISION

MASTER CARD

Record by Q Source of data BOWC Date 9/75 Map Logtown

State MS 28 County (or town) Hancock 23

Latitude: 30<sup>deg</sup> 15<sup>min</sup> 55<sup>sec</sup> N Longitude: 089<sup>degrees</sup> 36<sup>min</sup> 28<sup>sec</sup> W Sequential number: 1

Lat-long accuracy: 3<sup>T</sup> 9<sup>N</sup> 16<sup>R</sup> 16<sup>Sec</sup> 16 SW NE SW SW SW

Local well number: L027CA1609S16W Other number: 1172 B & H 16

Local use: 024 Owner or name: PEARLINGTON SCH Address: \_\_\_\_\_

Ownership: (C) County, Fed Gov't, (F) City, Corp or Co, Private, State Agency, Water Dist 2

Use of Air cond, Bottling, Comm, Dewater, Power, Fire, Dom, Irr, Med, Ind, P S, Rec, water: (S) Stock, (T) Instat, (U) Unused, (V) Recharge, (W) Desal-P S, (X) Desal-other, (Y) Other T

Use of (A) Anode, (D) Drain, (G) Seismic, (H) Heat Res, (I) Obs, (J) Oil-gas, (K) Recharge, (L) Test, (M) Unused, (N) Withdraw, (O) Waste, (P) Destroyed, well: W

DATA AVAILABLE: Well data  Freq. W/L meas:  Field aquifer char.

Hyd. lab. data: \_\_\_\_\_

Qual. water data; type: \_\_\_\_\_

Freq. sampling: \_\_\_\_\_ Pumpage inventory:  yes, no, period: \_\_\_\_\_

Aperture cards: \_\_\_\_\_ yes

Log data: D

10/2/82  
Cond: 320

WELL-DESCRIPTION CARD

SAME AS ON MASTER CARD Depth well: 520 ft Meas. rept accuracy 3

Depth cased; (first perf.) 480 ft Casing type: \_\_\_\_\_; Diam. 6x4 in 6

Finish: (C) concrete, (F) porous gravel w. (perf.), (G) gravel w. (screen), (H) horiz. open gallery, (I) open perf., (J) screen, (K) sd. pt., (L) shored, (M) open hole, (N) other S

Method: (A) air bored, (B) cable, (C) dug, (D) hyd rot., (E) jetted, (F) air percussion, (G) reverse, (H) trenching, (I) driven, (J) wash, (K) other H

Date Drilled: 3-25-66 966 Pump intake setting: \_\_\_\_\_ ft 36

Driller: SUTTER

Lift (type): (A) air, (B) bucket, (C) cent, (D) jet, (E) multiple, (F) multiple, (G) none, (H) piston, (I) rot, (J) submerg, (K) turb, (L) other T Deep  Shallow

Power (type): (A) diesel, (B) elec, (C) gas, (D) gasoline, (E) hand, (F) gas, (G) wind; H.P. 7 1/2 W Trans. or meter no. \_\_\_\_\_

Descrip. MP \_\_\_\_\_ ft above below LSD, Alt. MP \_\_\_\_\_

Alt. LSD: \_\_\_\_\_ Accuracy: (source) \_\_\_\_\_ 47

Water Level: \_\_\_\_\_ ft above below MP; Ft below LSD +6 Accuracy: \_\_\_\_\_ 52

Date meas: 366 Yield: \_\_\_\_\_ gpm 150 Method determined \_\_\_\_\_ 61

Drawdown: \_\_\_\_\_ ft \_\_\_\_\_ Accuracy: \_\_\_\_\_ Pumping period \_\_\_\_\_ hrs \_\_\_\_\_ 68

QUALITY OF WATER DATA: Iron \_\_\_\_\_ ppm \_\_\_\_\_ Sulfate \_\_\_\_\_ ppm \_\_\_\_\_ Chloride \_\_\_\_\_ ppm \_\_\_\_\_ Hard. \_\_\_\_\_ ppm \_\_\_\_\_ 72

Sp. Conduct \_\_\_\_\_ K x 10<sup>6</sup> \_\_\_\_\_ Temp. \_\_\_\_\_ °F \_\_\_\_\_ Date sampled \_\_\_\_\_ 77

Taste, color, etc. \_\_\_\_\_ 79

Well No.

**HYDROGEOLOGIC CARD**

**SAME AS ON MASTER CARD** Physiographic Province: \_\_\_\_\_ Section: 03

D Drainage Basin: \_\_\_\_\_ 13V Subbasin: \_\_\_\_\_

(D) (C) (E) (F) (H) (K) (L)  
 Topo of well site: depression, stream channel, dunes, flat, hilltop, sink, swamp,  
 (O) (P) (S) (T) (U) (V)  
 offshore, pediment, hillside, terrace, undulating, valley flat \_\_\_\_\_

**MAJOR AQUIFER:** \_\_\_\_\_ system \_\_\_\_\_ series TP \_\_\_\_\_ aquifer, formation, group GF

**Lithology:** \_\_\_\_\_ US Origin: \_\_\_\_\_ 3 **Aquifer Thickness:** 119 ft

**Length of well open to:** \_\_\_\_\_ ft 40 **Depth to top of:** \_\_\_\_\_ ft 40.1

**MINOR AQUIFER:** \_\_\_\_\_ system \_\_\_\_\_ series \_\_\_\_\_ aquifer, formation, group \_\_\_\_\_

**Lithology:** \_\_\_\_\_ Origin: \_\_\_\_\_ **Aquifer Thickness:** \_\_\_\_\_ ft

**Length of well open to:** \_\_\_\_\_ ft \_\_\_\_\_ **Depth to top of:** \_\_\_\_\_ ft \_\_\_\_\_

**Intervals Screened:** \_\_\_\_\_

**Depth to consolidated rock:** \_\_\_\_\_ ft \_\_\_\_\_ **Source of data:** \_\_\_\_\_

**Depth to basement:** \_\_\_\_\_ ft \_\_\_\_\_ **Source of data:** \_\_\_\_\_

**Surficial material:** \_\_\_\_\_ **Infiltration characteristics:** \_\_\_\_\_

**Coefficient Trans:** \_\_\_\_\_ gpd/ft \_\_\_\_\_ **Coefficient Storage:** \_\_\_\_\_

**Coefficient Perm:** \_\_\_\_\_ gpd/ft<sup>2</sup>; **Spec cap:** \_\_\_\_\_ gpm/ft; **Number of geologic cards:** \_\_\_\_\_

11/14/85 RWR  
 H 14  
 C 9.1  
 4.9  
 MP 4.4  
 .5

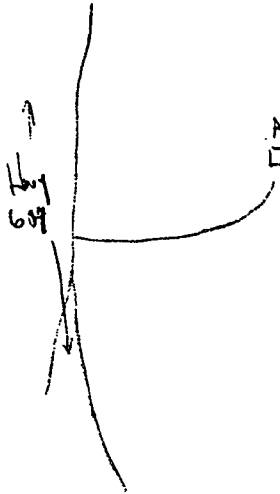

□ Class. Murphy School

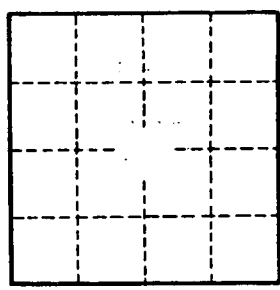

Well No.

HANCOCK

L 27

3-25-66

13V

MISSISSIPPI BOARD OF WATER COMMISSIONERS

CODED

WATER WELL DRILLERS LOG

Date: 3-25, 1966, Driller: Jutter Well Works County Hancock

(When well drilled)		(Name)	(Where well is located)		
(1) Owner of Land:	Pearlington School (Name)		Description & Color of Materials Sand, Clay, Red Clay, Shell, etc.	Thick- ness Feet	Depth Feet
	Pearlington, Miss. (Address)		Clay - sand streaks	48	48
(2) Location:	SW 1/4, NE 1/4, Sec. 16 T9S R 16 W		sand - some gravel	51	99
	1 miles E of Pearlington (distance) (direction) (Nearest Town)		Clay	12	111
(3) Topography:	Flat (Hilly) (Flat) (Level)		sand	15	126
(4) Purpose of Well:	School (Domestic Irrigation Municipal, Industrial, Other)		Clay	113	239
			sand	34	273
			Clay	99	372
			sand	12	384
			Clay	17	401
			sand	119	520

CODED

Information upon completion of well:

- (1) Diameter 4x6 inches.
- (2) Total Depth 520 feet.
- (3) Water Level + 6 feet above ground.
- (4) Cased to all, Size 4" TOP 149' of 6" bel. 4"
- (5) Screen: Size 2 1/2", Length 40'
- (6) Were any formations sealed against pollution?  
 yes,  no.
- If YES depth of formation 100 feet
- Why required
- Drillers Remarks:
- Yield in gpm: 150
- Size pump: 1 1/2 HP
- Type power: elec.

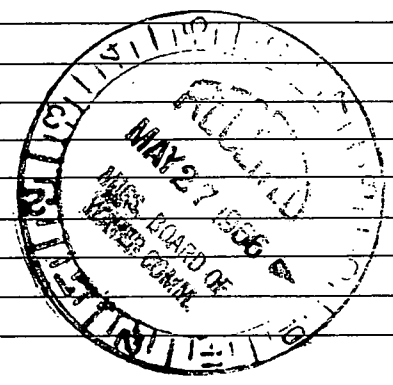

Mail this copy to Board of Water Commissioners 429 Miss. St. Jackson, Miss.

DEPARTMENT OF ENVIRONMENTAL QUALITY - OLWR

PUBLIC SUPPLY WELLS PROJECT

GPS LOG

USER NAME(S): Stewart / Everett DATE: 10/11/95

UNIT DEQ #: \_\_\_\_\_ FILE #: A101121A

HEALTH DEPT. #: 230020-01 ELEV. 7'

USGS #: L27 OLWR #: \_\_\_\_\_

OWNER: Charles B. Murphy School QUAD: Logtown  
IRK

LOCATION: SW SW S 16 T 9S R 16W COUNTY: Hancock

LOCATION DESCRIPTION: Behind school in metal shed

CASING DIA: \_\_\_\_\_ PUMP TYPE & SIZE: Subm

GPS FIELD LOCATION: LAT. 30° 15.444' LONG. 89° 36.709'

GPS CORRECTED LOCATION: LAT. 30.25759722 LONG. 89.61143649

REMARKS: \_\_\_\_\_  
\_\_\_\_\_  
\_\_\_\_\_  
\_\_\_\_\_

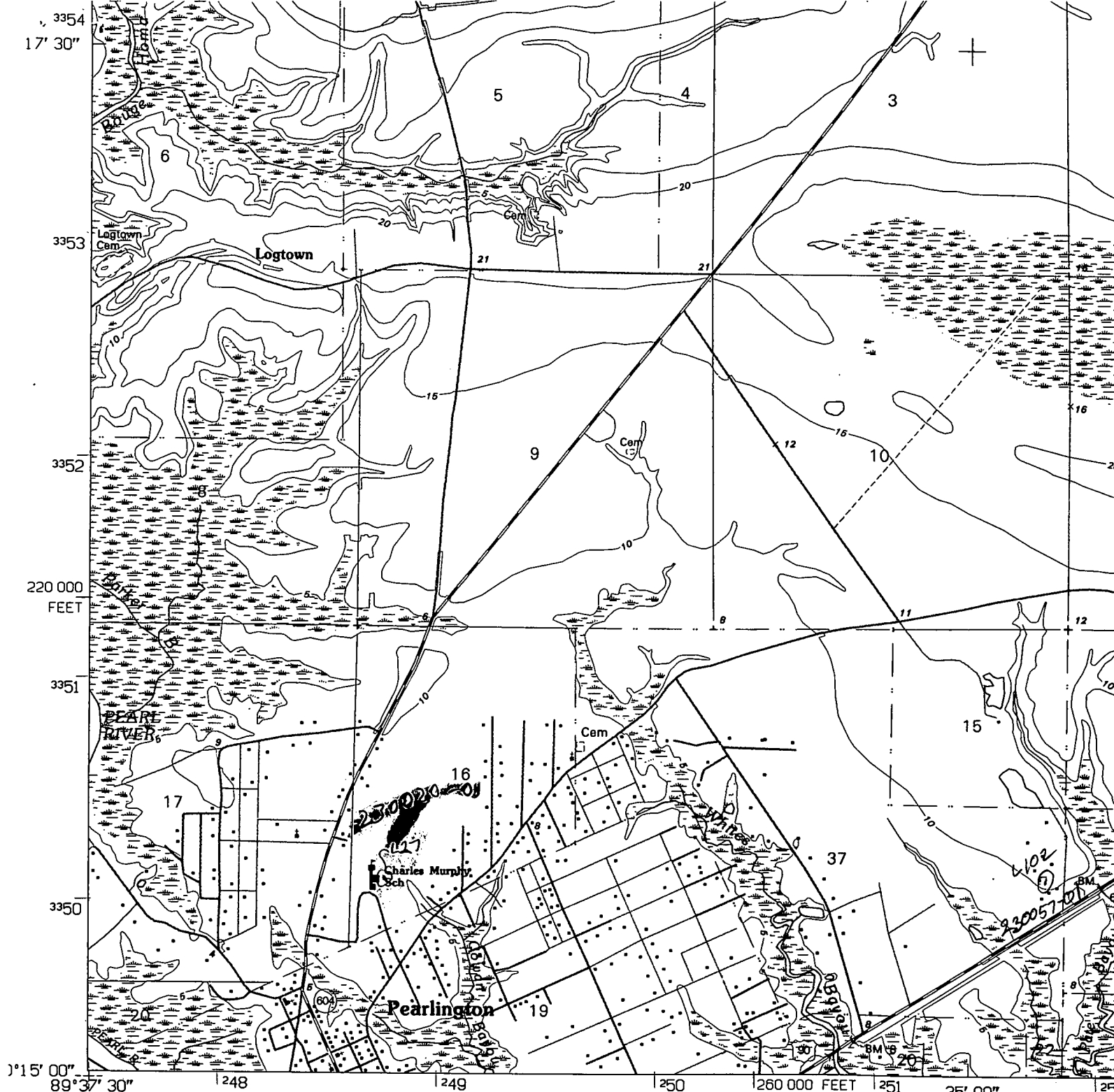

Produced by the United States Geological Survey  
 Planimetry by photogrammetric methods from imagery dated 1954  
 Topography by planimetric surveys 1958. Revised from imagery dated 1989 and other sources. Field checked 1993. Map edited 1994  
 North American Datum of 1927 (NAD 27). Projection and blue 1000-meter ticks: Universal Transverse Mercator, zone 16  
 10 000-foot ticks: Mississippi coordinate system, east zone  
 North American Datum of 1983 (NAD 83) is shown by dashed corner ticks. The values of the shift between NAD 27 and NAD 83 for 7.5-minute intersections are obtainable from National Geodetic Survey NADCON software

There may be private inholdings within the boundaries of the National or State reservations shown on this map

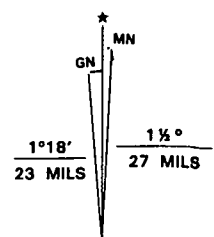

UTM GRID AND 1994 MAGNETIC NORTH DECLINATION AT CENTER OF SHEET

