

WELL SCHEDULE

U. S. DEPT. OF THE INTERIOR

GEOLOGICAL SURVEY

WATER RESOURCES DIVISION

SEP 18 1975

PUNCHED
AUG 26 1975

PUNCHED

MASTER CARD

Record by J. D. ... Source of data _____ Date _____ Map _____

State 28 County ... (or town) _____

Latitude: 30 deg 19 min 29 sec N Longitude: 12 degrees 20 min 08 sec W

Lat-long accuracy: 3 T 3 S R 12 W Sec 20 T. 14 S. 11 W

Local well number: K 305 - B 2008 S 1320 Other number: _____

Local use: _____ Owner or name: Harold ...

Ownership: (C) County, (F) Fed Gov't, (M) City, Corp or Co, (N) Private, (P) State Agency, (W) Water Dist

Use of water: (A) Air cond, (B) Bottling, (C) Comm, (D) Dewater, (E) Power, (F) Fire, (H) Dom, (I) Irr, (M) Med, (N) Ind, (P) S, (R) Rec, (S) Stock, (T) Unstit, (U) Unused, (V) Repressure, (W) Recharge, (X) Desal-P S, (Y) Desal-other, (Z) Other

Use of well: (A) Anode, (D) Drain, (G) Seismic, (H) Heat Res, (O) Obs, (P) Oil-gas, (R) Recharge, (T) Test, (U) Unused, (W) Withdraw, (X) Waste, (Z) Destroyed

DATA AVAILABLE: Well data Freq. W/L meas.: Field aquifer char.

Hyd. lab. data: _____

Qual. water data; type: _____

Freq. sampling: _____ Pumpage inventory: yes no, period: _____

Temperature cards: _____

Log data: _____

WELL-DESCRIPTION CARD

SAME AS ON MASTER CARD Depth well: 870 ft Meas. rept. accuracy _____

Depth cased (first perf.): 830 ft Casing type: _____; Diam. _____ in

Finish: (C) porous concrete, (F) gravel w. (perf.), (G) horiz. (screen), (H) open gallery, (O) end, (P) perf., (S) screen, (T) sd. pt., (W) shored, (X) open hole, (Z) other

Method Drilled: (A) air rot., (B) bored, (C) cable, (D) dug, (H) hvd jetted, (J) rot., (P) air percuss, (R) reverse, (T) trenching, (V) driven, (W) drive wash, (Z) other

Date Drilled: 9/6/6 Pump intake setting: _____ ft

Driller: _____ name _____ address _____

Lift (type): (A) air, (B) bucket, (C) cent., (J) jet, (L) multiple, (M) multiple, (N) none, (P) piston, (R) rot., (S) submerg, (T) turb., (Z) other

Power (type): (nat) diesel, elec, gas, gasoline, hand, gas, wind; (LP) H.P.

Trans. or meter no. U

Descrip. MP _____ ft above _____ ft below LSD, Alt. MP _____

Alt. LSD: 5 Accuracy: 5

Water Level _____ ft above _____ ft below MP; _____ ft below LSD Accuracy: F

Date meas: 1/56 Yield: 660 gpm Method determined 200

Drawdown: _____ ft Accuracy: _____ Pumping period _____ hrs

QUALITY OF WATER DATA: Iron _____ ppm Sulfate _____ ppm Chloride _____ ppm Hard. _____ ppm

Sp. Conduct _____ K x 10 6 Temp. _____ °F Date sampled _____

Taste, color, etc. _____

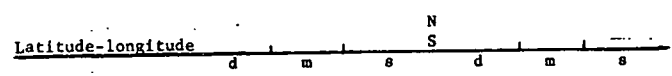

HYDROGEOLOGIC CARD

SAME AS ON MASTER CARD Physiographic Province: 03 Section: _____

Drainage Basin: D 135 Subbasin: _____

Topo of well site: (D) depression, stream channel, dunes, flat, hilltop, sink, swamp, (E) offshore, pediment, hillside, terrace, undulating, valley flat (F) (G) (H) (I) (J) (K) (L) (M) (N) (O) (P) (Q) (R) (S) (T) (U) (V) _____

MAJOR AQUIFER: _____ system _____ series TP _____ aquifer, formation, group GF

Lithology: _____ Origin: 3 Aquifer Thickness: _____ ft

Length of well open to: _____ ft 40 Depth to top of: _____ ft _____

MINOR AQUIFER: _____ system _____ series _____ aquifer, formation, group _____

Lithology: _____ Origin: _____ Aquifer Thickness: _____ ft

Length of well open to: _____ ft _____ Depth to top of: _____ ft _____

Intervals Screened: _____

Depth to consolidated rock: _____ ft _____ Source of data: _____

Depth to basement: _____ ft _____ Source of data: _____

Surficial material: _____ Infiltration characteristics: _____

Coefficient Trans: _____ gpd/ft _____ Coefficient Storage: _____

Coefficient Perm: _____ gpd/ft²; Spec cap: _____ gpm/ft; Number of geologic cards: _____

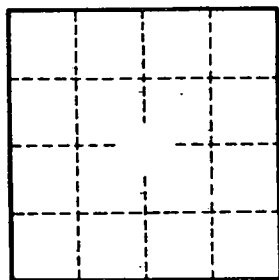
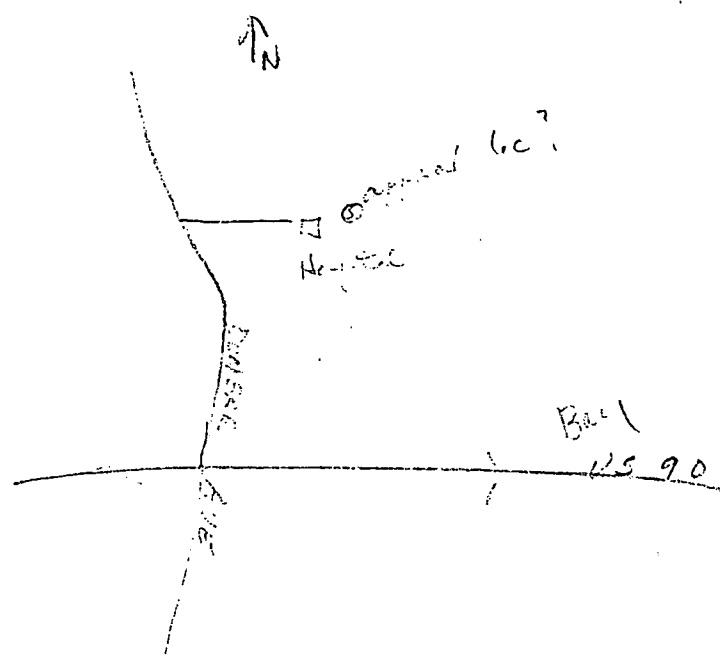

Well No.

Called B. Hicks Sellers Mansville La. 504-626-5665
 2/11/75. (no log set here well records available said he said the person about
 12 years ago) well logs on the well and the other in Gulfport. if he can
 find them. _____