

WELL SCHEDULE

U. S. DEPT. OF THE INTERIOR

GEOLOGICAL SURVEY

WATER RESOURCES DIVISION

7/17/79
NL 5.2'
above LSD

10/14/82
cond = 570
pH = 8.3

MASTER CARD

Record by PEG Source of data Chaplin Photo Date 6-25-64 Map _____

State 28 County (or town) 23

Latitude: 30° 19' 45" N Longitude: 089° 20' 08" W Sequential number: 1

Lat-long accuracy: 3 T. 8 S. R. 13 W Sec. 19, 11 T., _____ S., _____ E.

Local well number: K006 Other well number: 1908S13W B & M

Local use: 024 Owner or name: CITY OF BAY ST LOUIS

Owner or name: BAY ST LOUIS Address: _____

Ownership: County, Fed Gov't, City, Corp or Co, Private, State Agency, Water Dist M

Use of Air cond, Bottling, Comm, Dewater, Power, Fire, Dom, Irr, Med, Ind, P S, Rec, _____

Water: (S) (T) (U) (V) (W) (X) (Y) (Z) Standby use P

Stock, Instit, Unused, Repressure, Recharge, Desal-P S, Desal-other, Other _____

Use of well: (A) (D) (G) (H) (I) (P) (R) (T) (U) (W) (X) (Z) W

Anode, Drain, Seismic, Heat Res, Obs, Oil-gas, Recharge, Test, Unused, Withdraw, Waste, Destroyed, _____

DATA AVAILABLE: Well data Freq. W/L meas.: Field aquifer char.

Hyd. lab. data: _____

Qual. water data; type: MSSH-9.459 complet.

Freq. sampling: _____ Pumpage inventory: yes no, period: _____

Aperture cards: _____

Log data: _____

WELL-DESCRIPTION CARD

SAME AS ON MASTER CARD Depth well: 841 ft Meas. 3

Depth cased: (first perf.) 780 ft Casing type: _____; Diam 24 in

Finish: (C) porous concrete, (F) gravel w. (G) gravel w. (H) horiz. open (I) screen, (J) sd. pt., (K) shored, (L) open hole, (M) other

Method: (A) air bored, (B) cable, (C) dug, (D) hyd jetted, (E) air rot., (F) percussion, (G) rotary, (H) reverse, (I) trenching, (J) driven, (K) drive wash, (L) other

Date Drilled: 9.5.71 Pump intake setting: _____ ft

Driller: FRED BOTTEK address _____

Lift (type): (A) air, (B) bucket, (C) cent, (D) jet, (E) multiple, (F) multiple, (G) none, (H) piston, (I) rot, (J) submerg, (K) turb, (L) other T Deep Shallow

Power (type): (A) diesel, (B) elec, (C) gas, (D) gasoline, (E) hand, (F) gas, (G) wind, (H) H.P. 50 Trans. or meter no. _____

Descrip. MP 1' below LSD ft above below LSD, Alt. MP _____

Alt. LSD: 20 Accuracy: (source) CIS

Water Level 15 ft above below MP; Ft above below LSD 715 Accuracy: _____

Date meas: 6/25/64 Yield: 60 gpm 750 Method determined _____

Drawdown: _____ ft Accuracy: _____ Pumping period _____ hrs

QUALITY OF WATER DATA: Iron _____ ppm Sulfate _____ ppm Chloride _____ ppm Hard. _____ ppm

Sp. Conduct _____ K x 10⁶ Temp. _____ °F Date sampled _____

Taste, color, etc. _____

PRINTED AND REPRODUCED BY THE GEOLOGICAL SURVEY

Well No. K6

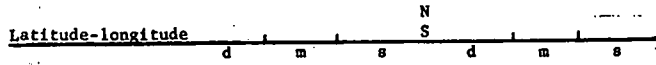

HYDROGEOLOGIC CARD

SAME AS ON MASTER CARD 03 Section: _____
 Province: _____
 Drainage Basin: D Subbasin: 13S

Topo of well site: (D) depression, stream channel, dunes, flat, hilltop, sink, swamp, (P) offshore, pediment, hillside, terrace, undulating, valley flat
 (C) (E) (F) (H) (K) (L) (S) (T) (U) (V)

MAJOR AQUIFER: system _____ series TP aquifer, formation, group GIF

Lithology: _____ Origin: 3 Aquifer Thickness: _____ ft

Length of well open to: _____ ft 60 Depth to top of: _____ ft

MINOR AQUIFER: system _____ series _____ aquifer, formation, group _____

Lithology: _____ Origin: _____ Aquifer Thickness: _____ ft

Length of well open to: _____ ft _____ Depth to top of: _____ ft

Intervals Screened:

Depth to consolidated rock: _____ ft _____ Source of data: _____

Depth to basement: _____ ft _____ Source of data: _____

Surficial material: _____ Infiltration characteristics: _____

Coefficient Trans: _____ gpd/ft _____ Coefficient Storage: _____

Coefficient Perm: _____ gpd/ft²; Spec cap: _____ gpm/ft; Number of geologic cards: _____

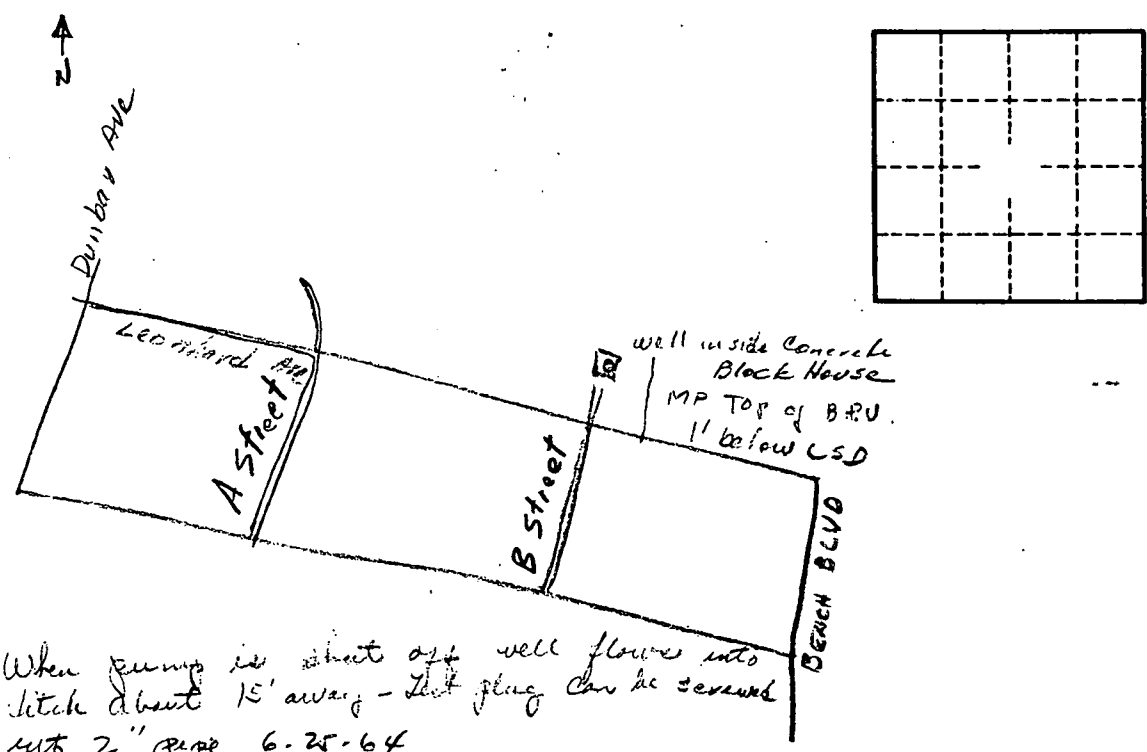

When pump is shut off well flows into ditch about 15' away - that plug can be removed with 2" pipe 6-25-64

Well No. 106