

9-185  
(October 1950)

- Well is not in use -

UNITED STATES  
DEPARTMENT OF THE INTERIOR  
GEOLOGICAL SURVEY  
WATER RESOURCES DIVISION

OUT ✓

WELL SCHEDULE

Date June 29, 1960 Field No. \_\_\_\_\_  
Record by B. E. Ellis Office No. K-1  
Source of data Charley Rhodes, Water Supt.

1. Location: State MISS. County Hancock  
Map St. Charles St. Old well  
NN NW 1/4 SW 1/4 sec. 130 T 8 N R 13

2. Owner: CITY OF BOY ST. LOUIS Address BOY ST LOUIS  
Tenant \_\_\_\_\_ Address \_\_\_\_\_  
Driller SUTTER Address PAUL CHRISTIAN

3. Topography \_\_\_\_\_

4. Elevation 16 ft.  above  below MSL

5. Type: Dug  drilled  driven, bored, jetted. 1960

6. Depth: Rept. 1300 ft. Meas. \_\_\_\_\_ ft.

7. Casing: Diam. 4 in., to \_\_\_\_\_ in., Type \_\_\_\_\_  
Depth 1280 ft., Finish STRAWER 20'

8. Chief Aquifer \_\_\_\_\_ From \_\_\_\_\_ ft. to \_\_\_\_\_ ft.  
Others 20'3 7-21-60 PEG BEE

9. Water level 28.9 ft.  above  below TOP OF  
PLATE ON WELL HEAD which is 1.2 ft.  above  below surface

10. Pump: Type NONE Capacity \_\_\_\_\_ G. M.  
Power: Kind \_\_\_\_\_ Horsepower \_\_\_\_\_

11. Yield: Flow \_\_\_\_\_ G. M., Pump \_\_\_\_\_ G. M., Meas., Rept. Est.  
Drawdown \_\_\_\_\_ ft. after \_\_\_\_\_ hours pumping \_\_\_\_\_ G. M.

12. Use: Dom., Stock, PS., RR., Ind., Irr.  (Obs.)  
Adequacy, permanence Plenty

13. Quality good BUT PUMPS SAND Temp 80 °F.  
Taste, odor, color \_\_\_\_\_ Sample  Yes 7-21-64 No

Unfit for \_\_\_\_\_

14. Remarks: (Log, Analyses, etc.) Well abandoned  
because of excess sand.

This well abandoned; would make perfect observation well - 6-25-64 P.E.G.

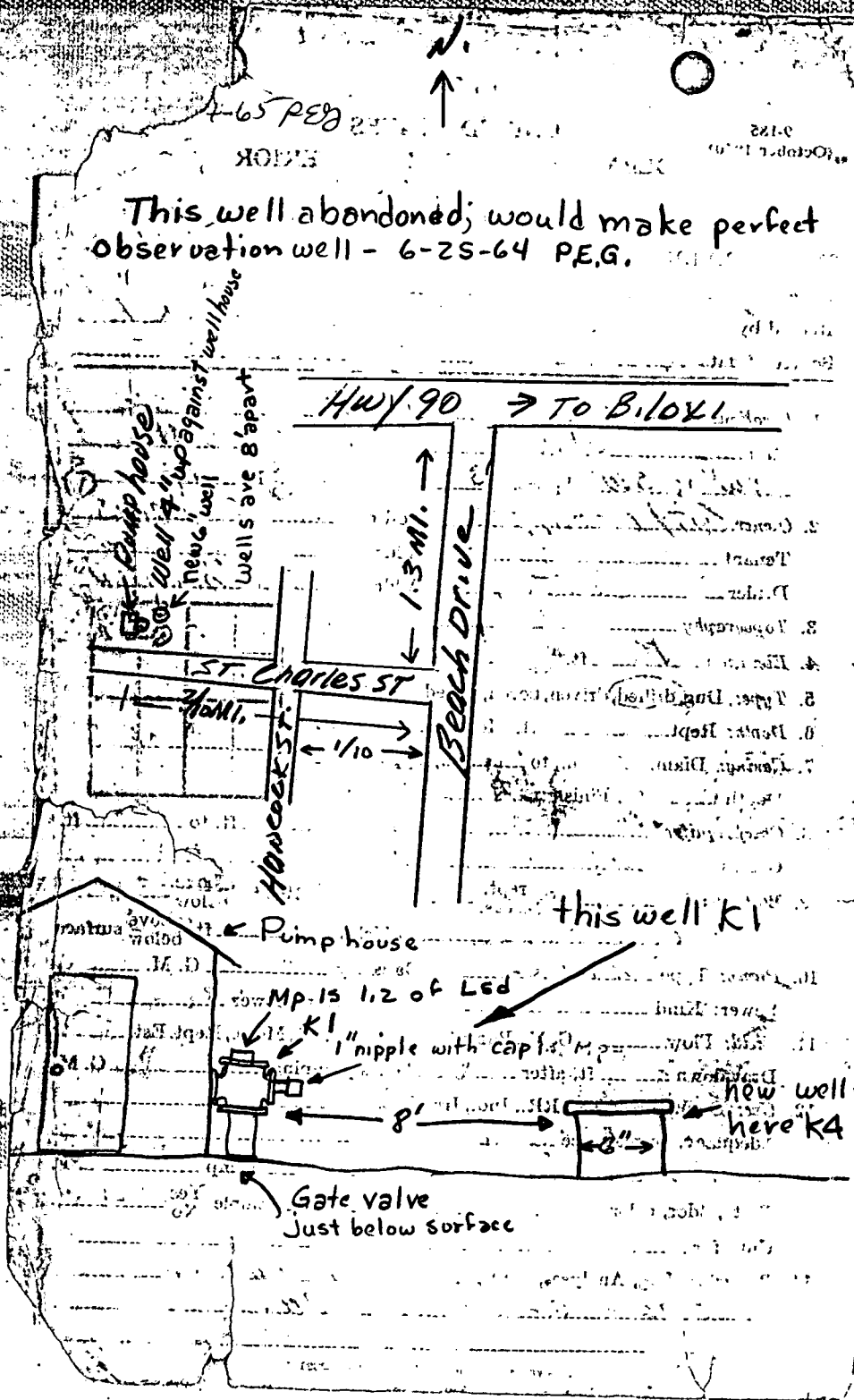

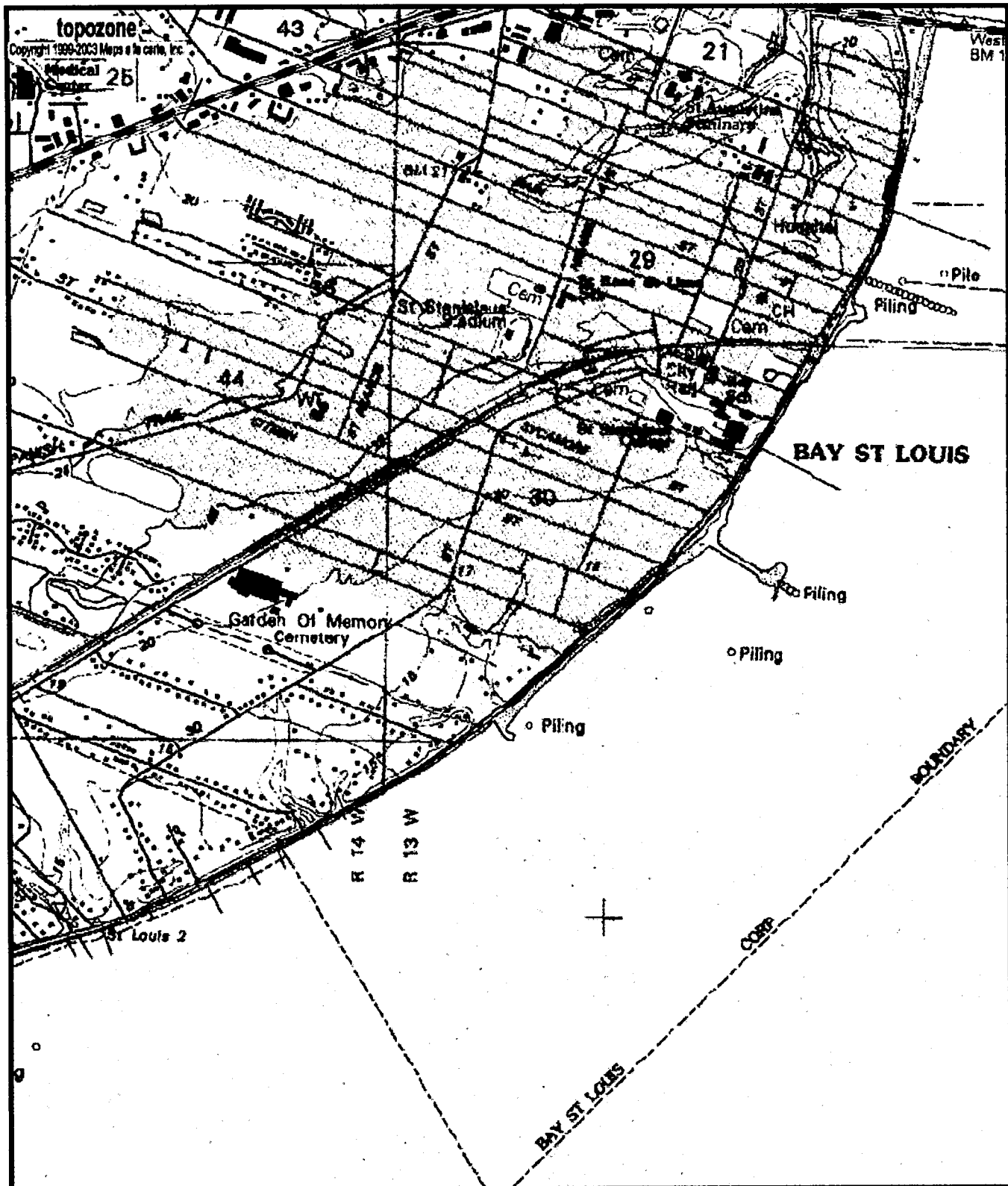

Map center is 30° 18' 05"N, 89° 20' 13"W (WGS84/NAD83)  
**Bay Saint Louis** quadrangle - TopoZone Pro elevation display  
 Projection is UTM Zone 16 NAD83 Datum

M=0.182  
 G=-1.18



Yahoo! - Help

Maps Yellow Pages City Guides Travel

### Yahoo! Maps

[Back to Map](#)

★ Hancock St  
Bay St Louis, MS 39520-4121

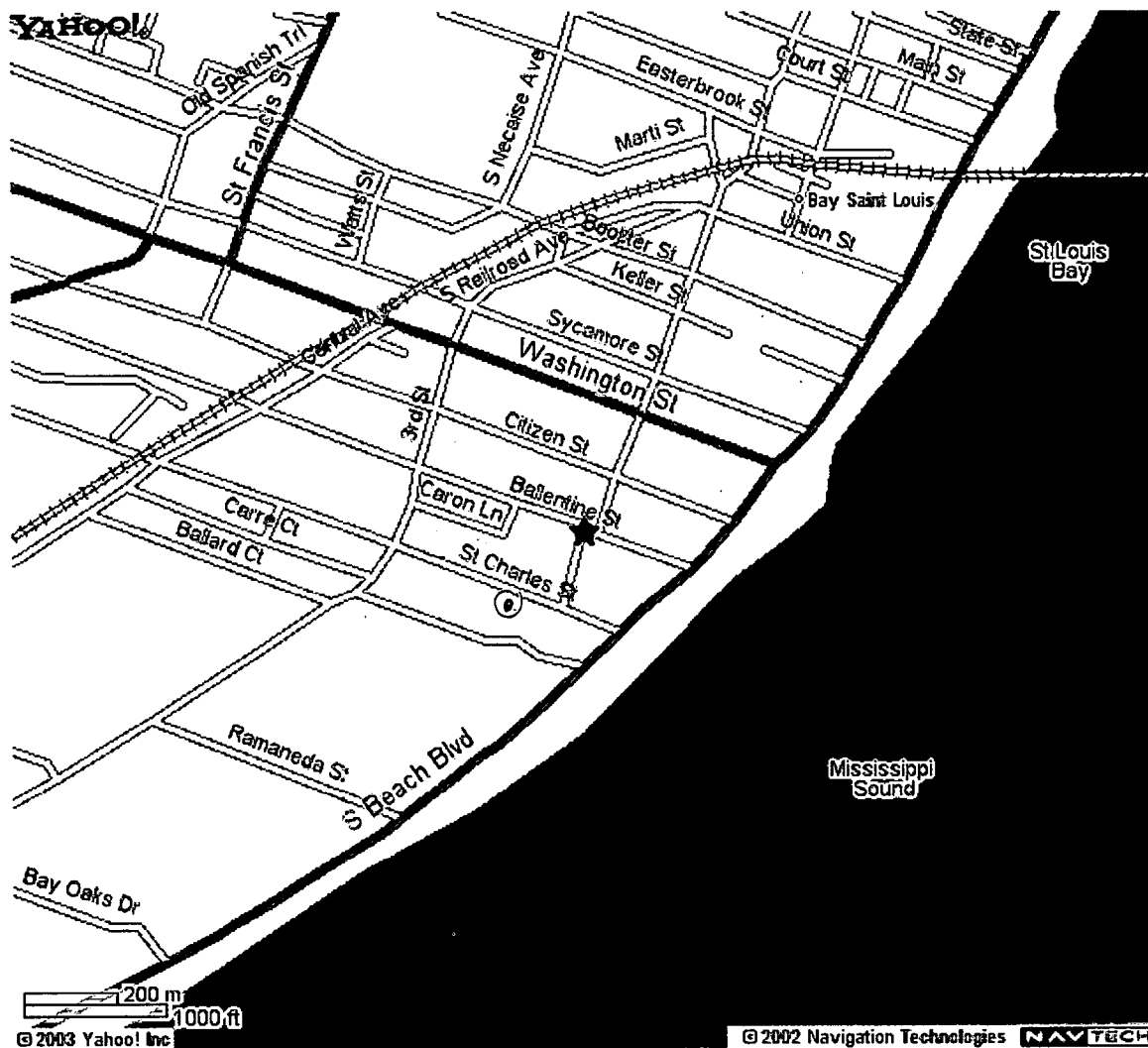

When using any driving directions or map, it's a good idea to do a reality check and make sure the road still exists, watch out for construction, and follow all traffic safety precautions. This is only to be used as an aid in planning.

Copyright © 2003 Yahoo! Inc. All rights reserved.  
[Privacy Policy](#) - [Terms of Service](#) - [Copyright Policy](#) - [Yahoo! Maps Terms of Use](#) - [Help](#) - [Ad Feedback](#)