

6W14157

131B

Coded By BRR 9/92
Checked By JTG 11-6-92
Entered By JTG
Date 10-16-92

U.S. GEOLOGICAL SURVEY
WATER RESOURCES DIVISION
MISSISSIPPI DISTRICT

E-Log No. _____
County GREENATA
Agency _____

Well No. 1144

Duck Hill Quad

WELL RECORD

Agency Code UISIGIS Site Id 1431341112121819144511011 Project No. 54

Station Name 12=H114141 GIEDRIG11A1 PACIFIC Latitude 9=313411212 Longitude 10=018R1414591

Lat/Long Ac. 11=S O T M Dist 6=28 State 7=28 County 8=043 Land Net 13=H114141211 W R 1015121

Location Map 14=DUKIKI H11414 Altitude 22.7 Met/Meas 17=A L M Accuracy 18=1210 Hydrologic Unit 20=01810131210101

Agency Use 903=A I O Date Inventoried 711= Station Type 4 Data Type 804=

SE/SW/SE

Instru. 805= Remarks _____ Relia. 3=C L M O 2=X

Date of Construction 21=06/11/11/1992 Well Use 23=M Water Use 24=M Primary Aquifer 714=1214W141W1 Hole Depth 27=11210

Well Depth 29=11111 Water Level 30=1215 Water Level Date 31=06/11/11/1992 Method 34= Status 37= Source 33=D

CONSTRUCTION DATA

Construction Date 60=06/11/11/1992 Contractor 63=1012 Method 65=H Finish 66=G
Name SUNBELT

CONSTRUCTION CASING DATA

Too/Casing	Bot/Casing	Diameter
<u>R=76 T=A 725#1 59#1 77</u>	<u>78 1911</u>	<u>79 121</u>
<u>R=76 T=A 725#2 59#1 77</u>	<u>78</u>	<u>79</u>

CONSTRUCTION OPENINGS DATA

Too/Depth	Bot/Depth	Diameter	Type	Length	Width
<u>R=82 T=A 726#1 59#1 83 1911</u>	<u>84 11111</u>	<u>87 121</u>	<u>85 S</u>	<u>89</u>	<u>88 10361</u>
<u>R=82 T=A 726#2 59#1 83</u>	<u>84</u>	<u>87</u>	<u>85 S</u>	<u>89</u>	<u>88</u>

CONSTRUCTION LIFT DATA

Power 45 H.P. 46 Serial No. 49

Lift Type 43=S Date 38=06/11/11/1992 Intake 44=1101

MISCELLANEOUS OWNER DATA

Date of Ownership 159=06/11/11/1992 Owner Name 161=GIEDRIG11A1 PACIFIC

MISCELLANEOUS OTHER ID DATA

E-Log No. 190 Assigner 191=M I S S I D I S I

MISCELLANEOUS QW DATA

R=192	T=A	738#1	Date of Measurement	1934 / / .	Aquifer Sampled	1954 .	Temp	196700010	Value	1974 .
R=192	T=A	738#2	Date of Measurement	1934 / / .	Aquifer Sampled	1954 .	So Cond	196700095	Value	1974 .
R=192	T=A	738#3	Date of Measurement	1934 / / .	Aquifer Sampled	1954 .	OH	196700000	Value	1974 .

MISCELLANEOUS LOGS DATA

R=198	T=A	739#1	Log Type	1994 D .	Sec. Depth	2004 .	End Depth	2014 20 .
R=198	T=A	739#1	Log Type	1994 .	Sec. Depth	2004 .	End Depth	2014 .

MISCELLANEOUS NETWORK DATA $T_{106} = Qw \cdot WL \cdot WD \cdot *$

R=114	T=A	730#1	Sec. Year	1154 4 .	End Year	1164 4 .	Agency Source	120=A	1174 .	Freq.	1184 .
R=121	T=A	730#2	Sec. Year	1154 4 .	End Year	1164 4 .	Agency Source	1174 .	Freq.	1184 .	

MISCELLANEOUS REMARKS DATA

R=183	T=A	311#1	Date of Remarks	1844 0161 1199 9 2 .	Remarks	1854 PMT 14157 .
-------	-----	-------	-----------------	--	---------	------------------

DISCHARGE DATA

R=146	T=A	Pump Flow	147#1	Date	1484 0161 1199 9 2 .	Type	7034 D	Discharge	1504 1826 .	So. Capacity	2724 .
-------	-----	-----------	-------	------	--	------	--------	-----------	-------------------	--------------	------------------

GEOHYDROLOGIC DATA

R=90	T=A	721#1	Depth Top	914 180 .	Depth Bot.	924 .	Unit Id	934 214 .	3044 =
------	-----	-------	-----------	-----------------	------------	-----------------	---------	-----------------------------------	--------

HYDRAULIC DATA

R=98	T=A	790#1	Unit Tested	1004 .	1034 .
------	-----	-------	-------------	----------------------------	------------

9 MI S. OF GRENADA

DESCRIPTION OF FORMATIONS ENCOUNTERED	FROM	TO
Clay	0	10
Sand	10	60
Clay	60	80
Sand	80	120

**MISSISSIPPI DEPARTMENT OF ENVIRONMENTAL QUALITY
Bureau of Land and Water Resources**

P. O. Box 10631
Jackson, MS 39289-0631

WATER WELL DRILLERS LOG

COUNTY WELL LOCATED Montgomery		PERMIT NUMBER 14157
WELL NUMBER A144	CODED <input checked="" type="checkbox"/>	
DATE WELL COMPLETED 6-11-92		NAME OF DRILLING FIRM SunBelt Water Well Serv., Inc.
		LOCATION Holcomb, MS

NAME & MAILING ADDRESS OF LANDOWNER
Georgia-Pacific Corp.

Rt. 1 - Box 17

Duck Hill, MS 38925

WELL LOCATION: SEC 14 TOWNSHIP 21 N RANGE 5 E

DISTANCE 9 Miles DIRECTION South of NEAREST TOWN Grenada

OTHER LANDMARK

WELL PURPOSE: Home, Irrigation, Municipal, Industrial, Fish Pond, etc.
Industrial

PUMP DATA

PUMP TYPE (Circle One):
Submersible, Turbine, Jet Flowing Well,
Other (Describe)

POWER TYPE (Circle One):
Electric, Tractor, Diesel, Gasoline, Butane,
Other (Describe)

Pump Capacity (GPM) 850	No. of Stages 4	Setting Depth 80' FT.
-----------------------------------	---------------------------	---------------------------------

PUMP TEST

Well yielded 825 GPM with
a drawdown of 18' ft.
after 1 hours of pumping

WELL DATA

Well Depth 111'	Casing Diameter (In.) 12"	Casing Length (Ft.) 91'
Type of Casing PVC	Hole Depth 111'	Depth to Static Water Level 25'

TYPE OF COMPLETION: (Circle One or More):
Gravel Packed, Underreamed, Telescoped,
Natural Development, Open Hole, Other
(Describe) **Straight Well**

Top of Lap Pipe or Reduction in Casing
none FEET IF TELESCOPED OR MORE THAN ONE SCREEN: USE BACK PAGE

LOG DATA

TYPE OF LOG RUN (Circle One): No Log Run,
Electric, Gamma Ray, Density, Sonic, Neutron,
Other (Describe)

Name of Organization Running Log

SCREEN DATA

Diameter - Inches 12"	Length - Feet 20'	Slot Size - Inches .030
Screen Type PVC	Depth to Bottom - Feet 111'	

GEOLOGIC DATA (Office Use Only)

Surface Elev.	Geologic Unit	Unit Thickness	Depth to Top
Subs. SWL	Date	Analysis	Aquifer Test

Driller's Remarks
PER. SAN. UPST. LOG

DESCRIPTION OF FORMATIONS ENCOUNTERED	FROM	TO	FORMATIONS (Continued)	FROM	TO
Clay	0	10			
Sand	10	60			
Clay	60	80			
Sand	80	120			

RECEIVED
JUN 24 1992
Dept. of Environmental Quality
Bureau of Land & Water Resources

IF MORE SPACE IS NEEDED, USE BACK

GEORGIA PACIFIC MS-GW-14157
H144 GRENADA CO. 11-9-2002

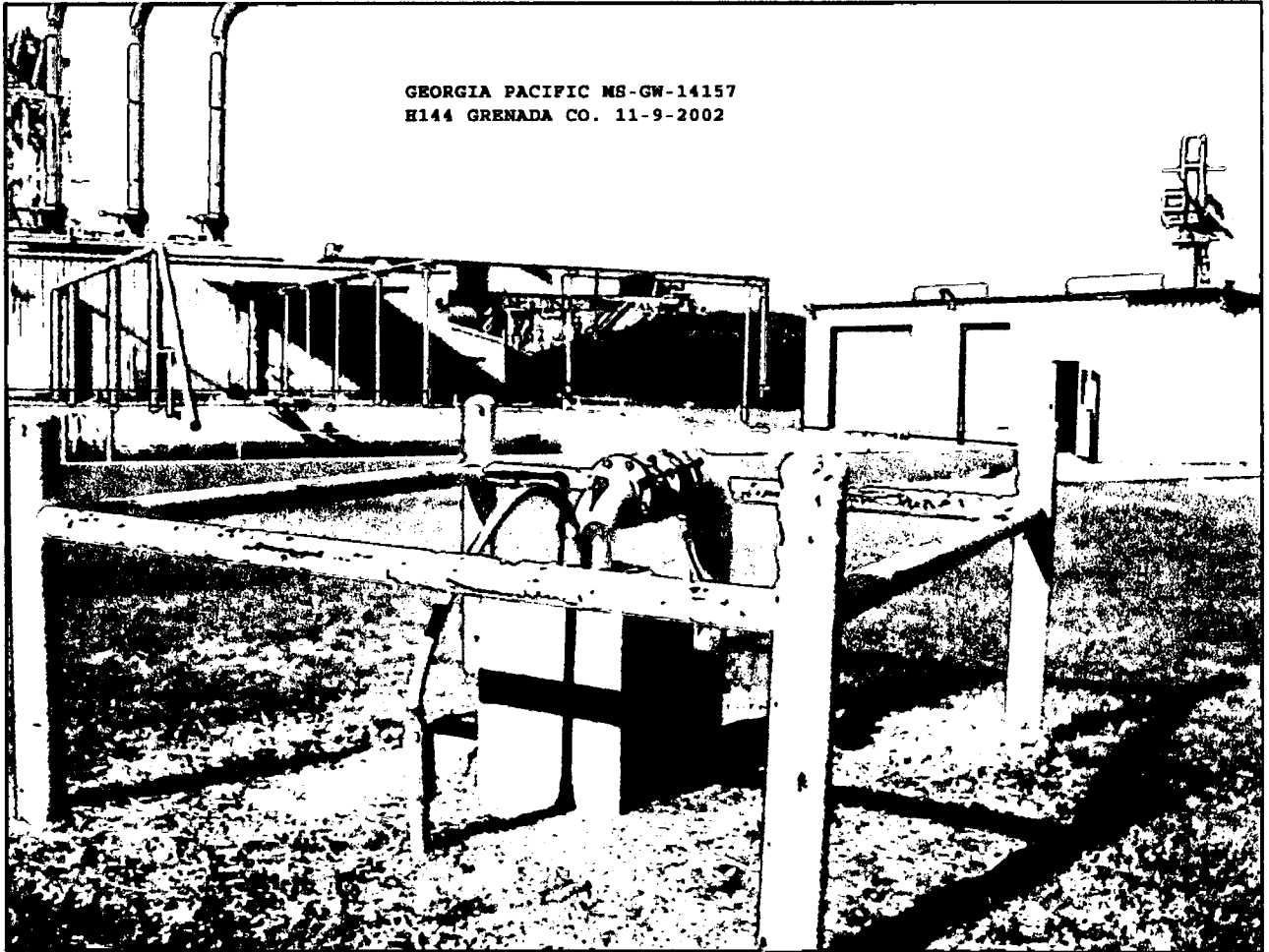

DEPARTMENT OF ENVIRONMENTAL QUALITY - OLWR-
PUBLIC SUPPLY WELLS PROJECT

GPS LOG

USER NAME (S) : RLB

DATE : 11-9-2002

UNIT DEQ # : _____

FILE # : _____

HEALTH DEPT. # : _____

ELEVATION : ²²⁷
~~247~~ FT. G.P.S.

USGS # : h144

OLWR # : ms-gw-14157

OWNER : georgia pacific

QUAD : duck hill

LOCATION : _____ S _____ T _____ R _____ COUNTY grenada

LOCATION DESCRIPTION :

CASING DIA : _____ PUMP TYPE & SIZE : _____

GPS FIELD LOCATION : LAT. 33.67855 LONG. -89.73953

GPS CORRECTED LOCATION : LAT. 33° 40' 43" LONG. 89 44' 22"

REMARKS : p00814 psd Sent to Wayne

alt. gps → 247'

MS-GW 14157
4144

Georgia Pacific

P000814
PSD

TopoZone.com

33-67855
89-73953

Target is 33° 40' 42"N, 89° 44' 25"W - **DUCK HILL** quad [Quad Info]

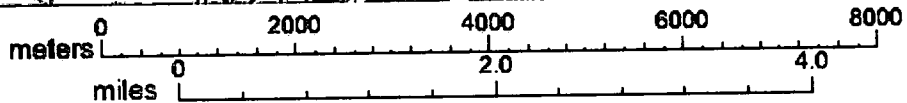
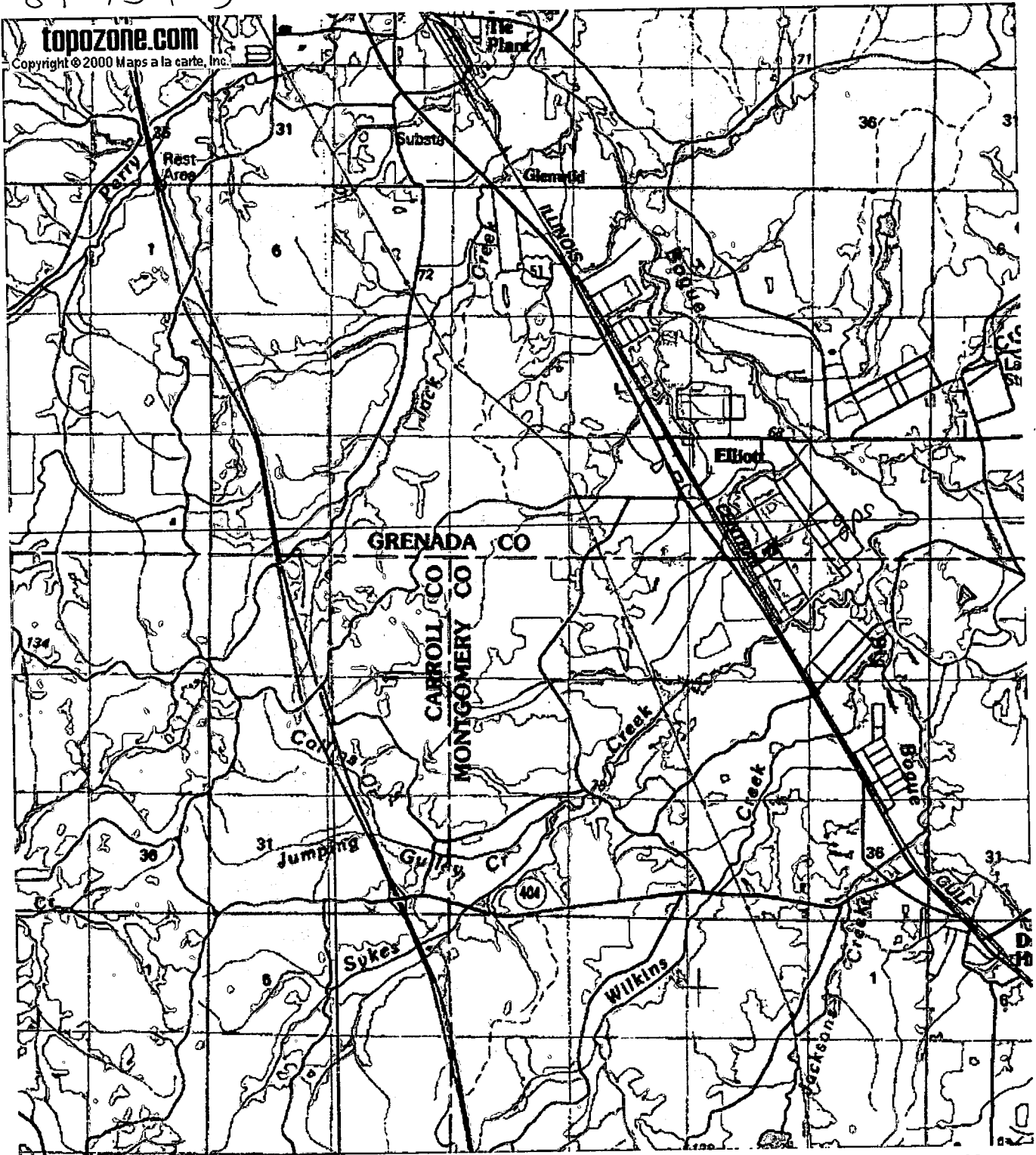

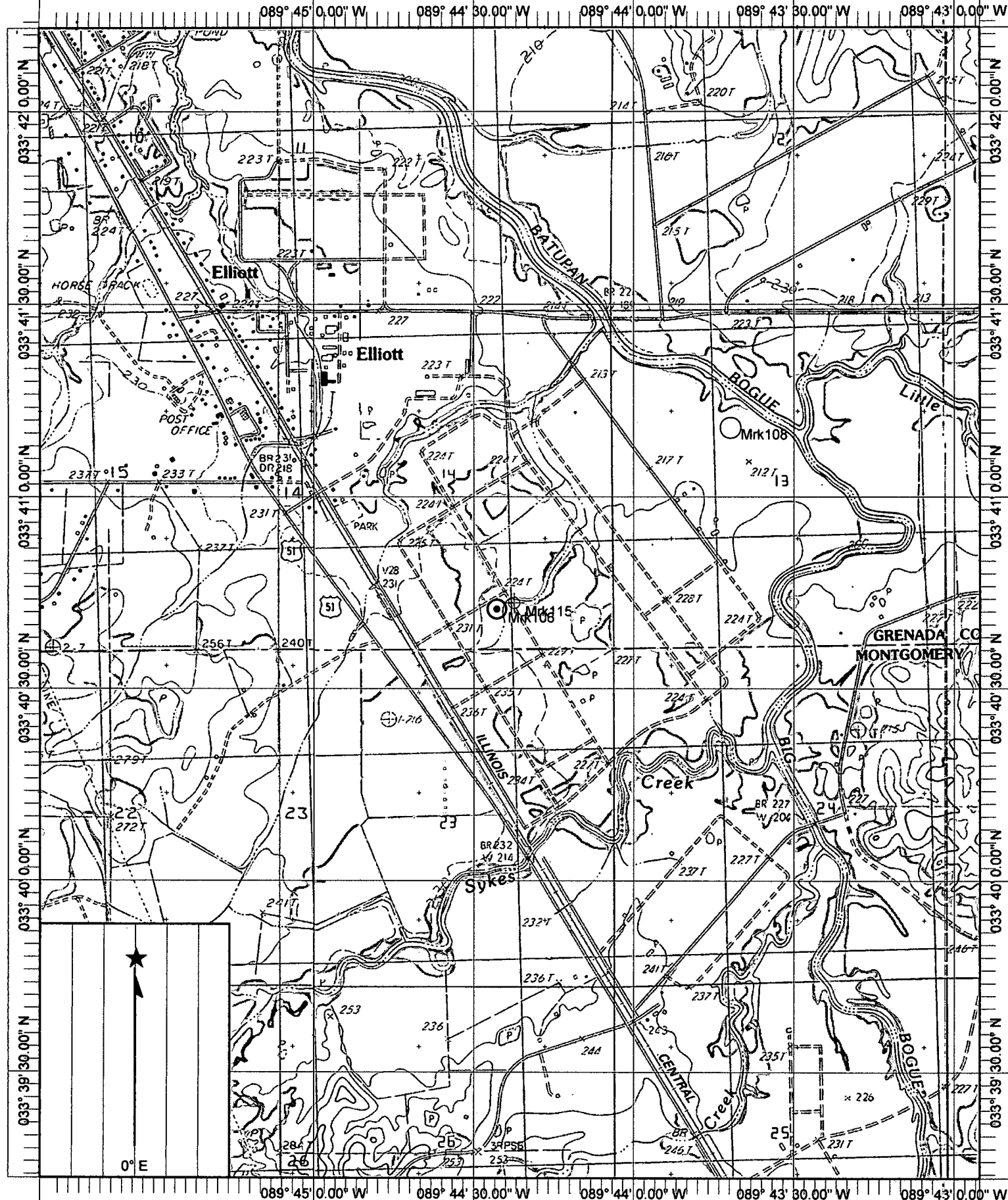

Name: DUCK HILL
 Date: 12/6/2002
 Scale: 1 inch equals 2000 feet

Location: 033° 40' 43.2" N 089° 44' 23.3" W

Markers

Name: Mrk106

Short Name: M00106

Coordinates: 033° 40' 42.2" N, 089° 44' 25.2" W

Name: Mrk108

Short Name: M00108

Coordinates: 033° 41' 10.9" N, 089° 43' 41.4" W

Name: Mrk115

Short Name: M00115

Coordinates: 033° 40' 43.2" N, 089° 44' 21.8" W

Comment: GEORGIA PACIFIC H144 MS-GW-14157 247 FT

can't be - must be 227'
pat

gaps 4 Fun.com



Target is 33° 40' 43"N, 89° 44' 22"W - DUCK HILL quad [Quad Info]

