

GW 5580
0220039-02

Tie Plant

Meas by SHB 5/17/74
PEL

FORM 9-1642
(1-68)

Well No. H82

WELL SCHEDULE

Elog # 64

U. S. DEPT. OF THE INTERIOR

GEOLOGICAL SURVEY

WATER RESOURCES DIVISION

PUNCHED

MASTER CARD

Record by WJO Source of data BOWC M3G3 Date 7/72 Map Tie Plant Qu AUG 2 1973

State MISS 2:8 County (or town) GRENADA 2:2

Latitude: 3 34 7 2 8 N Longitude: 0 8 9 4 5 3 9 Sequential number: 1

Lat-long accuracy: 2 21 0 5 0 10 10 15 19

Local well number: H 0 8 2 B A 1 0 2 1 N O S E Other number: Well # 2 North

Local use: 0 0 2 0 6 4 Owner or name: GRENADA C.P.W.A.

Ownership: County, Fed Gov't, City, Corp or Co, Private, State Agency, Water Dist N

Use of Air cond, Bottling, Comm, Dewater, Power, Fire, Dom, Irr, Med, Ind, P S, Rec, water: (S) (T) (U) (V) (W) (X) (Y) (Z) MU P

Use of (A) (D) (G) (H) (I) (J) (K) (L) (M) (N) (O) (P) (Q) (R) (S) (T) (U) (V) (W) (X) (Y) (Z) well: Anode, Drain, Seismic, Heat Res, Obs, Oil-gas, Recharge, Test, Unused, Withdraw, Waste, Destroyed. W

DATA AVAILABLE: Well data 70 Freq. W/L meas.: 71 Field aquifer char. 72

Hyd. lab. data: 73

Qual. water data; type: 74

Freq. sampling: 75 Pumpage inventory: yes no, period: 76

Aperture cards: 77

Log data: E log H' - 554' D.F. 78 79

WELL-DESCRIPTION CARD

SAME AS ON MASTER CARD Depth well: 19 ft 5 2 0 Meas. 24 3

Depth cased; (first perf.) 25 ft 4 8 0 Casing type: 26; Diam. 10 x 4 in 29 30

Finish: porous gravel w. gravel w. horiz. open (G) (H) (I) (J) (K) (L) (M) (N) (O) (P) (Q) (R) (S) (T) (U) (V) (W) (X) (Y) (Z) concrete, (perf.), (screen), gallery, end, perf., screen, sd. pt., shored, open hole, other 31 G

Method (A) (B) (C) (D) (E) (F) (G) (H) (I) (J) (K) (L) (M) (N) (O) (P) (Q) (R) (S) (T) (U) (V) (W) (X) (Y) (Z) Drilled: air bored, cable, dug, hyd jetted, air rot., percussion, rotary, reverse trenching, driven, drive wash, other 32 H

Date Drilled: 7-5-72 33 9 7 2 Pump intake setting: 34 ft 35 36

Driller: Robert Ratliff 37

Lift (type): (A) (B) (C) (D) (E) (F) (G) (H) (I) (J) (K) (L) (M) (N) (O) (P) (Q) (R) (S) (T) (U) (V) (W) (X) (Y) (Z) name (L) (M) address (type): air, bucket, cent, jet, multiple, multiple, none, piston, rot, submerg, turb, other T Deep Shallow 39 40

Power (type): diesel, elec, gas, gasoline, hand, gas, wind; H.P. 20 41 Trans. or meter no. 40

Descrip. MP 218 42 ft above below LSD, Alt. MP 43

Alt. LSD: 44 2 0 0 Accuracy: (source) topo 47 3

Water Level 48 ft above below MP; FE below LSD 49 4 9 Accuracy: 52 D

Date meas: 53 D 7 2 54 Yield: 55 1 5 0 Method determined 61

Drawdown: 62 ft 63 Accuracy: 64 Pumping period 65 hrs 66 67

QUALITY OF WATER DATA: Iron 68 ppm 69 Sulfate 70 ppm 71 Chloride 72 Hard. 73

Sp. Conduct K x 10 74 Temp. 75 °F 76 Date sampled 77 78

Taste, color, etc. 79

Well No.

Well No. _____

Latitude-longitude _____
d m s d m s

HYDROGEOLOGIC CARD

SAME AS ON MASTER CARD Province: 03 Section: _____

Drainage Basin: 156 Subbasin: _____

Topo of well site: (D) (C) (E) (F) (H) (K) (L) _____
(S) (P) (T) (U) (V) _____
depression, stream channel, dunes, flat, hilltop, sink, swamp,
offshore, pediment, hillside, terrace, undulating, valley flat

MAJOR Aquifer: _____ system _____ series TE _____ aquifer, formation, group WLCXM _____

Lithology: _____ Origin: _____ Aquifer Thickness: 50 ft

Length of well open to: 50 ft _____ Depth to top of: 470 ft _____

MINOR Aquifer: _____ system _____ series _____ aquifer, formation, group _____

Lithology: _____ Origin: _____ Aquifer Thickness: _____ ft

Length of well open to: _____ ft _____ Depth to top of: _____ ft _____

Intervals Screened: _____

Depth to consolidated rock: _____ ft _____ Source of data: _____

Depth to basement: _____ ft _____ Source of data: _____

Surficial material: _____ Infiltration characteristics: _____

Coefficient Trans: _____ gpd/ft _____ Coefficient Storage: _____

Coefficient Perm: _____ gpd/ft²; Spec cap: _____ gpm/ft; Number of geologic cards: _____

PH 8.2
Alk 211
CL 30
E2 < 0.1

2 1/2 m w 8.5 ft

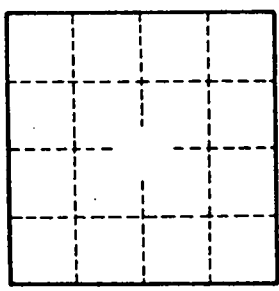

520
480

456' 10"
80' 4"
40' 40"

Well No. _____

1782
 GRENADA
 Flwg # 64

MISSISSIPPI
 BOARD OF WATER COMMISSIONERS
 416 North State Street
 Jackson, Mississippi 39201

WATER WELL DRILLERS LOG

12/29 1928 Robert E. Rattiff Co. Inc. GRENADA
 date well completed firm name county well located

LANDOWNER: <u>Elliott Water Assn.</u>	description of formations encountered	from	to
(mailing address)			
WELL LOCATION: sec. <u>10</u> T. <u>210</u> N. R. <u>5</u> W. <u>1</u> miles <u>NE</u> of <u>Elliott</u> (distance) (direction) (nearest town)	RED Sandy Clay	0	50
	CLAY	50	70
	FINE white SAND	70	110
	WHITE SAND	110	180
	CLAY	180	220
	GRAY CLAY	220	260
	CLAY	260	360
	CLAY with SAND SPEARS	360	460
	FINE white SAND	460	500
	CLAY	500	520
WELL PURPOSE: <u>Industrial</u> (home, irrigation, municipal, industrial)	SAND	520	558
WELL COMPLETION DATA: (1) diameter (inches) <u>10" x 4"</u> (2) total depth (feet) <u>520'</u> (3) static water level (feet) <u>49'</u> <u>below</u> top of ground. (4) casing <u>Black Steel</u> <u>456' 10"</u> (material) (depth) <u>10"</u> if telescope see back. (size) (5) screen <u>40'</u> <u>440'</u> <u>(480)</u> (length) (depth to top) <u>4"</u> <u>SSS</u> (size) (material) (6) pump <u>20</u> <u>150 GPM</u> (HP) (yield gpm) <u>electric</u> (type power) (7) electric log <u>YES</u> (yds or no) <u>MISS. GEO. SURVEY</u> (organization running log) (8) how well bottom plugged <u>back</u> <u>pressure valve</u>			
DRILLERS REMARKS:			

TETW

WILCOX DATA SHEET-VERIFICATION CHECKLIST

COUNTY GRENADA

Tic Plant Quad
U.S.G.S. E-log # 64

WELL OWNER Grenada Co. Water & Sewer Dist. (Well #2 - North) CHECKED
U.S.G.S. NO. H-82 9/21/94
B.O.H. NO 220039-02 9/21/94
OLWR NO. _____

LOCATION:

MAP SW, SW, NW, NE S10, T21N, R5E 9/21/94
GPS _____

ELEV. (MSL) 218' 9/21/94
W.L. (L.S.) (1) -78.05' 9/21/94
(2) -77.95' 9/21/94

HEAD (MSL) +140.05 9/21/94

SCREENED INTERVAL 480'-520' (Ls) / -262' - -302' (MSL) 9/21/94

AQUIFER VERIFIED Middle Wilcox 3/31/95

PREVIOUS W.L. -49' (1972) 9/21/94

DATA ENTERED _____

DEPARTMENT OF ENVIRONMENTAL QUALITY - OLWR
PUBLIC SUPPLY WELLS PROJECT

GPS LOG

USER NAME(S): Phillips/Hardin DATE: 10/22/97
UNIT DEQ #: _____ FILE #: B102220B
HEALTH DEPT. #: 220039-02 ELEV. 218
USGS #: H82 OLWR #: GW05580
OWNER: Grenada Water/Sewer QUAD: Tie Plant
LOCATION: NW/SE S 10 T 21N R 5E COUNTY: Grenada
LOCATION DESCRIPTION: On Alabama Ave off of Murff Dr.

CASING DIA: _____ PUMP TYPE & SIZE: Submersible
GPS FIELD LOCATION: LAT. 33°42'09.2"N LONG. 89°45'37.4"W
GPS CORRECTED LOCATION: LAT. 33.702958 LONG. 89.760098
REMARKS: Measured @ 10' from well

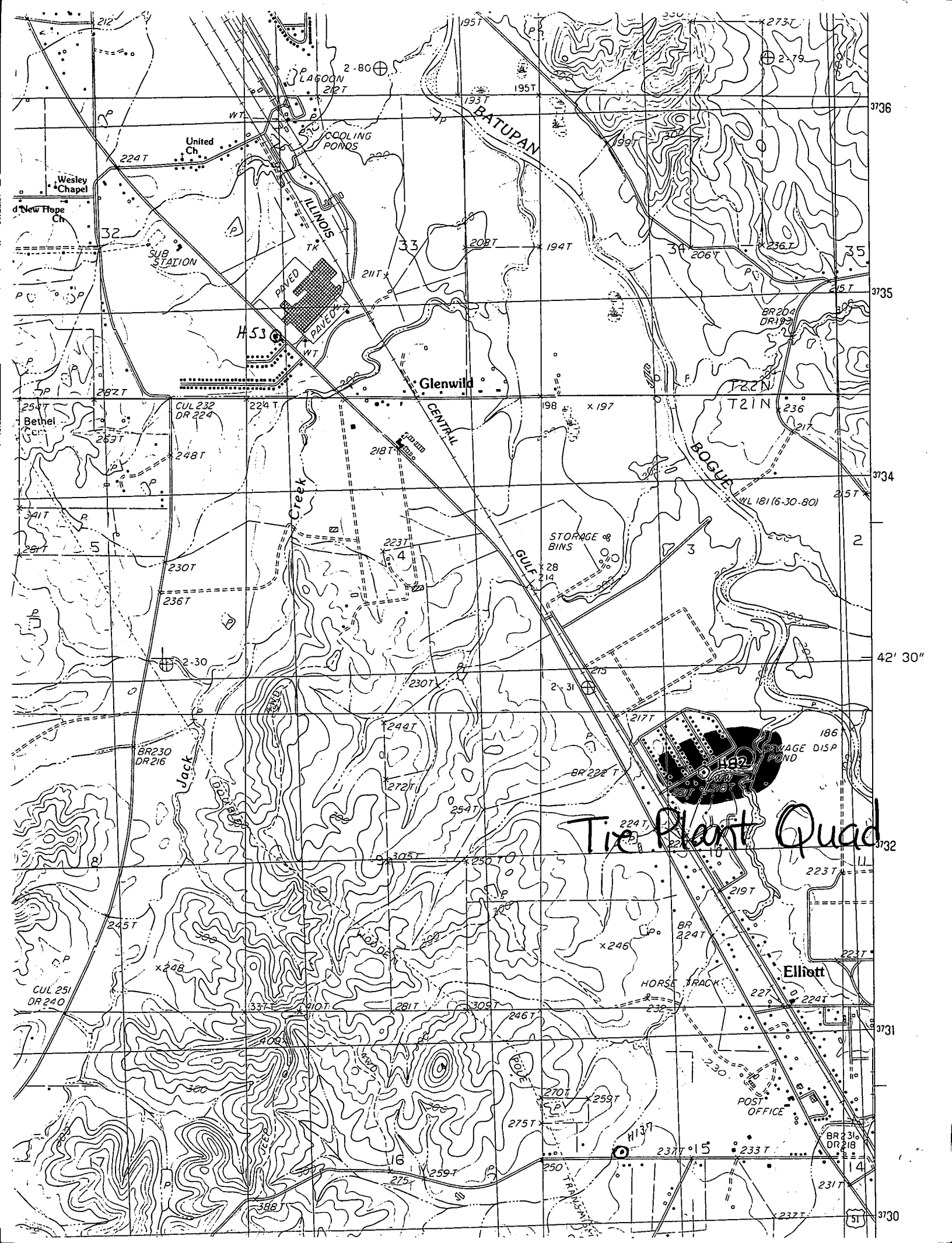

Tie Plant Quad