

WELL SCHEDULE

U. S. DEPT. OF THE INTERIOR GEOLOGICAL SURVEY WATER RESOURCES DIVISION

MASTER CARD

Record by RET Source of data USGS Files Date 10-21-70 Map \_\_\_\_\_

State 28 County (or town) 22

Latitude: 334400N Longitude: 0894700 Sequential number: 3

Lat-long accuracy: 3 T. N. E. S. R. W. Sec. k. t. k.

Local well number: H052003322NOSE Other number: \_\_\_\_\_ B & M

Local use: \_\_\_\_\_ Owner or name: \_\_\_\_\_

Owner or name: KOPPERS COMPANY Address: \_\_\_\_\_

Ownership: County, Fed Gov't, City, Corp or Co, Private, State Agency, Water Dist N

Use of water: (A) (B) (C) (D) (E) (F) (H) (I) (M) (N) (P) (R) U

Stock, Instit, Unused, Repressure, Recharge, Desal-P S, Desal-other, Other \_\_\_\_\_

Use of well: (A) (D) (G) (H) (I) (P) (R) (T) (U) (W) (X) (Z) U

Anode, Drain, Seismic, Heat Res, Obs, Oil-gas, Recharge, Test, Unused, Withdraw, Waste, Destroyed.

DATA AVAILABLE: Well data  Freq. W/L meas.:  Field aquifer char.

Hyd. lab. data: \_\_\_\_\_

Qual. water data; type: \_\_\_\_\_

Freq. sampling: \_\_\_\_\_ Pumpage inventory: yes  no  period: \_\_\_\_\_

Aperture cards: \_\_\_\_\_ yes  no

Log data: \_\_\_\_\_

WELL-DESCRIPTION CARD

SAME AS ON MASTER CARD Depth well: \_\_\_\_\_ ft 165 Meas. rept accuracy 6

Depth cased; (first perf.) \_\_\_\_\_ ft \_\_\_\_\_ Casing type: \_\_\_\_\_; Diam. \_\_\_\_\_ in 10

Finish: (C) porous concrete, (F) gravel w. (perf.), (G) gravel w. (screen), (H) horz. gallery, (I) open end, (P) perf., (S) screen, (T) sd. pt., (W) shored, (X) open hole, (Z) other 5

Method Drilled: (A) air rot., (B) bored, (C) cable, (D) dug, (H) hyd rot., (J) jetted, (P) air percussion, (R) reverse, (T) rotary, (U) trenching, (V) driven, (W) drive wash, (Z) other H

Date Drilled: 946 Pump intake setting: \_\_\_\_\_ ft \_\_\_\_\_

Driller: TO GIBBS name address

Lift (type): (A) air, (B) bucket, (C) cent., (J) jet, (L) multiple (cent.), (M) multiple (turb.), (N) none, (P) piston, (R) rot., (S) submerg, (T) turb., other 7 Deep  Shallow

Power (type): nat diesel, elec, gas, gasoline, hand, gas, wind; H.P. 15? LP 4 Trans. or meter no. \_\_\_\_\_

Descrip. MP \_\_\_\_\_ above ft below LSD, Alt. MP \_\_\_\_\_

Alt. LSD: \_\_\_\_\_ Accuracy: (source) \_\_\_\_\_ 4

Water Level: \_\_\_\_\_ ft above below MP; \_\_\_\_\_ ft above below LSD Accuracy: \_\_\_\_\_ 6

Date meas: \_\_\_\_\_ Yield: \_\_\_\_\_ gpm \_\_\_\_\_ Method determined \_\_\_\_\_

Drawdown: \_\_\_\_\_ ft \_\_\_\_\_ Accuracy: \_\_\_\_\_ Pumping period \_\_\_\_\_ hrs \_\_\_\_\_

QUALITY OF WATER DATA: Iron \_\_\_\_\_ Sulfate \_\_\_\_\_ Chloride \_\_\_\_\_ Hard. \_\_\_\_\_

Sp. Conduct \_\_\_\_\_ K x 10<sup>6</sup> \_\_\_\_\_ Temp. \_\_\_\_\_ °F \_\_\_\_\_ Date sampled \_\_\_\_\_ 960

Taste, color, etc. iron

PUNCHED and VERIFIED  
ROLLA COMPUTATION BRANCH

Well No.

H52

Well No. H 52

Latitude-longitude \_\_\_\_\_ N  
d m s S d m s

**HYDROGEOLOGIC CARD**

**SAME AS ON MASTER CARD** **Physiographic Province:** 03 Section: \_\_\_\_\_

**Drainage Basin:** D **Subbasin:** 156

**Topo of well site:** (D) depression, (C) stream channel, (E) dunes, (F) flat, (R) hilltop, (K) sink, (L) swamp, (O) offshore, (P) pediment, (S) hillside, (T) terrace, (U) undulating, (V) valley flat

**MAJOR AQUIFER:** system \_\_\_\_\_ series TE aquifer, formation, group M:W

**Lithology:** \_\_\_\_\_ **Origin:** 2 **Aquifer Thickness:** \_\_\_\_\_ ft

**Length of well open to:** \_\_\_\_\_ ft **Depth to top of:** \_\_\_\_\_ ft

**MINOR AQUIFER:** system \_\_\_\_\_ series \_\_\_\_\_ aquifer, formation, group \_\_\_\_\_

**Lithology:** \_\_\_\_\_ **Origin:** \_\_\_\_\_ **Aquifer Thickness:** \_\_\_\_\_ ft

**Length of well open to:** \_\_\_\_\_ ft **Depth to top of:** \_\_\_\_\_ ft

**Intervals Screened:** \_\_\_\_\_

**Depth to consolidated rock:** \_\_\_\_\_ ft **Source of data:** \_\_\_\_\_

**Depth to basement:** \_\_\_\_\_ ft **Source of data:** \_\_\_\_\_

**Surficial material:** \_\_\_\_\_ **Infiltration characteristics:** \_\_\_\_\_

**Coefficient Trans:** \_\_\_\_\_ gpd/ft **Coefficient Storage:** \_\_\_\_\_

**Coefficient Perm:** \_\_\_\_\_ gpd/ft<sup>2</sup>; **Spec cap:** \_\_\_\_\_ gpm/ft; **Number of geologic cards:** \_\_\_\_\_

Continuous operation for 12 hrs daily  
100,000 gal elev tank aerated

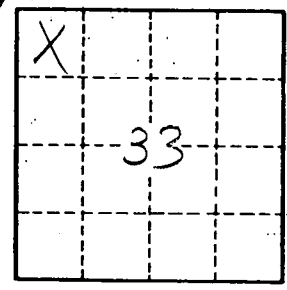
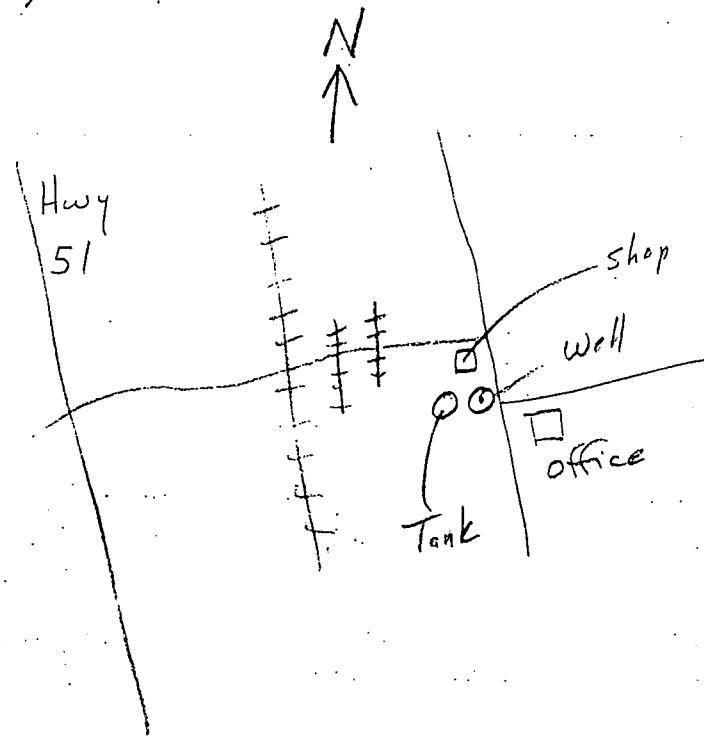

Well No. H 52