

Grenada Meas. by SHB/PEG  
5-18-94

about 2 1/2 mile from Grenada (SW)

FORM 9-1642  
(1-68)

Well No. G 23

### WELL SCHEDULE

U. S. DEPT. OF THE INTERIOR      GEOLOGICAL SURVEY      WATER RESOURCES DIVISION

**PUNCHED**

#### MASTER CARD

Record by JAC Source of data Luther Raliff Date 7/20/72 Map \_\_\_\_\_

State 28 County 22  
(or town)

Latitude: 33° 46' 00" N Longitude: 089° 50' 08" W Sequential number: 1

Lat-long accuracy: 4' T 22 S, R 4 E Sec 13 NE, SW, SW, SW

Local well number: G023CC1322NO4E Other number: \_\_\_\_\_

Local use: \_\_\_\_\_ Owner or name: Bogue Basin Wtr + Sew

Owner or name: JESSIE HAMBLY Address: Carrollton Rd

Mail Box #4574  
1/2 mile NE of I-55 on Carrollton Av

Ownership: County, Fed Gov't, City, Corp or Co, Private, State Agency, Water Dist P

Use of water: (A) Air cond, Bottling, Comm, Dewater, Power, Fire, Dom, Irr, Med, Ind, P S, Res, Stock, Instit, Unused, Repressure, Recharge, Desal-P S, Desal-other, Other P

Use of well: (A) Anode, Drain, Seismic, Heat Res, Obs, Oil-gas, Recharge, Test, Unused, Withdraw, Waste, Destroyed. W

DATA AVAILABLE: Well data  Freq. W/L meas.: 0 Field aquifer char:

Hyd. lab. data:

Qual. water data; type:

Freq. sampling:  Pumpage inventory:  no. period: \_\_\_\_\_

Aperture cards:  yes

Log data:

#### WELL-DESCRIPTION CARD

SAME AS ON MASTER CARD Depth well: 495 ft Meas. rept. accuracy 3

Depth cased: 20 (SS) ft 475 Casing type: \_\_\_\_\_; Diam. 4x2 in 4

Finish: (C) porous concrete, (F) gravel w. (perf.), (G) gravel w. (screen), (H) horiz. gallery, (I) open end, (J) other 5

Method Drilled: (A) air rot., (B) bored, (C) cable, (D) dug, (E) hyd rot., (F) jetted, (G) air percussion, (H) reverse, (I) rotary, (J) other H

Drilled: 965 Pump intake setting: 126 ft

Driller: Luther Raliff

Lift (type): (A) air, (B) bucket, (C) cent., (D) jet, (E) multiple, (F) multiple, (G) multiple, (H) none, (I) piston, (J) rot., (K) submers, (L) turb, (M) other S Deep  Shallow

Power (type): diesel, elec, gas, gasoline, hand, gas, wind; H.P. 2 Trans. or meter no. 7

Descrip. MP 225 above ft below LSD, Alt. MP \_\_\_\_\_

Alt. LSD: 300 Accuracy: 5

Water Level: \_\_\_\_\_ ft above MP; \_\_\_\_\_ ft below LSD Accuracy: 60

Date meas: 865 Yield: 25 gpm Method determined 61

Drawdown: \_\_\_\_\_ ft Accuracy: \_\_\_\_\_ Pumping period: \_\_\_\_\_ hrs 68

QUALITY OF WATER DATA: Iron \_\_\_\_\_ ppm Sulfate \_\_\_\_\_ ppm Chloride \_\_\_\_\_ ppm Hard. \_\_\_\_\_ ppm

Sp. Conduct \_\_\_\_\_ K x 10<sup>6</sup> Temp. \_\_\_\_\_ °F Date sampled \_\_\_\_\_

Taste, color, etc. \_\_\_\_\_

Well No. G 23

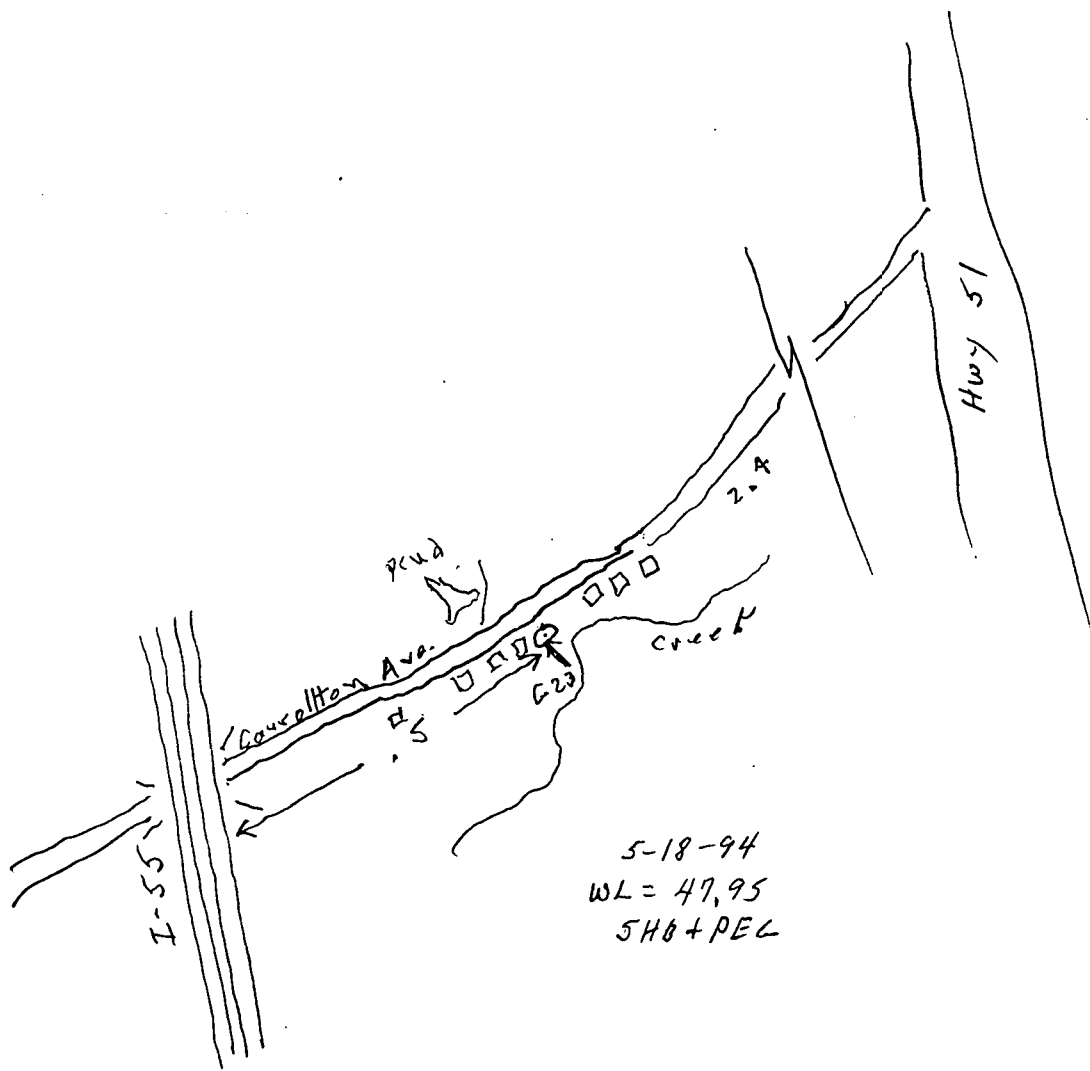

5-18-94  
WL = 47,95  
SHB + PEL

Latitude-longitude \_\_\_\_\_  
N  
S  
d m s d m s

HYDROGEOLOGIC CARD

SAME AS ON MASTER CARD Physiographic Province: \_\_\_\_\_ Section: \_\_\_\_\_

Drainage Basin: D 15G Subbasin: \_\_\_\_\_

Topo of well site: (C) (E) (F) (H) (K) (L) (M) (N) (P) (S) (T) (U) (V) \_\_\_\_\_  
depression, stream channel, dunes, flac, hilltop, sink, swamp, offshore, pediment, hillside, terrace, undulating, valley flac

MAJOR AQUIFER: \_\_\_\_\_ system \_\_\_\_\_ series TE \_\_\_\_\_ aquifer, formation, group TW

Lithology: \_\_\_\_\_ Origin: 2 Aquifer Thickness: \_\_\_\_\_ ft

Length of well open to: \_\_\_\_\_ ft 20 Depth to top of: \_\_\_\_\_ ft

MINOR AQUIFER: \_\_\_\_\_ system \_\_\_\_\_ series \_\_\_\_\_ aquifer, formation, group \_\_\_\_\_

Lithology: \_\_\_\_\_ Origin: \_\_\_\_\_ Aquifer Thickness: \_\_\_\_\_ ft

Length of well open to: \_\_\_\_\_ ft \_\_\_\_\_ Depth to top of: \_\_\_\_\_ ft

Intervals Screened: \_\_\_\_\_

Depth to consolidated rock: \_\_\_\_\_ ft \_\_\_\_\_ Source of data: \_\_\_\_\_

Depth to basement: \_\_\_\_\_ ft \_\_\_\_\_ Source of data: \_\_\_\_\_

Surficial material: \_\_\_\_\_ Infiltration characteristics: \_\_\_\_\_

Coefficient Trans: \_\_\_\_\_ gpd/ft \_\_\_\_\_ Coefficient Storage: \_\_\_\_\_

Coefficient Perm: \_\_\_\_\_ <sup>2</sup> spd/ft; Spec cap: \_\_\_\_\_ gpm/ft; Number of geologic cards: \_\_\_\_\_

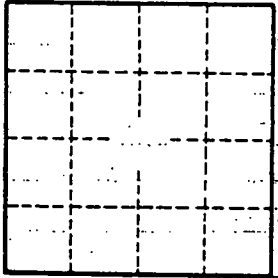

Well No. G 23

**Water Well Field Data Form**

*Tie Plate*

Well No. G 23 County Grenada

Date 5-18 1994 Party SHR + PFG

Elevation 220 GPS File No. A051822A

Health Department Tag No. none

Previous Water Level \_\_\_\_\_ Date \_\_\_\_\_

tape down no.	1	2	3	4
time	1730	1735		
held	55.00	65.00		
wet	6.55	16.55		
difference	48.45	48.45		
MP correction	0.50	0.50		
water level	47.95	47.95		
WL corr. to MSL				

Note: Provide sketch of location and/or Measuring Point on back if necessary.

Lat 33° 43.930  
 Long 89° 49.500

Well is located in front yard of house with  
P.O. Box #4576 Carrollton Ave. + 0.5 miles  
NW of I-55

*Well is in front yard.  
 any longer owned by family.  
 well is not used*

WILCOX DATA SHEET-VERIFICATION CHECKLIST

COUNTY GRENADA

Grenada Quad

WELL OWNER Jessie Hamby (Bogue Basin Water + Sewer) CHECKED  
U.S.G.S. NO. G-23 9/21/94  
B.O.H. NO None 9/21/94  
OLWR NO. \_\_\_\_\_

LOCATION:

MAP NW, SE, SW, SW S 13, T 22 N, R 4 E 3/15/95  
GPS  \_\_\_\_\_

ELEV. (MSL) 220' 3/15/95  
W.L. (L.S.) (1) - 47.95' 9/21/94  
(2) - 47.95' 9/21/94

HEAD (MSL) + 172.05' 9/21/94

SCREENED INTERVAL 475' - 495' (LS) / - 255' - - 275' (MSL) 3/15/95

AQUIFER VERIFIED Middle Wilcox 3/15/95

PREVIOUS W.L. - 60' (1965) 9/21/94

DATA ENTERED \_\_\_\_\_



) BY THE UNITED STATES GEOLOGICAL SURVEY  
 Y ..... USGS AND NOS/NOAA  
 FROM AERIAL PHOTOGRAPHS TAKEN ..... 1979  
 KED ..... 1982. MAP EDITED ..... 1983  
 ..... TRANSVERSE MERCATOR  
 METER UNIVERSAL TRANSVERSE MERCATOR ..... ZONE 16  
 FOOT STATE GRID TICKS ..... MISSISSIPPI, WEST ZONE  
 DECLINATION ..... 1°34' WEST  
 TIC NORTH DECLINATION ..... 3°00' EAST  
 ATUM ..... NATIONAL GEODETIC VERTICAL DATUM OF 1929  
 I. DATUM ..... 1927 NORTH AMERICAN DATUM

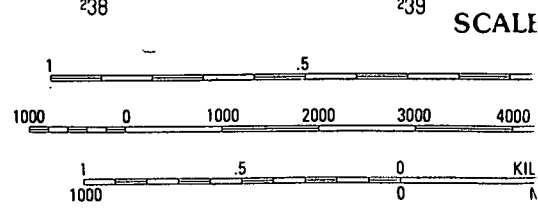
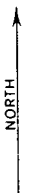

CONTOUR IN  
 SUPPLEMENTARY CO