

WELL SCHEDULE

U. S. DEPT. OF THE INTERIOR GEOLOGICAL SURVEY WATER RESOURCES DIVISION

3 mi W Grenada

MASTER CARD

Record by GJD Source of data Dr. Rpt. owner Date 5-26-71 Map _____

State 28 County (or town) Grenada 22

Latitude: 33⁴⁸ 47⁷ 15⁵ W^N Longitude: 08¹² 9¹⁵ 50¹⁸ 45¹⁹ Sequential number: 1

Lat-long accuracy: 2²⁰ T. 22²⁰ S. R. 4²⁰ W. Sec 11 SW SW NE

Local well number: 5018CA1122NO4E Other number: _____

Local use: 064³³ 571⁴⁰ 39⁵¹ Owner or name: H. W. Crawford

Owner or name: H. W. CRAWFORD Address: Grenada, Miss.

Ownership: County (C) Fed Gov't (F) City (M) Corp or Co (N) Private (P) State Agency (S) Water Dist (W) N

Use of water: (A) Air cond, (B) Bottling, (C) Comm, (D) Dewater, (E) Power, (F) Fire, (G) Dom, (H) Irr, (I) Med, (J) Ind, (K) P S, (L) Rec, (M) Stock, (N) Inatit, (O) Unused, (P) Repressure, (Q) Recharge, (R) Desal-P S, (S) Desal-other, (T) Other motel C

Use of well: (A) Anode, (B) Drain, (C) Seismic, (D) Heat Res, (E) Obs, (F) Oil-gas, (G) Recharge, (H) Test, (I) Unused, (J) Withdraw, (K) Waste, (L) Destroyed. W

DATA AVAILABLE: Well data Freq. W/L meas: Field aquifer char. Z

Hyd. lab. data: _____

Qual. water data; type: _____

Freq. sampling: _____ Pumpage inventory: yes no; period: _____

Aperture cards: _____

Log data: (E-log # 59 46' - 462' for well 619) D

WELL-DESCRIPTION CARD

SAME AS ON MASTER CARD Depth well: 455 ft Meas. rept accuracy 6

Depth cased: (first perf.) 415 ft Casing type: steel Diam. in 6

Finish: (C) porous concrete, (F) gravel w. (perf.), (G) gravel v. (screen), (H) horiz. gallery, (I) open end, (J) screen, (K) sd. pt., (L) shored, (M) open hole, (N) other S

Method: (A) air bored, (B) cable, (C) dug, (D) hyd jetted, (E) air rot., (F) percussion, (G) rotary, (H) reverse, (I) trenching, (J) driven, (K) wash, (L) other H

Date Drilled: 571 Pump intake setting: _____ ft

Driller: Singer-Lane Central address Cleveland

Lift (type): (A) air, (B) bucket, (C) cent, (D) jet, (E) multiple, (F) multiple, (G) none, (H) piston, (I) rot, (J) submerg, (K) turb, (L) other T Deep 40 Shallow _____

Power (type): (A) diesel, (B) elec, (C) gas, (D) gasoline, (E) hand, (F) gas, (G) wind, (H) H.P. Trans. or meter no. _____

Descrip. MP Top of Casina 2.8' ft above/below LSD, Alt. MP _____

Alt. LSD: 285 Accuracy: (source) 5

Water Level 116.56 ft above/below MP; Ft below LSD 114 Accuracy: _____

Date meas: 5-27-71 571 Yield: _____ gpm 44 Method determined 1

Drawdown: _____ ft 11 Accuracy: 0 Pumping period 1 1/2 hrs 2

QUALITY OF WATER DATA: Iron _____ ppm Sulfate _____ ppm Chloride _____ ppm Hard. _____ ppm

Sp. Conduct 105 K x 10 1 Temp. 19.0 Date sampled 571

Taste, color, etc. Clear

PUNCHED and VERIFIED
ROLLA COMPUTATION BRANCH

Well No. 618

Well No. G18

Latitude-longitude N
S
d m s d m s

HYDROGEOLOGIC CARD

Physiographic
 Province: 03 Section: _____
 Drainage Basin: D 156 Subbasin: _____
 Topo of well site: (D) depression, stream channel, dunes, flat, hilltop, sink, swamp, (E) offshore, pediment, hillside, terrace, undulating, valley flat. H
 MAJOR AQUIFER: system _____ series TE aquifer, formation, group MW
 Lithology: _____ Origin: 2 Aquifer Thickness: _____ ft
 Length of well open to: 55 ft Depth to top of: 40 ft 400 ft
 MINOR AQUIFER: system _____ series _____ aquifer, formation, group _____
 Lithology: _____ Origin: _____ Aquifer Thickness: _____ ft
 Length of well open to: 50 ft Depth to top of: _____ ft
 Intervals Screened: 415' - 455' = 40' of SS screen; 0.10" perf.
 Depth to consolidated rock: _____ ft Source of data: _____
 Depth to basement: _____ ft Source of data: _____
 Surficial material: _____ Infiltration characteristics: _____
 Coefficient Trans: 203 gpd/ft Coefficient Storage: _____
 Perm: 360 gpd/ft²; Spec cap: 3.8 gpm/ft; Number of geologic cards: _____

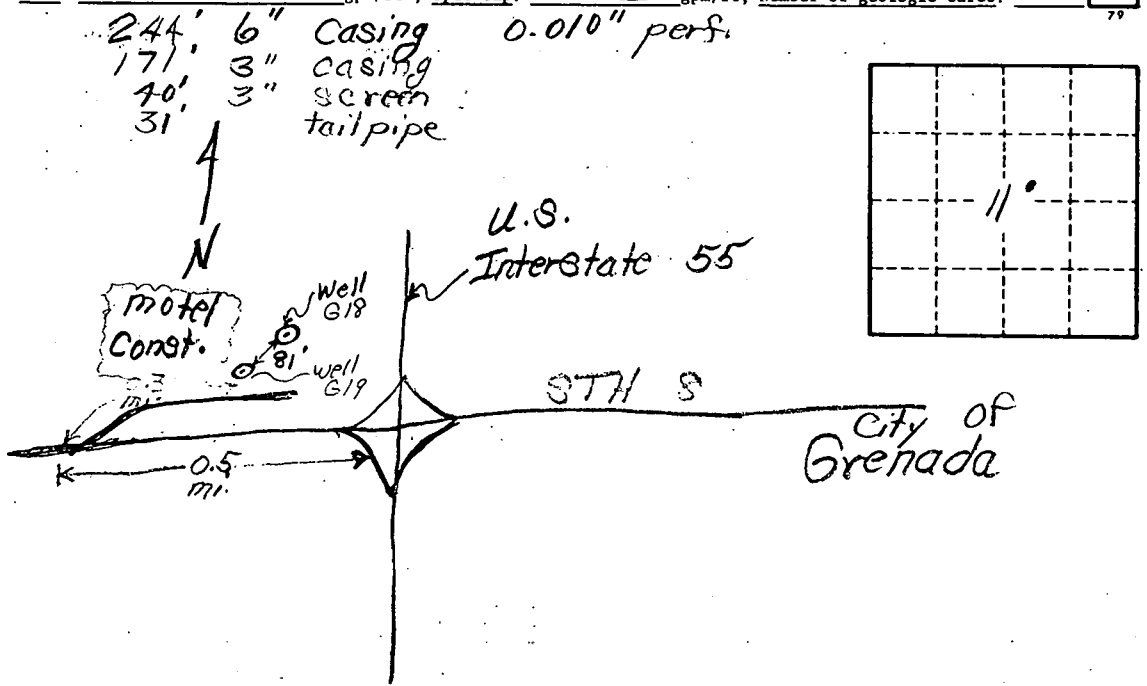

Well No. G18