



file

WELL SCHEDULE

E-log # 37  
WATER RESOURCES DIVISION

U. S. DEPT. OF THE INTERIOR GEOLOGICAL SURVEY

MASTER CARD

Record by CJ Source of data MGS Date 5/70 Map \_\_\_\_\_

State 28 County (or town) Grenada 27

Latitude: 33° 51' 45" N Longitude: 08° 9' 50" W Sequential number: 1

Lat-long accuracy: 3 T. 23 S. R. 4 W. Sec. 14 SW. SW. NE

Local well number: A001CD1423NO4E Other number: \_\_\_\_\_

Local use: 037037 Owner or name: \_\_\_\_\_

Owner or name: SUNRAY OIL CO Address: \_\_\_\_\_

Ownership: County, Fed Gov't, City, Corp or Co, Private, State Agency, Water Dist N

Use of Air cond, Bottling, Comm, Dewater, Power, Fire, Dom, Irr, Med, Ind, P S, Rec, water: \_\_\_\_\_

Use of well: Anode, Drain, Seismic, Heat Res, Obs, Oil-gas, Recharge, Test, Unused, Withdraw, Waste, Destroyed. W

DATA AVAILABLE: Well data  Freq. W/L meas.: N 1 Field aquifer char.

Hyd. lab. data: \_\_\_\_\_

Qual. water data; type: \_\_\_\_\_

Freq. sampling: \_\_\_\_\_ Pumpage inventory: \_\_\_\_\_

Aperture cards: \_\_\_\_\_

Log data: E-log + 798' DE

WELL-DESCRIPTION CARD

TD-809'

SAME AS ON MASTER CARD Depth well: 30' Meas. rept 779 accuracy 3

Depth cased; (first perf.) \_\_\_\_\_ ft 769 Casing type: \_\_\_\_\_; Diam. 4x2 in 4

Finish: porous concrete, gravel w. (perf.), gravel w. (screen), horiz. gallery, open end, perf., screen, sd. pt., shored, open hole, other S

Method Drilled: (A) bored, (B) cable, (C) dug, (D) air jetted, (H) air percussion, (J) rotary, (P) reverse, (R) trenching, (T) driven, (V) drive wash, (W) other H

Date Drilled: 7-30-65 965 Pump intake setting: \_\_\_\_\_ ft \_\_\_\_\_

Driller: Delta Drilling Co.

Lift (type): (A) air, (B) bucket, (C) cent, (J) jet, (L) multiple, (M) multiple, (N) none, (P) piston, (R) rot, (S) submerg, (T) turb, other \_\_\_\_\_ Deep \_\_\_\_\_ Shallow \_\_\_\_\_

Power (type): (nat) diesel, elec, gas, gasoline, hand, gas, wind; H.P. \_\_\_\_\_ Trans. or meter no. \_\_\_\_\_

Descrip. MP 250 BS 1979 ft above below LSD, Alt. MP \_\_\_\_\_

Alt. LSD: 260 260 Accuracy: Topo 4

Water Level \_\_\_\_\_ ft above below MP; \_\_\_\_\_ ft below LSD Accuracy: \_\_\_\_\_

Date meas: \_\_\_\_\_ Yield: \_\_\_\_\_ gpm Method determined \_\_\_\_\_

Drawdown: \_\_\_\_\_ ft Accuracy: \_\_\_\_\_ Pumping period \_\_\_\_\_ hrs \_\_\_\_\_

QUALITY OF WATER DATA: Iron \_\_\_\_\_ ppm Sulfate \_\_\_\_\_ ppm Chloride \_\_\_\_\_ ppm Hard. \_\_\_\_\_ ppm

Sp. Conduct \_\_\_\_\_ K x 10<sup>6</sup> Temp. \_\_\_\_\_ °F Date sampled \_\_\_\_\_

Taste, color, etc. \_\_\_\_\_

Well respaced by A15. probably hole in casing.

11/6/79  
43.04  
no .3  
42.74

ROLLA COMPUTATION BRANCH

Well No.

H

Well No. A 1

Latitude-longitude N  
S  
d m s d m s

**HYDROGEOLOGIC CARD**

SAME AS ON MASTER CARD Physiographic Province: 03 Section: \_\_\_\_\_

D Drainage Basin: 156 Subbasin: \_\_\_\_\_

Topo of well site: (D) depression, stream channel, dunes, flat, hilltop, sink, swamp, (E) offshore, pediment, hillside, terrace, undulating, valley flat (F) (G) (H) (I) (J) (K) (L) (M) (N) (O) (P) (Q) (R) (S) (T) (U) (V) \_\_\_\_\_

MAJOR AQUIFER: system \_\_\_\_\_ series TE aquifer, formation, group LW

Lithology: S Origin: 2 Aquifer Thickness: ± ft

32 Length of well open to: \_\_\_\_\_ ft 10 Depth to top of: \_\_\_\_\_ ft 766

MINOR AQUIFER: system \_\_\_\_\_ series \_\_\_\_\_ aquifer, formation, group \_\_\_\_\_

Lithology: \_\_\_\_\_ Origin: \_\_\_\_\_ Aquifer Thickness: \_\_\_\_\_ ft

32 Length of well open to: \_\_\_\_\_ ft \_\_\_\_\_ Depth to top of: \_\_\_\_\_ ft \_\_\_\_\_

Intervals Screened: 799-809 A

Depth to consolidated rock: \_\_\_\_\_ ft \_\_\_\_\_ Source of data: \_\_\_\_\_

Depth to basement: \_\_\_\_\_ ft \_\_\_\_\_ Source of data: \_\_\_\_\_

Surficial material: \_\_\_\_\_ Infiltration characteristics: \_\_\_\_\_

Coefficient Trans: \_\_\_\_\_ gpd/ft \_\_\_\_\_ Coefficient Storage: \_\_\_\_\_

Coefficient Perm: \_\_\_\_\_ gpd/ft<sup>2</sup>; Spec cap: \_\_\_\_\_ gpm/ft; Number of geologic cards: \_\_\_\_\_

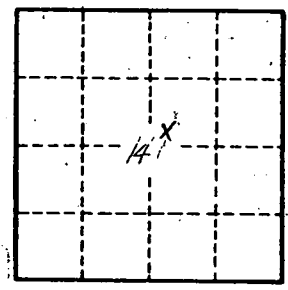
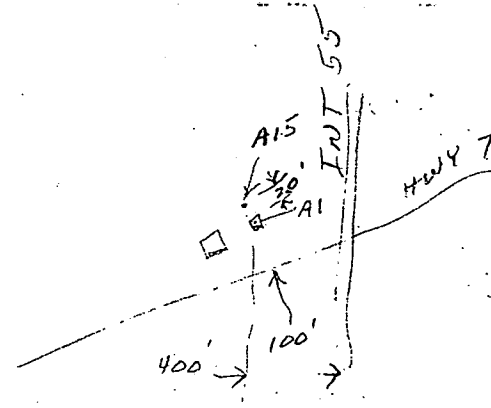

Well No. A 1