

U.S. GEOLOGICAL SURVEY
WATER RESOURCES DIVISION
MISSISSIPPI DISTRICT
WELL RECORD

TRANSMITTED FOR ADP.
1/77

(V)

Record by WTO Date 2/76 County Greene Well No. R20
McLain Quad E-log No. 112

GEN. SITE DATA

Site ID

3	1	0	1	5	1	0	8	8	4	7	3	9	0	1
---	---	---	---	---	---	---	---	---	---	---	---	---	---	---

 R= 0 T= (A) M 2= (W) *

Data reliab. 3= (C) U * Report. agency 4= U S G S * Dist. 6= 2 8 * 7= 2 8 *

County 8= 0 4 1 * Lat/Long. 9= 3 1 0 1 5 1 * 10= 0 8 8 4 7 3 9 *

Well No. 12= R 0 2 0 * Loc 13= N W S E S 2 1 * T O I N R 0 8 W *

Alt. 16= 9 5 * Hyd. Unit (OWDC) 20= OK *

Date 21= 1 0 / 2 9 / 1 9 7 5 * Well use 23= W * Water use 24= P *

Hole depth 27= 9 1 6 * Well depth 28= 3 3 8 *

WL 30= 1 7 * Date 31= 0 2 / 0 9 / 1 9 7 6 * Source 33= (D) *

OWNER

R = 158 * T= (A) M * Date 159# 0 2 / 0 9 / 1 9 7 6 * Owner No. _____

Owner 161= L E A F W A _____ *

FIELD QW

R = 192 * T= (A) M * Date 193# 0 2 / 0 9 / 1 9 7 6 * Additional cards same R thru 193 for each parameter.

Temp. 196# 0 0 0 1 0 * °C 197= 2 1 . 0 *

Cond. 196# 0 0 0 9 5 * uMhos 197= 5 8 0 . *

pH 196# 0 0 4 0 0 * Value 197= 8 . 6 *

CONSTR.

R = 58 * T= (A) M * 59# 1 * Date 60= 1 0 / 2 9 / 1 9 7 5 *

Drlr 63= 3 5 9 * Name: Lumpkin * Method 65= _____ *

Finish 66= S * Remarks _____

CASING

R = 76 * T= (A) M * 59# 1 *

Top csng 77# - 0 * Bot. csng 78= 2 7 0 . * Diam. 79# 8 . *

R = 76 * T= (A) M * 59# 1 *

Top csng 77# 2 9 0 . * Bot. csng 78= 3 3 2 . * Diam. 79# 2 . 5 *

OPENINGS

R = <u>82</u> * T= <u>(A) M</u> * 59# <u>1</u> *	R = <u>82</u> * T= <u>(A) M</u> * 59# <u>1</u> *
Top 83# <u>2 7 0 .</u> *	83# <u>3 3 2 .</u> *
Bot. 84= <u>2 9 0 .</u> *	84= <u>3 3 8 .</u> *
Type 85= <u>R</u> *	85= <u>R</u> *
Diam. 87= <u>4 .</u> *	87= <u>2 . 5</u> *
Size 88= _____ *	88= _____ *

YIELD

R = 134 (146) * T= (A) M * 147# 1 * Q 150= 8 5 . * Q/s 272= _____ *

LIFT

R= 42 * T= (A) M * Lift type 43# S * Intake 44= [] [] [] * Power type 45= E *
 Date 38= 02/09/1976 * H.P. 46= [] [10] [] *

LOGS

R= 198 * T= (A) M * Log 199# D * Top 200= [] [] [] [0] [] * Bot. 201= [] [290] [] [] *
 R= 198 * T= (A) M * Log 199# E * Top 200= [] [] [78] [] * Bot. 201= [] [] [916] [] *
 R= 189 * T= (A) * 190# 112 * 191= M I S S D I S T *

ANAL.

R= 114 * T= (A) M * Year 115# 1976 * Type 120= B *

AQUIFERS

R= 90 * T= (A) M * 256# 1 * Top 91= [] [270] [] * Bot. 92= [] [340] [] *
 Unit ID 93= 122 MOC N X Name of unit HBRG on permit
 R= 90 * T= A M * 256# * Top 91= [] [] [] [] * Bot. 92= [] [] [] [] *
 Unit ID 93= [] [] [] [] [] [] Name of unit [] [] [] [] [] []

HYDRAULICS

R= 98 * T= A M * 99# 1 * Unit tested 100= [] [] [] [] [] [] [] [] [] [] *
 R= 105 * T= A M * 99# 1 Test No. 106# *
 Transmissivity 107= [] [] [] [] [] [] * T(gal/d)/ft
 Hydraul. conduct. 108= [] [] [] [] [] [] * P(gal/d)/ft²
 Storage coeff. 110= [] [] [] [] [] [] * Boundaries

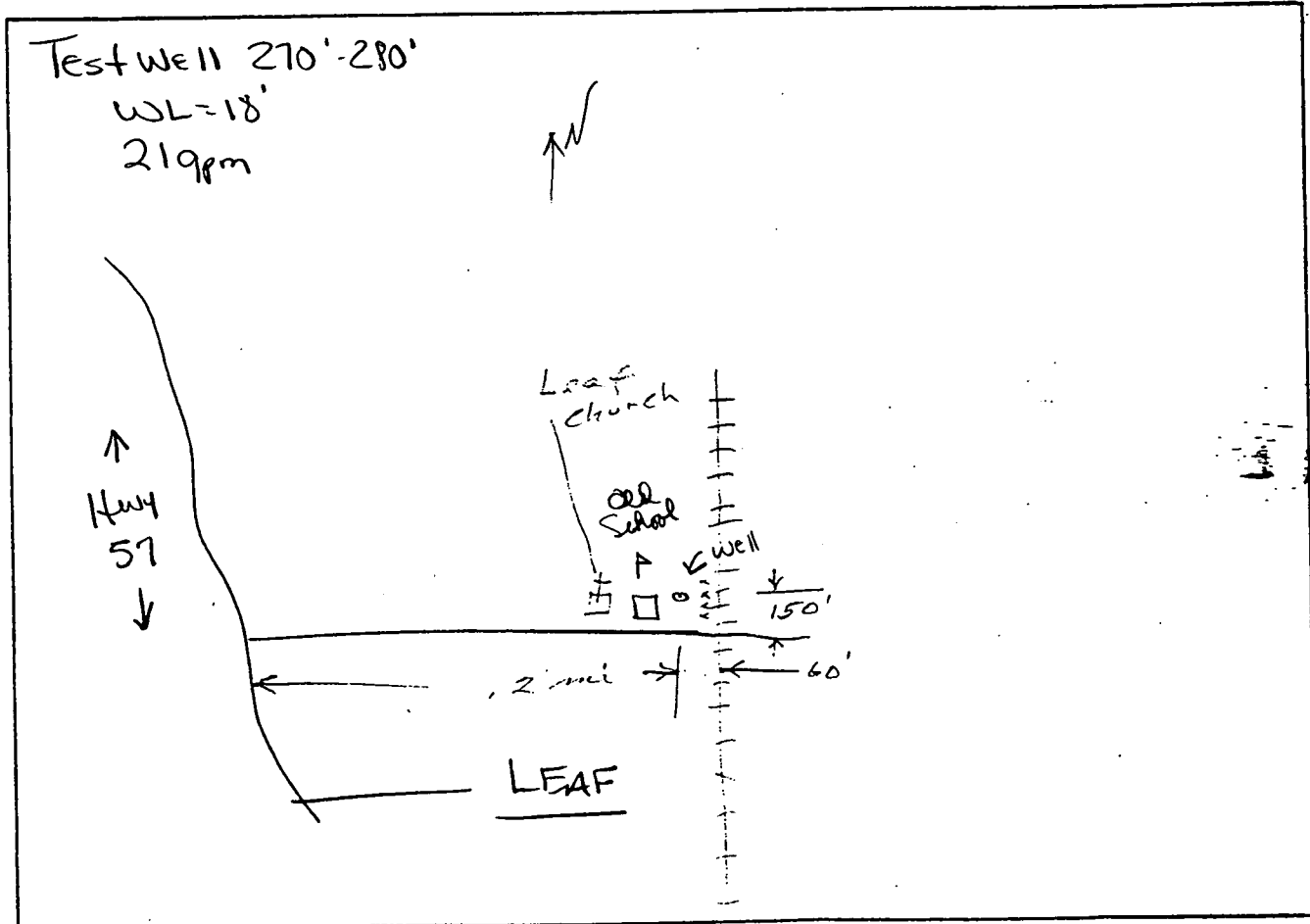

**APPLICATION FOR PERMIT TO DIVERT OR WITHDRAW
FOR BENEFICIAL USE THE PUBLIC WATERS OF THE STATE OF MISSISSIPPI**

DEPARTMENT OF ENVIRONMENTAL QUALITY, OFFICE OF LAND AND WATER RESOURCES
P.O. BOX 10631, JACKSON, MS 39289-0631; (601) 961-5202

This box is for office use only. 4-9-96 AGN. FORM OLWR-AP-2 (REV. 9/94)

Issued: <u>3-11-86</u>	Expires: <u>3-11-2006</u>	Fee Paid: <u>7</u>	Permit No.
Lat. <u>310132</u>	Long. <u>884746</u>	Elev. <u>97</u>	USGS No. <u>R20</u>
Quad. <u>MCLAIN</u>	ASCS Farm No.	STAC.	MSDOH No.
Aquifer: <u>ABRG</u>	Tract No.		Basin No. <u>03170005</u>
Remarks:			Dam Inv. No.

THIS APPLICATION IS FOR (Circle one): NEW PERMIT RENEWAL PERMIT NO. MS-GW-01768

THIS APPLICATION IS FOR (Circle one): GROUNDWATER COMPLETE A,B,E
 SURFACE WATER - COMPLETE A,C,D,E

BENEFICIAL USE (Circle one or more): 1) Public Supply - Municipal, Rural Water, or Private Water 2) Irrigation
3) Industrial 4) Fish Culture 5) Recreation 6) Institutional (eg. Church, School) 7) Commercial (eg. Hotel, Casino, Restaurant) 8) Fire Protection 9) Livestock 10) Flood Protection 11) Other: _____

SECTION A (to be completed by ALL APPLICANTS)

LANDOWNER: LEAF WATER ASS. 64-0690242
(Name) (SSN or Tax ID No.)
Box B-10
(Address)
LEAF MCLAIN, MS. 39456 (601) _____
(City) (State & Zip) (Telephone No.)

APPLICANT, AGENT, OR LESSEE (if different from Landowner):

NO MAP

(Name) _____ (SSN or Tax ID No.) _____
(Address) _____
(City) _____ (State & Zip) _____ (Telephone) _____

*Location of diversion/withdrawal point (A suitable map with location marked must accompany this application):
SW 1/4 of the SE 1/4 of Section 21, Township 1N, Range 8W, County GREENE

Does the land to which this application pertains have any source(s) of water other than that for which you are now applying (circle one)? YES NO If yes, describe the nature and amount of any additional supply and, if applicable, list permit number. _____

SECTION B (to be completed for GROUNDWATER SOURCE)

- AQUIFER: MCGN ABRG MISSISSIPPI DEPARTMENT OF HEALTH NO.: HD 210006-01 #
- Proposed work will begin on _____, 19____, and will be completed by _____, 19____.
If well has already been drilled, when was well completed (date)? 11 0, 1975. Under whose name was well originally drilled (if known)? LEAF WATER ASS.
- Description of proposed or completed well:
 - DEPTH OF WELL: 320 feet. DRILLER: OUT OF BUSINESS
 - SURFACE CASING: Length 20 feet; Diameter 8 inches; Type BLACK IRON
 - SCREEN: Length 20 feet; Diameter 4 inches; Type BAR & WELD
 - PUMP: Type SUBMERSIBLE size 10 HP; Capacity 85 gallons per minute; Setting depth 270 feet
 - POWER UNIT: Type N/A; Size N/A horsepower
- PERMITTED VOLUME:
 - _____ acre-feet per year at a maximum rate of _____ gallons per minute
 - 0.04 million gallons per day at a maximum rate of 85 gallons per minute

(CONTINUED ON BACK)

807

85

SECTION C (to be completed for SURFACE WATER SOURCE)

1. Source of water is from N/A which drains into _____
 which drains into _____
 (major stream or river)
2. Description of pump/diversion works:
 Pump (size & type): _____ Power Unit (size & type): _____
 Lift: _____ feet Maximum capacity: _____ gallons per minute
3. _____ acre-feet per year at a maximum rate of _____ gallons per minute

SECTION D (to be completed for SURFACE WATER IMPOUNDMENTS (DAMS) on continuously flowing streams)

1. Name of storage reservoir: N/A Dam Height: _____ feet
2. Surface area at normal pool: _____ Storage capacity at normal pool: _____ acre-feet

SECTION E WATER USE DATA (ALL APPLICATIONS - complete section related to beneficial use)

1. **IRRIGATION:** List the number of acres of each crop to be irrigated: Rice _____; Cotton _____; Oats _____;
 Corn _____; Soybeans _____; Pasture _____; Truck _____; Wheat _____; Grain Sorghum _____;
 Other (specify) _____ Acres _____
- A. Method of Irrigation (circle one) - Center Pivot Flood Furrow
 B. Land Condition (circle one) - Precision Land Formed Smoothed
 C. ASCS Farm No. _____ Tract No. _____
2. **FISH CULTURE:** Explain how water will be used: _____
 How often will reservoir (s) be emptied and refilled? _____
3. **MUNICIPAL, WATER ASSOCIATION, or PRIVATE WATER SYSTEM**
 Chose "a" or "b". (a) The number of people served is 356 or (b) The number of connections is 147
 What is the estimated average daily consumption during periods of maximum use at the end of each five-year period during the
 next twenty (20) years? 17,150 2000 17,850 2005 18,100 2010 18,500 2015
 (Volume) (Year) (Volume) (Year) (Volume) (Year) (Volume) (Year)
4. **INDUSTRIAL:** If the water is to be released into a watercourse, indicate the amount released each year N/A;
 Rate of release _____; NPDES Permit No. _____
 Explain any changes in quality of water to be released: _____
 Explain how water will be used: _____
 How much groundwater will be used for once-through non-contact cooling? _____
5. **RECREATION:** Explain how water will be used: NA
6. **OTHER USE:** Explain in detail (if needed, attach another page): _____
7. **REMARKS:** _____

List below the person to be contacted for additional information if required.

Richard P. Daughdrill
 (Name)
Box 7B
 (Address)
McLean MS 39456
 (City, State, Zip)
(601) 753-2553
 (Telephone)

The accompanying map is hereby declared a part of this application. For irrigation and fish culture use, an ASCS photograph is required. The TEN DOLLAR (\$10.00) permit fee is enclosed herewith.

(Signature)

Subscribed and sworn to before me this _____ day of _____, 19____, at _____ County of _____

My commission expires _____; _____ Notary Public.

GREENE
R20

11-28-76
Ref E Log #112

MISSISSIPPI
BOARD OF WATER COMMISSIONERS
416 North State Street
Jackson, Mississippi 39201

CODED

Nov 28 1976 date well completed
Lumpkin Well Dr. Co. firm name
Deer county well located

LANDOWNER:	description of formations encountered	from	to
Lump Water Ass.			
Leaf. Miss. (mailing address)	Clay	0	18
	Sand	18	68
	Clay	68	148
	Sand	147	160
	Clay	160	220
	Sand	220	290
WELL LOCATION: sec. 21 T 1 N R 8 E S 8 W 6 miles S of Yonkers (distance) (direction) (nearest town)			
WELL PURPOSE: Domestic (home, irrigation, municipal, industrial)			
WELL COMPLETION DATA:			
(1) diameter (inches) 8"			
(2) total depth (feet) 290'			
(3) static water level (feet) 15' below top of ground.			
(4) casing Blue Pipe, 270' (material) (depth)			
8" If telescope see back. (size)			
(5) screen 20' 220' (length) (depth to top)			
4" Stainless Steel (size) (material)			
(6) pump 10 8.5 (HP) (yield gpm)			
Che. (type power)			
(7) electric log No. (yes or no)			
No. (organization running log)			
(8) how well bottom plugged Base checked			
DRILLERS REMARKS:			

GREENE
R20
10/27/75
Eng #112

MISSISSIPPI
 BOARD OF WATER COMMISSIONERS CODED
 416 North State Street
 Jackson, Mississippi 39201

WATER WELL DRILLERS LOG

Oct-27 1975 Temple Well Co. L. Green
 date well completed firm name county well located

LANDOWNER:	description of formations encountered	from	to
Leaf Water Assoc.			
<u>Leaf, Miss.</u>	Clay	0	18
<u>TEST WELL</u> (mailing address)	Sand	18	68
WELL LOCATION:	Clay	68	147
sec. <u>21</u> T. <u>1</u> N. R. <u>5</u> E.	Sand	147	160
<u>6</u> miles <u>S.</u> of <u>McLean</u>	Clay	160	270
(distance) (direction) (nearest town)	Sand	270	285
WELL PURPOSE: <u>Municipal</u>	Clay	285	310
(home, irrigation, municipal, industrial)	Fine Sand	310	330
WELL COMPLETION DATA:	Sand	330	345
(1) diameter (inches) <u>4" x 2"</u>	Clay	345	390
(2) total depth (feet) <u>106' 4" - 200' 2"</u>	Fine Sand	390	480
(3) static water level (feet) <u>13'</u> below above top of ground.	Clay	480	690
(4) casing <u>Gal.</u> <u>270'</u>	COBECK	690	927
(material) (depth)			
<u>4" x 2"</u> If telescope see back.			
(size)			
(5) screen <u>10'</u> <u>270'</u>			
(length) (depth to top)			
<u>2"</u> <u>Slender Steel</u>			
(size) (material)			
(6) pump <u>3/4</u> <u>21</u>			
(HP) (yield gpm)			
<u>Electric</u>			
(type power)			
(7) electric log <u>Yes.</u>			
(yes or no)			
<u>No.</u>			
(organization running log)			
(8) how well bottom plugged <u>Sand. Shale</u>			
DRILLERS REMARKS:			

DEPARTMENT OF ENVIRONMENTAL QUALITY - OLWR
PUBLIC SUPPLY WELLS PROJECT

GPS LOG

USER NAME(S): SHB:shop DATE: 8-4-94 T=1930
UNIT DEQ #: 82 859 FILE #: D080500B
HEALTH DEPT. #: 210006-01 ELEV. 95
USGS #: R-9001 R-20 OLWR #: GW-1768
OWNER: Leaf Water Assn-south QUAD: McLain
LOCATION: SE/SW/SE S²¹~~28~~ T1N R8W COUNTY: Green
LOCATION DESCRIPTION: Well Located near R.RD Track Behind
Old School Bldg. about .2 mile E. of Hwy 57
in Leaf M
CASING DIA: _____ PUMP TYPE & SIZE: Sub
GPS FIELD LOCATION: LAT. 31°01.858 LONG. 88°47.810
GPS CORRECTED LOCATION: LAT. 31.030333 LONG. 88.797034
REMARKS: GPS Located 60 FT S/W of well

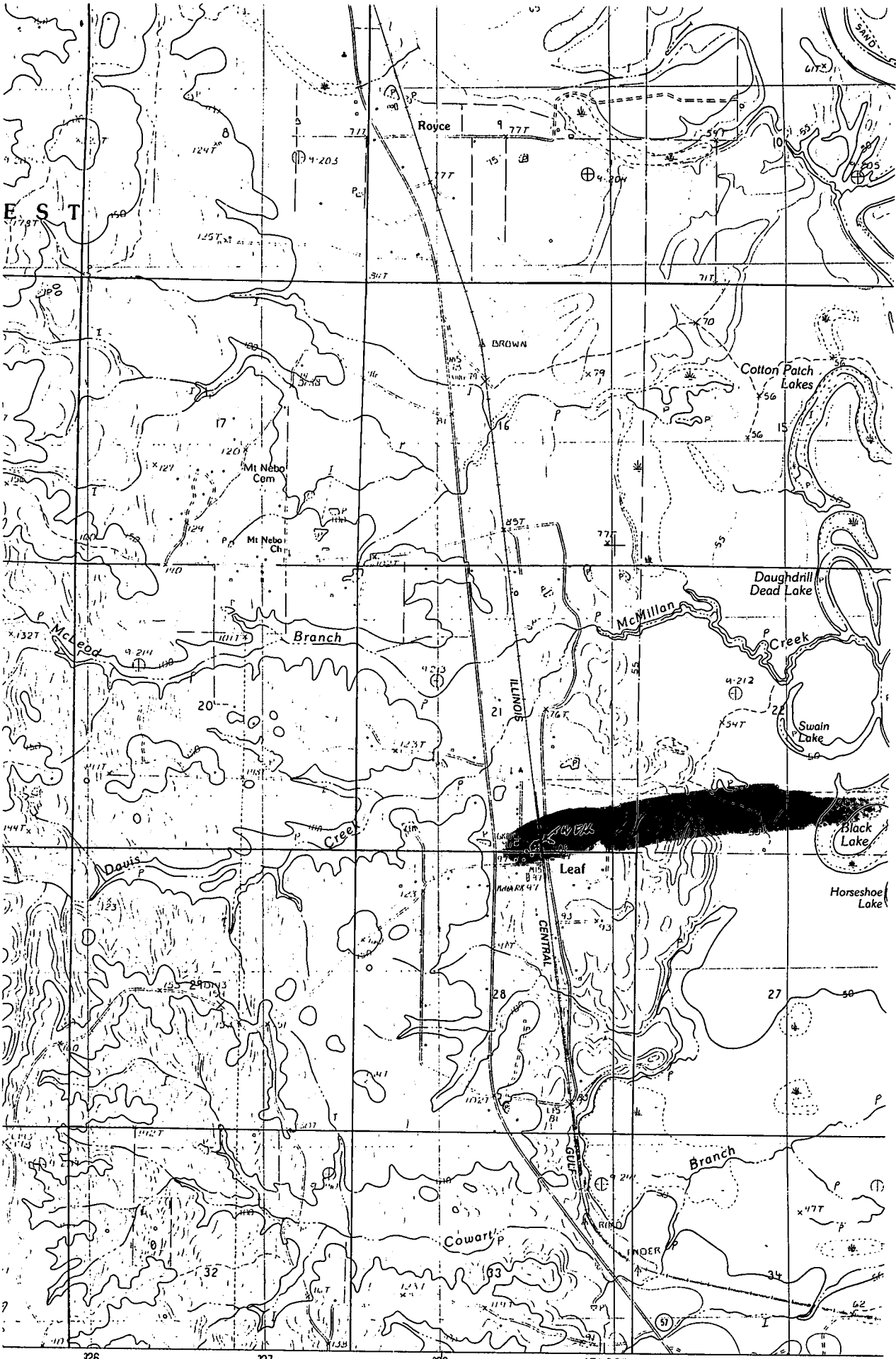

SCALE 1:24 000

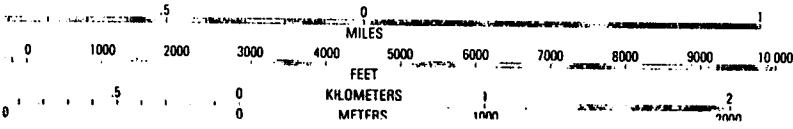

QUADRANGLE LOCATION