

6/78/WTO

DOH # 0200009-01 Basin Quad

Recorded by JPC

U.S. GEOLOGICAL SURVEY  
WATER RESOURCES DIVISION  
MISSISSIPPI DISTRICT  
WELL RECORD

Well No. K60

Date 1/17/80

E-Log No. \_\_\_\_\_

County GEORGE

*Lucretia*  
TRANSMITTED

Site ID 3 0 4 8 4 3 0 8 8 4 0 0 2 0 1 R=0\* T=A\* 2=W\*

GEN. SITE DATA

Data reliab. 3=U\* Report. agency 4=USGS\* Dist. 6=28\* 7=28\* Co. 8=039\*

Lat. \_\_\_\_\_ Long. 9=3 0 4 8 4 3\* 10=0 8 8 4 0 0 2\* Well No. 12=5 0 6 0\*

Location 13=N W / S E S 0 3 T 0 3 S R 0 7 W\* Alt. 16=60\* 158

Hyd. Unit (OWDC) 20= \_\_\_\_\_ Date 21=12 1 2 9 1 1 9 7 9\*

Well use 23=W\* Water Use 24=T\* Hole depth 27=4 1 0\* Well depth 28=3 9 0\*

WL 30=1 1 0\* Date 31=12 1 2 9 1 1 9 7 9\* Source 33=D\*

Status 273= \_\_\_\_\_ Project No. 5= \_\_\_\_\_

OWNER

R=158\* T=A\* Date 159# 12 1 2 9 1 1 9 7 9\* Owner No. \_\_\_\_\_

Owner 161=Singing River Ed\*

FIELD QW

R=192\* T=A\* Date 193# \_\_\_\_\_ Temp. 196#00010\* 197= \_\_\_\_\_

R=192\* T=A\* Date 193# \_\_\_\_\_ Cond. 196#00095\* 197= \_\_\_\_\_

R=192\* T=A\* Date 193# \_\_\_\_\_ pH 196#00400\* 197= \_\_\_\_\_

CONSTR.

R=58\* T=A\* 59# 1\* Date 60=12 1 2 9 1 1 9 7 9\* Remarks \_\_\_\_\_

Drlg. 63=4 0 8\* Name Fryfogle Method 65=4\* Finish 66=S\*

CASING

R=76\* T=A\* 59# 1\*

Top csng. 77# 0\* Bot. csng. 78=1 4 0\* Diam. 79# 4\*

R=76\* T=A\* 59# 1\*

Top csng. 77# 1 4 0\* Bot. csng. 78=3 8 0\* Diam. 79# 2\*

OPENINGS

R=82\* T=A\* 59# 1\* Top 83# 3 8 0\* Bottom 84=4 1 0\*

Type 85=S\* Diam. 87=2\* Size 88= \_\_\_\_\_

R=82\* T=A\* 59# 1\* Top 83# \_\_\_\_\_ Bottom 84= \_\_\_\_\_

Type 85= \_\_\_\_\_ Diam. 87= \_\_\_\_\_ Size 88= \_\_\_\_\_

YIELD

R=146\* T=A\* 147# 1\* Q 150=3 0\* Q/S 272= \_\_\_\_\_

134 flows 146 pumped

LIFT

R=42\* T= A \* Lift type 43# J \* Intake 44= \* Power type 45= E \*

Date 38= 12/29/1979 \* H.P. 46= 1 \*

LOGS

R=198\* T= A \* Log 199# D \* Top 200= 0 \* Bot 201= 410 \*

R=198\* T= A \* Log 199# \* Top 200= \* Bot 201= \*

R=189\* T= A \* E Log No. 190# \* 191= M I S S D I S T \*

ANAL.

R=114\* T= A \* Year 115# \* Type 120= \*

AQUIFERS

R=90\* T= A \* 256# 1 \* Top 91= 375 \* Bot 92= 410 \*

Unit ID 93= 122MΦCN \* Name of Unit

R=90\* T= A \* 256# 1 \* Top 91= \* Bot 92= \*

Unit ID 93= \* Name of Unit

HYDRAULICS

R=98\* T= A \* 99# 1 \* Unit tested 100= \* 103= \*

R=105\* T= A \* 99# 1 \* Test No. 106# \*

107= \* Transmissivity (gal/d)/ft

108= \* Hydraul. cond. (gal/d)/ft<sup>2</sup>

110= \* Storage coeff. Boundaries

R=121\* T= \* Yr Begin 122# \* Network 258= \*

Water Level Data Collection (1)

description of formations encountered	from	to
SAND	0	75
tan clay	75	110
Blue Clay	110	210
SAND	210	200
Clay	320	350
fine sand	350	375
SAND	375	410

DEPARTMENT OF ENVIRONMENTAL QUALITY - OLWR  
PUBLIC SUPPLY WELLS PROJECT

GPS LOG

Basin Quad

USER NAME(S): SH Bishop DATE: 8-3-94  
UNIT DEQ #: 82859 FILE #: D080317B  
HEALTH DEPT. #: 20009-01 ELEV. 158  
USGS #: K-9000 K60 OLWR #: \_\_\_\_\_

OWNER: Singing R. E.D. Assoc.

LOCATION: NW-SE S 12 T 35 R 7W COUNTY: Georgia

LOCATION DESCRIPTION: From S.R.E.A. Head station <sup>sign</sup> Hwy 63 Go West on  
Basin Refuge RD and follow main RD 4 mi to Basin Volunteer Fire Dept.  
at 1174 Pleasant Hill Church RD

CASING DIA: \_\_\_\_\_ PUMP TYPE & SIZE: 5HP

GPS FIELD LOCATION: LAT. 30° 47.984 LONG. 88° 38.425

GPS CORRECTED LOCATION: LAT. 30.79993889 LONG. 88.63994111  
LAT. 30 47 59.780 LONG. 88 38 23.788

REMARKS: GPS at well  
\_\_\_\_\_  
\_\_\_\_\_  
\_\_\_\_\_

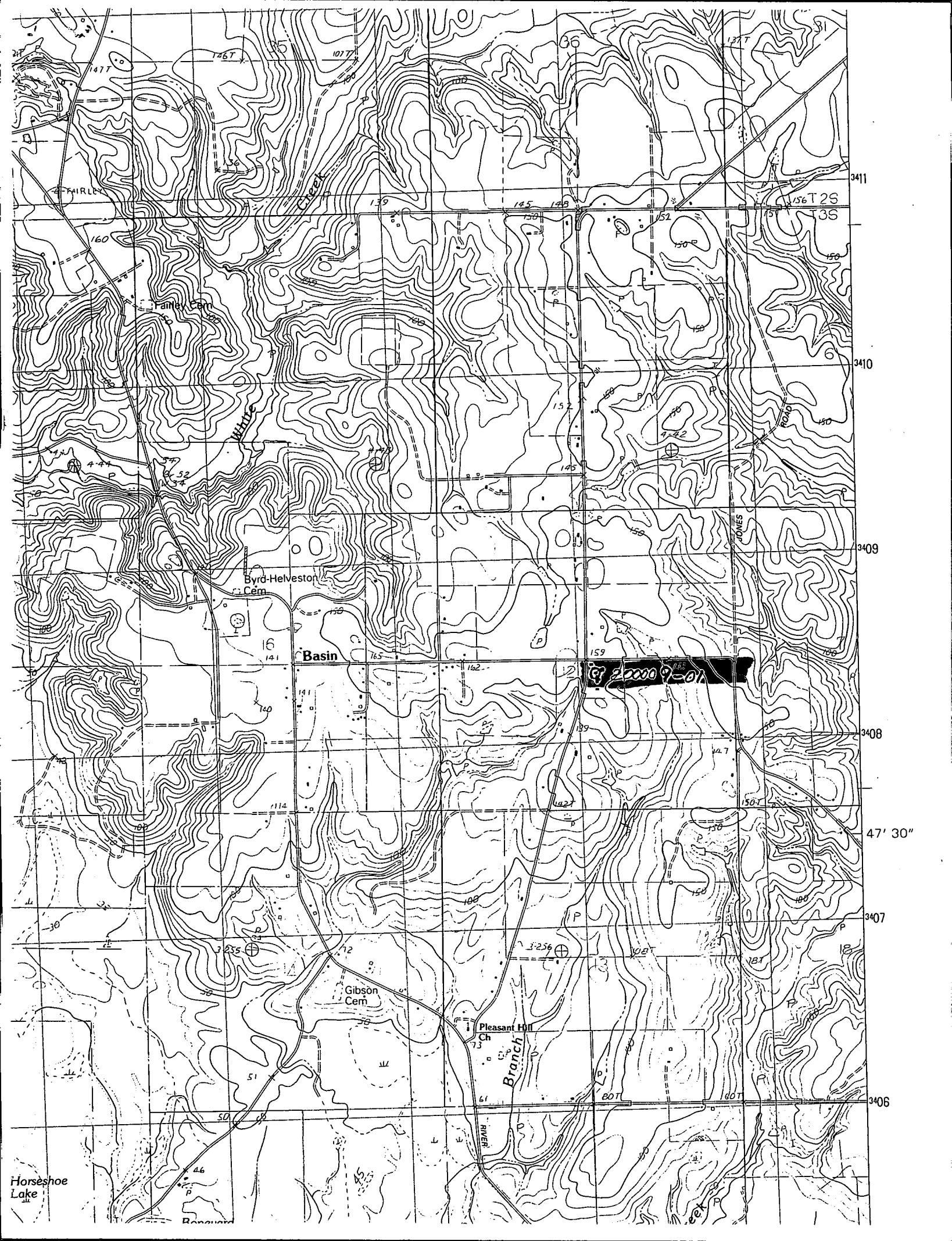

Horseshoe Lake

Basin

200009-01

Pleasant Hill Ch

Gibson Cem

Fairley Cem

Byrd-Helveston Cem

Branch

JONES ROAD

3411

3410

3409

3408

3407

3406

47' 30"

3407

3408

3409

3410

3411

3412

3413

3414

3415

3416

3417

3418

3419

3420

3421

3422

3423

3424

3425

3426

3427

3428

3429

3430

3431

3432

3433

3434

3435

3436

3437

3438

3439

3440

3441

3442

3443

3444

3445

3446

3447

3448

3449

3450

3451

3452

3453

3454

3455

3456

3457

3458

3459

3460

3461

3462

3463

3464

3465

3466

3467

3468

3469

3470

3471

3472

3473

3474

3475

3476

3477

3478

3479

3480

3481

3482

3483

3484

3485

3486

3487

3488

3489

3490

3491

3492

3493

3494

3495

3496

3497

3498

3499

3500

3501

3502

3503

3504

3505

3506

3507

3508

3509

3510

3511

3512

3513

3514

3515

3516

3517

3518

3519

3520

3521

3522

3523

3524

3525

3526

3527

3528

3529

3530

3531

3532

3533

3534

3535

3536

3537

3538

3539

3540

3541

3542

3543

3544

3545

3546

3547

3548

3549

3550

3551

3552

3553

3554

3555

3556

3557

3558

3559

3560

3561

3562

3563

3564

3565

3566

3567

3568

3569

3570

3571

3572

3573

3574

3575

3576

3577

3578

3579

3580

3581

3582

3583

3584

3585

3586

3587

3588

3589

3590

3591

3592

3593

3594

3595

3596

3597

3598

3599

3600

3601

3602

3603

3604

3605

3606

3607

3608

3609

3610

3611

3612

3613

3614

3615

3616

3617

3618

3619

3620

3621

3622

3623

3624

3625

3626

3627

3628

3629

3630

3631

3632

3633

3634

3635

3636

3637

3638

3639

3640

3641

3642

3643

3644

3645

3646

3647

3648

3649

3650

3651

3652

3653

3654

3655

3656

3657

3658

3659

3660

3661

3662

3663

3664

3665

3666

3667

3668

3669

3670

3671

3672

3673

3674

3675

3676

3677

3678

3679

3680

3681

3682